

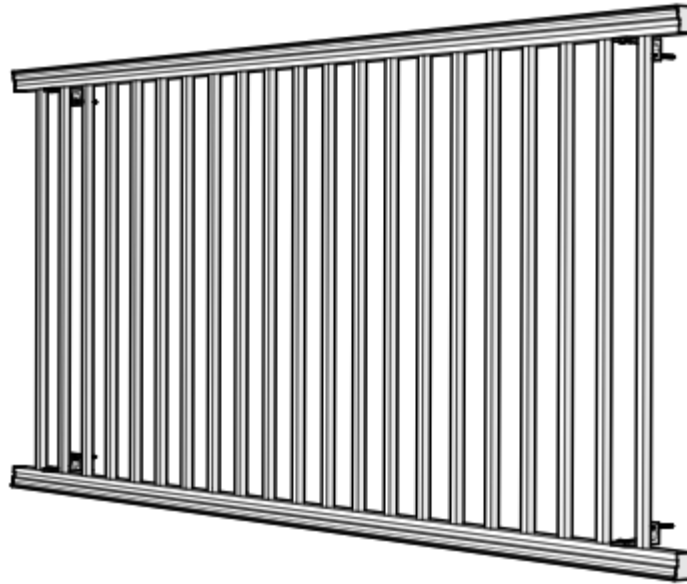

Barrier Railing

KeyLinkOnline.com



Recommended Tools

- Safety Glasses
- Tape Measure & Pencil
- Level
- Power Drill w/ Square bit
- Drill Bit (1/8")
- Saw w/fine-tooth aluminum cutting blade
- Ladder

What's Included:

- 2 - Rails (Top & Bottom)
- 9 - #10 x 3/4" Pan Head Screws
- 4 - L-Brackets
- 4 - Rail End Caps
- X - Balusters



Rail End Cap

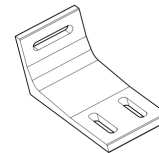

L - Bracket



Pan-Head Screws

- *These directions are only a guide and may not address every situation.*
- *Always wear proper safety equipment while assembling and installing.*
- *The installer should obtain all required building permits and follow all installation procedures in accordance with applicable building code requirements.*
- *Key-Link Fencing and Railing Inc. shall not be held liable for improper or unsafe installations.*
- *Applying paint, other than Key-Link's touch up paint, will void your warranty.*
- *To ensure proper coverage by our warranty please visit our website and complete the warranty form and mail to: Key-Link Fencing & Railing, Inc., 150 Orlan Road, New Holland, PA 17557*



WARNING: This product can expose you to chemicals including Quartz (crystalline silica), which is known to the State of California to cause cancer, and Hexavalent Chromium, which is known to the State of California to cause birth defects or other reproductive harm. For more information go to www.P65Warnings.ca.gov.

KFRIG180928

1

Determine the position and measurements of the section needed on the doorway.



Cutting Tip

Be sure to use a **fine-tooth blade approved for cutting aluminum** and rest rails on a piece of **non-abrasive material** to protect from scratches.

2

Cut Rails to proper length by cutting an equal amount from each end. Do not cut through Baluster holes.

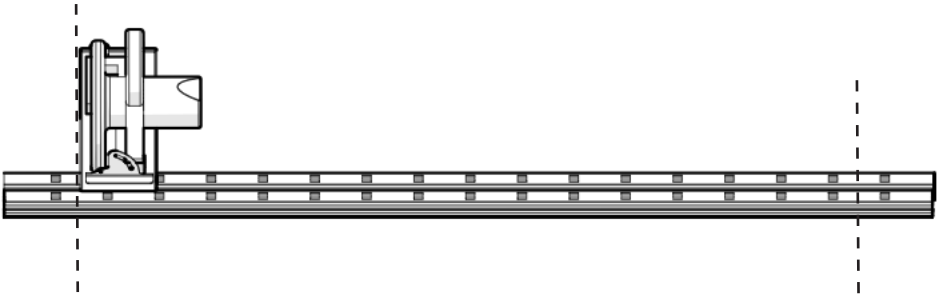
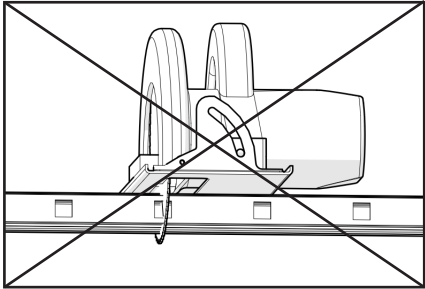

3

Working on a flat, smooth, non-abrasive surface ; tap/ insert the end caps onto the rail ends, with a soft mallet.

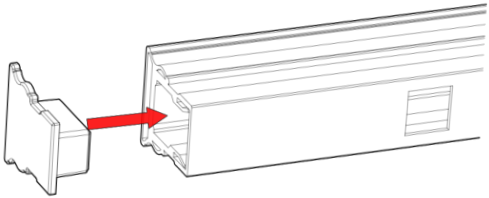
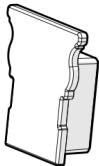

4

Ensure placement/ measurement of L-Bracket on rails (without covering/encroaching on any rail holes). Mark positions and Predrill two 1/8" dia. holes through the bottom face of each rail.

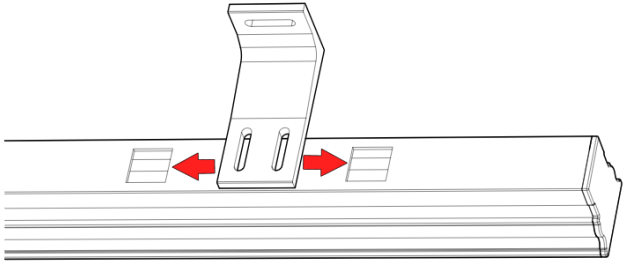
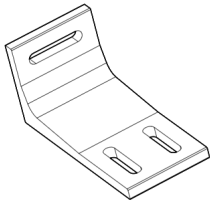

5

Lay the rails down with the Baluster holes facing upward, and attach the L-Brackets with the provided pan head screws.

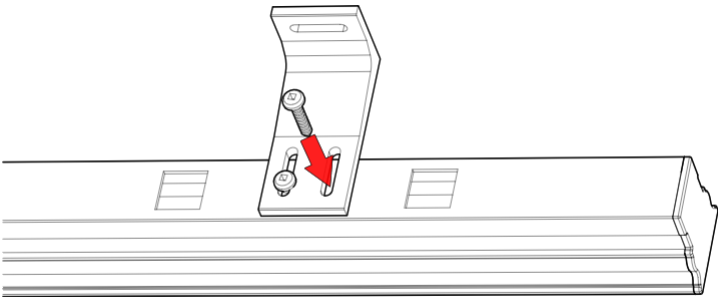

6

Insert the Balusters into the designated bottom rail, (both rails are the same), carefully slip the designated top rail onto the tops of the balusters and attach/secure the section together with a screw in the rails; at each end of the centermost baluster, to prevent bottom rail sag. Finally secure the section together with shrink wrap or banding, (for installation).

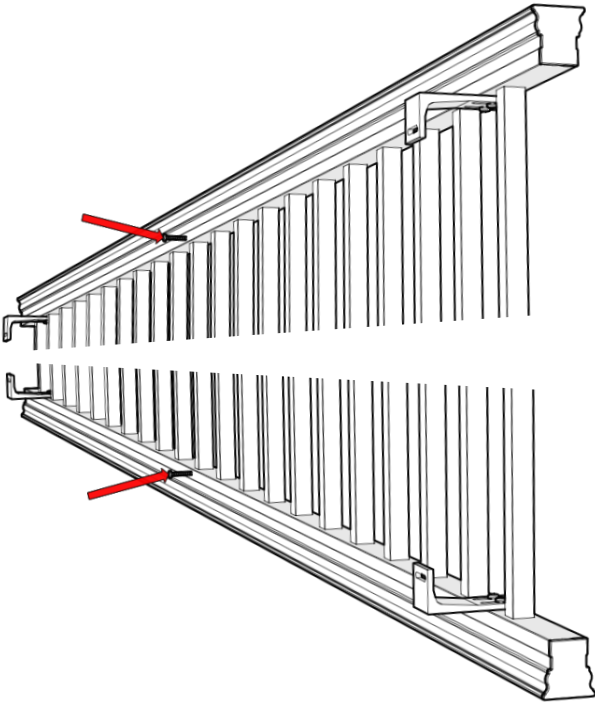
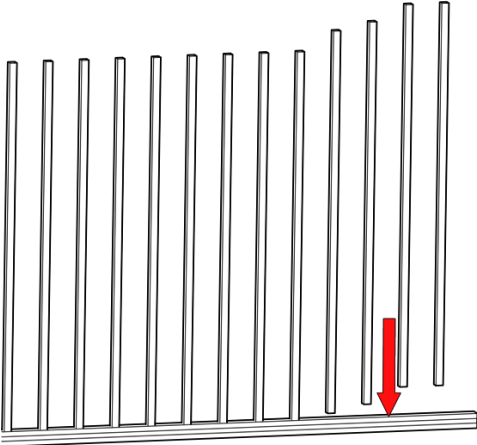

7

Attach the assembled section with code approved screws (not provided).