

82 HANOVER STREET PORTLAND, MAINE

FEBRUARY 26, 2019

SQUARE FOOTAGE
MEASURED TO CENTER
OF SHARED WALLS AND
OUTSIDE FACE OF
EXTERIOR WALLS

PROGRESS PRINT ONLY
Not for Construction

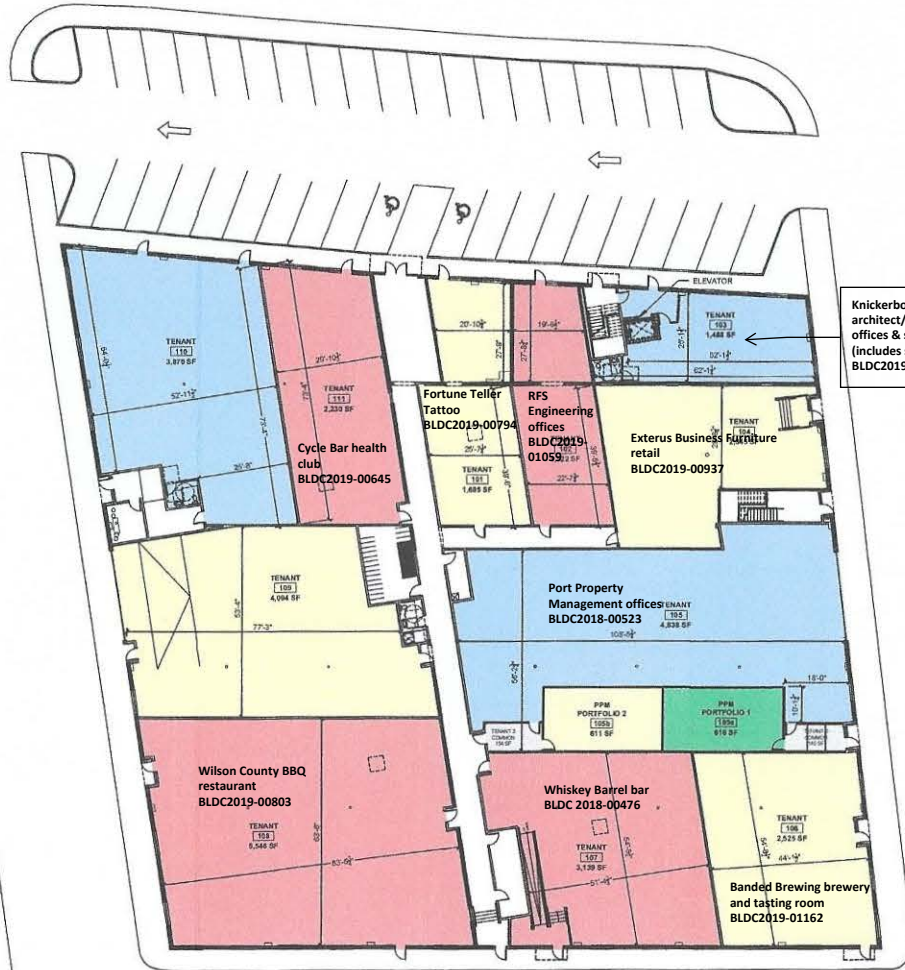

Knickerbocker Group (KG)
architect/interior designer
offices & showroom
(includes second story)
BLD C2019-01181

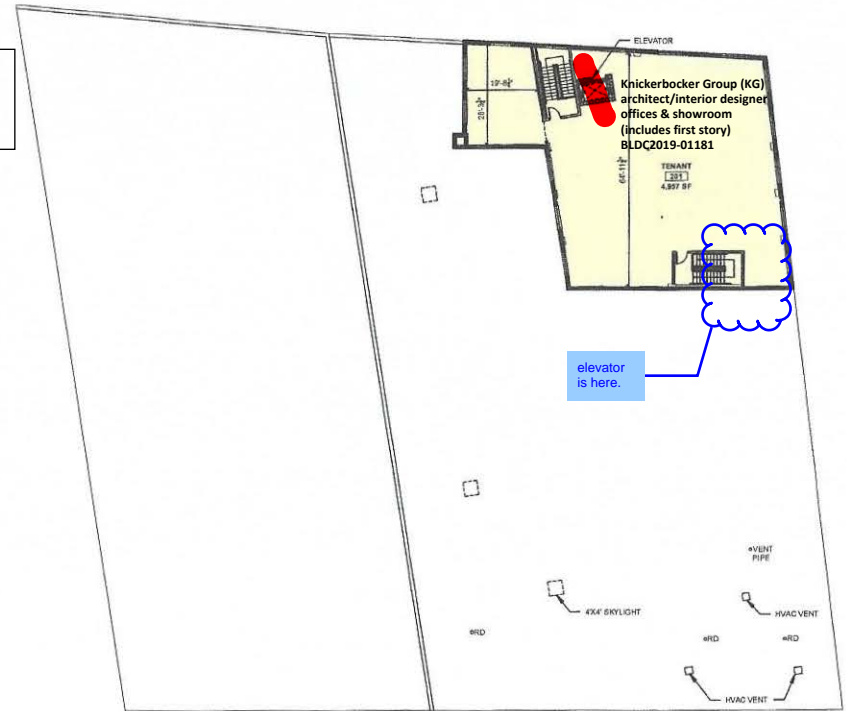

elevator
is here.

1 FIRST FLOOR PLAN
DWG # 1 OF 2 WHEN PRINTED AT 20" X 30"

2 SECOND FLOOR PLAN
DWG # 2 OF 2 WHEN PRINTED AT 20" X 30"