

P.E.: MICHAEL E. TADEAMA-WIELANDT
DATE: 3-28-2018

NO.	DATE	REVISIONS	BY
1	3-28-2018	SUBMITTED TO PLANNING BOARD FOR APPROVAL	MTW

565 CONGRESS STREET
SUITE 310
PORTLAND, ME 04102
CLIMBERLAND HALL
41 CAMPUS DRIVE, SUITE 101
NEW GLOUCESTER, ME 04260

OFFICE: (207) 926-5111 FAX: (207) 221-1317
www.terradync consultants.com

TERRADYN
CONSULTANTS, LLC
Civil Engineering - Land Planning - Stormwater Design - Environmental Permitting

SHEET DESCRIPTION
178 KENNEBEC STREET
178 KENNEBEC STREET
PORTLAND, ME 04101
SITE PLAN

PREPARED FOR
MAINE WORKFORCE HOUSING, LLC
482 CONGRESS STREET, SUITE 203
PORTLAND, ME 04101

DATE: 3/16/2018
SCALE: 1" = 10'
DESIGNED: ARF
JOB NO: 1747
FILE: 1747-B.DWG
SHEET **C-3.0**

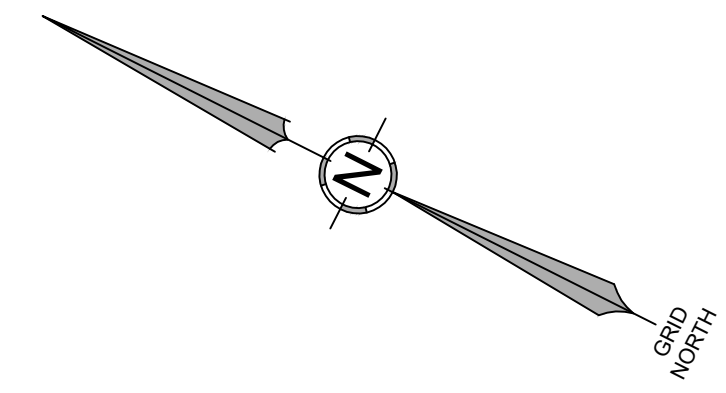

PARRIS STREET

34' PAVED - PUBLIC - 50' WIDE ROW

KENNEBEC STREET

35' PAVED - PUBLIC - 50' WIDE ROW

BRATTLE STREET

30' PAVED - PUBLIC - 30' WIDE ROW

CURB LEGEND

- VERTICAL GRANITE CURB
- SLIPFORM CONCRETE CURB
- INTEGRAL CONCRETE CURB WITH SIDEWALK
- FLUSH GRANITE CURB
- CURB TIPDOWN

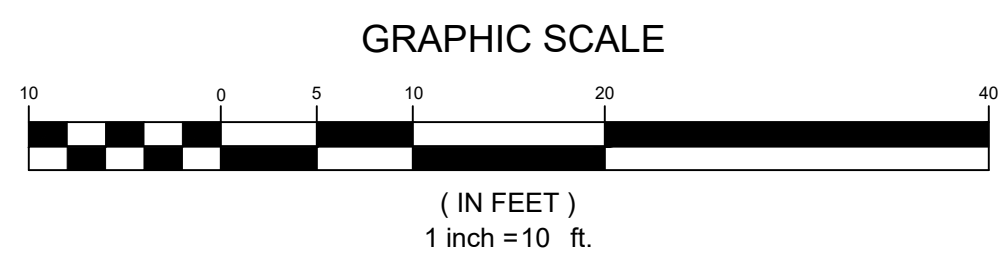
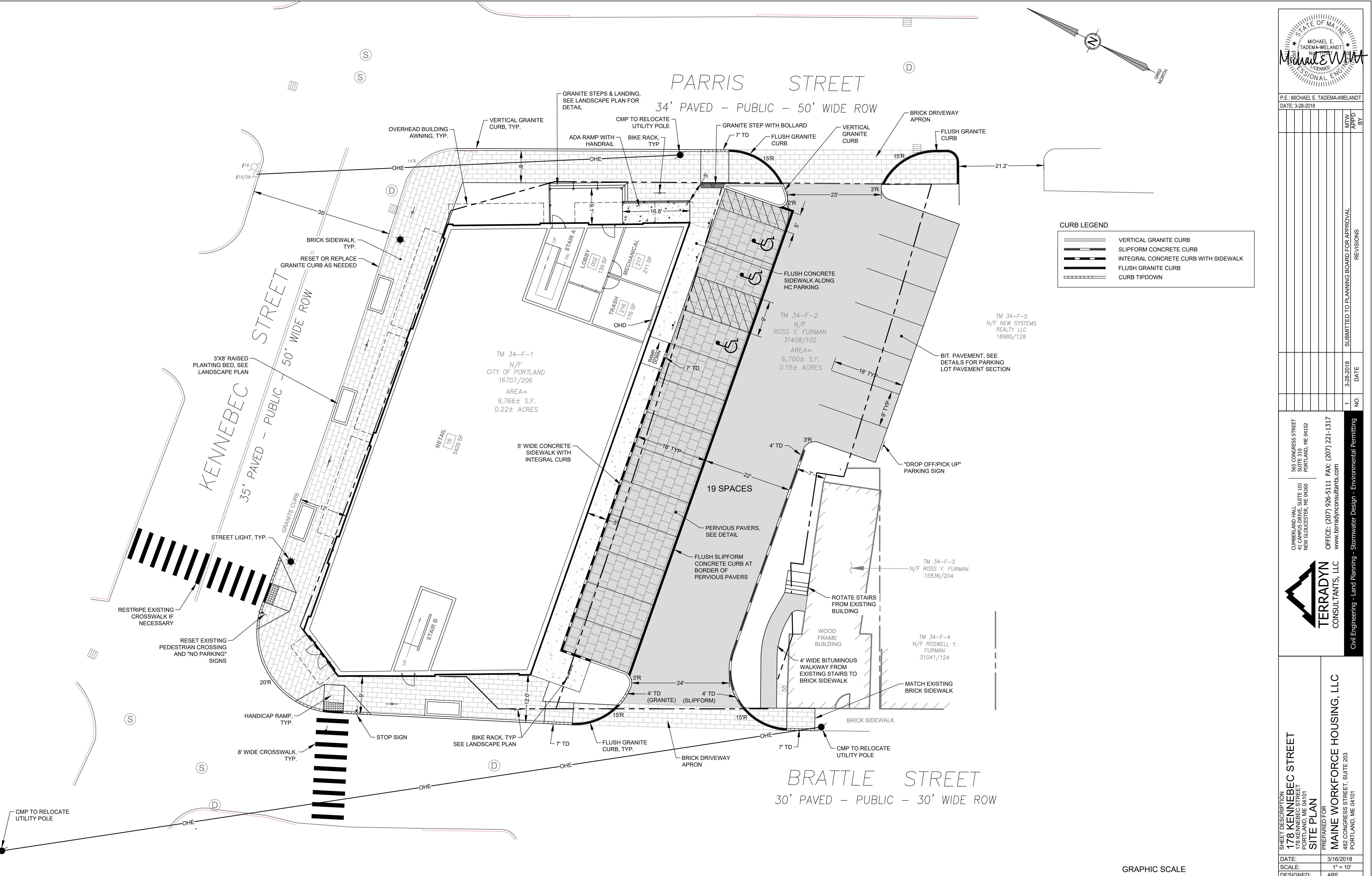

PRELIMINARY - NOT FOR CONSTRUCTION