

GENERAL NOTES

- REFER TO SHEET A131 FOR EQUIPMENT LIST AND FURNITURE SCHEDULE.
- PROVIDE FULL HEIGHT BLOCKING IN WALL FOR ALL SHELVING, TYP.

855 GRANDVIEW AVENUE
SUITE 295
COLUMBUS, OHIO 43215
PHONE: 614.487.8770
FAX: 614.487.8777



COPYRIGHT 2015
THIS DRAWING IS AN INSTRUMENT OF SERVICE AND AS SUCH
REMAINS THE PROPERTY OF CHIPOTLE MEXICAN GRILL, INC.
PERMISSION FOR USE OF THIS DOCUMENT IS LIMITED AND
CAN BE EXTENDED ONLY BY WRITTEN AGREEMENT WITH
CHIPOTLE MEXICAN GRILL, INC.



CHIPOTLE MEXICAN GRILL, INC.
1401 WYNWOOD STREET, SUITE 500
DENVER, COLORADO 80202
TELEPHONE: (303) 595-4000
FAX: (303) 595-4014
INTERNET: WWW.CHIPOTLE.COM

STORE NO.: 2603
PORTLAND MARGINAL WAY
195 KENNEBEC ST
PORTLAND, ME 04101

Issue Record:
09/15/15 PERMIT/LANDLORD REVIEW

Issue	Checked

Revisions:

Drawn	Checked
TC, BP, DP	KH, TC

Project No:
CMG507

Contents:

Elevations - Interior
Kitchen

A220

Date of Last Print:
09/15/15

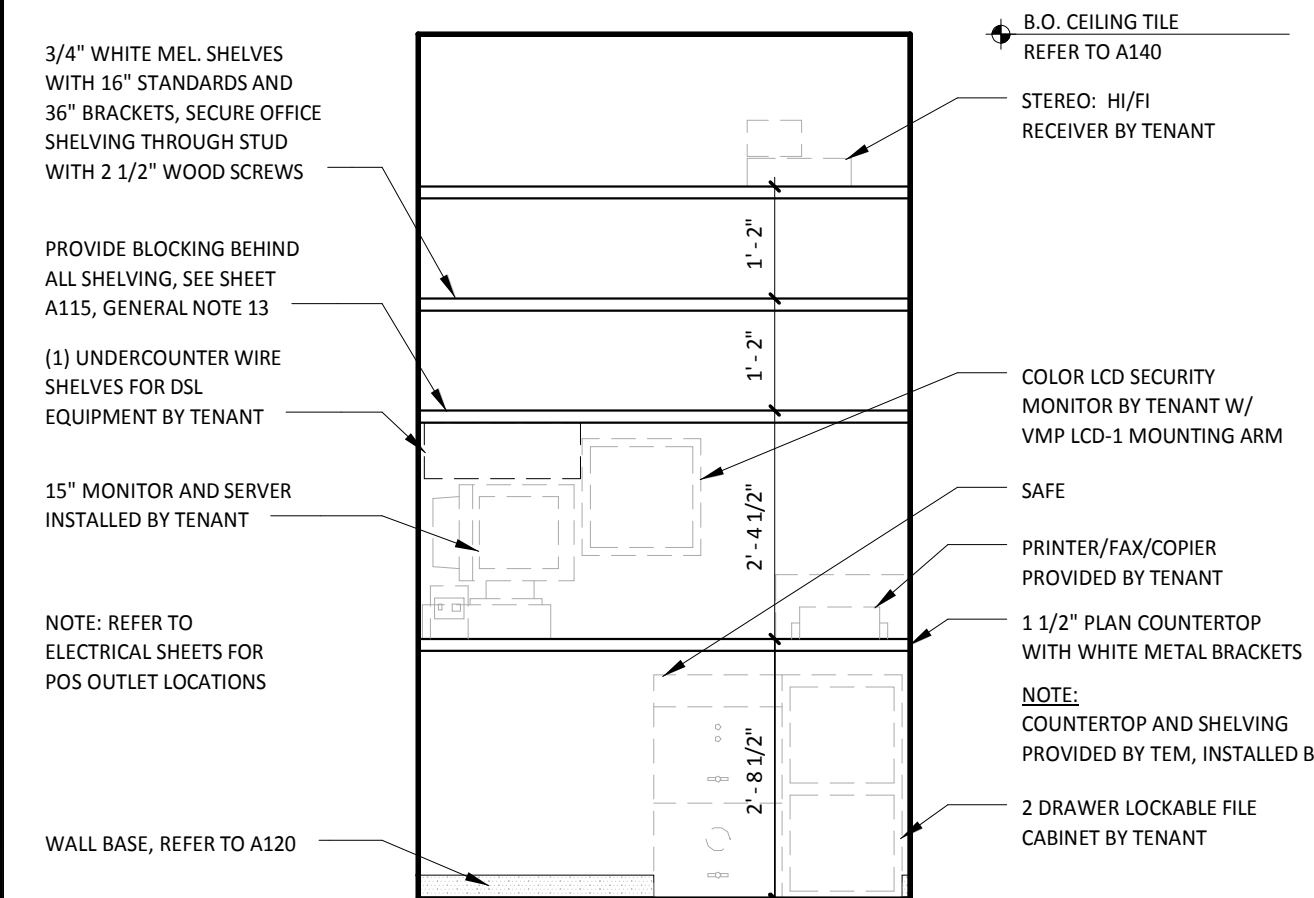

17 TYP ELEV - OFFICE SHELVING
1/2" = 1'-0"

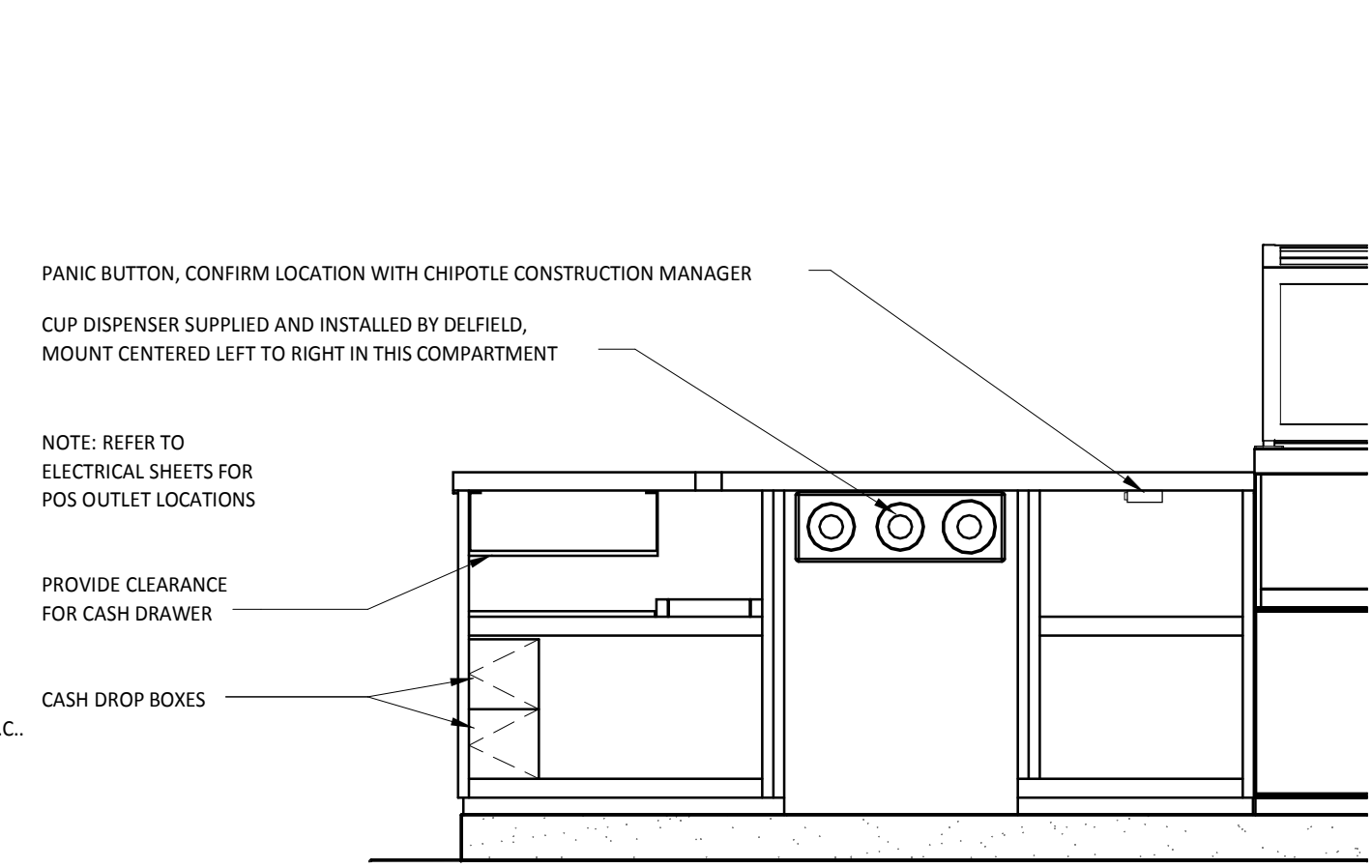

18 TYP ELEV - POS
3/4" = 1'-0"

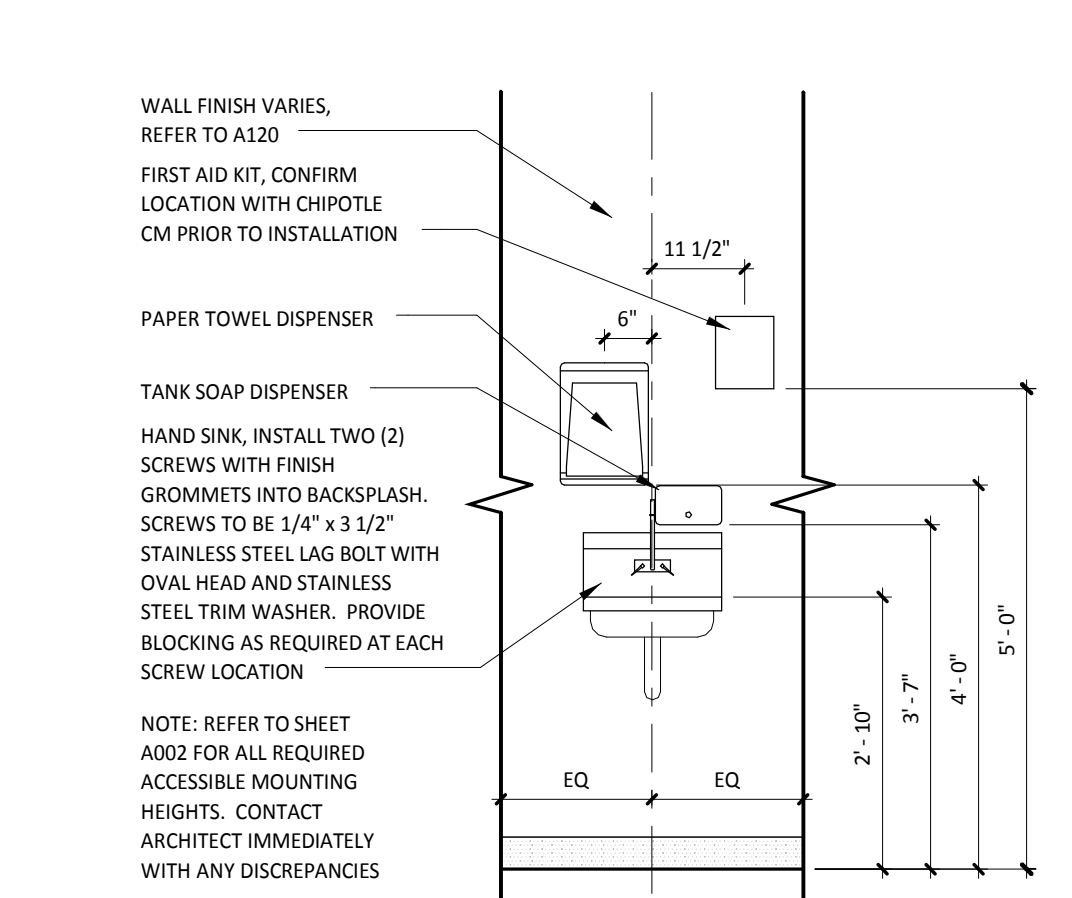

15 TYP ELEV - HAND SINK
1/2" = 1'-0"

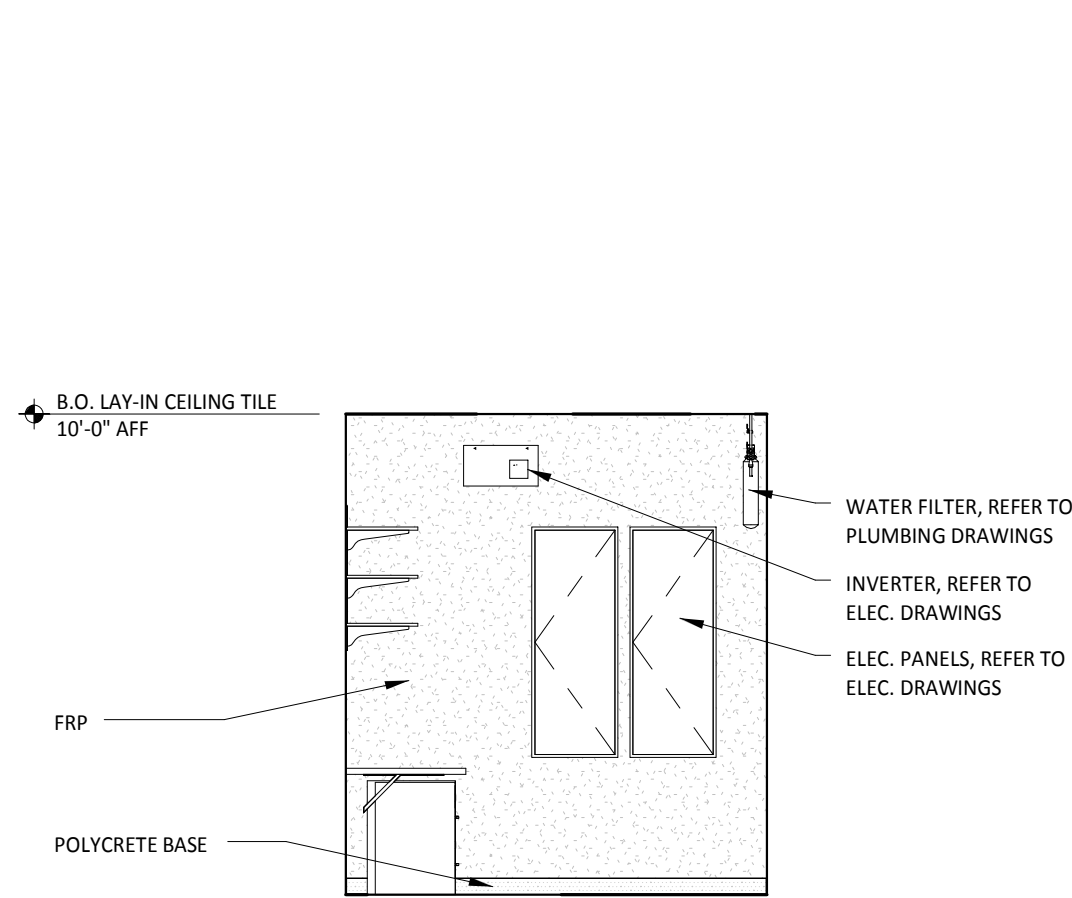

14 INT ELEV - KITCHEN
1/4" = 1'-0"

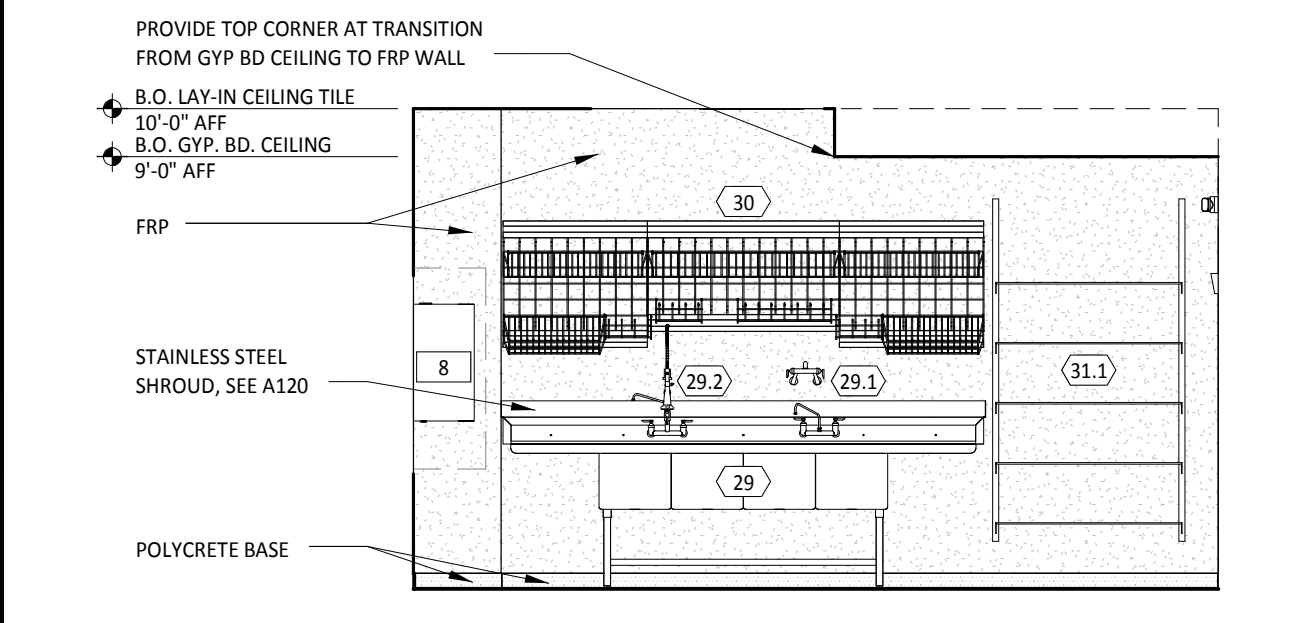

13 INT ELEV - KITCHEN
1/4" = 1'-0"

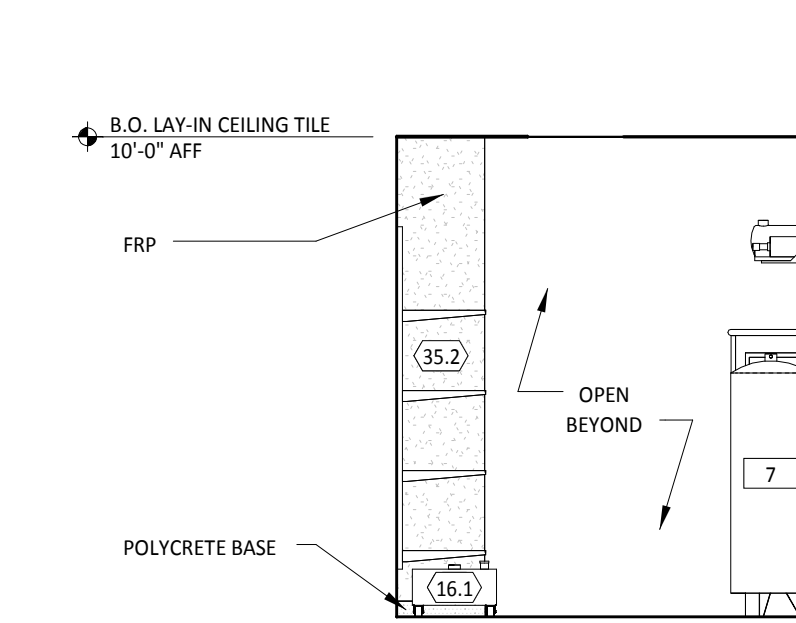

12 INT ELEV - KITCHEN
1/4" = 1'-0"

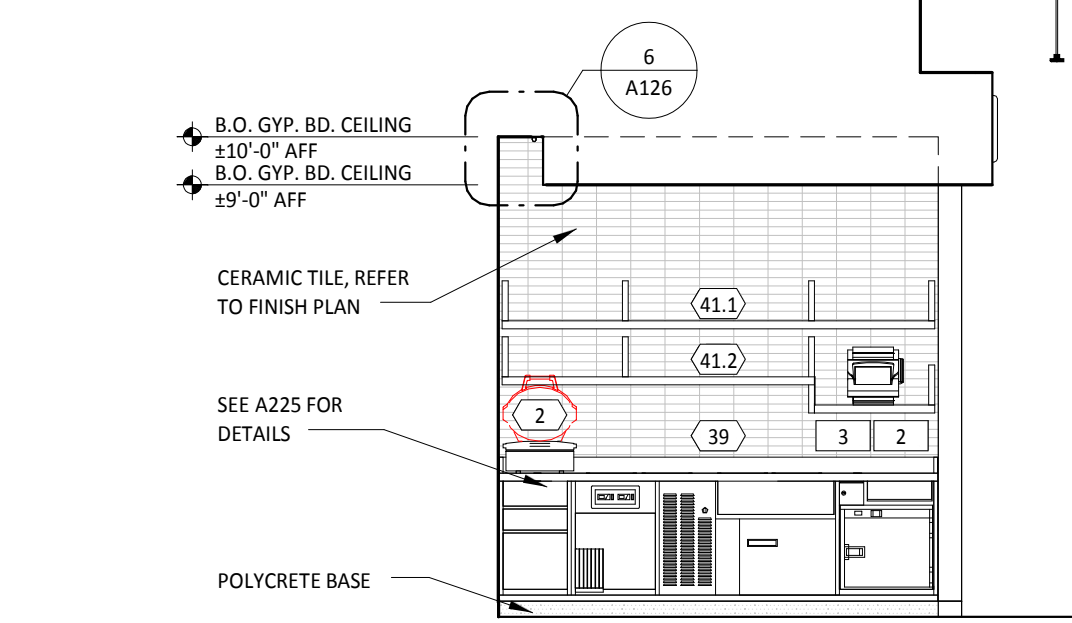

11 INT ELEV - KITCHEN
1/4" = 1'-0"

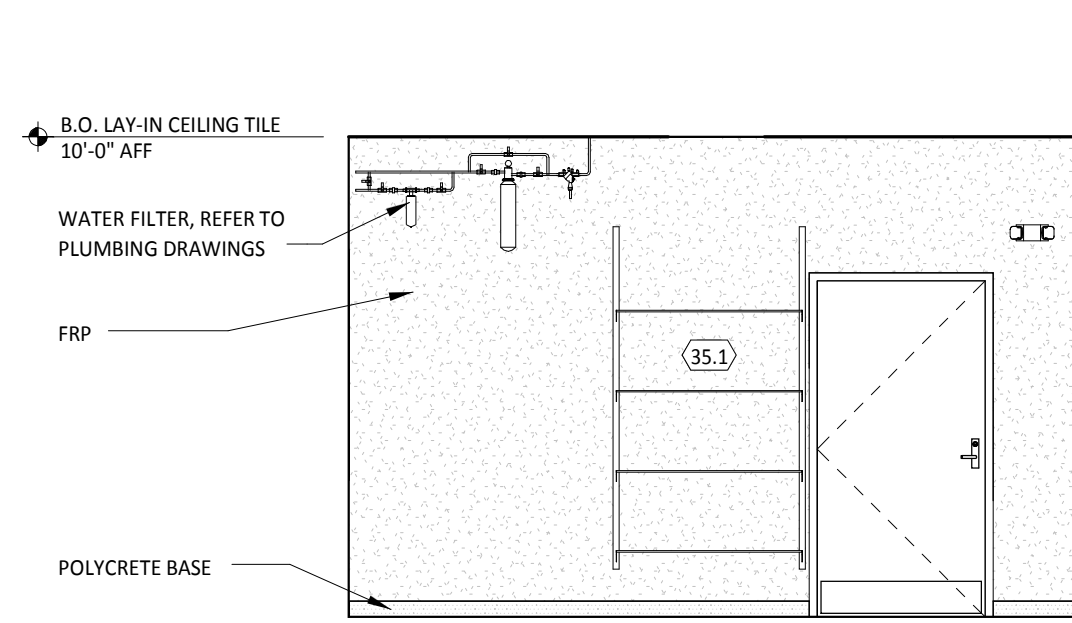

10 INT ELEV - KITCHEN
1/4" = 1'-0"

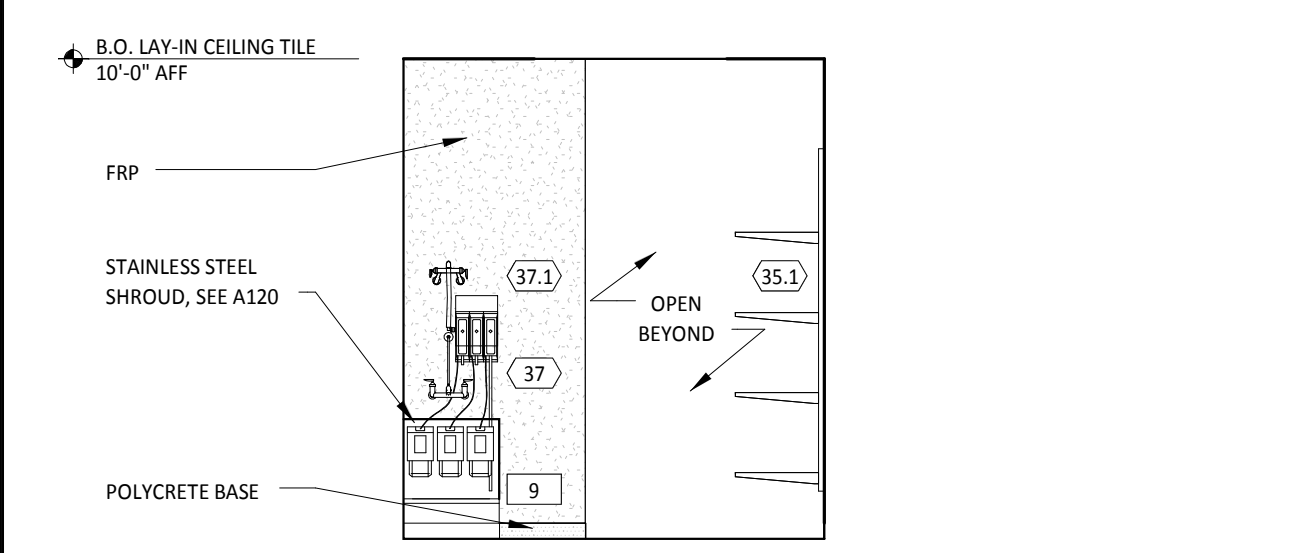

9 INT ELEV - KITCHEN
1/4" = 1'-0"

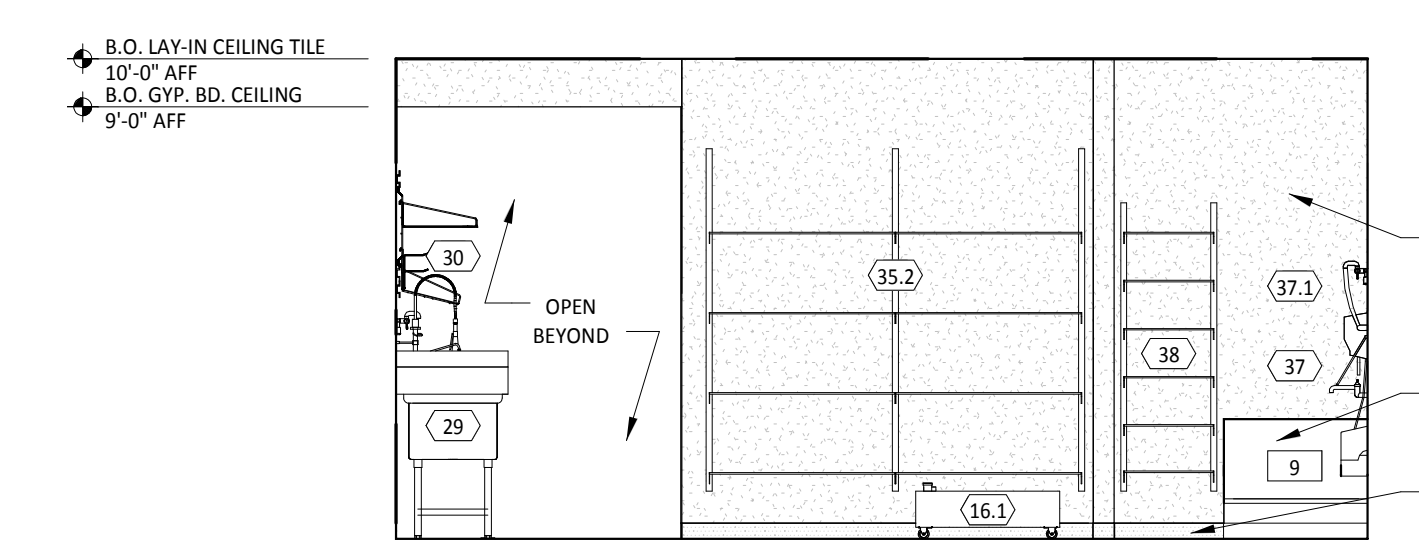

8 INT ELEV - KITCHEN
1/4" = 1'-0"

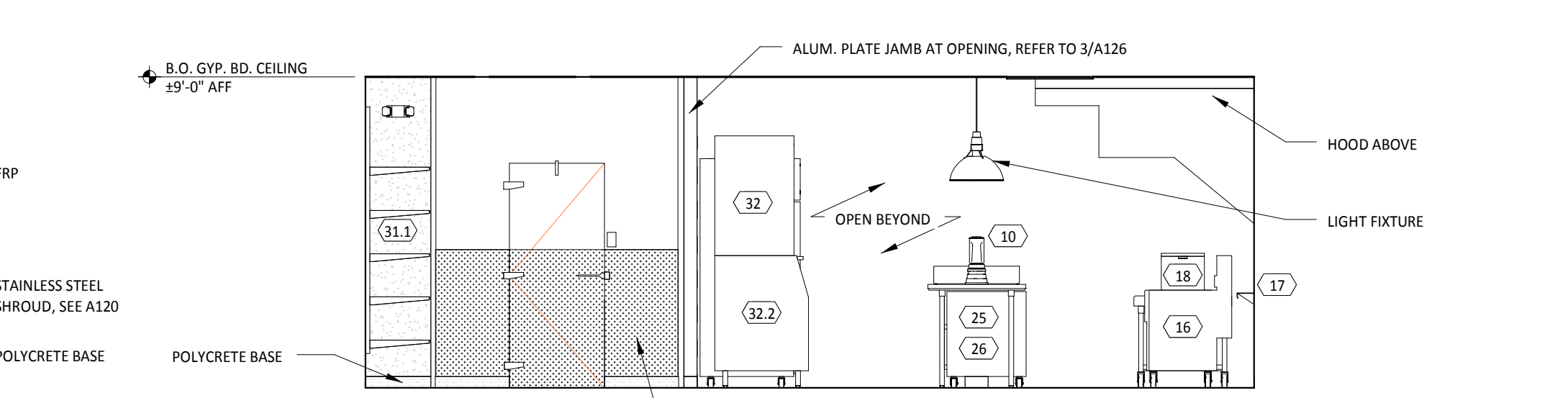

7 INT ELEV - KITCHEN
1/4" = 1'-0"

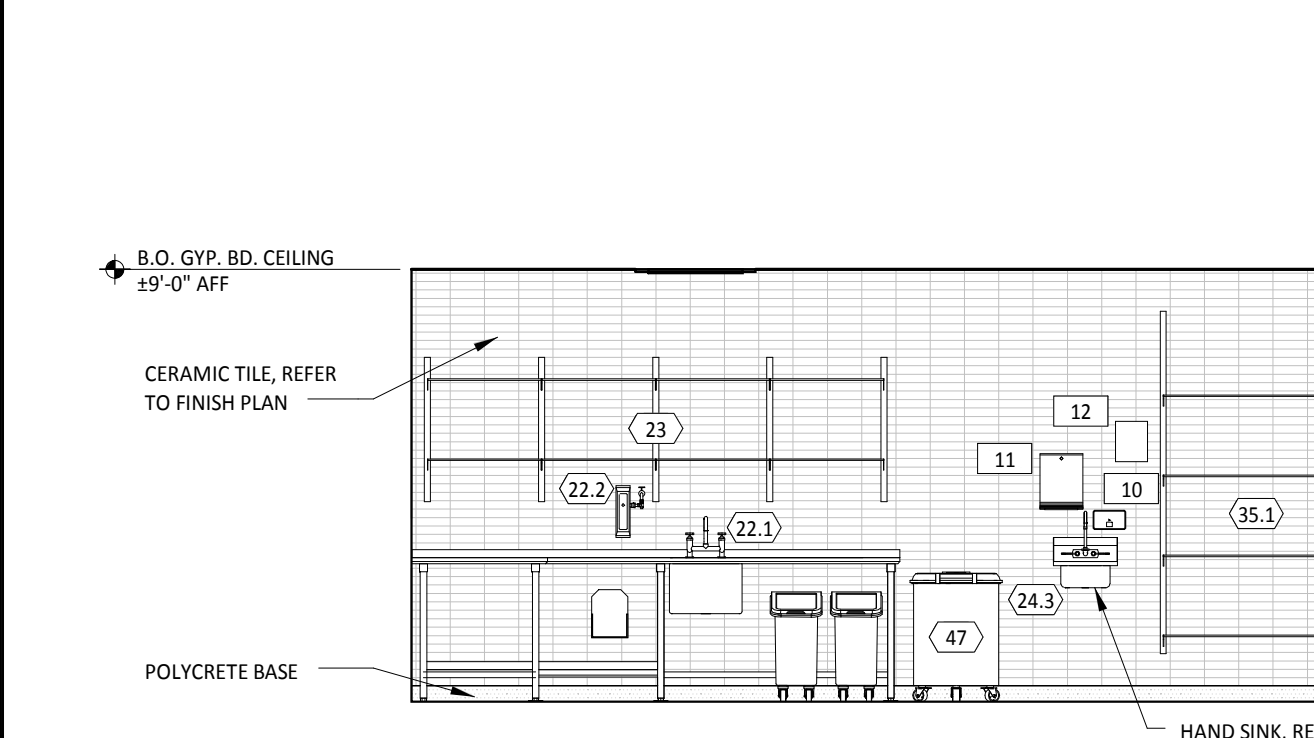

6 INT ELEV - KITCHEN
1/4" = 1'-0"

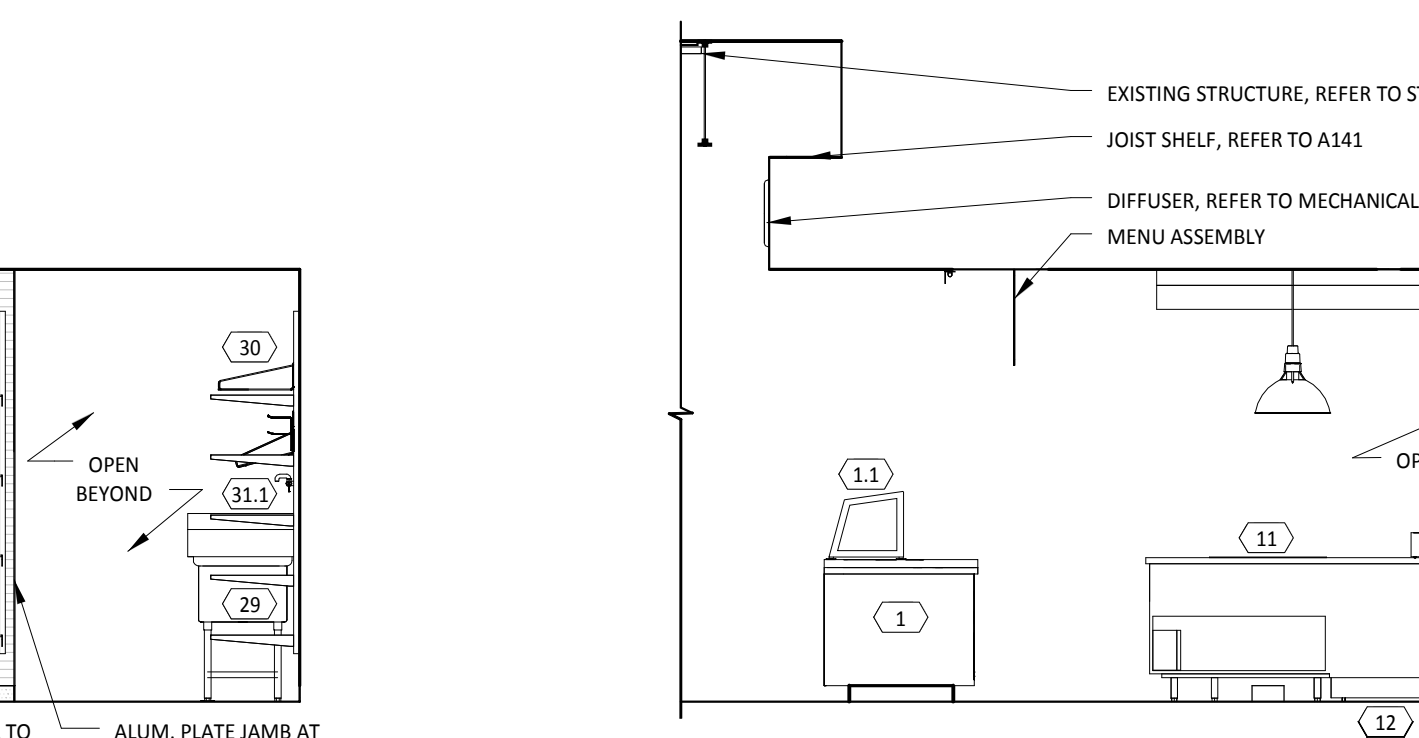

5 INT ELEV - KITCHEN
1/4" = 1'-0"

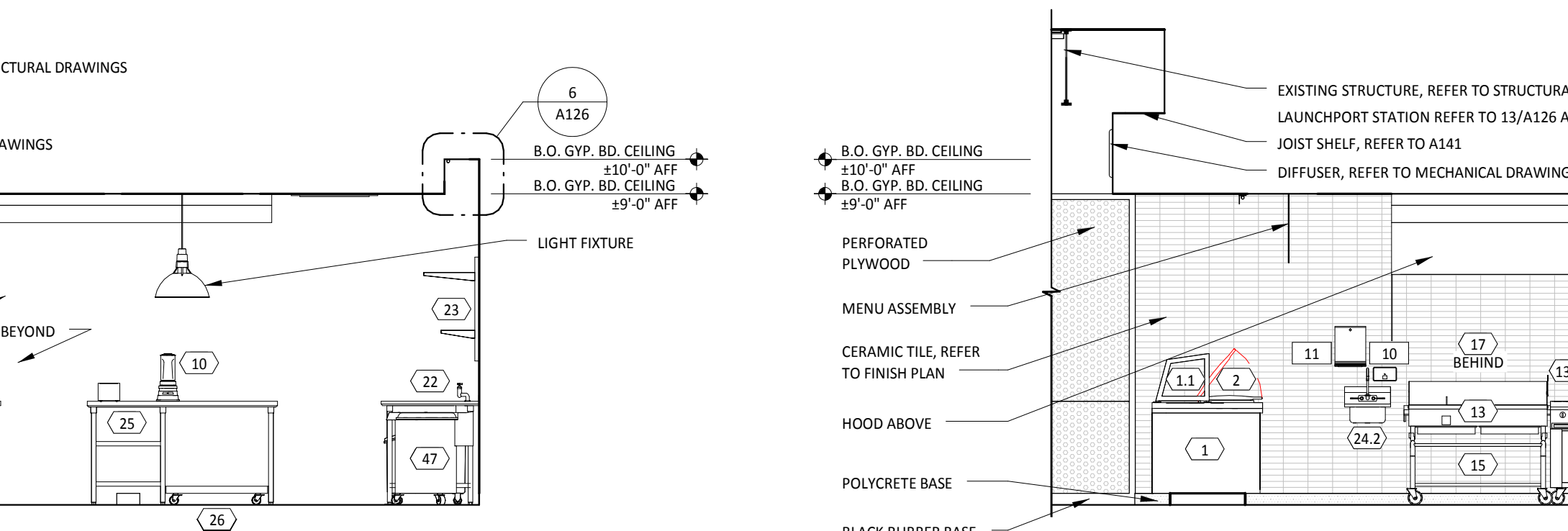

4 INT ELEV - KITCHEN
1/4" = 1'-0"

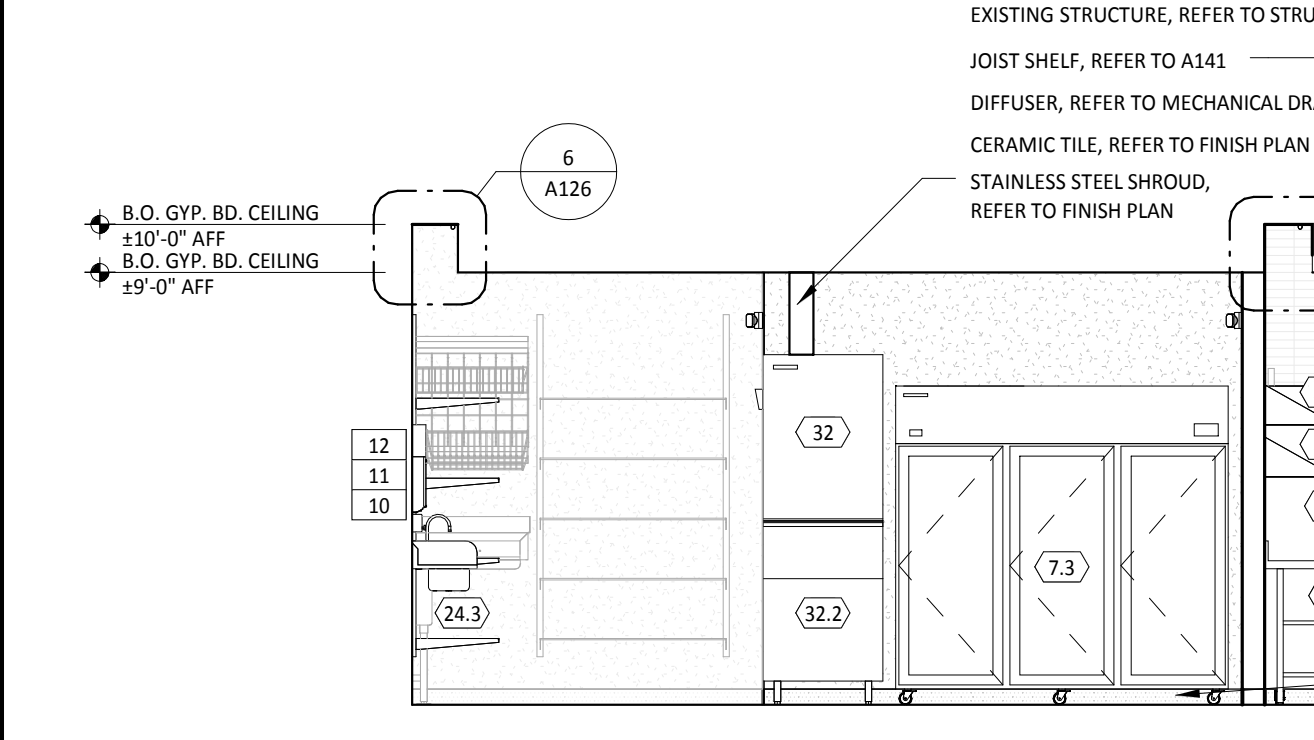

3 INT ELEV - KITCHEN
1/4" = 1'-0"

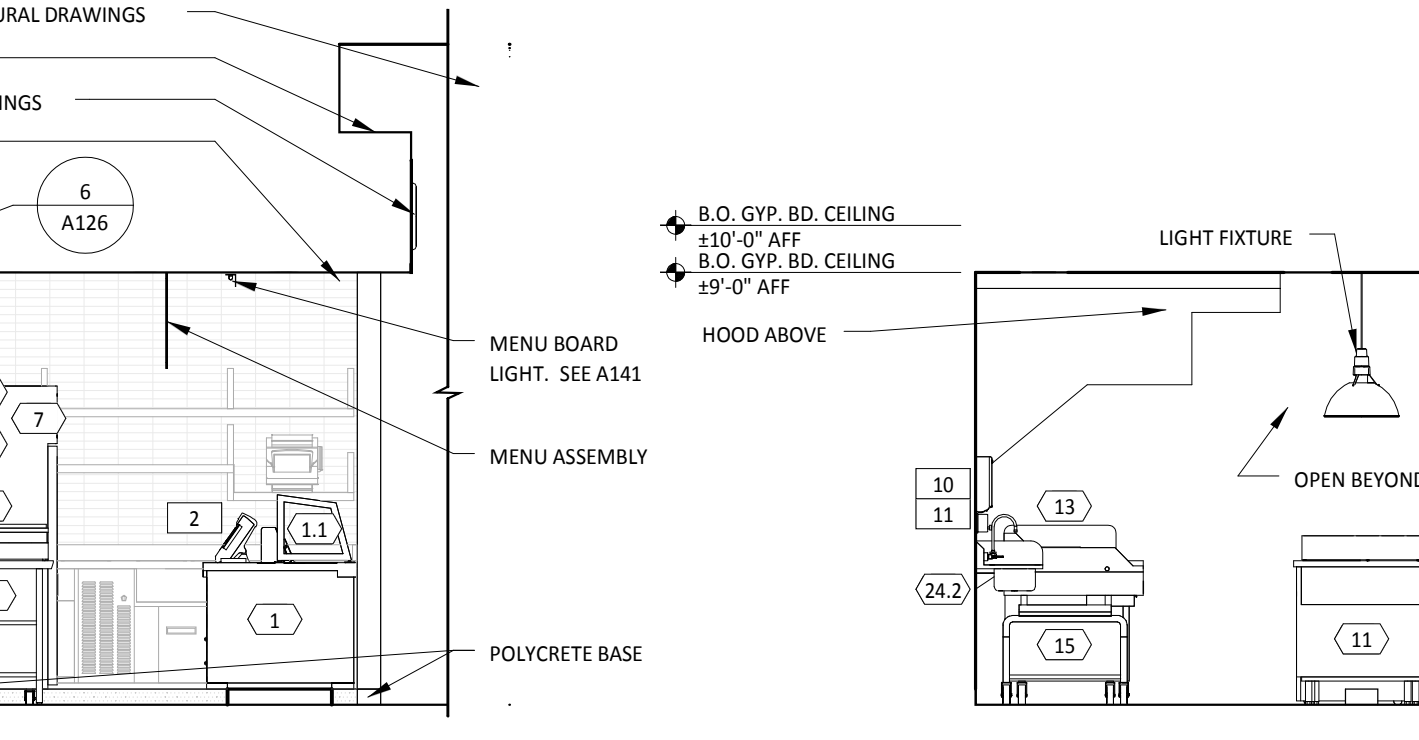

2 INT ELEV - KITCHEN
1/4" = 1'-0"

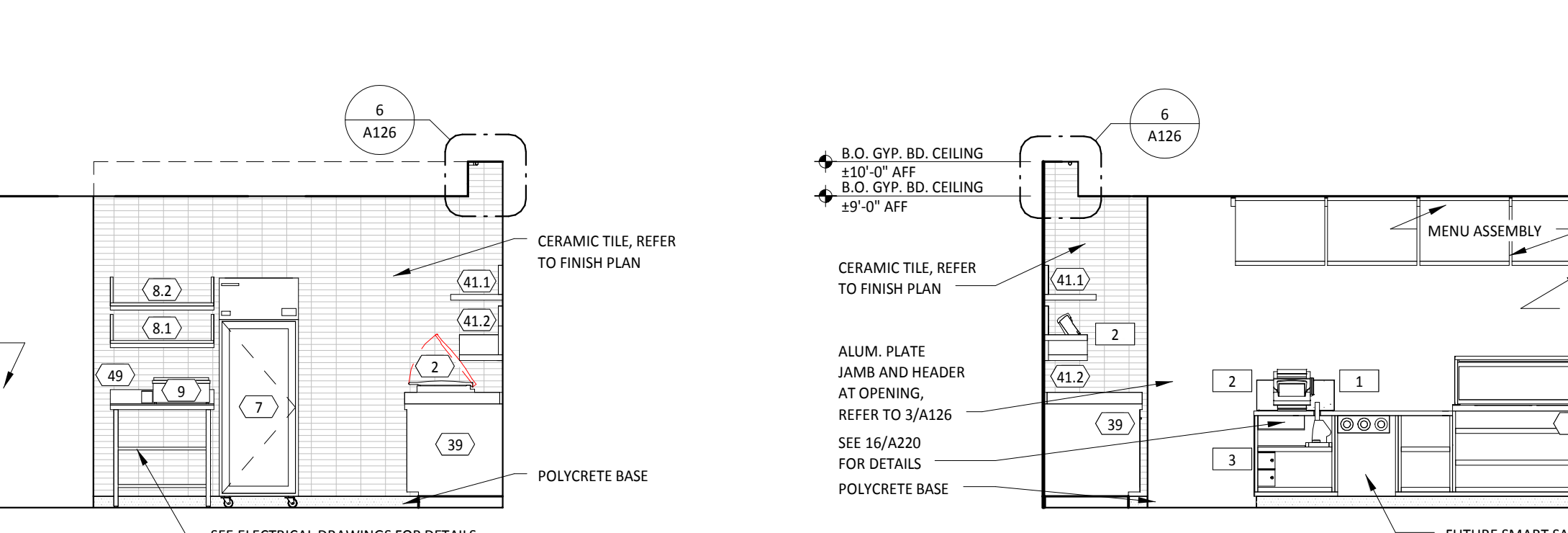

1 INT ELEV - KITCHEN
1/4" = 1'-0"