

FINISH LEGEND

FLOOR FINISHES		WALL BASE FINISHES		WALL FINISHES		CEILING/DECK FINISHES	
LGD. #		LGD. #		LGD. #		LGD. #	
F1	POLISHED CONCRETE	B1	BLACK RUBBER, COVELESS	P1	GYP BD, PAINT MOONLIT SNOW	C1	OPEN TO STRUCTURE
F2	POLY-CRETE RESIN	B2	NOT USED	P2	NOT USED	C2	NOT USED
F3	NOT USED	B3	POLY-CRETE BASE	P3	RICHLITE WAINSCOT	C3	GYP BD, PAINT MOONLIT SNOW
F4	EXTERIOR CONCRETE			P4	NOT USED	C4	2X4 VINYL-FACED LAY-IN
				P5	CERAMIC TILE - HORIZONTAL STACK BOND		
				P6	FIBERGLASS REINFORCED PANELS		
				P7	DIAMOND PLATE TO 48" AFF		
				P8	GYP BD, PAINT AUTUMN RIDGE		
				P9	GYP BD, PAINT TO MATCH DECK		
				P10	STOREFRONT		
				P11	PERFORATED PLYWOOD PANEL		

ROOM FINISH SCHEDULE

ROOM #	ROOM NAME	FLOOR FINISH	BASE FINISH	WALL FINISH	CEILING FINISH	CEILING HEIGHT	REMARKS
100	MAIN ENTRY	F1	B1		C3	±10'-6"	SEE SHEET A210 AND SPECIFICATION SHEETS
101	DINING	F1	B1		C1	STR	SEE SHEET A210 AND SPECIFICATION SHEETS
102	UTENSIL	F1	B1		C1	STR	SEE SHEET A210 AND SPECIFICATION SHEETS
103	PASSAGE	F1	B1/B3		C3	STR	SEE SHEET A210 AND SPECIFICATION SHEETS
104	POS	F2	B3		C3	±9'-0"	SEE SHEET A220 AND SPECIFICATION SHEETS, POLY-CRETE RESIN FINISH TO END FLUSH WITH BACKSIDE OF MAKE WALL
105	ORDERING	F1	B3		C1/C3	STR / ±9'-0"	SEE SHEET A210 AND SPECIFICATION SHEETS
106	SERVING	F2	B3		C3	±9'-0"	SEE SHEET A220 AND SPECIFICATION SHEETS
107	COOKING	F2	B3		C3	±9'-0"	SEE SHEET A220 AND SPECIFICATION SHEETS
108	KITCHEN	F2	B3		C4	10'-0"	SEE SHEET A220 AND SPECIFICATION SHEETS
109	OFFICE	F2	B3		C4	10'-0"	EXTEND SHEATHING TO STRUCTURE
110	COOLER	F2	B3		STR	STR	CEILING HEIGHT & FINISHES PER MANUFACTURER
111	MEN	F2	B3		C3	±7'-7 1/4"	SEE SHEET A230 AND SPECIFICATION SHEETS
112	WOMEN	F2	B3		C3	±7'-7 1/4"	SEE SHEET A230 AND SPECIFICATION SHEETS
113	PATIO	F4					

CODED NOTES

- 1-1/2" X 1-1/2" STAINLESS STEEL CORNER GUARDS
- SCHLUTER-QUADEC METAL CORNER, REFER TO 11 & 12/A126
- ALUMINUM ENDCAP, REFER TO 9/A126
- PROVIDE STAINLESS STEEL ON WALL TO 24" ABOVE TOP OF MOP SINK. FLASH BOTTOM EDGE OVER MOP SINK RIM. BEND STAINLESS STEEL AT INSIDE CORNER SO THERE IS NO JOINT.
- AT ALL LOCATIONS WHERE THE 4-COMP SINK IS AGAINST ANY WALL, PROVIDE STAINLESS STEEL ON WALL TO 4" ABOVE TOP OF 4-COMP SINK BACKSPASH. FLASH BOTTOM EDGE OVER 4-COMP SINK BACKSPASH EDGE, BEND STAINLESS STEEL AT INSIDE CORNER SO THERE IS NO JOINT
- COOLER WALL PANELS AS PROVIDED BY THE COOLER MANUFACTURER HAVE A 26-GAUGE COATED AND EMBOSSED STEEL FINISH.
- G.C. TO PROVIDE 18 GAUGE STAINLESS STEEL SHROUD AROUND EXPOSED LINES AT THE ICE MAKER.
- RICHLITE SILL AND JAMB, REFER TO 3 & 6/A125.

GENERAL NOTES

1. WAINSCOTS PROVIDED BY TMS, INSTALL BY GC
2. PLYWOOD BOX AND PERFORATED PLYWOOD WALL PROVIDED BY TMS, INSTALLED BY GC
3. GC IS RESPONSIBLE FOR SEQUENCING OF PREWIRING WITH COMPLETION OF INTERIOR FINISHES (GYP. BD. FINISHES).

AC PLYWOOD FINISH SCHEDULE

●	CLASS A
○	CLASS C

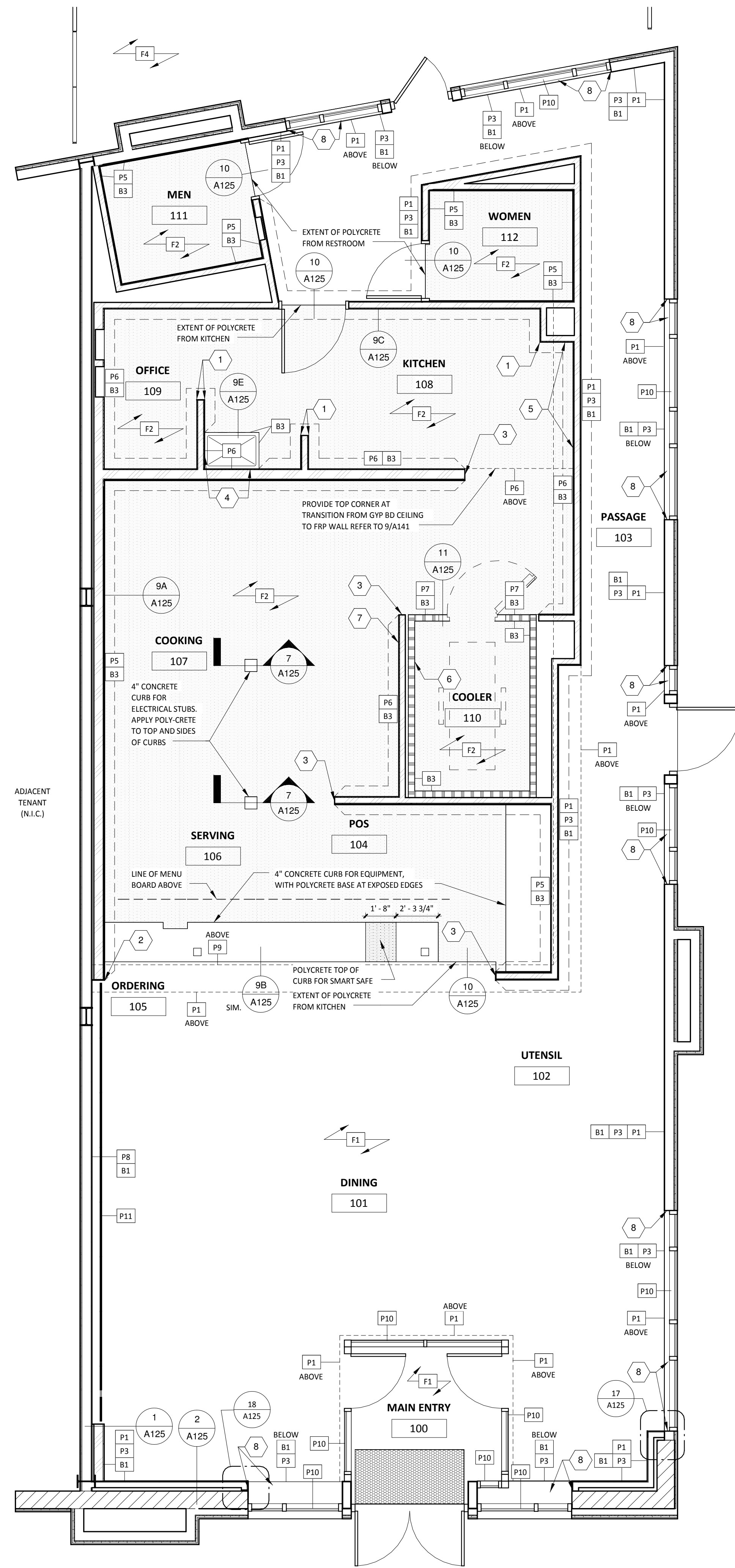

1
A120
FINISH PLAN
1/4" = 1'-0"

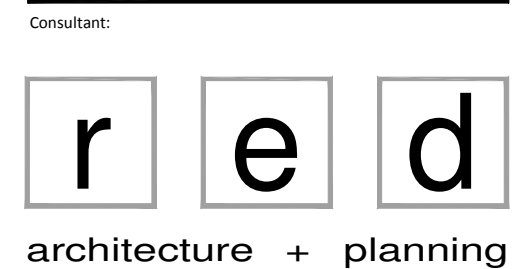

855 GRANDVIEW AVENUE SUITE 295
COLUMBUS, OHIO 43215
PHONE: 614.487.8770
FAX: 614.487.8777



COPYRIGHT 2015
THIS DRAWING IS AN INSTRUMENT OF SERVICE AND AS SUCH
REMAINS THE PROPERTY OF CHIPOTLE MEXICAN GRILL, INC.
PERMISSION FOR USE OF THIS DOCUMENT IS LIMITED AND
CAN BE EXTENDED ONLY BY WRITTEN AGREEMENT WITH
CHIPOTLE MEXICAN GRILL, INC.



CHIPOTLE MEXICAN GRILL, INC.
1401 WYNWOOD STREET, SUITE 500
DENVER, COLORADO 80202
TELEPHONE: (303) 595-4000
FAX: (303) 595-4014
INTERNET: WWW.CHIPOTLE.COM

STORE NO.: 2603
PORTLAND MARGINAL WAY
195 KENNEBEC ST
PORTLAND, ME 04101

Issue Record:
09/15/15 PERMIT/LANDLORD REVIEW

Revisions:

Drawn: TC, BP, DP
Checked: KH, TC

Project No.: CMG507

Contents:
Finish Plan

A120

Date of Last Print: 09/15/15