

SECTION 1
1\"/>

N8x15 SHEAR CONNECTION SHALL BE DESIGNED FOR THE FOLLOWING UNFACTORED LOADS:
DEAD LOAD = 1.7k
SNOW LOAD = 4.8k

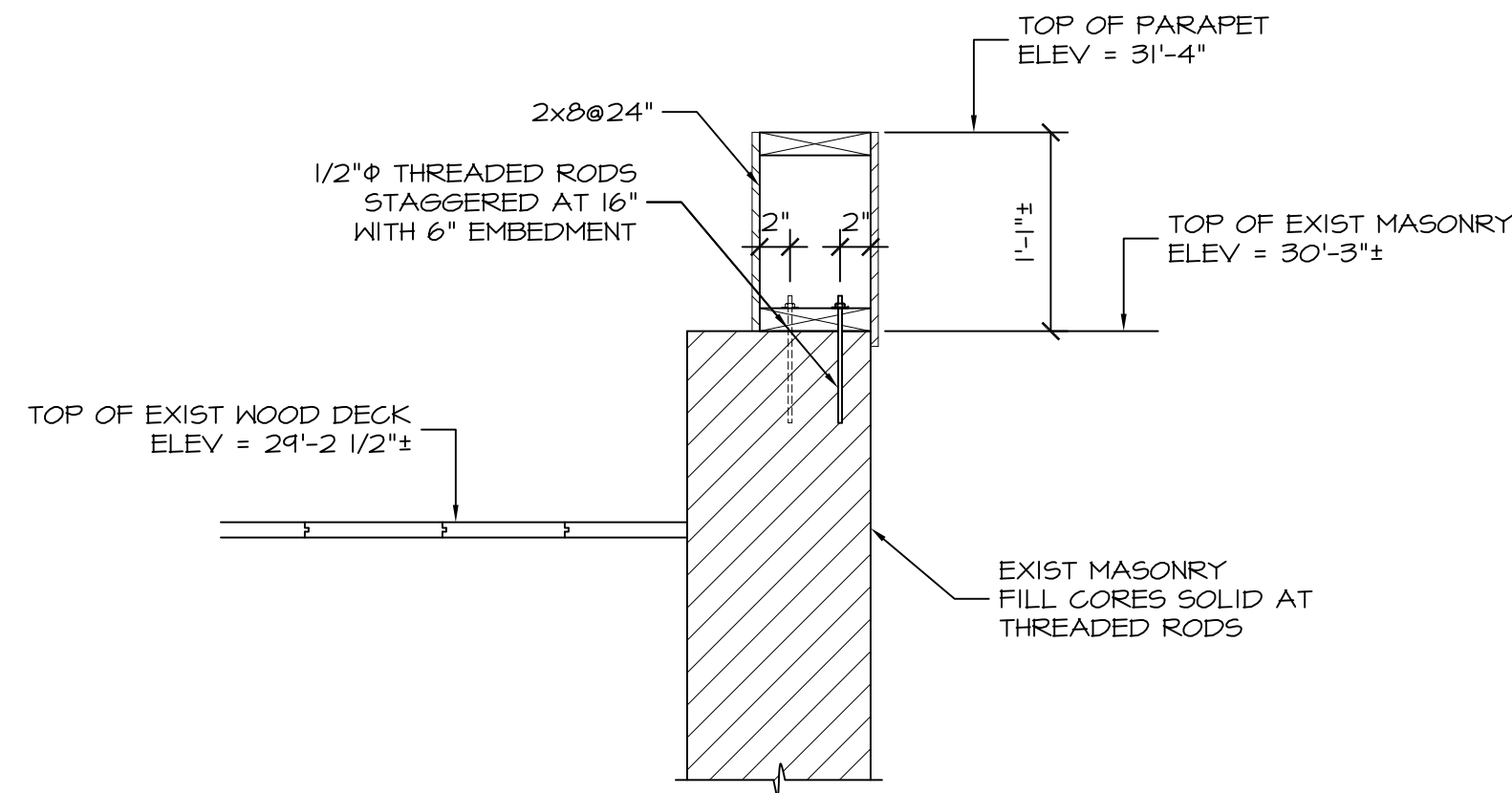

SECTION 2
1\"/>

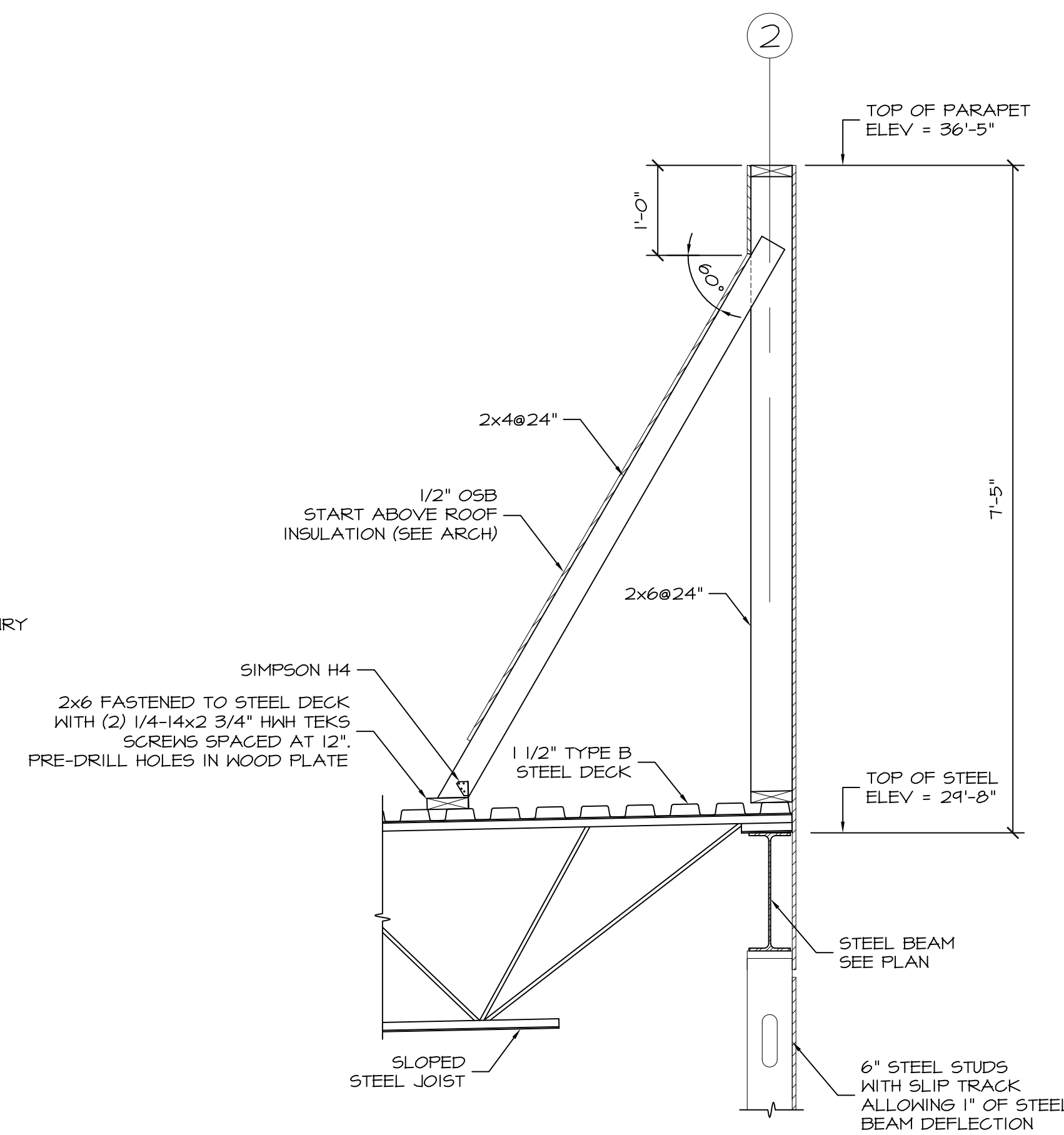

SECTION 3
3/4\"/>

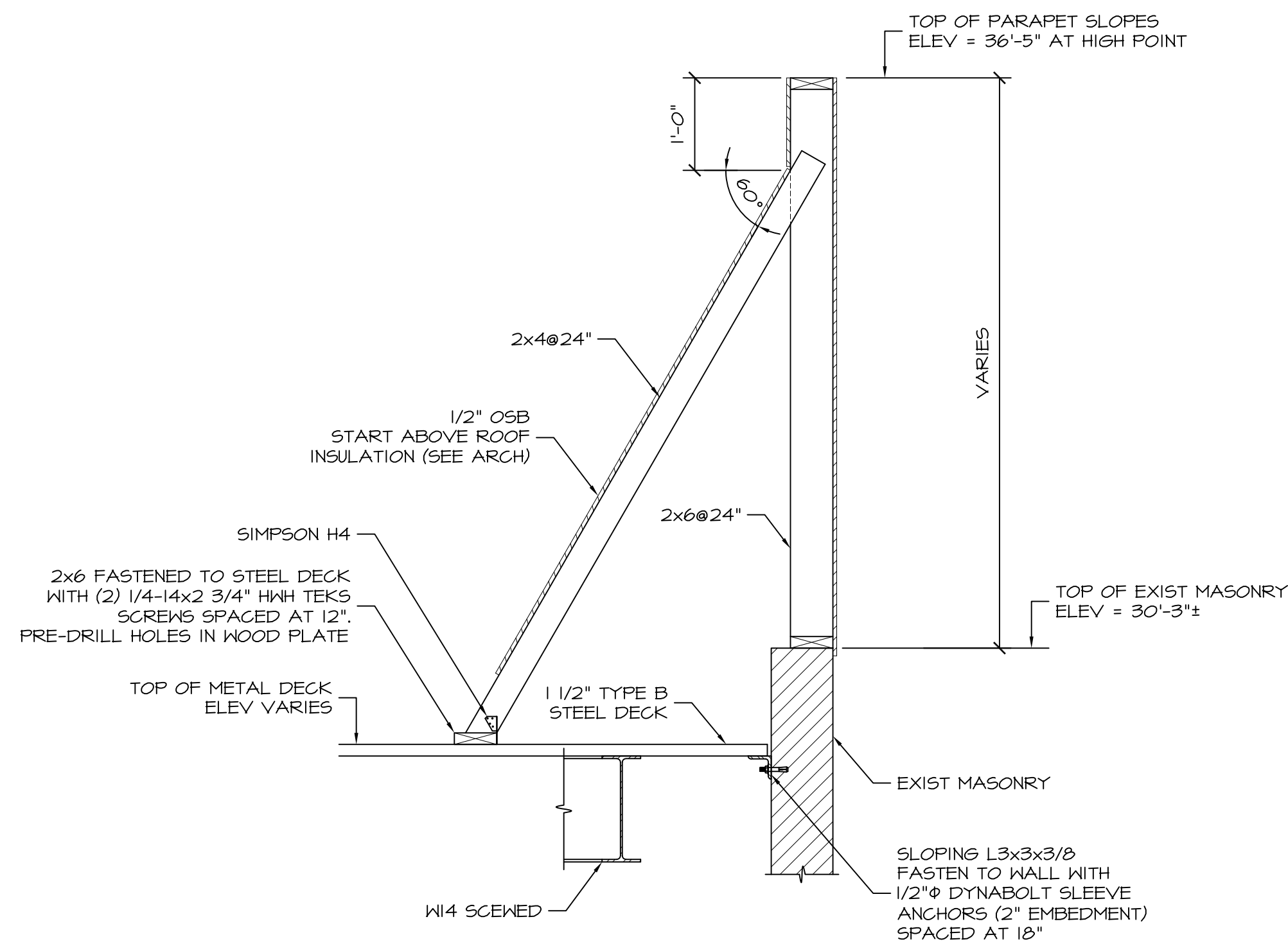

SECTION 4
3/4\"/>

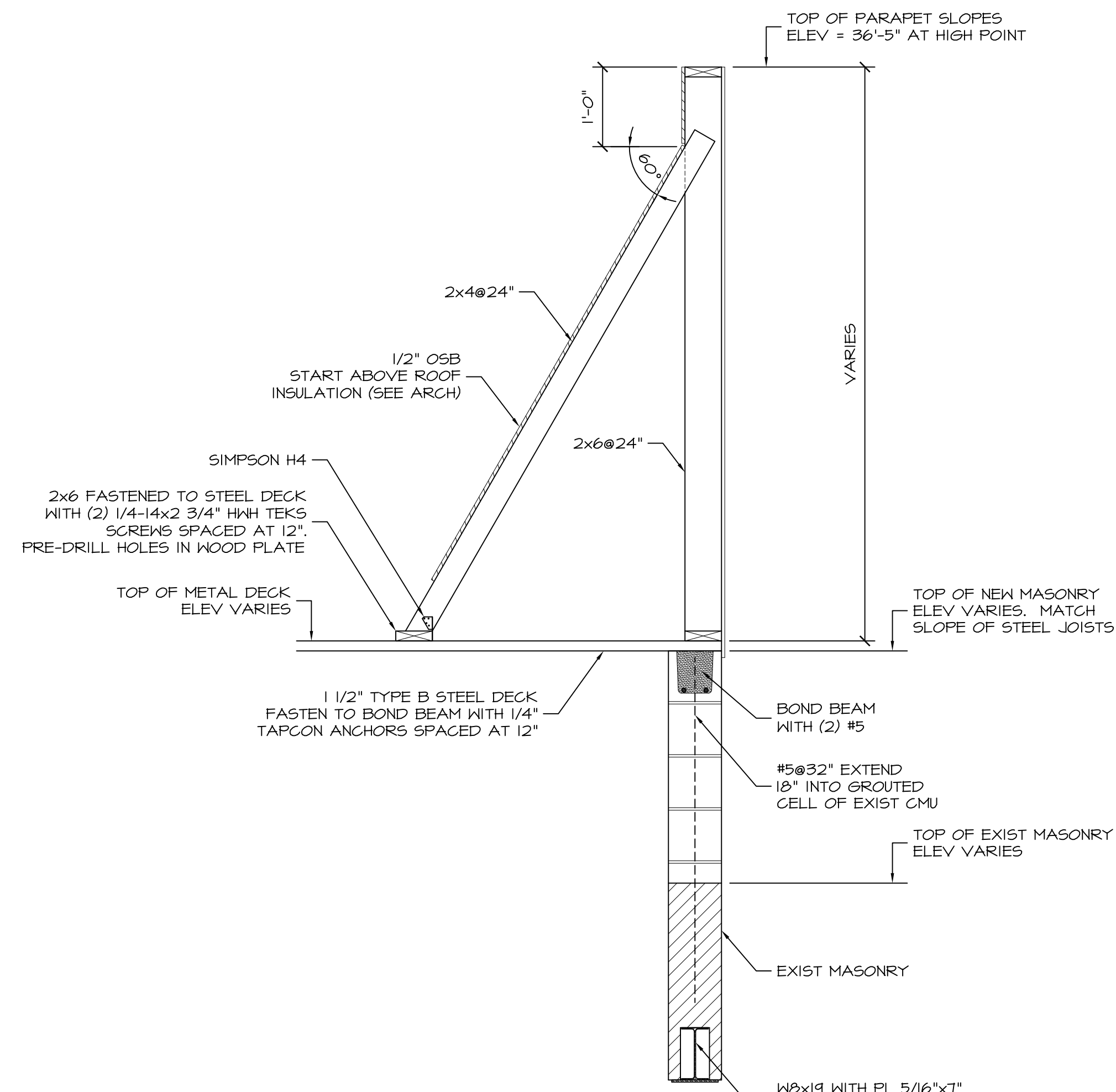

SECTION 5
3/4\"/>

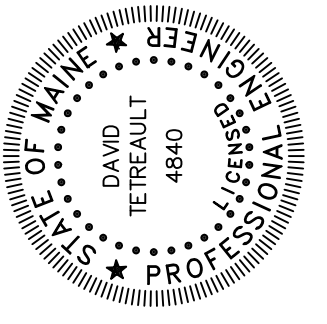

Prepared For:
Northland Enterprises, LLC
ONE CITY CENTER
PORTLAND, MAINE

Structural Engineer:
STRUCTURAL DESIGN CONSULTING
22 Oakmont Drive
Old Orchard Beach, ME 04064-1121
Tel: 207-934-8638
Fax: 207-934-8639

Architect:
ARCHETYPE architects
48 Union Wharf, Portland, Maine 04101
(207) 772-6022 Fax (207) 772-4056

Project:
CENTURY TIRE
815 MARGINAL WAY
PORTLAND, MAINE

Revisions:	Issued for Permit	03/16/15

Date: 16 Mar 15
Scale: As Noted

FRAMING SECTIONS

S4.0