

DISPLAY THIS CARD ON PRINCIPAL FRONTAGE OF WORK CITY OF PORTLAND

Please Read
Application And
Notes, If Any,
Attached

BUILDING DEPARTMENT
PERMIT

<p>PERMIT ISSUED</p> <p>Permit Number: 070757</p> <p>JUL - 9 2007</p> <p>CITY OF PORTLAND</p>
--

This is to certify that ARONSON ADELE & RICHARD LEBLANC TRUSTEES/N Kra
 has permission to Install 3' x 6' freestanding sign
 AT 195 KENNEBEC ST C 034 C00900

provided that the person or persons, firm or corporation accepting this permit shall comply with all of the provisions of the Statutes of Maine and of the ordinances of the City of Portland regulating the construction, maintenance and use of buildings and structures, and of the application on file in this department.

Apply to Public Works for street line and grade if nature of work requires such information.

Notification of inspection must be given and work in progress must be reported before this building or part thereof is closed or closed-in. **HOURLY NOTICE IS REQUIRED.**

A certificate of occupancy must be procured by owner before this building or part thereof is occupied.

OTHER REQUIRED APPROVALS

Fire Dept. _____
 Health Dept. _____
 Appeal Board _____
 Other _____
 Department Name _____

[Signature] 7/9/07
 Director - Building & Inspection Services

PENALTY FOR REMOVING THIS CARD

City of Portland, Maine - Building or Use Permit Application

389 Congress Street, 04101 Tel: (207) 874-8703, Fax: (207) 874-8716

Permit No: 07-0757	Issue Date:	CBL: 034 C009001
-----------------------	-------------	---------------------

Location of Construction: 195 KENNEBEC ST	Owner Name: ARONSON ADELE & RICHARD	Owner Address: 17 BIRKDALE RD	Phone:
Business Name:	Contractor Name: NeoKraft Signs	Contractor Address: 686 Main St. Lewiston	Phone: 2077829654
Lessee/Buyer's Name	Phone:	Permit Type: Signs - Permanent	Zone: B-7

Past Use: Commercial / Century Tire	Proposed Use: Commercial / Century Tire install 3 2' x 6' freestanding signs building	Permit Fee: \$102.00	Cost of Work: \$102.00	CEO District: 1
Proposed Project Description: Install 3' x 6' freestanding signs building		FIRE DEPT: <input type="checkbox"/> Approved <input checked="" type="checkbox"/> Denied Signature: <i>N/A</i>	INSPECTION: Use Group: <i>V</i> Type: <i>Sgt</i> <i>IBC 2003</i> Signature:	
		PEDESTRIAN ACTIVITIES DISTRICT (P.A.D.) Action. <input type="checkbox"/> Approved <input type="checkbox"/> Approved w/Conditions <input type="checkbox"/> Denied Signature: Date:		

Permit Taken By: dmartin	Date Applied For: 06/22/2007	Zoning Approval		
<ol style="list-style-type: none">This permit application does not preclude the Applicant(s) from meeting applicable State and Federal Rules.Building permits do not include plumbing, septic or electrical work.Building permits are void if work is not started within six (6) months of the date of issuance. False information may invalidate a building permit and stop all work..		Special Zone or Reviews <input type="checkbox"/> Shoreland <input type="checkbox"/> Wetland <input type="checkbox"/> Flood Zone <input type="checkbox"/> Subdivision <input type="checkbox"/> Site Plan Maj <input type="checkbox"/> Minor <input type="checkbox"/> MM <input type="checkbox"/> Date: <i>7/3/07</i>	Zoning Appeal <input type="checkbox"/> Variance <input type="checkbox"/> Miscellaneous <input type="checkbox"/> Conditional Use <input type="checkbox"/> Interpretation <input type="checkbox"/> Approved <input type="checkbox"/> Denied Date:	Historic Preservation <input checked="" type="checkbox"/> Not in District or Landmark <input type="checkbox"/> Does Not Require Review <input type="checkbox"/> Requires Review <input type="checkbox"/> Approved <input type="checkbox"/> Approved w/Conditions <input type="checkbox"/> Denied <i>ABM</i> Date:

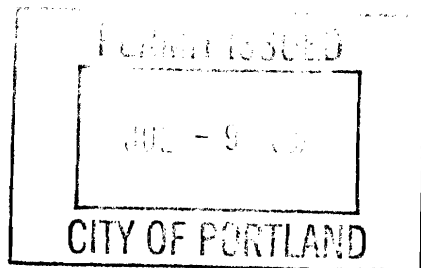
**CERTIFICATION**

I hereby certify that I am the owner of record of the named property, or that the proposed work is authorized by the owner of record and that I have been authorized by the owner to make this application as his authorized agent and I agree to conform to all applicable laws of this jurisdiction. In addition, if a permit for work described in the application is issued, I certify that the code official's authorized representative shall have the authority to enter all areas covered by such permit at any reasonable hour to enforce the provision of the code(s) applicable to such permit.

SIGNATURE OF APPLICANT	ADDRESS	DATE	PHONE
RESPONSIBLE PERSON IN CHARGE OF WORK, TITLE		DATE	PHONE

City of Portland, Maine - Building or Use Permit

389 Congress Street, 04101 Tel: (207) 874-8703, Fax: (207) 874-8716

Permit No: 07-0757	Date Applied For: 06/22/2007	CBL: 034 C009001
------------------------------	--	----------------------------

Location of Construction: 195 KENNEBEC ST	Owner Name: ARONSON ADELE & RICHARD	Owner Address: 17 BIRKDALE RD	Phone:
Business Name:	Contractor Name: NeoKraft Signs	Contractor Address: 686 Main St. Lewiston	Phone (207) 782-9654
Lessee/Buyer's Name	Phone:	Permit Type: Signs - Permanent	

Proposed Use: Commercial / Century Tire install 3 2' x 6' building signs	Proposed Project Description: Install 3' x 6' building signs
--	--

Dept: Zoning **Status:** Approved with Conditions **Reviewer:** Ann Machado **Approval Date:** 07/03/2007**Note:** Signs already legally nonconforming. Replacing one sign with smaller sign. Other replacement signs are same size. **Ok to Issue:** ☒

- 1) This permit is being approved on the basis of plans submitted. Any deviations shall require a separate approval before starting that work.

Dept: Building **Status:** Approved with Conditions **Reviewer:** Tammy Munson **Approval Date:** 07/09/2007**Note:** **Ok to Issue:** ☒

- 1) Signage Installation to comply with Chapter 31 of the IBC 2003 building code.



Signage/Awning Permit Application

If you or the property owner owes real estate or personal property taxes or user charges on any property within the City, payment arrangements must be made before permits of any kind are accepted.

Location/Address of Construction: <u>185 Kennebec Street and 26 Marginal Way</u>		
Tax Assessor's Chart, Block & Lot Chart# Block# Lot#	Owner: <u>Adelle S. Aronson (SSI Trust)</u> <u>17 Birkdale Rd.</u> <u>Falmouth, ME 04105</u>	Telephone: <u>207-797-8515</u>
Lessee/Buyer's Name (If Applicable) <u>Century Tire Company</u>	Contractor name, address & telephone: <u>Neckkraft Signs Inc.</u> <u>686 Main St.</u> <u>Leicester, ME 04240</u> <u>207-782-9654</u>	Total s.f. of signage x \$2.00 Per s.f. plus \$30.00/\$65.00 For H.D. signage= Total Fee: \$ <u>102.00</u> Awning Fee= cost of work Total Fee: \$ <u>102.00</u>
Who should we contact when the permit is ready: <u>Shane Moffett</u> phone: <u>207-782-9654</u>		
Tenant/allocated building space frontage (feet): Length: _____ Height: _____ Lot Frontage (feet): _____ Single Tenant or Multi Tenant Lot: _____		
Current Specific use: <u>Tire Company / Garage</u> If vacant, what was prior use: <u>N/A</u> Proposed Use: <u>Same</u>		
Information on proposed sign(s): Freestanding (e.g., pole) sign? Yes _____ No <input checked="" type="checkbox"/> Dimensions proposed: _____ Height from grade: _____ Bldg. wall sign? (attached to bldg) Yes <input checked="" type="checkbox"/> No _____ Dimensions proposed: <u>(3) 2'x6' signs</u>		
Proposed awning? Yes _____ No <input checked="" type="checkbox"/> Is awning backlit? Yes _____ No _____ Height of awning: _____ Length of awning: _____ Depth: _____ Is there any communication, message, trademark or symbol on it? Yes _____ No _____ If yes, total s.f. of panels w/communications, message, trademark or symbol: _____ s.f.		
Information on existing and previously permitted sign(s): Freestanding (e.g., pole) sign? Yes <input checked="" type="checkbox"/> No _____ Dimensions: _____ Bldg. wall sign? (attached to bldg) Yes <input checked="" type="checkbox"/> No _____ Dimensions: _____ Awning? Yes _____ No <input checked="" type="checkbox"/> Sq. ft. area of awning w/communication: _____		
A site sketch and building sketch showing exactly where existing and new signage is located must be provided. Sketches and/or pictures of proposed signage and existing building are also required.		

Please submit all of the information outlined in the Sign/Awning Application Checklist.
Failure to do so may result in the automatic denial of your permit.

In order to be sure the City fully understands the full scope of the project, the Planning and Development Department may request additional information prior to the issuance of a permit. For further information visit us on-line at www.portlandmaine.gov, stop by the Building Inspections office, room 315 City Hall or call 874-8703.

I hereby certify that I am the Owner of record of the named property, or that the owner of record authorizes the proposed work and that I have been authorized by the owner to make this application as his/her authorized agent. I agree to conform to all applicable laws of this jurisdiction. In addition, if a permit for work described in this application is issued, I certify that the Code Official's authorized representative shall have the authority to enter all areas covered by this permit at any reasonable hour to enforce the provisions of the codes applicable to this permit.

Signature of applicant: Shane Moffett

Date: 6/19/07

This is not a permit; you may not commence ANY work until the permit is issued.

B7 - one 2x6 replacing existing 2x10 sign - so smaller.
two signs replacing each 2x6 - replacing one 4x6 - same size.

Plot Plan

Dualite

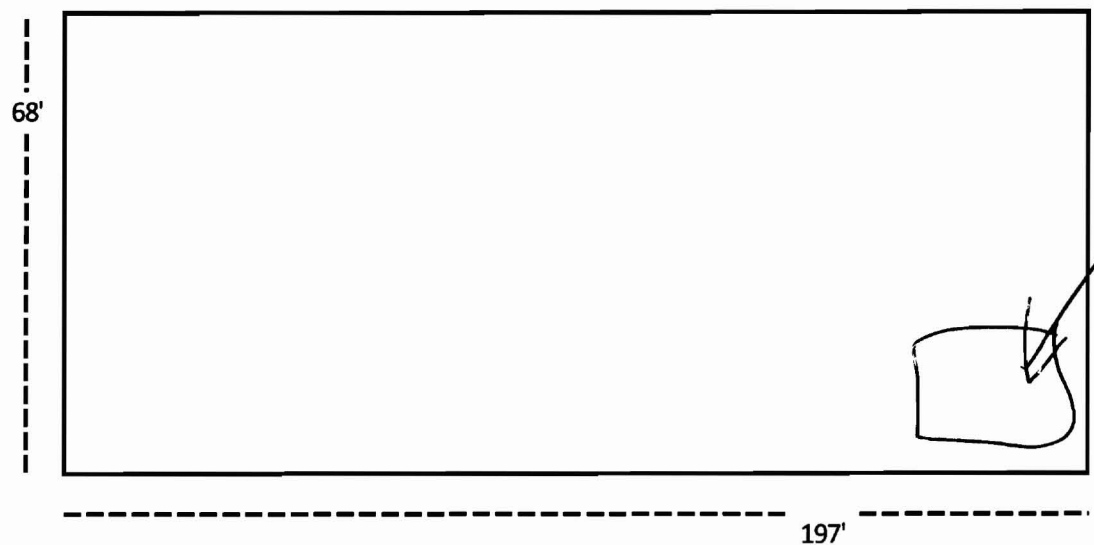

E12

#185

Kennebec St.

185 Kennel Street

Wall Sign

Dualite

E9, E10 (N1),
E11

Description	Bridgestone, Lee Tires, Nokian
Sign t idth	10' ea
Sign , eight	2' ea
Overall ,e ight	11',9',7'
Visual Opening Width	9'10" ea
Visual Opening Height	1'10" ea
Retainer t idth	1" ea
Cabinet Depth	4" ea
Manufacturer	N/A
Sign Material	Flat plastic
Location	Front
Notes	Mounted on siding



Existing signs

185 Kennebec Street

Century Tire Company
185 Kennebec St.
Portland, ME



Appearance Rating (1-5)

2



Dualite Sales & Service, Inc.
WILLIAMSBURG, OHIO • CEDAR HILL, TEXAS

Dualite Sales & Service, Inc.
One Dualite Lane
Williamsburg, Ohio 45176

Existing Signs and Specs.

Plot Plan

Dualite

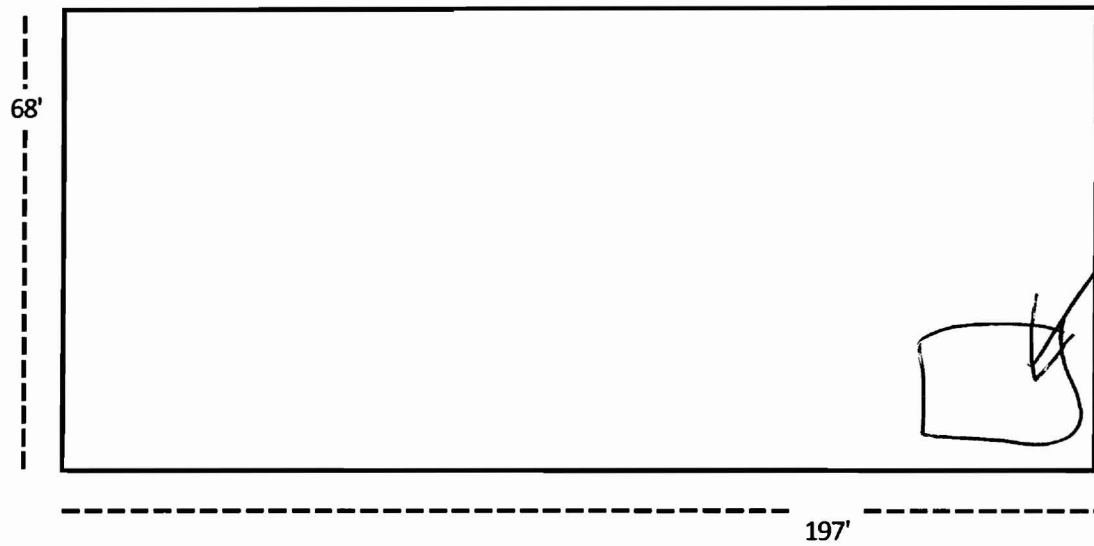

E12

#185

Kennebec St.

Building Elevations



Front Elevation

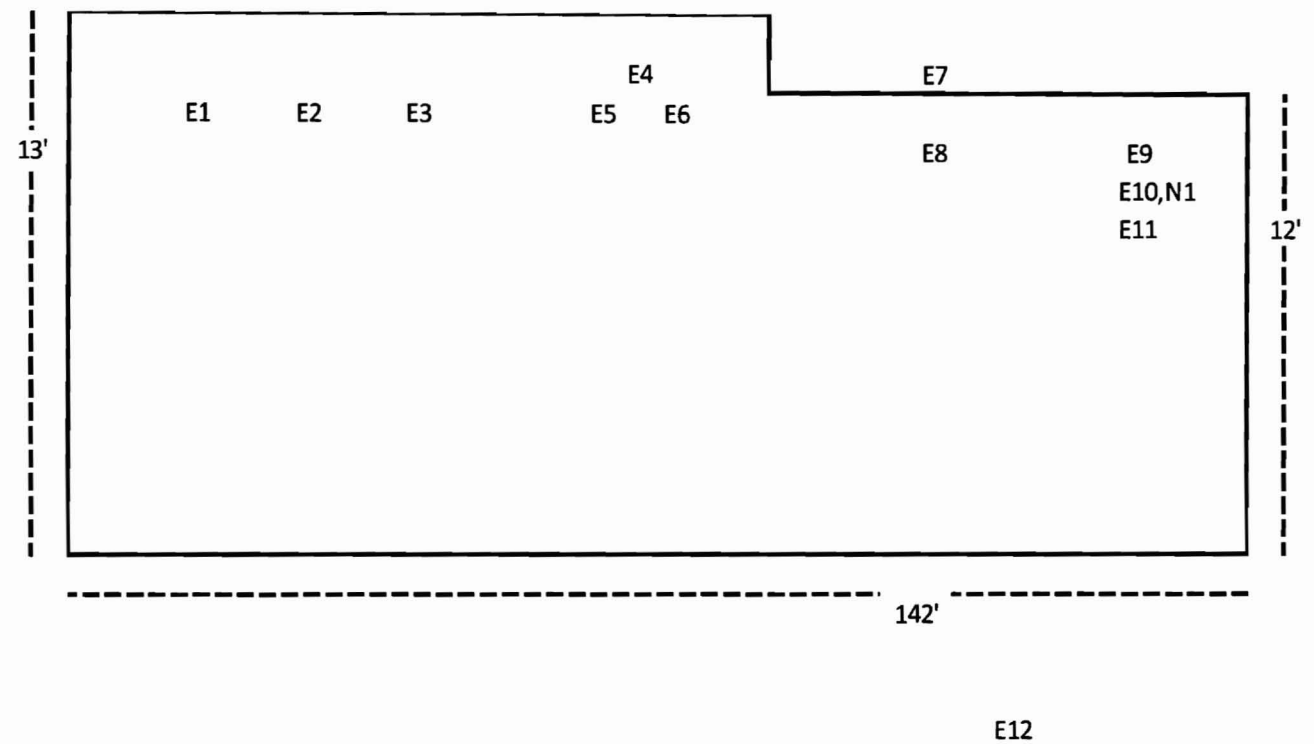

Roof Sign

Dualite

E7

Description	Fires(t)one
Sign t idth	25'
Sign , eight	2' est
Overall Height	14' est
Visual Opening Width	N/A
Visual Opening Height	N/A
Retainer Width	N/A
Cabinet Depth	N/A
Manufacturer	N/A
Sign Material	Plastic channel letters
Location	Front
Notes	Mounted on roof



Wall Sign

Dualite

E8

Description	Century tire co.
Sign t idth	7'
Sign , eight	3'
Overall Height	11 ½ '
Visual Opening Width	N/A
Visual Opening Height	N/A
Retainer Width	N/A
Cabinet Depth	3"
Manufacturer	N/A
Sign Material	Plastic channel letters
Location	Front
Notes	Mounted on siding



Wall Sign



E9, E10 (N1),
E11

Description	Bridgestone, Lee Tires, Nokian
Sign t idth	10' ea
Sign , eight	2' ea
Overall ,e ight	11',9',7'
Visual Opening Width	9'10" ea
Visual Opening Height	1'10" ea
Retainer t idth	1" ea
Cabinet Depth	4" ea
Manufacturer	N/A
Sign Material	Flat plastic
Location	Front
Notes	Mounted on siding



← replace



Wall Sign

Dualite

E1, E2, E3

Description	Tune-up, Alignment, Batteries
Sign t idth	8'
Sign , eigh	1"
Overall ,e ight	12'
Visual Opening Width	N/A
Visual Opening Height	N/A
Retainer Width	N/A
Cabinet Depth	N/A
Manufacturer	N/A
Sign Material	Flat plastic
Location	Front
Notes	Mounted on painted brick



Wall Sign

Dualite

E4

Description	Century Tire Co
Sign t idth	26'
Sign , eight	2'
Overall Height	13'
Visual Opening Width	N/A
Visual Opening Height	N/A
Retainer Width	N/A
Cabinet Depth	N/A
Manufacturer	N/A
Sign Material	Plastic channel letters
Location	Front
Notes	Mounted on painted brick



Wall Sign

Dualite

E5, E6

Description	Brake Service, Tires
Sign t idth	8'
Sign , eight	1'
Overall Height	12'
Visual Opening Width	N/A
Visual Opening Height	N/A
Retainer Width	N/A
Cabinet Depth	N/A
Manufacturer	N/A
Sign Material	Flat plastic
Location	Front
Notes	Mounted on painted brick



Freestanding Sign



E 12

Description	Firestone/ Century Tire Co.
Sign t idth	12' ea
Sign , eight	3' / 1'
Overall Height	14'
Visual Opening Width	11'10" ea
Visual Opening Height	2'10" / 10"
Retainer t idth	1"
Cabinet Depth	5"
Manufacturer	N/A
Sign Material	Panned plastic
Location	Front
Notes	Single pole mount

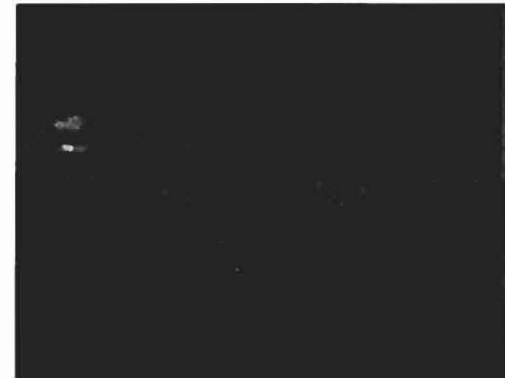

Photos

Dualite

185

Front Left



Front



Right



Rear



Rear



E12 pole



Plot Plan

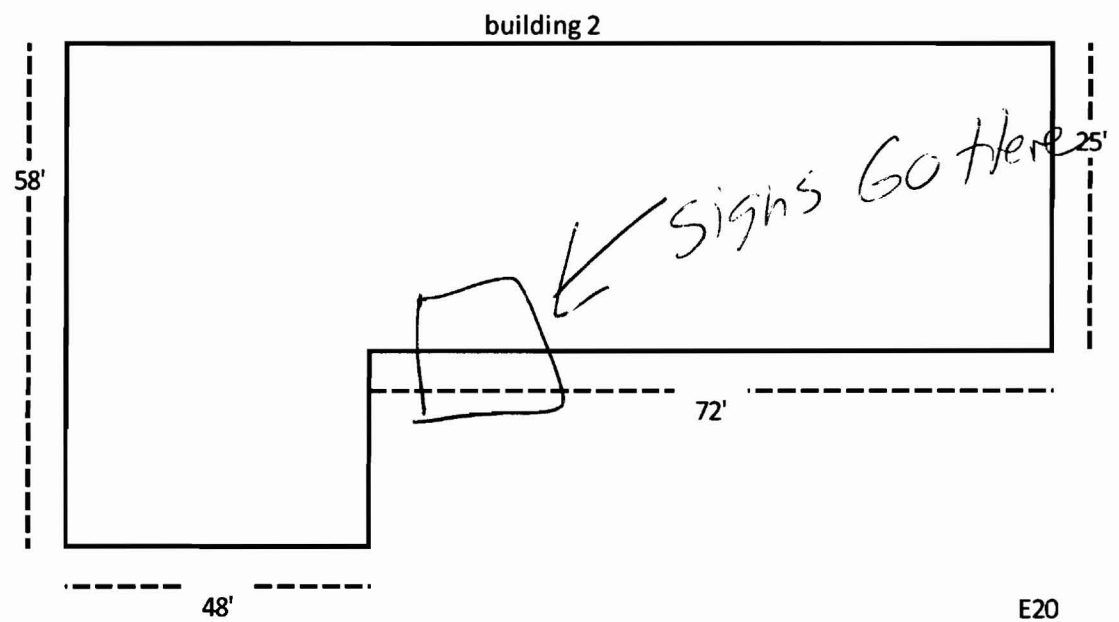

#26 Marginal Way

26 Marginal Way

Wall Sign



E17 (N2)

6'x4=24'

Description	Lee Tires
Sign t idth	6'
Sign Height	4'
Overall Height	13'
Visual Opening Width	5'10"
Visual Opening Height	3'10"
Retainer t idth	1"
Cabinet Depth	4"
Manufacturer	N/A
Sign Material	Panned plastic
Location	Front
Notes	Mounted on painted brick

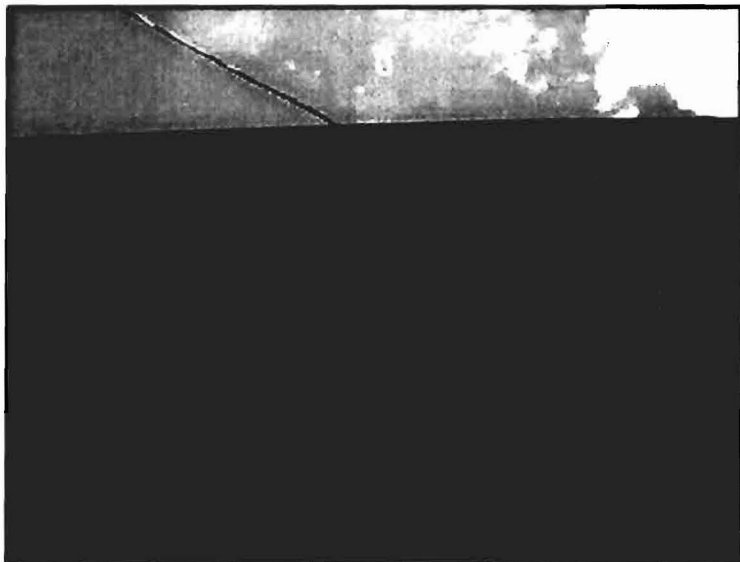

Existing Sign

26 Marginal Way

Century Tire Company

137 Marginal St

Portland, ME

(building 2)

Dualite



Appearance Rating (1-5)

2



Dualite Sales & Service, Inc.

WILLIAMSBURG, OHIO • CEDAR HILL, TEXAS

Dualite Sales & Service, Inc.

One Dualite Lane

Williamsburg, Ohio 45176

Existing Signs and Specs.

Plot Plan

Dualite

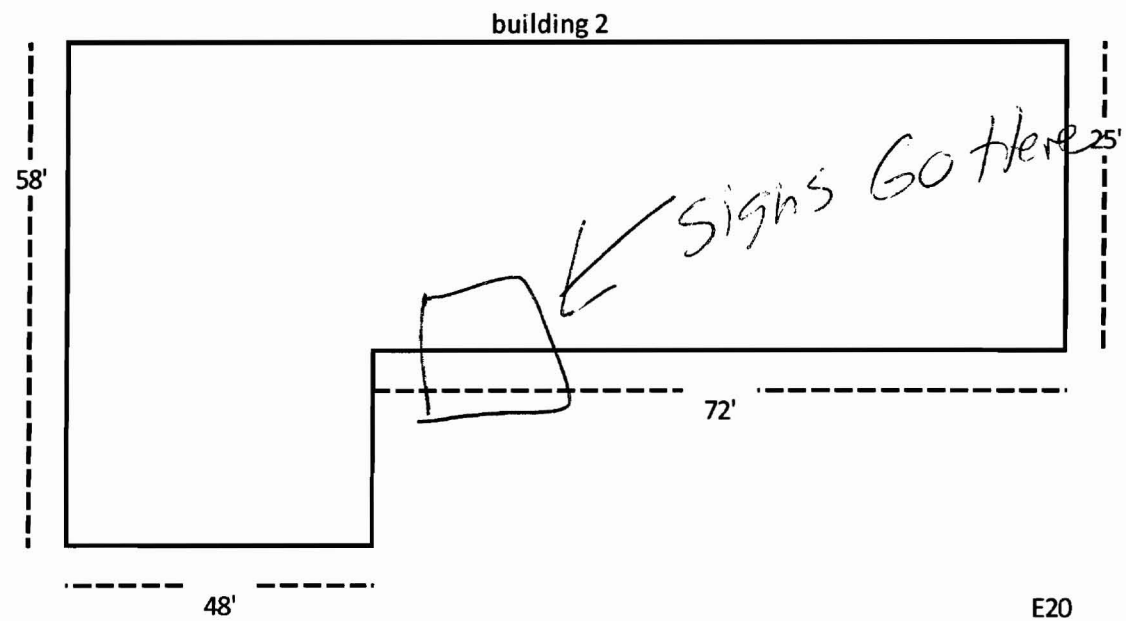

#26 Marginal Way

Building Elevations



Front Elevation

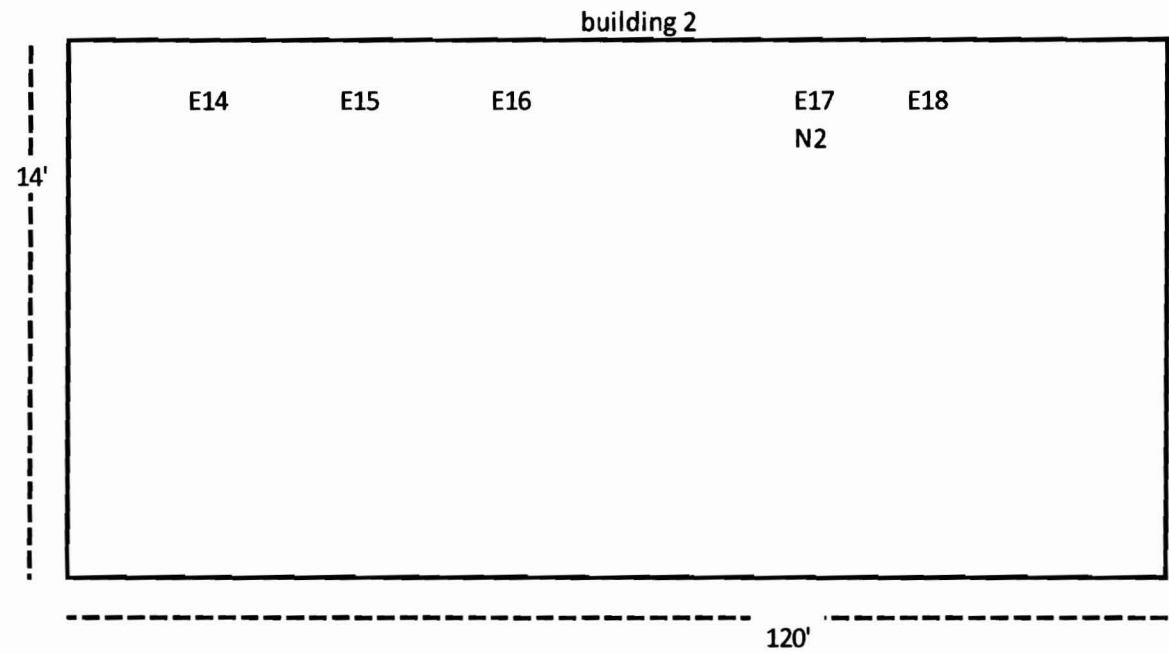

Left Elevation

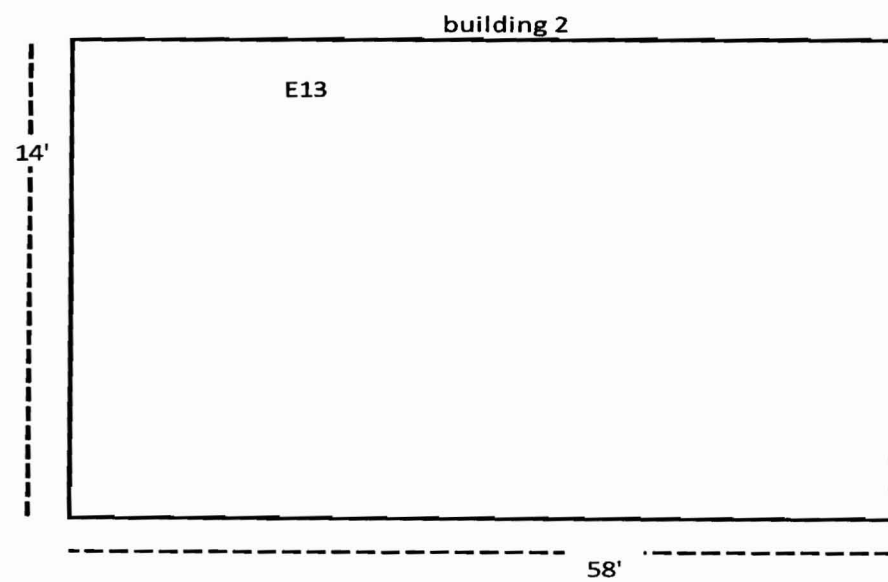

Building Elevations



Right Elevation

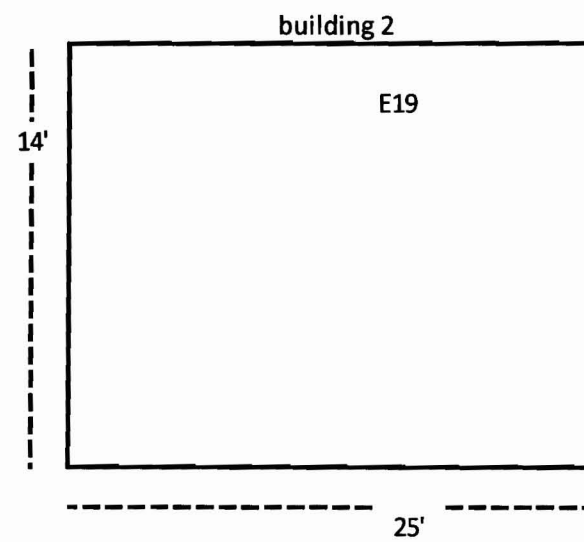

Wall Sign

Dualite

E13

Description	Brake Service
Sign t idth	8'
Sign , eight	1'
Overall Height	13'
Visual Opening Width	N/A
Visual Opening Height	N/A
Retainer Width	N/A
Cabinet Depth	N/A
Manufacturer	N/A
Sign Material	Flat plastic
Location	Left
Notes	Mounted on painted brick



Wall Sign



E14

Description	Batteries
Sign t idth	8'
Sign , eight	1'
Overall Height	13'
Visual Opening Width	N/A
Visual Opening Height	N/A
Retainer Width	N/A
Cabinet Depth	N/A
Manufacturer	N/A
Sign Material	Flat plastic
Location	Front
Notes	Mounted on painted brick

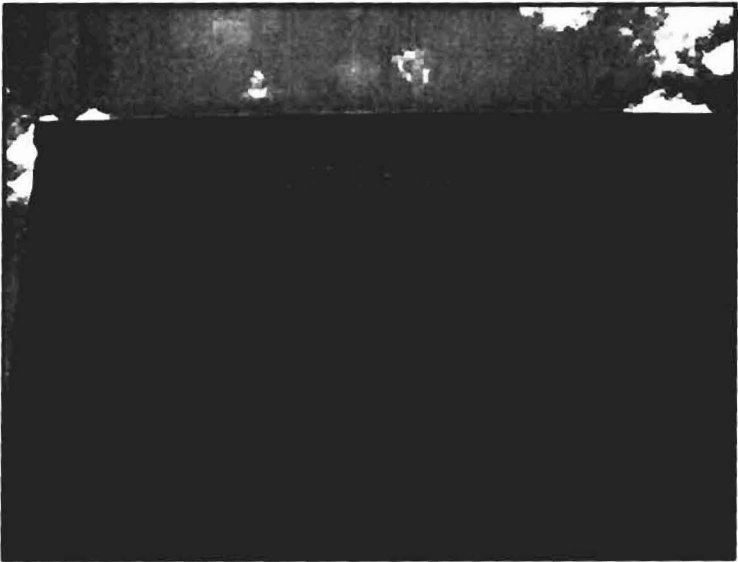

Wall Sign



E15

Description	Tune-up
Sign t idth	8'
Sign , eight	1'
Overall Height	13'
Visual Opening Width	N/A
Visual Opening Height	N/A
Retainer Width	N/A
Cabinet Depth	N/A
Manufacturer	N/A
Sign Material	Flat plastic
Location	Front
Notes	Mounted on painted brick



Wall Sign

Dualite

E16

Description	Bridgestone
Sign t idth	10'
Sign , eight	2'
Overall Height	13'
Visual Opening Width	9'10"
Visual Opening Height	1'10"
Retainer t idth	1"
Cabinet Depth	4"
Manufacturer	N/A
Sign Material	Panned plastic
Location	Front
Notes	Mounted on painted brick





JUNE 19, 2007
MICHELIN
PORTLAND, ME

2 x 6 S.F. SIGN @ 14' O.A.N. ASCE 7-98

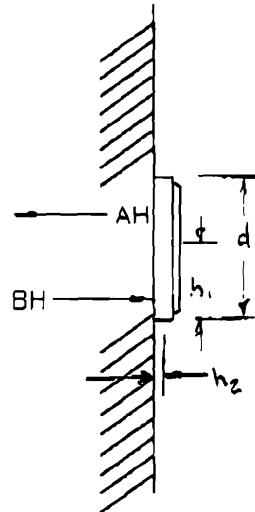

DESIGN WIND SPEED = 110 MPH; EXPOSURE C

$V_f = 110$; $DL = 60$; $K_z = 0.85$; $K_{zt} = 1.0$; $K_d = 0.85$

$C_f = 1.2$; $G_{ge} = 0.85$; $I = 1.0$

$q_z = [0.00256 \cdot K_z \cdot K_{zt} \cdot K_d \cdot V_f^2 \cdot I] = 22.4 \text{ PSF}$

$P_w = q_z \cdot G_{ge} \cdot C_f = 22.9 \text{ PSF}$

$P_{wL} = 22.9 \cdot 12 = 274.8 \text{ lbs}$

$AH = \frac{P_{wL} \cdot h_1 + DL \cdot h_2}{d} = \frac{274.8 \cdot 12 + 60 \cdot 2.5}{24} = 143.7 \text{ lbs}$

$BH = AH - P_{wL} = -13.2 \text{ lbs}$

$143.7 \div 2 \text{ BOLTS} = 71.85 \text{ lbs/BOLT}$

$\frac{71.9}{0.1104} = 651.3 \text{ PSI} < 20 \text{ KSI ALLOWABLE} \quad \underline{\underline{OK}}$

Letter of Authorization

This letter authorizes a representative of **Neokraft Signs** to secure permits to perform sign installations, removals or any sign maintenance necessary at our property located at:

Century Tire Company
26 Marginal
Portland ME 04101

and

185 Kennebec St
Portland ME 04101

Property Owner : ADELE S ARONSON GST TRUST

Address: 17 BIRKDALE RD. FALMOUTH, ME 04105

Phone: 207-792-5756 Fax: 207-797-8515

Tax Folio Number: 034-C-009-001

Adele S. Aronson

Owner's Signature

ACORD CERTIFICATE OF LIABILITY INSURANCE		DATE (MM/DD/YYYY) 06/06/2007
PRODUCER (603)742-1616 FAX (603)749-6884 The Richardson Group 34 Dover Point Rd. Dover, NH 03820-4687		THIS CERTIFICATE IS ISSUED AS A MATTER OF INFORMATION ONLY AND CONFERS NO RIGHTS UPON THE CERTIFICATE HOLDER. THIS CERTIFICATE DOES NOT AMEND, EXTEND OR ALTER THE COVERAGE AFFORDED BY THE POLICIES BELOW.
INSURED Century Tire Co. P.O. Box 1318 Portland, ME 04104		INSURERS AFFORDING COVERAGE INSURER A: Harleysville Worcester Ins Co 116 INSURER B: INSURER C: INSURER D: INSURER E:

COVERAGES

THE POLICIES OF INSURANCE LISTED BELOW HAVE BEEN ISSUED TO THE INSURED NAMED ABOVE FOR THE POLICY PERIOD INDICATED. NOTWITHSTANDING ANY REQUIREMENT, TERM OR CONDITION OF ANY CONTRACT OR OTHER DOCUMENT WITH RESPECT TO WHICH THIS CERTIFICATE MAY BE ISSUED OR MAY PERTAIN, THE INSURANCE AFFORDED BY THE POLICIES DESCRIBED HEREIN IS SUBJECT TO ALL THE TERMS, EXCLUSIONS AND CONDITIONS OF SUCH POLICIES. AGGREGATE LIMITS SHOWN MAY HAVE BEEN REDUCED BY PAID CLAIMS.

INSR ADD'L LTR INSRD	TYPE OF INSURANCE	POLICY NUMBER	POLICY EFFECTIVE DATE (MM/DD/YY)	POLICY EXPIRATION DATE (MM/DD/YY)	LIMITS
	GENERAL LIABILITY <input type="checkbox"/> COMMERCIAL GENERAL LIABILITY <input type="checkbox"/> CLAIMS MADE <input type="checkbox"/> OCCUR GEN'L AGGREGATE LIMIT APPLIES PER: <input type="checkbox"/> POLICY <input type="checkbox"/> PRO- JECT <input type="checkbox"/> LOC				EACH OCCURRENCE \$ DAMAGE TO RENTED PREMISES (Per occurrence) \$ MED EXP (Any one person) \$ PERSONAL & ADV INJURY \$ GENERAL AGGREGATE \$ PRODUCTS - COMP/OP AGG \$
	AUTOMOBILE LIABILITY <input type="checkbox"/> ANY AUTO <input type="checkbox"/> ALL OWNED AUTOS <input type="checkbox"/> SCHEDULED AUTOS <input type="checkbox"/> HIRED AUTOS <input type="checkbox"/> NON-OWNED AUTOS				COMBINED SINGLE LIMIT (Ea accident) \$ BODILY INJURY (Per person) \$ BODILY INJURY (Per accident) \$ PROPERTY DAMAGE (Per accident) \$
A	GARAGE LIABILITY <input checked="" type="checkbox"/> ANY AUTO	G05J2010	08/07/2006	08/07/2007	AUTO ONLY - EA ACCIDENT \$ 1,000,000 OTHER THAN EA ACC \$ 1,000,000 AUTO ONLY: AGG \$ 3,000,000
	EXCESS/UMBRELLA LIABILITY <input type="checkbox"/> OCCUR <input type="checkbox"/> CLAIMS MADE <input type="checkbox"/> DEDUCTIBLE RETENTION \$				EACH OCCURRENCE \$ AGGREGATE \$ \$ \$ \$
	WORKERS COMPENSATION AND EMPLOYERS' LIABILITY ANY PROPRIETOR/PARTNER/EXECUTIVE OFFICER/OWNER EXCLUDED? If yes, describe under SPECIAL PROVISIONS below OTHER				WC STATU- TORY LIMITS <input type="checkbox"/> OTH- ER <input type="checkbox"/> E.L. EACH ACCIDENT \$ E.L. DISEASE - EA EMPLOYEE \$ E.L. DISEASE - POLICY LIMIT \$

DESCRIPTION OF OPERATIONS / LOCATIONS / VEHICLES / EXCLUSIONS ADDED BY ENDORSEMENT / SPECIAL PROVISIONS
The City of Portland is named as additional insured under garage liability as respects signs installed at the following insured locations:
1) R185 Kennebec Street, Portland, ME
2) 26 Marginal Way, Portland, ME

CERTIFICATE HOLDER

City of Portland
389 Congress Street
Portland, ME 04101

CANCELLATION

SHOULD ANY OF THE ABOVE DESCRIBED POLICIES BE CANCELLED BEFORE THE EXPIRATION DATE THEREOF, THE ISSUING INSURER WILL ENDEAVOR TO MAIL 10 DAYS WRITTEN NOTICE TO THE CERTIFICATE HOLDER NAMED TO THE LEFT, BUT FAILURE TO MAIL SUCH NOTICE SHALL IMPOSE NO OBLIGATION OR LIABILITY OF ANY KIND UPON THE INSURER, ITS AGENTS OR REPRESENTATIVES.

AUTHORIZED REPRESENTATIVE



City of Portland GIS Viewer
HELP

100,000

Quick Tools: Select Quick Tool

Select Property by:

Address

Account Number

CBL

SWITCH TO LEGEND LAYERS

- ☒ All Layers
- ☐ ☒ House Number
- ☐ ☐ Major Roads
- ☐ ☐ Interstate
- ☐ ☐ Unit Lines
- ☐ Utilities
- ☐ ☐ Streets
- ☐ ☒ Parcels
- ☐ ☐ Buildings
- ☐ ☐ Travelled Ways
- ☐ ☐ Stream
- ☐ ☐ Wetland
- ☐ ☐ Lake/Pond
- ☐ ☐ Jetport
- ☐ ☐ Neighborhoods
- ☐ ☐ Open Space
- ☐ ☐ FEMA Flood Zones
- ☐ ☐ Zoning
- ☐ Historic
- ☐ Political Districts
- ☐ School Districts
- ☐ ☐ Assessor Chart
- ☐ Topography
- ☐ Photos 2006 (peninsula)
- ☐ Photos 2006
- ☐ Photos 2001

Refresh Map

☒ Auto Refresh

Help:

- A closed group, click to open.
- An open group, click to close.
- A map layer.
- A hidden group/layer, click to make visible.
- ☒ A visible group/layer, click to hide.
- A visible layer, but not at this scale.
- ☒ A partially visible group, click to make visible.
- ☐ An inactive layer, click to make active.
- ☒ The active layer.

Parcels						
Rec	CBL	FULLCBL	ACCT_NBR	PROP_LOC	OWNER_NAME1	
1	034 C009	034 C009001	5172	195 KENNEBEC ST	ARONSON ADELE &	RICHAR



Signage/Awning Permit Application Checklist

All of the following information is required and must be submitted. Checking off each item as you prepare your application package will ensure your package is complete and will help to expedite the permitting process.

- ☒ Certificate of Liability listing the City as additional insured if any portion of the sign abuts or encroaches on any public right of way, or can fall into any public right of way.
- ☒ Letter of permission from the owner indicating the permissions granted and the tenant/space building frontage.
- ☐ A sketch plan of lot indicating location of buildings, driveways and any abutting streets or rights of way, lengths of building frontages, street frontages and all existing setbacks. Please indicate on the plan all existing and proposed signs with their dimensions and specific locations. Be sure to include distance from the ground and building façade dimensions for any signage attached to the building.
- ☒ A sketch or photo of any proposed sign(s) indicating content, dimensions, materials, source of illumination, construction method as well as specifics of installation/attachment.
- ☒ Certificate of flammability required for awning or canopy.
- ☒ A UL# is required for lighted signs at the time of final inspection.
- ☒ Pre-application questionnaire completed and attached.
- ☐ Photos of existing signage
- ☒ Details for sign fastening, attachment or mounting in the ground.

Permit fee for signage or awning-with-signage: \$30.00 plus \$2.00 per square foot of sign.

Permit fee for awning-without-signage is based on cost of work:
\$30.00 for the first \$1,000.00, \$9.00 per additional \$1,000.00 of cost.

Base application fee for any Historic District signage is \$65.00.

MICHELIN 3 - 2'-0" x 6'-0 1/2" SF-WM Illuminated logo

1 SF-WM & 1 DF-CP

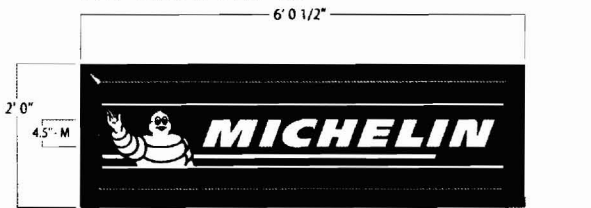

2' 0" x 6' 0 1/2" • 1/4" Deep Embossing - Bib Man & MICHELIN
• 1/8" Deep Embossing - Yellow Stripe
Pantone Reflex Blue, Pantone Process Yellow, Black & White (2nd surface printing)
Face Material Non-Yellowing Solar Grade • Black Retainer and Cabinet



2' x 6' 0 1/2" • 1/4" Deep Embossing - BFGoodrich & underline
Pantone 485 Red, Pantone 288 Blue & White (2nd surface printing)
Face Material Non-Yellowing Solar Grade • Black Retainer and Cabinet



2' x 6' 0 1/2" • 1/4" Deep Embossing - UNIROYAL & Bookends
Pantone 032 Red, Black & White (2nd surface printing)
Face Material Non-Yellowing Solar Grade • Black Retainer and Cabinet

#1194529 Portland, ME



Replacing existing 2'x10' Signs



Replacing existing 4'x6' Lee Tire

Note: Dimensions are Approximate and Subject to Change Pending Review by Dualite Engineering.

 Dualite Sales & Service, Inc. WILLIAMSBURG, OHIO • CEDAR HILL, TEXAS	Dualite Sales & Service, Inc. One Dualite Lane Williamsburg, Ohio 45176	Sketch No. 07-5-245 MI600 KVF		Customer Approval or Comments:
		Scale: 3/8" = 1' 0"	Date: 5-30-07	
This design is exclusive property of Dualite Sales & Service, Inc. • 1 Dualite Lane • Williamsburg, OH 45176 • Copyright 2007 Dualite Sales & S Reproduction of this proprietary work without the permission of Dualite Sales & Service, Inc. will subject the user to liability under the copyright statutes of ti				