

Ⓢ ceiling drop: provide junction box in ceiling compatible with work station pwr and data feed (2 required)

see notes sheet A3

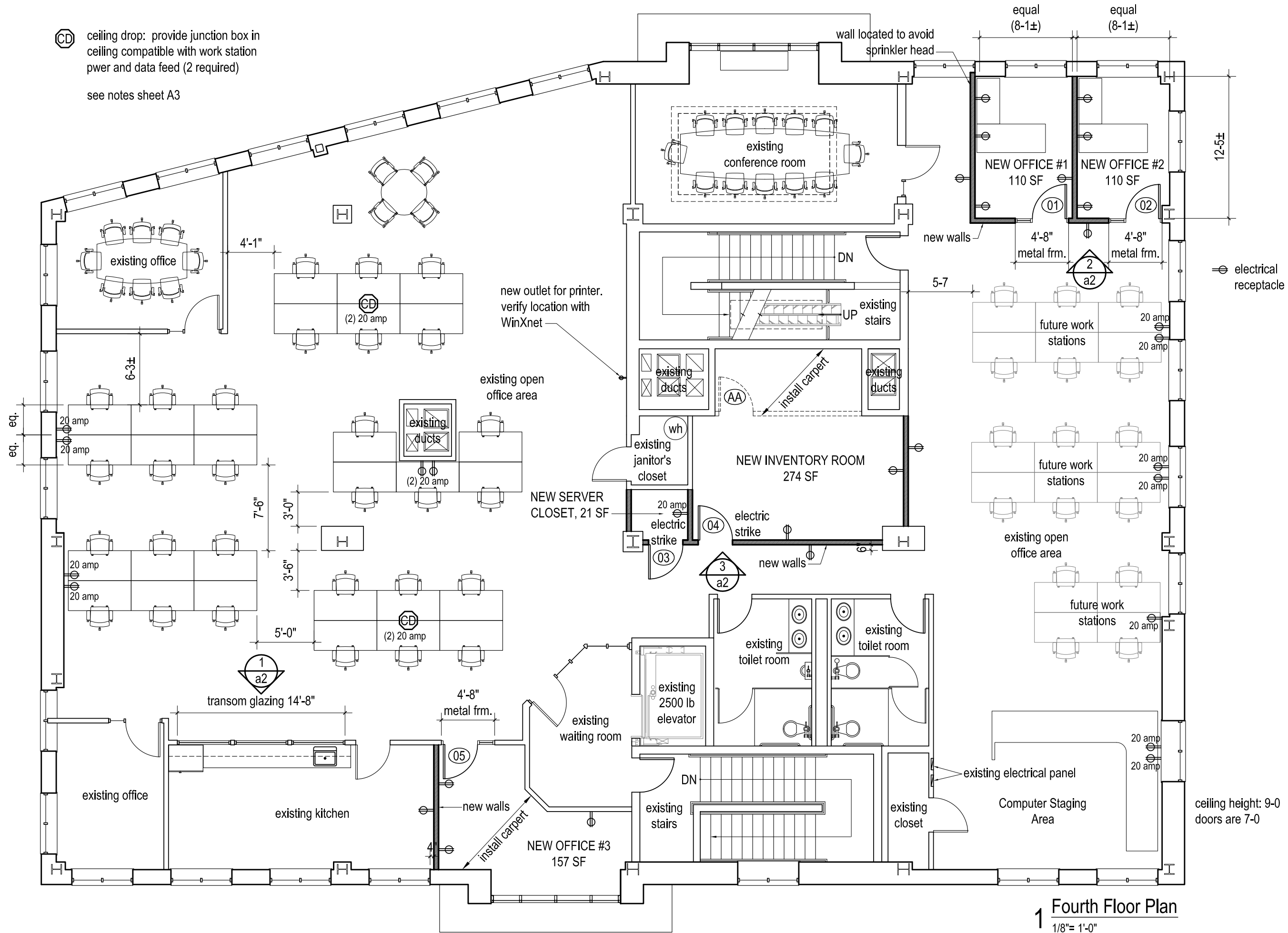

1 Fourth Floor Plan
1/8" = 1'-0"



licensed architect
josef chatlat
ar 2354
state of maine

josef chatlat, architect
327 Ocean House Road cape elizabeth, maine 04107
ph. 207 318 3234, email: azimuth@maine.r.com

april 17, 2014

WinXnet Tenant Improvement
63 Marginal Way, Portland Maine
034 C001 B7 Zoning District

a1

ceiling height: 9-0
doors are 7-0

⊕ electrical receptacle

equal (8-1±)

equal (8-1±)

12-5±

4'-8" metal frm.

4'-8" metal frm.

new walls

5-7

future work stations

20 amp

20 amp

future work stations

20 amp

20 amp

existing open office area

future work stations

20 amp

20 amp

existing electrical panel

Computer Staging Area

wall located to avoid sprinkler head

existing conference room

DN

UP

existing stairs

existing ducts

existing ducts

install carpet

existing janitor's closet

wh

NEW INVENTORY ROOM 274 SF

NEW SERVER CLOSET, 21 SF

20 amp electric strike

04

electric strike

03

new walls

3 a2

existing toilet room

existing toilet room

existing 2500 lb elevator

existing waiting room

05

DN

existing stairs

existing closet

NEW OFFICE #3 157 SF

new walls

install carpet

4

4'-8" metal frm.

existing kitchen

transom glazing 14'-8"

1 a2

5'-0"

3'-6"

3'-0"

7'-6"

6-3±

4'-1"

existing office

(2) 20 amp

Ⓢ

existing ducts

(2) 20 amp

Ⓢ

(2) 20 amp

Ⓢ

Ⓢ

Ⓢ

Ⓢ

Ⓢ

Ⓢ

Ⓢ

Ⓢ

Ⓢ

Ⓢ

Ⓢ

Ⓢ

Ⓢ