

# 200 KENNEBEC

## PORTLAND, MAINE

### DATE OF ISSUE

03-16-2015 ISSUED FOR PERMITTING  
 05-08-2015 ISSUED FOR CONSTRUCTION  
 10-21-2016 SHELL REDESIGN



### DRAWING LIST

- STRUCTURAL**  
 S1.2 WAREHOUSE FOUNDATION PLAN  
 S2.2 WAREHOUSE ROOF FRAMING PLAN  
 S3.2 FOUNDATION AND FRAMING SECTIONS
- ARCHITECTURAL DRAWINGS**  
 A1.01 FLOOR AND ROOF PLAN  
 A2.01 ELEVATIONS  
 A3.01 BUILDING SECTIONS  
 A3.02 WALL SECTIONS  
 A4.00 WALL TYPES  
 A8.01 DOOR SCHEDULE  
 A8.02 WINDOW SCHEDULE

### SIGNATURES

OWNER: \_\_\_\_\_ DATE: \_\_\_\_\_  
 ARCHITECT: \_\_\_\_\_ DATE: \_\_\_\_\_  
 CONTRACTOR: \_\_\_\_\_ DATE: \_\_\_\_\_  
 MAINE HOUSING: \_\_\_\_\_ DATE: \_\_\_\_\_  
 CONSTRUCTION LENDER: \_\_\_\_\_ DATE: \_\_\_\_\_

### RELEVANT CODES

INTERNATIONAL BUILDING CODE	REFERENCE
NONSEPARATED OCCUPANCIES M and S-2	309
CALCULATIONS BASED ON MORE RESTRICTIVE M OCCUPANCY	
CONSTRUCTION TYPE 2B	T601
SPRINKLED W/NFPA 13	903.1
ALLOWABLE AREA = 50,000 SQ.FT. (TABULAR AREA + SPRINKLER INCREASE)	T503
PROPOSED FLOOR AREA (2,957 SQ.FT.)	
ALLOWABLE HEIGHT (3) STORIES (TABULAR HGT. PLUS SPRINKLER INCREASE)	T503
PROPOSED HEIGHT (1) STORIES	
FIRE RESISTANCE RATING STRUCTURAL FRAME (0 HOUR)	T601
FIRE RESISTANCE RATING BEARING WALLS (0 HOUR)	T601
FIRE RESISTANCE RATING NON-BEARING WALLS AND PARTITIONS (0 HOURS)	T601
FIRE RESISTANCE RATING FLOOR CONSTRUCTION (0 HOUR)	T601
FIRE RESISTANCE RATING ROOF CONSTRUCTION (0 HOUR)	T601
MEANS OF EGRESS	1003
M OCCUPANT LOAD: 1,700 / 30 = 57	T-1004.1.1
S-2 OCCUPANT LOAD (WAREHOUSE): 1,257 / 500 = 3	
FIRE PARTITIONS	T-1017.1
CORRIDOR FIRE PARTITION (NONBEARING) - 0 HR	905.3.1
STANDPIPE NOT REQUIRED (<30 FT. ABOVE GRADE)	903.3.6
FIRE DEPT. CONNECTION REQUIRED	(AS DIRECTED BY FIRE)
MANUAL ALARM NOT REQUIRED	907.2.1 (EX.)
NFPA 101 - 2009	REFERENCE
OCCUPANCY - MERCANTILE	NFPA 6.1.10
CONSTRUCTION TYPE II (000)	NFPA TABLE A.8.2.1.2
SPRINKLED W/NFPA 13	
DEAD END CORRIDOR = 50 FT	42.2.5
EXIT ENCLOSURE 1 HOUR	7.1.3.2.1
AREA OF REFUGE NOT REQUIRED	7.2.12.1.1

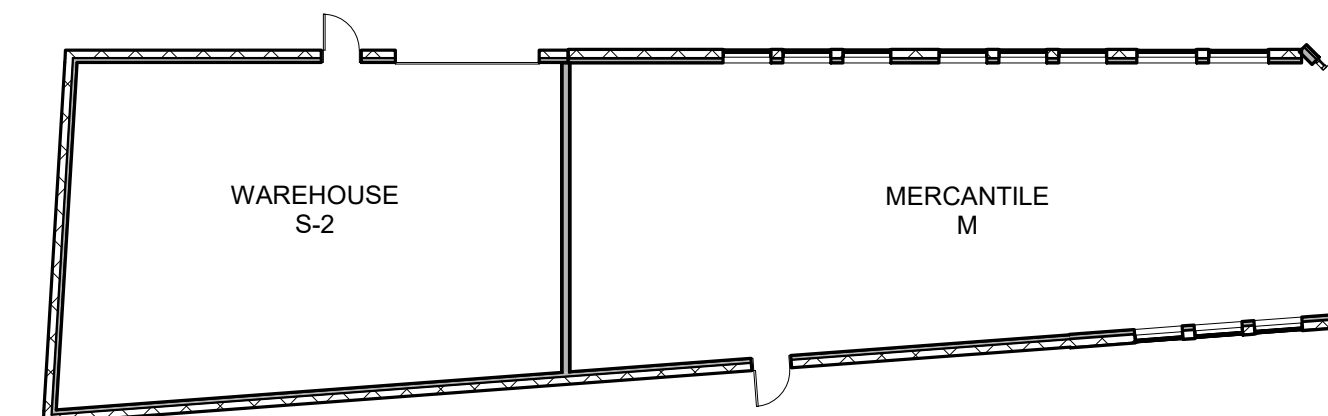

### CONTACTS

**Client:**  
 Northland Development  
 17 South St. 3rd Floor  
 Portland, ME  
 04101  
 (207) 780-0223

**Architect:**  
 Archetype Architects  
 48 Union Wharf  
 Portland, ME  
 04101  
 (207) 772 6022

**Structural Engineer:**  
 Structural Design Consulting  
 2696 Lake Shore Rd.  
 Unit 130  
 Gilford, NH  
 03249  
 (603) 293-8038

**Electrical Engineer:**  
 xxxxx  
 xxxxx  
 xxxxx  
 xxxxx  
 xxxxx  
 xxxxx

**Mechanical Engineer:**  
 xxxxx  
 xxxxx  
 xxxxx  
 xxxxx  
 xxxxx  
 xxxxx

**Civil Engineer:**  
 xxxxx  
 xxxxx  
 xxxxx  
 xxxxx  
 xxxxx  
 xxxxx