

PARTITION ASSEMBLY TYPE

INTERIOR STEEL STUD WALL

- 2x4 STEEL STUDS @ 16" O.C. TO UNDERSIDE OF CEILING, 25 GA.
- (1) LAYER 1/2" GWB - EACH SIDE.
- R11 INSULATION BETWEEN STUDS

GENERAL
DESCRIPTION

SCALE: 1/2" = 1'-0"

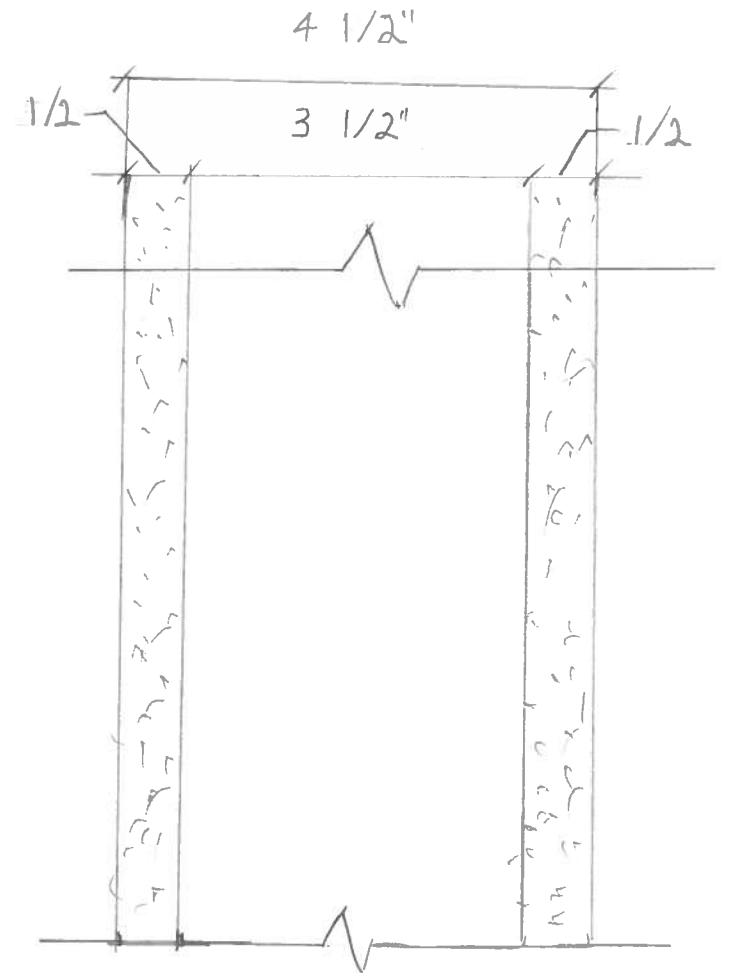

GENERAL
PICTORIAL

PARTITION DETAIL

A3.01