

**GENERAL NOTES:**

- PER NFPA 6.1.4 - OCCUPANCY CLASSIFICATION: DAY CARE
- INSTALL EXIT SIGNS ABOVE ALL EXTERIOR DOORS AND CORRESPONDING SIGNAGE IN HALLWAYS.
- INSTALL EMERGENCY LIGHTING AT ALL HALLWAYS AND EXIT AREAS PER NFPA.
- STAIRWAYS TO BE ENCLOSED IN 2 HR FIRE SEPARATION.
- ST01 TO REMAIN WITH PARTIAL RECONFIGURATION.  
EXISTING TREADS: 11"  
EXISTING RISERS: 7 3/4"  
WIDTH: 3'-4 1/2"  
EXISTING STAIR AND RECONFIGURED BOTTOM (2) STEPS TO MEET REQUIREMENTS PER NFPA TABLE 7.2.2.2.1.1(b)  
RECONFIGURED LANDING TO MEET REQUIREMENTS PER 7.2.2.3.2

**PARTITION TYPES:**

<b>W4 01</b>	<p>3/4" PLY FURRING STRIPS @ 16" OC EXISTING RUBBLE FOUNDATION WALL</p> <p>NOTE: PARTITION TO EXTEND TO GWB CEILING ABOVE. FIRE TAPE AND CAULK AS REQUIRED AT PENETRATIONS AND EXISTING GWB CEILING</p>
<b>W4 02</b>	<p>5/8" GWB (EA. SIDE) ACOUSTIC BATT INSULATION, TYP. 2X WOOD STUDS @ 16" OC</p> <p>NOTE: PARTITION TO EXTEND TO GWB CEILING ABOVE. FIRE TAPE AND CAULK AS REQUIRED AT PENETRATIONS AND EXISTING GWB CEILING</p>
<b>W4 03</b>	<p>(2) SHEETS 5/8" TYPE X GWB (EA. SIDE) ACOUSTIC BATT INSULATION, TYP. 2X WOOD STUDS @ 16" OC</p> <p>NOTE: PARTITION TO EXTEND TO GWB CEILING ABOVE. FIRE TAPE AND CAULK AS REQUIRED AT PENETRATIONS AND EXISTING GWB CEILING</p>

**PARTITION NOTES:**

- REFER TO ROOM FINISH SCHEDULE FOR FINISH SURFACE TREATMENT AND CEILING HEIGHTS ASSOCIATED WITH PARTITIONS.
- PROVIDE WOOD BLOCKING BETWEEN ALL STUDS TO REINFORCE GWB WALLS AT THE FOLLOWING LOCATIONS:  
A | BEHIND ALL DOORS RECEIVING WALL MOUNTED BUMPERS (DOORS INDICATED AS SWING AGAINST WALL).  
B | AT ALL WALLS SCHEDULED TO RECEIVE WALL HUNG CABINETS, SHELVING, FIXTURES, ACCESSORY AND BASE CABINETS.
- STUD SPACING SHOWN ON PARTITION TYPES IS MINIMUM STANDARD.
- PROVIDE ACOUSTICAL SEALANT BENEATH ALL STUD RUNNERS AND AROUND ALL PENETRATIONS IN WALLS WITH SOUND BATTS.
- ALL BATHROOMS, JANITOR CLOSETS & KITCHENS TO HAVE 5/8" MOISTURE RESISTANT GWB/AND OR TILE BACKER BOARD.

**TYPICAL CEILING ASSEMBLY:**

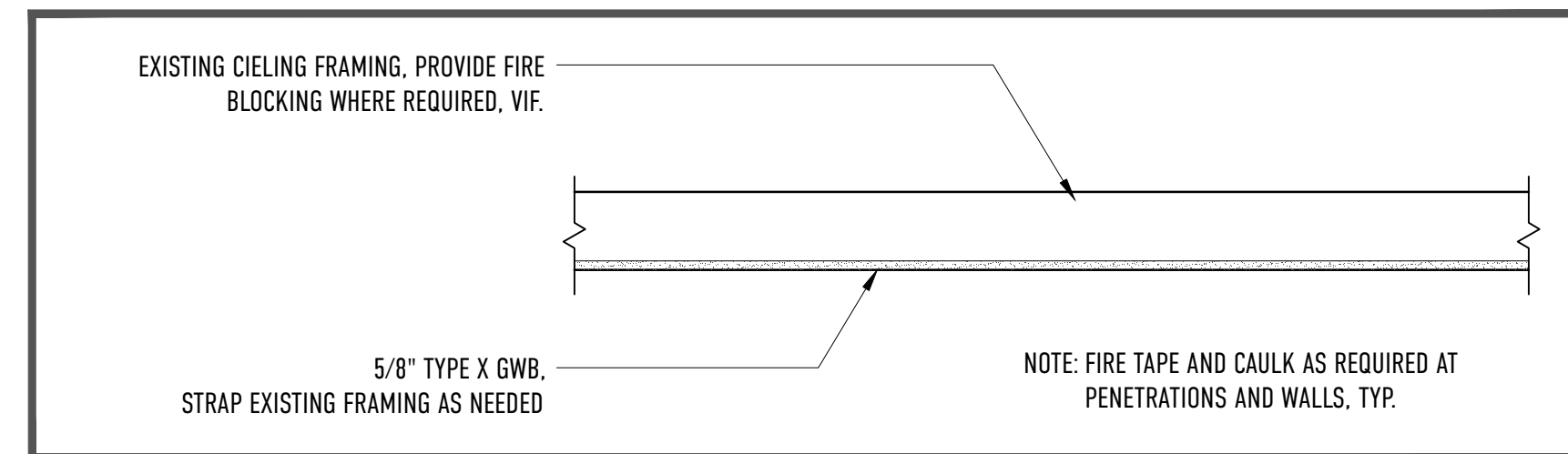

**DOOR SCHEDULE:**

MARK	LOCATION	DESCRIPTION	MODEL	DOOR			MATERIAL	HARDWARE	RATING	NOTES
				WIDTH	HEIGHT	THICK				
001	001	FLUSH	TBD	3'-0"	6'-8"	1 3/8"	HDF	PRIVACY	--	--
003	003	FLUSH-PAIRED	TBD	6'-0"	6'-8"	1 3/8"	HDF	PRIVACY	--	--
007	007	FLUSH	TBD	3'-0"	6'-8"	1 3/8"	HDF	PRIVACY	--	--

NOTES:  
1. GENERAL CONTRACTOR SHALL CONFIRM ALL JAMB DEPTH DIMENSIONS PRIOR TO PLACING THE DOOR ORDER.  
2. ALL GLASS TO BE TEMPERED AS REQUIRED BY CODE.  
3. CONFIRM CLEAR OPENING DIMENSIONS AT ALL EXISTING EGRESS DOORS. VERIFY THEY MEET ANY ADA REQUIREMENTS

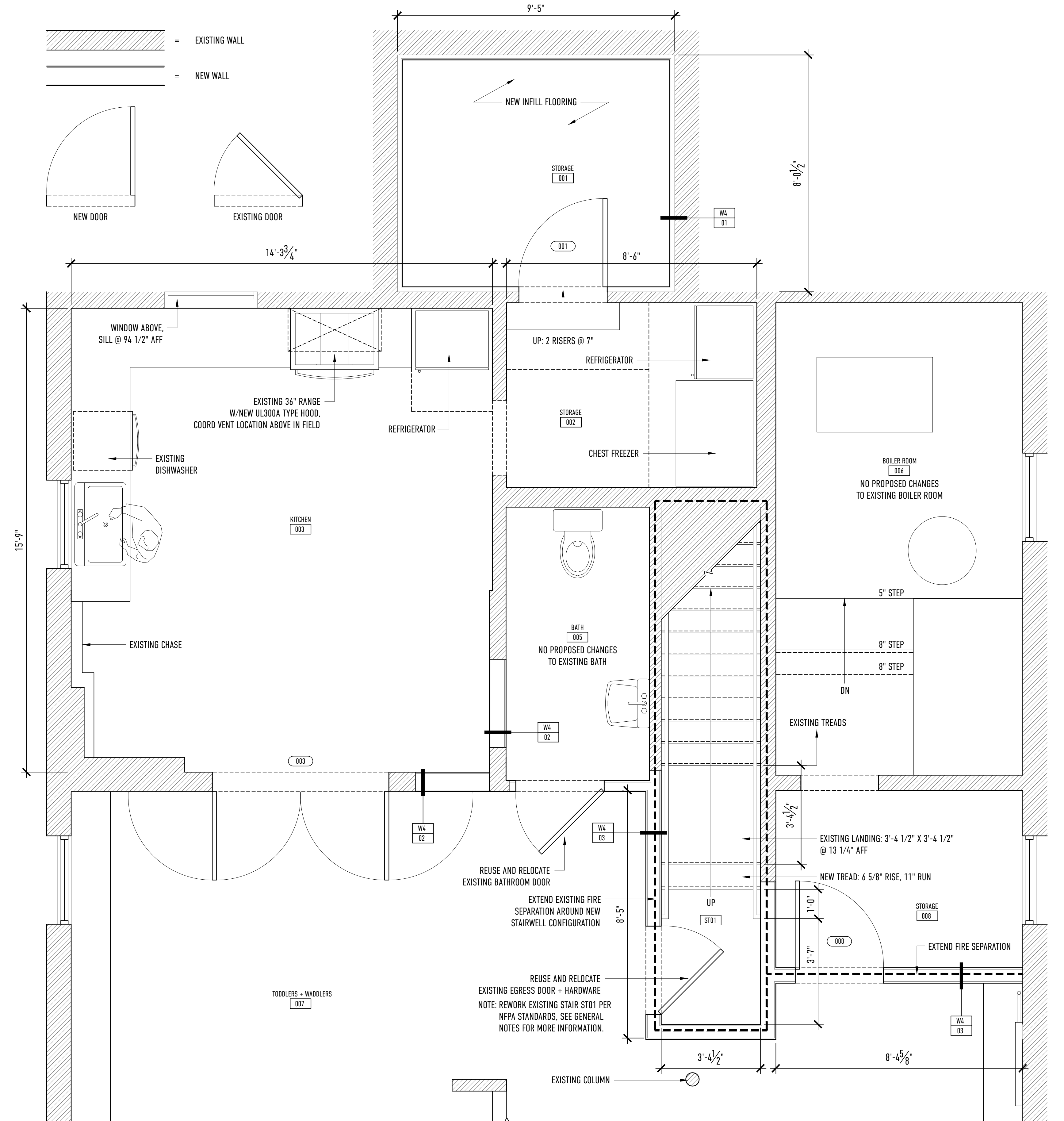

**1 PROPOSED FLOOR PLAN**  
SCALE: 1/2" = 1'-0"

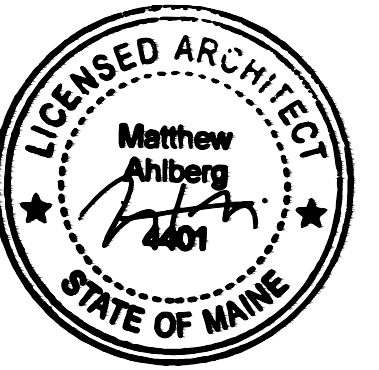

REVISIONS:

**A.101 PROPOSED FLOOR PLAN**

DRAWING TITLE:  
**A.101**

PROJECT NAME:  
YOUTH & FAMILY OUTREACH  
331 CUMBERLAND AVENUE  
PORTLAND, MAINE 04101

DATE OF ISSUE:  
NOVEMBER 6, 2017

ISSUED FOR:  
PERMIT DOCUMENTS

SCALE:  
1/2" = 1'-0"

THIS DRAWING IS THE PROPERTY OF BARRETT MADE AND IS NOT TO BE COPIED OR REPRODUCED IN ANY MANNER WITHOUT THE WRITTEN CONSENT OF BARRETT MADE.

