

VACANT LOT
D DWELLING DATA
 CONSTRUCTION
 STORY _____
 1 BRICK 4 CONC. BLK. 7 STONE
 2 FRAME 5 STUCCO 8
 3 FR. & MAS. 6 9
 AGE _____
 REMODELED 19 _____

LIVING ACCOMMODATIONS
 TOTAL ROOMS _____
 BED. ROOMS _____
 FULL BATHS _____
 HALF BATHS _____
 TOTAL FIXTURES _____

FOUNDATION
 BASEMENT & ATTIC
 FIN. BSMT. AREA _____
 HEAD ROOM _____
 GARAGE S D _____
 WERS/LAB/CRAWL _____
 BASEMENT - FULL _____
 0 1/4 1/2 3/4 _____
 DORMER _____
 L/F _____

EXTERIOR WALLS
 1000 VINYL ALUM. _____
 HINGLES - WOOD _____
 HINGLES - ASPHALT _____
 HINGLES - ASBESTOS _____
 BRICK VENEER _____
 PLASTER _____
 DRYWALL _____
 PANELING _____

ROOFING
 HINGLES - ASPHALT _____
 HINGLES - WOOD _____
 HINGLES - ASBESTOS _____
 LATE _____
 OIL _____

FLOORS
 8 1 2 3 _____
 CONCRETE _____
 PARTIAL _____
 FULL _____
 SOLAR _____
 NO HEAT 1 2 3 _____

INTERIOR FINISH
 1 2 3 _____
 PIPE _____
 HARDWOOD _____
 PLASTER _____
 DRYWALL _____
 PANELING _____

UNFINISHED
 HEATING _____
 HOT WATER RAD BB _____
 STEAM _____
 FLOOR FURNACE _____
 ELECTRIC _____
 AIR CONDITIONING _____
 UNIT HEATER _____
 NO. OF HTG. STS. _____

OCCUPANCY
 SINGLE FAMILY _____
 TWO FAMILY _____
 APARTMENT _____
 NO. UNITS _____
 OTHER _____
 COTTAGE _____
 UNFIN. _____
 FIN. OPEN _____
 FIN. DIV. _____

PLUMBING M 0
 BATHROOM _____
 TOILET ROOM _____
 FLUSH _____
 LAVATORY _____
 SHOWER - EXTRA _____
 KITCHEN SINK _____
 HOT WATER HEATER _____
 NO PLUMBING _____
 WATER ONLY _____

REMODELING DATA
 KITCHEN _____
 PLUMBING _____
 HEATING _____
 GENERAL _____

ECONOMIC CLASS
 OVER BUILT _____
 UNDER BUILT _____

NO.	TYPE	SIZE	GRADE	RATE	REPL. COST	DEPR.	%	TOTAL VALUE	TYPE CODE	NOTES
1	CD	4000		32.41	307160				070452	
2										
3										
4										
5										
TOTAL VALUE - BUILDINGS									12500	

OTHER BUILDINGS AND YARD

OTHER FEATURES
 MASONRY TRIM _____
 MODERNIZED KITCHEN _____
 RECREATION ROOM _____
 WOODBURNING FIREPLACE _____
 BASEMENT GARAGE _____
 ATTACHED GARAGE _____
 TOTAL OTHER FEATURE POINTS _____

DWELLING COMPUTATIONS
 19 19 19
 BASE PRICE _____
 PLUMBING _____
 BASEMENT _____
 BASEMENT FIN. _____
 ATTIC _____
 HEATING _____
 ADDITIONS _____
 DORMERS _____
 TOTAL BASE _____
 GRADE FACTOR _____
 TOTAL _____
 OTHER FEATURES _____
 TOTAL _____
 C & D FACTOR _____
 REPL. COST _____
 DEPREC. _____
 R.C.L.D. _____

NOTES: FIRE
 * THIS BLDG. TRANS. TO J-17
 ALONG WITH 1,119 # OF LAND
 BLDG. TO BE REHAB. TO
 10 DWELLING UNITS - REPAIRS
 SEE CARD 2 OF 2

August 8 33-J-017

COMMERCIAL/INDUSTRIAL BUILDING DATA & COMPUTATIONS

ROOFING		EXTERIOR WALL CODES	
COMPOSITION	SLATE OR TILE	1 BRICK	3 GLASS
METAL	SHINGLE	5 STUCCO	7 STONE
FRAMING	B 1 2 3 4	9 CONCRETE	0 ENAM. STL.
WOOD JOIST	✓	EXTERIOR WALLS	
FIRE RESISTANT	✓	EFF. PERIMETER	
FIRE PROOF	✓	PERM. AREA RATIO	
FLOORS		NO. OF UNITS	10
CONCRETE	✓	AV. UNIT SIZE	474
WOOD	✓	BSMT. SIZE	100%
TILE	✓	SCHEDULE	APT
FINISH TYPE		HT.	
UNFINISHED		BASEMENT	25.20
FINISHED OPEN		FIRST	30.08
FINISHED DIVIDED	✓	SECOND	28.15
USE		3RD	28.15
STORE		4TH	28.15
OFFICE		BASE PRICE	139.73
APARTMENT	2 2 2 2	B.P.A.	
WAREHOUSE		SUB TOTAL	139.73
VACANT		LIGHTING	
ABANDONED		HTG/AIR CON.	
HEATING EST. E.L.		SPRINKLER	
CENTRAL WARM AIR		PARTITIONS	
HOT WATER/STEAM		INTERIOR FINISH	
UNIT HEATERS		SF/CF PRICE	139.73
NO HEATING		AREA/CUBE	949
AIR COND. CENTRAL		SUB TOTAL	132,600
PACKAGE/UNITS		SPECIAL FEATURES	
PLUMBING		ADDITIONS	13870
BATH ROOMS	✓	TOTAL BASE	146470
TOILET ROOMS	✓	GRADE FACTOR	1.05%
OTHER		REPL. COST	139,230
SPRINKLER	NONE	PRICE	153760
QTY.		ITEM DESCRIPTION	
		PLUMBING FIXTURES	

GROSS BUILDING SUMMARY

BLOG. NO.	USE	CONSTRUCTION	GRADE	AGE	RECT. I. REMOD.	CDU	SIZE	RATE	REPLACEMENT COST	DEPRECIATION NORMAL OBSOL.	R.C.L.D.	YR.
10 UNIT	APT. BLDG.	4 ST. 6 SMT. FRAMES	C-105	1949	1987		949		139,230	10	31,330	87/81
									153,760	10	124,550	87/81

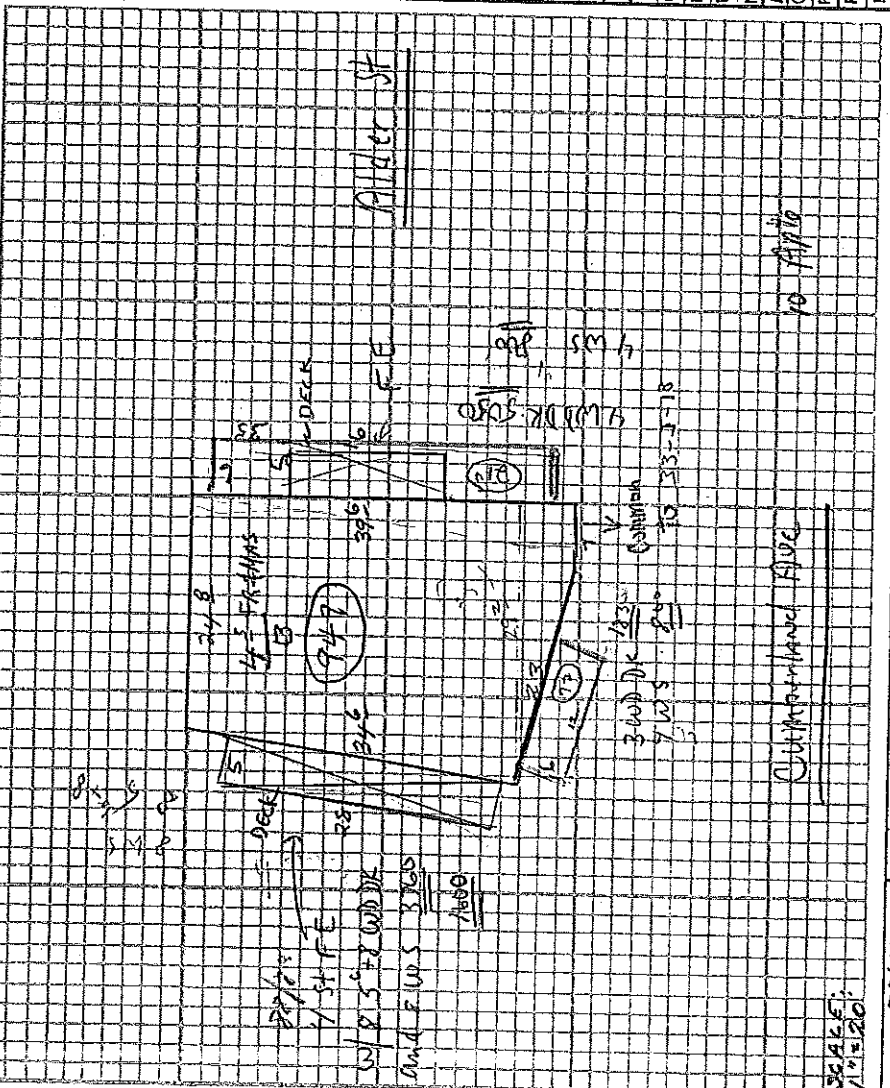

OTHER BUILDINGS AND YARD

NO.	TYPE	SIZE	GRADE	RATE	REPL. COST	DEPR.	R.C.L.D.	TYPE CODE	TOTAL VALUE
1						%		01 B.T. PAV.	
2						%		02 CONC. PAV.	
3						%		03 POOL	
4						%		04 SHOP/SHED	
5						%		05 MISC.	
#									

NOTES: 5788 FORMER 1340. JARE HOUSE C-8. TO BE CONVERTED TO 10 APT. UNITS 4/1/87 - 3224 THE FEAS. NOT ST. NO MECH. SEAT. P.R. ST.