

RECEIVED

JUL 08 2013

Dept. of Building Inspections
City of Portland Maine

B-1 Zone

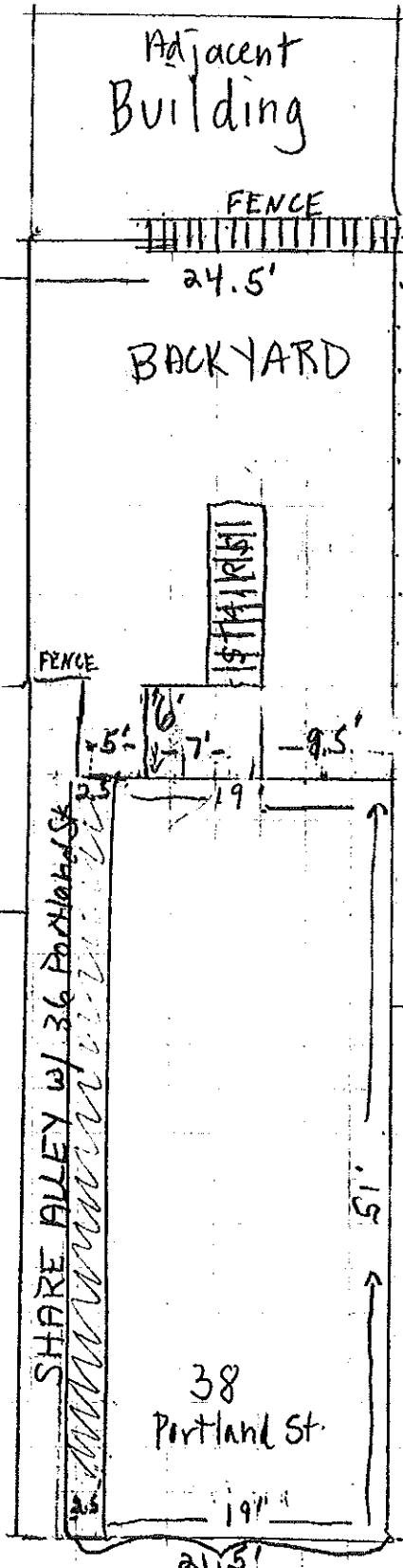

Building

DRIVEWAY

36 Portland St.

Building

36 Portland St.

FENCE

SHARE ALLEY w/ 36 Portland St.

Adjacent Building

FENCE

24.5'

BACKYARD

STAIRS

5' 6' 7' 9.5'

19'

38 Portland St.

19'

51'

ALLEY

DRIVEWAY

BUILDING

Building

40 Portland St.

SIDEWALK

PORTLAND STREET