

GENERAL NOTES

1: DRAWING NOTES:
CONTRACTOR TO FURNISH AND INSTALL ALL NOTED LABOR AND MATERIALS UNLESS OTHERWISE NOTED.

2: CODE COMPLIANCE:
ALL WORK SHALL CONFORM TO THE LATEST EDITION OF STATE, LOCAL AND OTHER CODES WHICH APPLY TO THIS PROJECT OR HAVE JURISDICTION.

3: COORDINATION:
IT IS THE RESPONSIBILITY OF THE CONTRACTOR TO COORDINATE ALL DISCIPLINES AND TRADES SO THAT ALL BUILDING SYSTEMS AND COMPONENTS CAN BE ASSEMBLED WITHOUT CONFLICTS. IN THE EVENT THAT THE CONSTRUCTION DOCUMENTS DEFINE CONDITIONS WHICH PROHIBIT, OR MAY PROHIBIT, SUCH ASSEMBLY, THE CONTRACTOR SHALL BRING TO THE ARCHITECTS ATTENTION, IN WRITING AND IN A TIMELY FASHION, SUCH CONDITION. THE CONTRACTOR SHALL NOT PROCEED WITH RELATED WORK WITHOUT A WRITTEN RESOLUTION CLARIFICATION FROM THE ARCHITECT.
THE CONTRACTOR AND HIS/HER SUBCONTRACTORS SHALL BE RESPONSIBLE FOR PROVIDING MATERIALS AND SYSTEMS SHOWN IN THE CONSTRUCTION DOCUMENTS REGARDLESS OF WHERE THE INFORMATION IS LOCATED. WHERE COMPONENTS OF A SYSTEM ARE INDICATED THE CONTRACTOR SHALL BE RESPONSIBLE FOR PROVIDING ALL LABOR AND MATERIALS NECESSARY TO COMPLETE THE SYSTEM.

4: DISCREPANCIES & CLARIFICATIONS:
THIS PROJECT INVOLVES THE FIT-UP OF AN EXISTING BUILDING. EXISTING DIMENSIONS SHOWN ON THE DRAWINGS ARE BELIEVED TO BE ACCURATE, BUT CANNOT BE GUARANTEED. MEASURE AND VERIFY DIMENSIONS IN FIELD PRIOR TO FABRICATION AND CONSTRUCTION. IT IS THE RESPONSIBILITY OF THE CONTRACTOR TO BRING TO THE ARCHITECTS ATTENTION, IN WRITING, ANY DISCREPANCIES OR AMBIGUITIES IN THE DRAWINGS AND/OR SPECIFICATIONS. THE CONTRACTOR SHALL NOT PROCEED WITH RELATED WORK WITHOUT A WRITTEN RESOLUTION OR CLARIFICATION FROM THE ARCHITECT.

5: LAYOUT:
UNLESS INDICATED OTHERWISE, CENTER WALL FRAMING AND PARTITION FRAMING ON COLUMN LINES. FLOOR PLAN DIMENSIONS ARE TO CENTER OF FRAMING, FACE OF CONCRETE, FACE OF CMU, OR FROM COLUMN CENTERLINES, UNLESS INDICATED OTHERWISE. DOORS AND WINDOWS ARE DIMENSIONED TO CENTERLINES UNLESS INDICATED OTHERWISE.

6: CENTERING:
UNLESS INDICATED OTHERWISE, CENTER BUILDING ELEMENTS WITHIN OR BETWEEN OTHER BUILDING ELEMENTS WHEN CONDITIONS OR THE DRAWINGS INDICATE OR IMPLY THAT SUCH IS THE INTENT, WHETHER OR NOT DIMENSIONS ARE INCLUDED

7: SYMMETRY:
WHERE CONDITIONS OR THE DRAWINGS INDICATE OR IMPLY THAT SYMMETRY IS INTENDED, INFORMATION PROVIDED AT ONE SIDE APPLIES EQUALLY TO BOTH SIDES, UNLESS CONDITIONS CLEARLY PRECLUDE SUCH APPLICATION.

8: ACCESSIBILITY:
ALL HANDICAPPED ACCESSIBLE BATHROOMS, GRAB BARS, AND DOOR OPENINGS SHALL MEET THE REQUIREMENTS OF TITLE 94-348, CHAPTER 5 OF THE MAINE HUMAN RIGHTS COMMISSION TITLE LATEST EDITION & THE DEPARTMENT OF JUSTICE ADA STANDARDS FOR ACCESSIBLE DESIGN.

9: DRAWING SCALES:
WORK FROM THE GIVEN DIMENSIONS ONLY. SCALE IS INDICATED ON THE DRAWINGS FOR CONVENIENCE ONLY. IT IS NOT INTENDED THAT CONSTRUCTION BE DETERMINED BY ALING THE DRAWINGS SINCE SOME ITEMS MAY NOT BE TO SCALE.

10: WATER-RESISTANT GWB:
INSTALL WATER-RESISTANT GYPSUM WALL BOARD IN ALL REST ROOMS & TOILET ROOMS OR AT ANY WALL WITH PLUMBING FIXTURES.

10A: HIGH IMPACT GWB:
INSTALL HIGH IMPACT GYPSUM WALL BOARD IN ALL STAIRWELLS

11: INTERIOR ELEVATIONS:
INTERIOR ELEVATIONS MAY BE REVERSED FROM AND/OR SIMILAR TO ACTUAL CONDITIONS. SEE FLOOR PLANS FOR WINDOW AND DOOR QUANTITIES AND LOCATIONS, FOR CASEWORK LAYOUTS, AND FOR MONITOR LOCATIONS.

12: BUILDING INSULATION:
PROVIDE AS INDICATED IN WALL SECTIONS AND IN ACCORDANCE WITH PARTITION TYPES, WHETHER OR NOT SHOWN IN DETAILS AND OTHER DRAWINGS. FOR CLARITY, INSULATION MAY NOT BE SHOWN IN SOME CASES, EVEN IF IT IS TO BE PROVIDED.

13: BLOCKING:
INSTALL BLOCKING BEHIND ALL SURFACE-APPLIED FIXTURES TRIM, CASEWORK, SHELVES, BRACKETS, TOILET ACCESSORIES, CHAIR RAILS, PICTURE RAILS, GRAB BARS, BASE MOLDINGS, AND AS OTHERWISE REQUIRED, WHEN SUCH ITEMS ARE APPLIED ON STUD WALLS.

14: PENETRATIONS AT STRUCTURAL MEMBERS:
BEFORE PENETRATING JOISTS, BEAMS OR OTHER STRUCTURAL MEMBERS, CONSULT WITH THE ARCHITECT.

15: DAMAGED WORK:
BUILDING OR SITE COMPONENTS WHICH ARE AFFECTED BY NEW WORK, DEMOLITION, OR WHICH MAY BE DAMAGED BY THE GENERAL CONTRACTOR OR ANY SUB-CONTRACTOR SHALL BE REPLACED OR RESTORED TO ORIGINAL CONDITION AND COLOR TO MEET THE APPROVAL OF THE ARCHITECT.

16: UTILITIES:
VERIFY THE SIZE AND LOCATION OF ALL UNDERGROUND UTILITIES AND REPORT ANY DISCREPANCIES TO THE ARCHITECT IN WRITING. DO NOT PROCEED WITH WORK UNTIL THE DISCREPANCY HAS BEEN RESOLVED TO THE SATISFACTION OF THE ARCHITECT.

17: RATED CONSTRUCTION:
PROVIDE RATED CONSTRUCTION AS REQUIRED BY CODE, AS SPECIFIED, AND AS INDICATED ON DRAWINGS. IT IS THE RESPONSIBILITY OF THE CONTRACTOR TO PROVIDE AND INSTALL ALL COMPONENTS REQUIRED TO CREATE SUCH RATED CONSTRUCTION, REGARDLESS OF WHETHER OR NOT SUCH COMPONENTS ARE INDICATED. PROVIDE CONTINUITY OF SUCH RATED CONSTRUCTION AROUND AND BETWEEN SPACES, INCLUDING AT CHASES AND AT FLOORS, TO MAINTAIN COMPLETE SEPARATIONS, EVEN IF NOT SPECIFICALLY INDICATED.

18: SHOP DRAWINGS:
SUBMIT SHOP DRAWINGS TO THE ARCHITECT FOR REVIEW PRIOR TO FABRICATIONS. SUBMITTALS REQUIRED INCLUDE, BUT ARE NOT LIMITED TO, SHOP DRAWINGS FOR ALL PREFABRICATED CONCRETE, STEEL, MILLWORK & SIGNAGE, SAMPLES OF ALL PROPOSED PAINTS, METALS, WALL COVERINGS, LAMINATES, SOLID SURFACE MATERIALS, CERAMIC TILE, AND HARDWARE. SUBMIT MANUFACTURERS' DATA FOR ALL LIGHTING SYSTEMS, AND HARDWARE.

19: PERMITS:
THE GENERAL CONTRACTOR SHALL OBTAIN AND PAY FOR ANY BUILDING PERMITS REQUIRED AND CARRY ANY INSURANCE COVERAGES REQUIRED.

20: INTERIOR FINISHES:
ALL INTERIOR FINISHES AND FURNISHINGS ARE TO BE CLASS 'A' FIRE-RATED AND ARE TO COMPLY WITH SECTION 920.0 BOCA (INTERIOR FLAME SPREAD).

21: ELECTRICAL DESIGN:
DESIGN BUILD FORMAT

22: WASTE REMOVAL:
THE GENERAL CONTRACTOR SHALL DISPOSE OF ALL WASTE AND DEBRIS OFF THE PREMISES.

23: LANDLORD COORDINATION:
THE GENERAL CONTRACTOR MUST COORDINATE WITH THE BUILDING OWNER ALL ACTIVITIES INCLUDING BUT NOT LIMITED TO WORK WHICH WILL GENERATE EXCESSIVE NOISE AND MODIFICATION TO UTILITIES. WORK MUST NOT INTERFERE WITH EXISTING SMOKE DETECTORS, ALARMS OR BUILDING SYSTEM MANAGEMENT.

24: TEMPORARY FACILITIES:
PROVIDE ALL TEMPORARY FACILITIES AND SERVICES, CONSTRUCTION AND SUPPORT FACILITIES, AND SECURITY AND PROTECTION AS NEEDED TO PROTECT NEW AND EXISTING CONSTRUCTION FOR THE DURATION OF A COMPLETE INSTALLATION.

25: FINAL CLEANING:
EMPLOY EXPERIENCED WORKERS FOR FINAL CLEANING. CLEAN EACH SURFACE TO THE CONDITION EXPECTED IN A COMMERCIAL BUILDING CLEANING PROGRAM.

26: MANUFACTURERS INSTRUCTIONS:
ALL MATERIALS & EQUIPMENT SHALL BE INSTALLED ACCORDING TO MANUFACTURER'S SPECIFICATIONS.

27: GUARANTEE:
GUARANTEE: ALL MATERIALS AND WORKMANSHIP SHALL BE GUARANTEED FOR A PERIOD OF ONE YEAR FROM THE DATE OF FINAL ACCEPTANCE UNLESS OTHERWISE SPECIFIED FOR A LONGER PERIOD OF TIME ON A CERTAIN ITEM.

28: ASBESTOS:
ALL MATERIAL USED FOR THE CONSTRUCTION OF THIS PROJECT, WHETHER BUILDING MATERIALS OR APPURTENANCES, SHALL BE NON-ASBESTOS CONTAINING MATERIAL.

29: HAZARDOUS FUMES:
THE GENERAL CONTRACTOR SHALL CONFIRM THAT ALL MATERIAL AND FINISHES SPECIFIED AND THEIR FABRICATION OR INSTALLATION WILL NOT RELEASE FUMES OR AROMAS DURING CONSTRUCTION WHICH MAY BE A HAZARD OR NUISANCE TO PERSONNEL.

30: PEST CONTROL:
ALL MATERIAL USED FOR THE CONSTRUCTION OF THIS PROJECT, WHETHER BUILDING MATERIALS OR APPURTENANCES, SHALL BE NON-ASBESTOS CONTAINING MATERIAL.

31: EXPOSED UTILITIES:
ALL EXPOSED UTILITY WIRES AND PIPES (ELECTRICAL, PLUMBING, ETC.) SHALL BE INSTALLED IN A WAY THAT DOES NOT OBSTRUCT OR PREVENT THE CLEANING OF FLOORS, WALLS, AND CEILING AREAS. THEY SHALL BE INSTALLED A MINIMUM OF 6" OFF FLOORS AND 1" OFF WALLS, CEILINGS AND ADJACENT PIPES.

32: OWNER SUPPLIED EQUIPMENT:
EQUIPMENT SUPPLIED BY THE OWNER AND INSTALLED BY THE GENERAL CONTRACTOR SHALL BE RESPONSIBLE FOR VERIFYING WITH THE OWNER THE EXACT DIMENSIONS AND EQUIPMENT CONNECTION REQUIREMENTS (INCLUDING ELECTRICAL CIRCUIT REQUIREMENTS) OF EQUIPMENT TO BE SUPPLIED. THE GENERAL CONTRACTOR SHALL MAKE ALL FINAL CONNECTIONS AS NOTED ON THE DRAWINGS, INSTALL THE SET UP IN WORKING ORDER, CHECK WARRANTIES, TEST AND NOT VOID WARRANTIES. THE GENERAL CONTRACTOR SHALL COORDINATE WITH THE OWNER DELIVERY, STORAGE AND INSTALLATION OF ALL OWNER SUPPLIED EQUIPMENT. THE GENERAL CONTRACTOR SHALL STORE EQUIPMENT IF REQUESTED BY THE OWNER UNTIL INSTALLATION. SEE DRAWINGS FOR OTHER OWNER SUPPLIED/GENERAL CONTRACTOR INSTALLED ITEMS.

33: FIRE PROTECTION NOTE:
EXISTING SPRINKLERHEADS, ALARM SYSTEM AND DETECTORS ARE TO BE MODIFIED TO CONFORM WITH THE PROPOSED PLAN. COORDINATE WITH THE ARCHITECT, ANY MODIFICATION OR LOCATIONS WHERE EXISTING SYSTEMS ARE AFFECTED BY THE NEW DESIGN.

34: SOILS AT FOOTINGS:
REPORT THE LOCATION OF ALL UNSUITABLE SOILS AND MATERIALS BELOW ANTICIPATED LEVEL OF FOOTING TO THE ARCHITECT PRIOR TO THE SETTING OF FORMS.

35: ACCESS PANELS:
CONTRACTOR IS RESPONSIBLE FOR COORDINATING QUANTITY AND LOCATION OF ALL REQUIRED ACCESS PANELS FOR ALL MEP CONTROLS, CLEANOUTS, DAMPERS, PULL BOXES, ETC.

36: EXISTING HAZARDOUS MATERIALS
ALL HAZARDOUS MATERIALS INCLUDING BUT NOT LIMITED TO ASBESTOS AND LEAD PAINT ARE TO BE HANDLED, ENCAPSULATED, ABATED AND DISPOSED OF IN ACCORDANCE WITH ANY AND ALL FEDERAL, STATE AND LOCAL REQUIREMENTS AND REGULATIONS.

37: INDUSTRY STANDARDS:
ALL WORK SHALL BE PERFORMED IN ACCORDANCE WITH INDUSTRY STANDARDS. STANDARDS INCLUDE BUT ARE NOT LIMITED TO THE FOLLOWING:

- AAMA AMERICAN ARCHITECTURAL MANUFACTURERS ASSOCIATION
- ACI AMERICAN CONCRETE INSTITUTE
- ANSI AMERICAN NATIONAL STANDARDS INSTITUTE
- ASTM AMERICAN SOCIETY FOR TESTS AND MATERIALS
- AWI ARCHITECTURAL WOODWORK INSTITUTE
- "CUSTOM GRADE"
- AWS AMERICAN WELDING SOCIETY
- IGMA INSULATING GLASS MANUFACTURERS ALLIANCE
- NAAMM NATIONAL ASSOCIATION OF ARCHITECTURAL METAL MANUFACTURERS
- NRCA NATIONAL ROOFING CONTRACTORS ASSOCIATION
- NITCA NATIONAL TILE CONTRACTORS ASSOCIATION
- SMACNA SHEET METAL AND AIR CONDITIONING NATIONAL ASSOCIATION
- VDMA WINDOW AND DOOR MANUFACTURERS ASSOCIATION

ABBREVIATIONS

<p>A AC AIR CONDITIONING ACT ACoustICAL CEILING TILE AD AREA DRAIN ADAAG AMERICANS WITH DISABILITIES ACT ACCESSIBILITY GUIDELINES ADD ADDENDUM AFF ABOVE FINISHED FLOOR AHU AIR-HANDLING UNIT AL ALUMINUM ARCH ARCHITECT/ARCHITECTURAL AWP Acoustic WALL PANEL</p> <p>B B TO BLS BACK-TO-BACK ANGLES B.B.G.C. BASE BUILDING GENERAL CONTRACTOR BL BUILDING LINE BLDG BUILDING BLKG BLOCKING BSMT BASEMENT BTWN BETWEEN BO BY OTHERS</p> <p>C C COURSE (MASONRY) CER CERAMIC CG CORNER GUARD CH COAT HOOK CJ CONTROL JOINT CL CENTER LINE CLG CONCRETE MASONRY UNIT CMU CONCRETE MASONRY UNIT CO CAN OUT COL COLUMN CONC CONCRETE CONC CONCRETE CONN CONNECT/CONNECTION CONST CONSTRUCTION CONT CONTINUOUS CORR CORRIDOR CT CERAMIC TILE CUH CABINET UNIT HEATER</p> <p>D DBL DOUBLE DF DRINKING FOUNTAIN DIA DIAMETER DIFF DIFFUSER DIM DIMENSION DOOR DOOR DR DOOR DSP DRY STAND PIPE DWG DRAWING</p> <p>E E EAST EA EACH EL ELEVATION ELEC ELECTRICAL ELEV ELEVATION ENTR ENTRANCE EQ EQUIPMENT EXP EXPANSION EXPB EXPANSION BOLT EXT EXTERIOR EPDM ETHYLENE PROPYLENE DIENE MONOMER EWC ELECTRIC WATER COOLER</p> <p>F FAHRENHEIT FB FLAT BAR FD FIRE EXTINGUISHER AND CABINET FE FLOOR DRAIN FE FIRE EXTINGUISHER FEC FIRE EXTINGUISHER CABINET FTWD FIRE TREATED WOOD FINISH FINISH FL FLOOR FMB FACE OF BRICK FOC FACE OF CONCRETE FOF FACE OF FINISH FOS FACE OF STUDS FOW FACE OF WALL FSS FIRE SUPPRESSION SYSTEM FOOT FOOT FTG FOOTING FRG FIBER REINFORCED GYPSUM FTR FIN TUBE RADIATION FH FUME HOOD</p> <p>G GA GAUGE GALV GALVANIZED GC GENERAL CONTRACTOR GFI GROUND-FAULT INTERRUPTER GL GLASS/GLAZING GLAM GLUE-LAMINATED WOOD GND GROUND GWB GYPSUM WALL BOARD</p> <p>H HC HOSE BIB HANDICAP HM HOLLOW METAL HORIZ HORIZONTAL HP HORSE POWER/HIGH POINT/HEAT PUMP HR HOUR HW HOT WATER HVAC HEATING VENTILATION AIR CONDITIONING</p> <p>I ID INSIDE DIMENSION/INSIDE DIAMETER IN INCHES INFO INFORMATION INSUL INSULATION</p> <p>J JST JOIST JT JOINT</p> <p>K KD KILN-DRIED KIP 1000 POUNDS</p>	<p>L LAB LABORATORY LAM LAMINATED LB POUND LH LEFT HAND LLC LEAD COATED COPPER</p> <p>M MACH MACHINE MASC MASONRY MATL MATERIAL MAX MAXIMUM MDO MEDIUM-DENSITY OVERLAY MECH MECHANICAL MEMB MEMBRANE MET METAL MEZZ MEZZANINE MFR MANUFACTURER MIN MINIMUM MISC MISCELLANEOUS MO MOUNTED MTL METAL MB MARKER BOARD</p> <p>N N NORTH # NUMBER #C NOT IN CONTACT NOM NOMINAL DIMENSION NTS NOT TO SCALE</p> <p>O O/OVER ON/OVER OC ON CENTER OD OUTSIDE DIAMETER/OUTSIDE DIMENSION OFF OFFICE OPN OPENING OPNUS OPENING OPP H OPPOSITE HAND OSB ORIENTED STRAND BOARD OUNC OUNCE</p> <p>P POB/OC PURCHASED BY OWNER INSTALLED BY CONTRACTOR PC PRECAST PI PLATE PL PLASTIC LAMINATE PR PAIR PREF PREFABRICATE PRIV PRIVACY PRIM PRIMED PSF POUNDS PER SQUARE FOOT PSI POUNDS PER SQUARE INCH PTD PAINTED PTN PARTITION PVC POLYVINYL CHLORIDE PYD PLYWOOD PRF PRESSURE TREATED PERF PERFORATED</p> <p>Q QT QUARRY TILE QTR QUARTER</p> <p>R RAD RADIUS RUB RUBBER BASE RCP REFLECTED CEILING PLAN RD ROOF DRAIN REBAR REINFORCING BAR REFR REFRIGERATOR REINF REINFORCED RES RESILIENT REV REVERSE RM ROOM ROW ROUGH OPENING R/W RIGHT OF WAY</p> <p>S S SOUTH SCHD SCHEDULE SQ SQUARE FEET SIM SIMILAR SPEC SPECIFICATION SQ SQUARE SST STAINLESS STEEL SND SOUND TRANSMISSION CLASS STD STANDARD STEEL STR STORAGE STRUC STRUCTURE/STRUCTURAL SUSP SUSPENSION</p> <p>T TAG TONGUE&GROOVE TEL TELEPHONE THK THICK TOP TOP OF DECK TOP OF STEEL TYP TYPICAL TV TELEVISION TACK TACK BOARD TOP OF CONCRETE</p> <p>U U UNDERWRITERS LABORATORIES, INC. UNIT UNIT VENTILATOR</p> <p>V VCT VINYL COMPOSITION TILE VERT VERTICAL VIF VERIFY IN FIELD VOL VOLUME</p> <p>W W WEST W/O WITHOUT W/ WITH WOOD WOOD WF WIDE FLANGE WP WORK POINT WT WEIGHT</p>
---	---

DRAWING LEGEND

	EARTH		BEDROOM		ROOM NAME AND NUMBER		ELEVATION COMPASS NUMBER
	POROUS FILL		DOOR		INTERIOR ELEVATION SYMBOL		ELEVATION NUMBER
	CONCRETE		WINDOW		SHEET WHERE ELEVATION LOCATED		FLOORING TYPE TRANSITION
	CONCRETE MASONRY UNIT		SECTION NUMBER		SECTION MARK		SHT WHERE SECTION LOCATED
	BRICK		DETAIL NUMBER		DETAIL MARK		SHT WHERE DETAIL LOCATED
	STEEL		WALL TYPE		WALL TYPE TAG		
	WOOD - ROUGH		FIRE EXTINGUISHER				
	GYPSUM BOARD						
	RIGID INSULATION						
	BATT INSULATION						
	CELLULOSE INSULATION						

FIRESTOPPING DETAILS

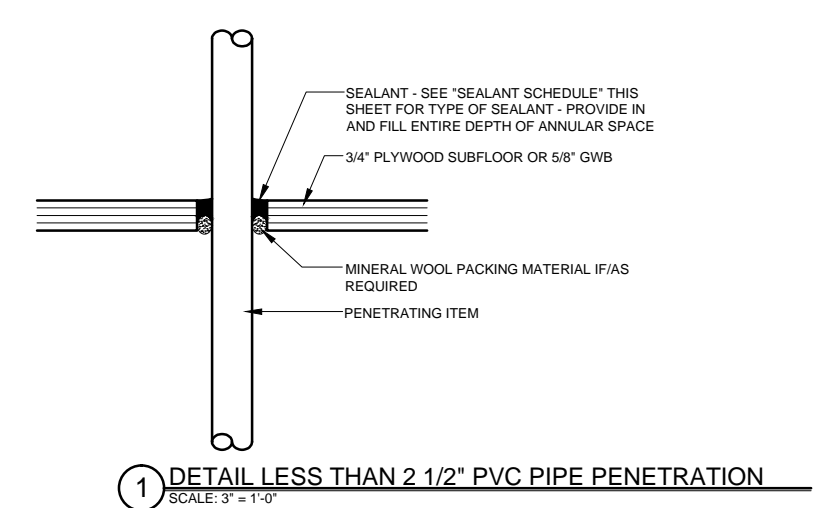
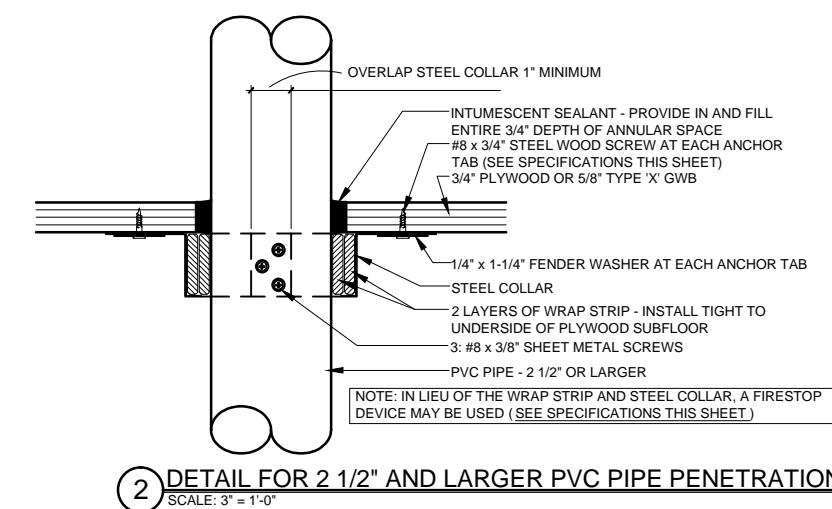

SPECIFICATIONS

WRAP STRIP: 1/4" THICK X 1 1/2" MINIMUM WIDTH INTUMESCENT MATERIAL WITH PLASTIC FILM FACING BOTH SIDES. TEMPORARILY SECURE WITH MAKING TAPE. SPECIFIED TECHNOLOGIES INC. (STI) "SpecSeal RED Wrap Strip" OR "SpecSeal BLU Wrap Strip" OR EQUAL.

STEEL COLLAR: WRAP STRIP MANUFACTURER'S STEEL COLLAR, FABRICATED FROM .016 INCH THICK GALVANIZED SHEET STEEL, WIDTH TO MATCH WRAP STRIP (1 1/2" MINIMUM), WITH 1 INCH X 2 INCH ANCHOR TABS AND RETAINER TABS. ANCHOR TABS TO BE SYMMETRICALLY OPPOSED AROUND COLLAR; PROVIDE 3 TABS FOR 2 1/2" AND 3" PIPE; PROVIDE 4 TABS FOR 4" PIPE.

INTUMESCENT SEALANT: ONE-PART, INTUMESCENT, LATEX ELASTOMER TESTED TO ASTM E 814. MINIMUM EXPANSION OF 3x AT 1000°F. 3M "FIRE BARRIER SEALANT CP 25WB" OR EQUAL.

FIRESTOP SEALANT: SINGLE COMPONENT NONCOMBUSTIBLE FIRE RATED SEALANT TESTED TO ASTM E 814. TESTED TO 3000°F. "BOSS 130 FIRESTOP/DRAFT SEALANT" MANUFACTURED BY ACCUMETRIC, LLC, OR EQUAL.

SEALANT SCHEDULE:

INTUMESCENT SEALANT: PROVIDE AT ALL PENETRATIONS THROUGH RATED CONSTRUCTION FOR PENETRATING ITEMS INCLUDING BUT NOT LIMITED TO: PVC PIPE, ROOF LEADER PIPES, GAS PIPES & LINES, SPRINKLER PIPES; ELECTRICAL & COMMUNICATIONS CABLES & WIRES; AND ALARM SYSTEM WIRES. DO NOT USE INTUMESCENT SEALANT AT DOMESTIC HOT WATER OR HYDRONIC HEATING SYSTEM PIPES.

FIRESTOP SEALANT: PROVIDE AT ALL PENETRATIONS THROUGH RATED CONSTRUCTION FOR PENETRATING ITEMS INCLUDING DOMESTIC HOT AND COLD WATER PIPES AND HYDRONIC HEATING SYSTEM PIPES.

NOTE:

FOR LOCATIONS OF RATED CONSTRUCTION, SEE ARCHITECTURAL FLOOR PLANS AND SECTIONS

WALL TYPE NOTES

- FIRE RATED WALLS TO EXTEND UP TO DECKING ABOVE THROUGH THE FLOOR / CEILING ASSEMBLY. AT FLUTED DECKING DRYWALL TO BE CUT TO AND EXTEND UP TO PROFILE OF DECK FLUTES WITH ALLOWANCE FOR DEFLECTION JOINT
- INSTALL WATER RESISTANT GYPSUM WALLBOARD IN ALL RESTROOMS AND TOILET ROOM WALLS AND CEILINGS, AND AT ANY WALL WITH PLUMBING FIXTURES
- WHEN TWO ADJACENT WALL TYPES HAVE DIFFERING NUMBERS OF LAYERS OF GWB, THE FINISHED FACE OF GWB MUST FORM ONE CONTINUOUS PLANE. ADJUST STUD PLANE LOCATION AS REQUIRED TO ACHIEVE THE CONTINUOUS PLANE
- HOLD BOTTOM OF GWB UP 1/2" FROM CONCRETE, PROVIDE SEALANT AT JOINT.
- ALL WALL TYPES WITH AN INSULATION COMPONENT TO BE ACOUSTICALLY SEALED
- PROVIDE ACOUSTICAL SEALANT AROUND ALL PENETRATING ELEMENTS IN WALLS AND CEILINGS (ELECTRICAL BOXES, DUCTS, PIPES, ETC)
- FOR ALL WALLS THAT DO NOT RUN UP TO STRUCTURE ABOVE, PROVIDE DIAGONAL BRACING TO STRUCTURE ABOVE FOR WALL SUPPORT
- PROVIDE 4" RUBBER COVE BASE AT ALL WALLS, PARTITIONS, COLUMNS AND PILASTERS

WALL AND PARTITION TYPES

GRAPHIC DEPICTION	DESCRIPTION			
	- LAYER OF 5/8" GWB - 3/8" MTL. STUDS AT 16" O.C. - 3/2" SOUND BATT INSULATION - LAYER OF 5/8" GWB			
	- WALL HEIGHT UP TO 10'-0" AFF. BRACE TOP OF WALL WITH DIAGONAL FRAMING TO DECK ABOVE			
TYPE	FIRE RATING	UL NUMBER	STC RATING	IIC RATING
NA	N/A	N/A	N/A	N/A

GRAPHIC DEPICTION	DESCRIPTION			
	- LAYER OF 5/8" GWB - 3/8" MTL. STUDS AT 16" O.C. - 3/2" SOUND BATT INSULATION - LAYER OF 5/8" GWB			
	- WALL HEIGHT UP TO DECK ABOVE WITH HEAD SLIP DEFLECTION TRACK			
TYPE	FIRE RATING	UL NUMBER	STC RATING	IIC RATING
NB	N/A	N/A	N/A	N/A

GRAPHIC DEPICTION	DESCRIPTION			
	- LAYER OF 5/8" MR GWB - 6" MTL. STUDS AT 16" O.C. - 5/2" SOUND BATT INSULATION			
	- WALL HEIGHT UP TO DECK ABOVE WITH HEAD SLIP DEFLECTION TRACK			
TYPE	FIRE RATING	UL NUMBER	STC RATING	IIC RATING
NC	N/A	N/A	N/A	N/A

GRAPHIC DEPICTION	DESCRIPTION			
	- LAYER OF 5/8" TYPE X' GWB - 3/8" MTL. STUDS AT 16" O.C. - 3/2" FIRE/SOUND BATT INSULATION - LAYER OF 5/8" TYPE X' GWB			
	- WALL HEIGHT UP TO DECK ABOVE WITH HEAD SLIP DEFLECTION TRACK FIRECAULK GWB TO DECK			
TYPE	FIRE RATING	UL NUMBER	STC RATING	IIC RATING
1A	1HR	U465	N/A	N/A

GRAPHIC DEPICTION	DESCRIPTION			
	CONTRACTOR OPTION TO REPAIR EXISTING WALL IN PLACE TO MEET SPECIFICATIONS BELOW			
	- LAYER OF 5/8" TYPE X' GWB - 3/8" MTL. STUDS AT 16" O.C. - 3/2" FIRE/SOUND BATT INSULATION - LAYER OF 5/8" TYPE X' GWB			
	- WALL HEIGHT UP TO DECK ABOVE WITH HEAD SLIP DEFLECTION TRACK FIRECAULK GWB TO DECK			
TYPE	FIRE RATING	UL NUMBER	STC RATING	IIC RATING
1B	1HR	U465	N/A	N/A

GRAPHIC DEPICTION	DESCRIPTION			
	- LAYER OF 5/8" GWB - VAPOR BARRIER - 3/8" MTL. STUDS AT 16" O.C. - 3/2" BATT INSULATION - 1" AIR SPACE - EXISTING WALL			
	- WALL HEIGHT UP TO DECK ABOVE WITH HEAD SLIP DEFLECTION TRACK			
TYPE	FIRE RATING	UL NUMBER	STC RATING	IIC RATING
E1	N/A	N/A	N/A	N/A



© 2014 RYAN SENATORE ARCHITECTURE

GOOD WILL FIT-UP
 200 LANCASTER ST.
 PORTLAND, MAINE



CONSULTANTS:

REVISIONS:

DATE: DECEMBER 3, 2014

PROJECT No. 1448

DRAWN BY: RJS

CHECKED BY: RJS

SCALE: AS NOTED

SHEET TITLE:
GENERAL NOTES AND ABBREVIATIONS

G1-0