



© 2014 RYAN SENATORE ARCHITECTURE

**GOOD WILL FIT-UP**  
200 LANCASTER ST.  
PORTLAND, MAINE



RYAN SENATORE  
ARCHITECTURE  
67 GRAY ROAD  
GORHAM, MAINE 04038  
207-650-6414  
senatorearchitecture.com

CONSULTANTS:

REVISIONS:

DATE: DECEMBER 3, 2014

PROJECT No. 1448

DRAWN BY: RJS

CHECKED BY: RJS

SCALE: AS NOTED

SHEET TITLE:

REFLECTED  
CEILING PLAN

A1-1

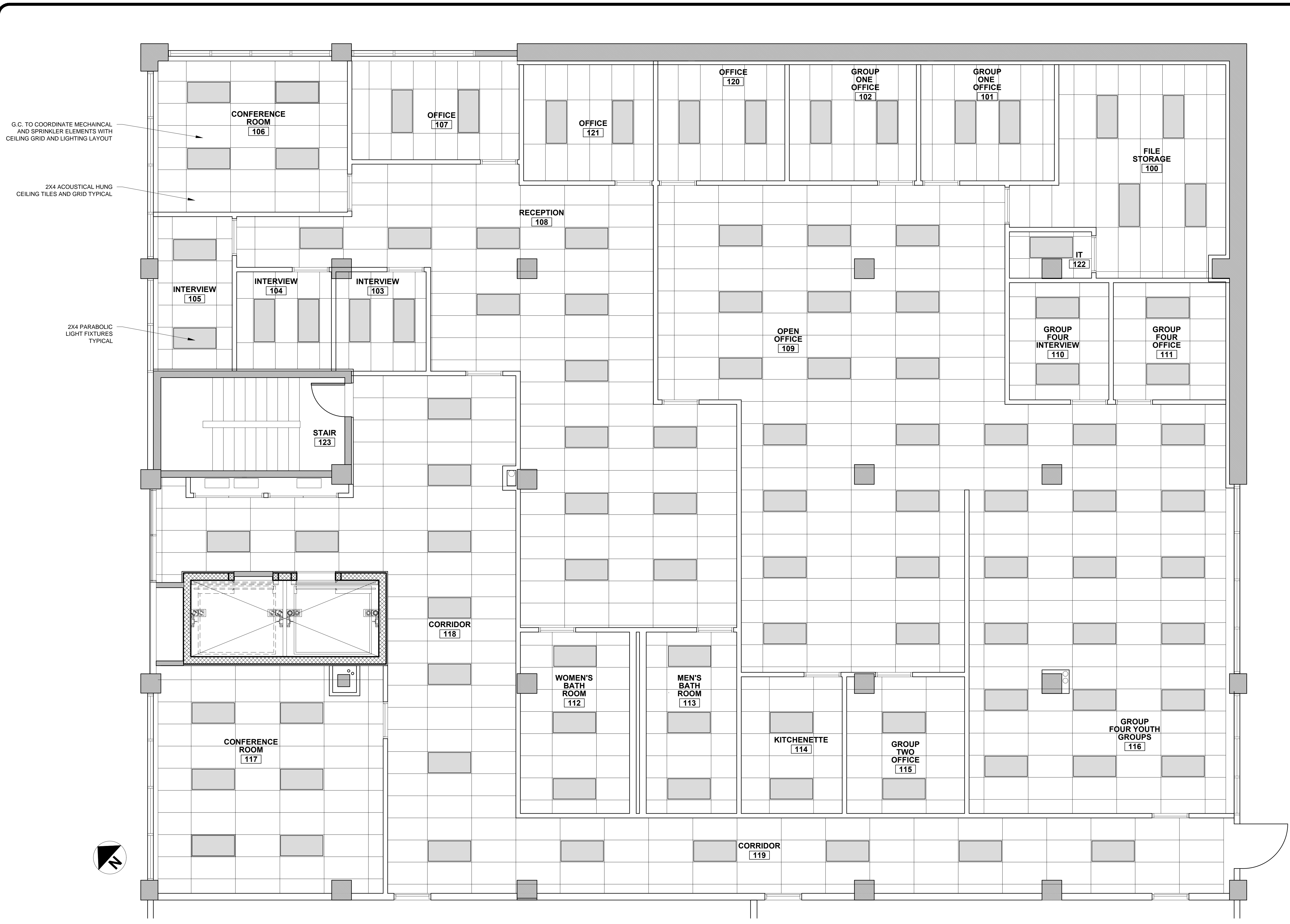

G.C. TO COORDINATE MECHANICAL AND SPRINKLER ELEMENTS WITH CEILING GRID AND LIGHTING LAYOUT

2X4 ACOUSTICAL HUNG CEILING TILES AND GRID TYPICAL

2X4 PARABOLIC LIGHT FIXTURES TYPICAL

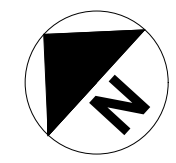

1 REFLECTED CEILING PLAN  
1/4" = 1'-0"

OXFORD  
STREET  
LEVEL