

GENERAL NOTES

1. DRAWING NOTES:

CONTRACTOR TO FURNISH AND INSTALL ALL NOTED LABOR AND MATERIALS UNLESS OTHERWISE NOTED.

2. CODE COMPLIANCE:

ALL WORK SHALL CONFORM TO THE LATEST EDITION OF STATE, LOCAL, AND OTHER CODES WHICH APPLY TO THIS PROJECT OR HAVE JURISDICTION.

3. COORDINATION:

IT IS THE RESPONSIBILITY OF THE CONTRACTOR TO COORDINATE ALL DISCIPLINES AND TRADES SO THAT ALL BUILDING SYSTEMS AND COMPONENTS CAN BE ASSEMBLED WITHOUT CONFLICTS. IN THE EVENT THAT THE CONSTRUCTION DOCUMENTS DEFINE CONDITIONS WHICH PROHIBIT, OR MAY PROHIBIT, SUCH ASSEMBLY, THE CONTRACTOR SHALL BRING TO THE ARCHITECTS ATTENTION, IN WRITING AND IN A TIMELY FASHION, SUCH CONDITION. THE CONTRACTOR SHALL NOT PROCEED WITH RELATED WORK WITHOUT A WRITTEN RESOLUTION CLARIFICATION FROM THE ARCHITECT.

4. DISCREPANCIES & CLARIFICATIONS:

THIS PROJECT INVOLVES THE FIT-UP OF AN EXISTING BUILDING. EXISTING DIMENSIONS SHOWN ON THE DRAWINGS ARE BELIEVED TO BE ACCURATE, BUT CANNOT BE GUARANTEED. MEASURE AND VERIFY DIMENSIONS IN FIELD PRIOR TO FABRICATION AND CONSTRUCTION. IT IS THE RESPONSIBILITY OF THE CONTRACTOR TO BRING TO THE ARCHITECTS ATTENTION, IN WRITING, ANY DISCREPANCIES OR AMBIGUITIES IN THE DRAWINGS AND/OR SPECIFICATIONS. THE CONTRACTOR SHALL NOT PROCEED WITH RELATED WORK WITHOUT A WRITTEN RESOLUTION OR CLARIFICATION FROM THE ARCHITECT.

5. LAYOUT:

UNLESS INDICATED OTHERWISE, CENTER WALL FRAMING AND PARTITION FRAMING ON COLUMN LINES. FLOOR PLAN DIMENSIONS ARE TO CENTER OF FRAMING, FACE OF CONCRETE, FACE OF CMU, OR FROM COLUMN CENTERLINES, UNLESS INDICATED OTHERWISE. DOORS AND WINDOWS ARE DIMENSIONED TO CENTERLINES UNLESS INDICATED OTHERWISE.

6. CENTERING:

UNLESS INDICATED OTHERWISE, CENTER BUILDING ELEMENTS WITHIN OR BETWEEN OTHER BUILDING ELEMENTS WHEN CONDITIONS OR THE DRAWINGS INDICATE OR IMPLY THAT SUCH IS THE INTENT, WHETHER OR NOT DIMENSIONS ARE INCLUDED.

7. SYMMETRY:

WHERE CONDITIONS OR THE DRAWINGS INDICATE OR IMPLY THAT SYMMETRY IS INTENDED, INFORMATION PROVIDED AT ONE SIDE APPLIES EQUALLY TO BOTH SIDES, UNLESS CONDITIONS CLEARLY PRECLUDE SUCH APPLICATION.

8. ACCESSIBILITY:

ALL HANDICAPPED ACCESSIBLE BATHROOMS, GRAB BARS, AND DOOR OPENINGS SHALL MEET THE REQUIREMENTS OF TITLE 94-348, CHAPTER 5 OF THE MAINE HUMAN RIGHTS COMMISSION TITLE LATEST EDITION & THE DEPARTMENT OF JUSTICE ADA STANDARDS FOR ACCESSIBLE DESIGN.

9. DRAWING SCALES:

WORK FROM THE GIVEN DIMENSIONS ONLY. SCALE IS INDICATED ON THE DRAWINGS FOR CONVENIENCE ONLY. IT IS NOT INTENDED THAT INFORMATION BE DETERMINED BY SCALING THE DRAWINGS SINCE SOME ITEMS MAY NOT BE TO SCALE.

10. WATER-RESISTANT GWB:

INSTALL WATER-RESISTANT GYPSUM WALL BOARD IN ALL REST ROOMS & TOILET ROOMS OR AT ANY WALL WITH PLUMBING FIXTURES.

10A. HIGH IMPACT GWB:

INSTALL HIGH IMPACT GYPSUM WALL BOARD IN ALL STAIRWELLS

11. INTERIOR ELEVATIONS:

INTERIOR ELEVATIONS MAY BE REVERSED FROM AND/OR SIMILAR TO ACTUAL CONDITIONS. SEE FLOOR PLANS FOR WINDOW AND DOOR QUANTITIES AND LOCATIONS, FOR CASEWORK LAYOUTS, AND FOR MONITOR LOCATIONS.

12. BUILDING INSULATION:

PROVIDE AS INDICATED WALL SECTIONS AND IN ACCORDANCE WITH PARTITION TYPES, WHETHER OR NOT SHOWN IN DETAILS AND OTHER DRAWINGS. FOR CLARITY, INSULATION MAY NOT BE SHOWN IN SOME CASES, EVEN IF IT IS TO BE PROVIDED.

13. BLOCKING:

INSTALL BLOCKING BEHIND ALL SURFACE-APPLIED FIXTURES TRIM, CASEWORK, SHELVES, BRACKETS, TOILET ACCESSORIES, CHAIR RAILS, PICTURE RAILS, GRAB BARS, BASE MOLDINGS, AND AS OTHERWISE REQUIRED, WHEN SUCH ITEMS ARE APPLIED ON STUD WALLS.

14. PENETRATIONS AT STRUCTURAL MEMBERS:

BEFORE PENETRATING JOISTS, BEAMS OR OTHER STRUCTURAL MEMBERS, CONSULT WITH THE ARCHITECT.

15. DAMAGED WORK:

BUILDING OR SITE COMPONENTS WHICH ARE AFFECTED BY NEW WORK, DEMOLITION, OR WHICH MAY BE DAMAGED BY THE GENERAL CONTRACTOR OR ANY SUB-CONTRACTOR SHALL BE REPLACED OR RESTORED TO ORIGINAL CONDITION AND COLOR TO MEET THE APPROVAL OF THE ARCHITECT.

16. UTILITIES:

VERIFY THE SIZE AND LOCATION OF ALL UNDERGROUND UTILITIES AND REPORT ANY DISCREPANCIES TO THE ARCHITECT IN WRITING. DO NOT PROCEED UNTIL THE DISCREPANCY HAS BEEN RESOLVED TO THE SATISFACTION OF THE ARCHITECT.

17. RATED CONSTRUCTION:

PROVIDE RATED CONSTRUCTION AS REQUIRED BY CODE, AS SPECIFIED, AND AS INDICATED ON DRAWINGS. IT IS THE RESPONSIBILITY OF THE CONTRACTOR TO PROVIDE AND INSTALL ALL COMPONENTS REQUIRED TO CREATE SUCH RATED CONSTRUCTION, REGARDLESS OF WHETHER OR NOT SUCH COMPONENTS ARE INDICATED. PROVIDE CONTINUITY OF SUCH RATED CONSTRUCTION AROUND AND BETWEEN SPACES, INCLUDING AT CHASES AND AT FLOORS, TO MAINTAIN COMPLETE SEPARATIONS, EVEN IF NOT SPECIFICALLY INDICATED.

18. SHOP DRAWINGS:

SUBMIT SHOP DRAWINGS TO THE ARCHITECT FOR REVIEW PRIOR TO FABRICATIONS. SUBMITTALS REQUIRED INCLUDE, BUT ARE NOT LIMITED TO: SHOP DRAWINGS FOR ALL PREFABRICATED CONCRETE, STEEL, MILLWORK & SIGNAGE, SAMPLES OF ALL PROPOSED PAINTS, METALS, WALL COVERINGS, LAMINATES, SOLID SURFACE MATERIALS, CERAMIC TILE, AND HARDWARE. SUBMIT MANUFACTURERS' DATA FOR ALL LIGHTING SYSTEMS, AND HARDWARE.

19. PERMITS:

THE GENERAL CONTRACTOR SHALL OBTAIN AND PAY FOR ANY BUILDING PERMITS REQUIRED AND CARRY ANY INSURANCE COVERAGES REQUIRED.

20. INTERIOR FINISHES:

ALL INTERIOR FINISHES AND FURNISHINGS ARE TO BE CLASS 'A' FIRE-RATED AND ARE TO COMPLY WITH SECTION 920.0 BOCA (INTERIOR FLAME SPREAD).

21. ELECTRICAL DESIGN:

REFER TO ELECTRICAL DRAWINGS AND SPECIFICATIONS

22. WASTE REMOVAL:

THE GENERAL CONTRACTOR SHALL DISPOSE OF ALL WASTE AND DEBRIS OFF THE PREMISES.

23. LANDLORD COORDINATION:

THE GENERAL CONTRACTOR MUST COORDINATE WITH THE BUILDING OWNER ALL ACTIVITIES INCLUDING BUT NOT LIMITED TO WORK WHICH WILL GENERATE EXCESSIVE NOISE AND MODIFICATION TO UTILITIES. WORK MUST NOT INTERFERE WITH EXISTING SMOKE DETECTORS, ALARMS OR BUILDING SYSTEM MANAGEMENT.

24. TEMPORARY FACILITIES:

PROVIDE ALL TEMPORARY FACILITIES AND SERVICES, CONSTRUCTION AND SUPPORT FACILITIES, AND SECURITY AND PROTECTION AS NEEDED TO PROTECT NEW AND EXISTING CONSTRUCTION FOR THE DURATION OF A COMPLETE INSTALLATION.

25. FINAL CLEANING:

EMPLOY EXPERIENCED WORKERS FOR FINAL CLEANING. CLEAN EACH SURFACE TO THE CONDITION EXPECTED IN A COMMERCIAL BUILDING CLEANING PROGRAM.

26. MANUFACTURERS INSTRUCTIONS:

ALL MATERIALS & EQUIPMENT SHALL BE INSTALLED ACCORDING TO MANUFACTURER'S SPECIFICATIONS.

27. GUARANTEE:

GUARANTEE: ALL MATERIALS AND WORKMANSHIP SHALL BE GUARANTEED FOR A PERIOD OF ONE YEAR FROM THE DATE OF FINAL ACCEPTANCE UNLESS OTHERWISE SPECIFIED FOR A LONGER PERIOD OF TIME ON A CERTAIN ITEM.

28. ASBESTOS:

ALL MATERIAL USED FOR THE CONSTRUCTION OF THIS PROJECT, WHETHER BUILDING MATERIALS OR APPURTENANCES, SHALL BE NON-ASBESTOS CONTAINING MATERIAL.

29. HAZARDOUS FUMES:

THE GENERAL CONTRACTOR SHALL CONFIRM THAT ALL MATERIAL AND FINISHES SPECIFIED AND THEIR FABRICATION OR INSTALLATION WILL NOT RELEASE FUMES OR AROMAS DURING CONSTRUCTION WHICH MAY BE A HAZARD OR NUISANCE TO PERSONNEL.

30. PEST CONTROL:

SEAL AND CAULK AROUND ALL PENETRATIONS, CRACKS AND CREVICES AND ANY OPENINGS CAPABLE OF HARBORING INSECTS/RODENTS.

31. EXPOSED UTILITIES:

ALL EXPOSED UTILITY WIRES AND PIPES (ELECTRICAL, PLUMBING, ETC.) SHALL BE INSTALLED IN A WAY THAT DOES NOT OBSTRUCT OR PREVENT THE CLEANING OF FLOORS, WALLS, AND CEILING AREAS. THEY SHALL BE INSTALLED A MINIMUM OF 8" OFF FLOORS AND 1" OFF WALLS, CEILINGS AND ADJACENT PIPES.

32. OWNER SUPPLIED EQUIPMENT:

EQUIPMENT SUPPLIED BY THE OWNER AND INSTALLED BY THE GENERAL CONTRACTOR: EQUIPMENT INFORMATION AND SPECIFICATIONS ARE TO BE THE MOST CURRENT AVAILABLE AT THE TIME OF DOCUMENTATION PREPARATION. THE GENERAL CONTRACTOR SHALL BE RESPONSIBLE FOR VERIFYING WITH THE OWNER THE EXACT DIMENSIONS AND EQUIPMENT CONNECTION REQUIREMENTS (INCLUDING ELECTRICAL CIRCUIT REQUIREMENTS) OF EQUIPMENT TO BE SUPPLIED. THE GENERAL CONTRACTOR SHALL MAKE ALL FINAL CONNECTIONS AS NOTED ON THE DRAWINGS. INSTALL THE SET UP IN WORKING ORDER, CHECK WARRANTIES, TEST AND NOT VOID WARRANTIES. THE GENERAL CONTRACTOR SHALL COORDINATE WITH THE OWNER DELIVERY, STORAGE AND INSTALLATION OF ALL OWNER SUPPLIED EQUIPMENT. THE GENERAL CONTRACTOR SHALL STORE EQUIPMENT IF REQUESTED BY THE OWNER UNTIL INSTALLATION. SEE DRAWINGS FOR OTHER OWNER SUPPLIED/GENERAL CONTRACTOR INSTALLED ITEMS.

33. FIRE PROTECTION NOTE:

EXISTING SPRINKLERHEADS, ALARM SYSTEM AND DETECTORS ARE TO BE MODIFIED TO CONFORM WITH THE PROPOSED PLAN. COORDINATE WITH THE ARCHITECT, ANY MODIFICATION OR LOCATIONS WHERE EXISTING SYSTEMS ARE AFFECTED BY THE NEW DESIGN.

34. SOILS AT FOOTINGS:

REPORT THE LOCATION OF ALL UNSUITABLE SOILS AND MATERIALS BELOW ANTICIPATED LEVEL OF FOOTING TO THE ARCHITECT PRIOR TO THE SETTING OF FORMS.

35. ACCESS PANELS:

CONTRACTOR IS RESPONSIBLE FOR COORDINATING QUANTITY AND LOCATION OF ALL REQUIRED ACCESS PANELS FOR ALL MEP CONTROLS, CLEANOUTS, DAMPERS, PULL BOXES, ETC.

36. EXISTING HAZARDOUS MATERIALS

ALL HAZARDOUS MATERIALS INCLUDING BUT NOT LIMITED TO ASBESTOS AND LEAD PAINT ARE TO BE HANDED, ENCAPSULATED, ABATED AND DISPOSED OF IN ACCORDANCE WITH ANY AND ALL FEDERAL, STATE AND LOCAL REQUIREMENTS AND REGULATIONS.

37. INDUSTRY STANDARDS:

ALL WORK SHALL BE PERFORMED IN ACCORDANCE WITH NATIONAL ASSOCIATION OF ARCHITECTURAL METAL MANUFACTURERS STANDARDS INCLUDE BUT ARE NOT LIMITED TO THE FOLLOWING:

Table listing industry standards: AAMA American Architectural Manufacturers Association, ACI American Concrete Institute, ANSI American National Standards Institute, ASTM American Society for Tests and Materials, AWS American Welding Society, IGMA Insulating Glass Manufacturers Alliance, NAAMM National Association of Architectural Metal Manufacturers, NRCA National Roofing Contractors Association, NTCNA National Tile Contractors Association, SMACNA Sheet Metal and Air Conditioning National Association, WDMA Window and Door Manufacturers Association.

ABBREVIATIONS

Table of abbreviations: AC AIR CONDITIONING, AD ACUSTICAL CEILING TILE, ADAAG AMERICANS WITH DISABILITIES ACT ACCESSIBILITY'S GUIDELINES, ADD ADDENDUM, AFF ABOVE FINISHED FLOOR, AHU AIR-HANDLING UNIT, AL ALUMINUM, ARCH ARCHITECTURAL, AWP ACOUSTIC WALL PANEL, B TO BLS BACK-TO-BACK ANGLES, B.G.C. BASE BUILDING GENERAL CONTRACTOR, BLDG BUILDING LINE, BLK BLOCKING, BSMT BASEMENT, BTWN BETWEEN, BO BY OTHERS, C COURSE (MASONRY), CER CERAMIC, CS CORNER GUARD, CH COAT HOOK, CJ CONTROL JOINT, CL CENTER LINE, CLG CEILING, CMU CONCRETE MASONRY UNIT, CO CLEAN OUT, COL COLUMN, CONC CONCRETE, COND CONDITION, CONN CONNECTION, CONST CONSTRUCTION, CONT CONTINUOUS, COR CORRIDOR, CT CERAMIC TILE, CH CABINET TILE HEATER, DBL DOUBLE, DF DRINKING FOUNTAIN, DIA DIAMETER, DIFF DIFFUSER, DIM DIMENSION, DN DOWN, DR DOOR, DSP DRY STAND PIPE, DWG DRAWING, E EAST, EA EACH, EL ELEVATION, ELEC ELECTRICAL, ELEV ELEVATION, ENTR ENTRANCE, EQ EQUAL, EQP EQUIPMENT, EXP EXPANSION, EXPB EXPANSION BOLT, EXPJ EXPANSION JOINT, EXT EXTERIOR, EPM ETHERYLENE PROPYLENE DIENE MONOMER, EWC ELECTRIC WATER COOLER, F FAHRENHEIT, FB FLAT BAR, FD FIRE EXTINGUISHER AND CABINET, FE FLOOR DRAIN, FE FIRE EXTINGUISHER, FECE FIRE EXTINGUISHER CABINET, FEC FIRE TREATED WOOD, FIN FINISH, FL FLOOR, FOB FACE OF BRICK, FOC FACE OF CONCRETE, FOF FACE OF FINISH, FOS FACE OF STUDS, FOW FACE OF WALL, FSS FIRE SUPPRESSION SYSTEM, FT FOOT, FTG FOOTING, FRG FIBER REINFORCED GYPSUM, FTR FIN TUBE RADIATION, FH FUME HOOD, G GAUGE, GALV GALVANIZED, GB GRAB BAR, GC GENERAL CONTRACTOR, GFI GROUND-FAULT INTERRUPTER, GL GLASS/GLAZING GLAZED, GLAM GLUE LAMINATED, GND GROUND, GWB GYPSUM WALL BOARD, H HOSE BIB, HC HANDICAP, HM HOLLOW METAL, HORIZ HORIZONTAL, HRS HORSE POWER/HIGH POINT/HEAT PUMP, HR HOUR, HW HOT WATER, HWAC HEATING VENTILATION AIR CONDITIONING, I INSIDE DIMENSION/INSIDE DIAMETER, IN INCHES, INFO INFORMATION, INSUL INSULATION, J JOIST, JST JOIST, JT JOINT, K KILN-DRIED, KP 1000 POUNDS, LAB LABORATORY, LAM LAMINATED, LM LEAD, LH LEFT-HAND, LCC LEAD COATED COPPER, M MACH, MAS MASONRY, MAT MATERIAL, MAX MAXIMUM, MDO MEDIUM-DENSITY OVERLAY, MECH MECHANICAL, MET MEMBRANE, MFR MANUFACTURER, MEZZ MEZZANINE, MIN MINIMUM, MISC MISCELLANEOUS, MO MOUNTED, MTL METAL, MB MARKER BOARD, N NORTH, N# NUMBER, NIC NOT IN CONTACT, NOM NOMINAL DIMENSION, NTS NOT TO SCALE, O ON, O/C ON CENTER, OC OFFICE, OFF OFFICE, OPNG OPENING, OPP OPPOSITE, OPFH OPPOSITE HAND, OSB ORIENTED STRAND BOARD, OZ OUNCE, PBOIBC PURCHASED BY OWNER INSTALLED BY CONTRACTOR, PRECAST, PL PLATE, PLAM PLASTIC LAMINATE, PRE FAB, PRIVAC, PRIM, PSF POUNDS PER SQUARE FOOT, POUNDS PER SQUARE INCH, PTD PAINTED, PRT PARTITION, PVC POLYVINYL CHLORIDE, PWD PLYWOOD, PRES PRESSURE TREATED, PERF PERFORATED, Q QUARTY TILE, QUARTER, R RISE/RADIUS, RAD RADIUS, RB RUBBER BASE, RCP REFLECTED CEILING PLAN, RD ROOF DRAIN, REBAR REINFORCING BAR, REF REFRIGERATOR, REIN REINFORCED, REQ REQUIRED, RES RESILIENT, REV REVERSE, RM ROOM, RO ROUGH OPENING, ROW RIGHT OF WAY, S SOUTH, SCHED SCHEDULE, SF SQUARE FEET, SIM SIMILAR, SPEC SPECIFICATION, SQN SQUARE, SST STAINLESS STEEL, STC SOUND TRANSMISSION CLASS, STD STANDARD, STL STEEL, STRG STORAGE, STRUC STRUCTURE/STRUCTURAL, SUSP SUSPENSION, T T&G TONGUE&GROOVE, TEL TELEPHONE, THK THICK, TOD TOP OF DECK, TYP TYPICAL, TV TELEVISION, TB TACK BOARD, TOC TOP OF CONCRETE, U UNDERWRITERS LABORATORIES, INC., UNIT VENTILATOR, VCT VINYL COMPOSITION TILE, VERT VERTICAL, VIF VERIFY IN FIELD, VOL VOLUME, W WEST, W/O WITHOUT, W WITH, WD WOOD, WF WIDE FLANGE, WP WORK POINT, WT WEIGHT

FIRESTOPPING DETAILS

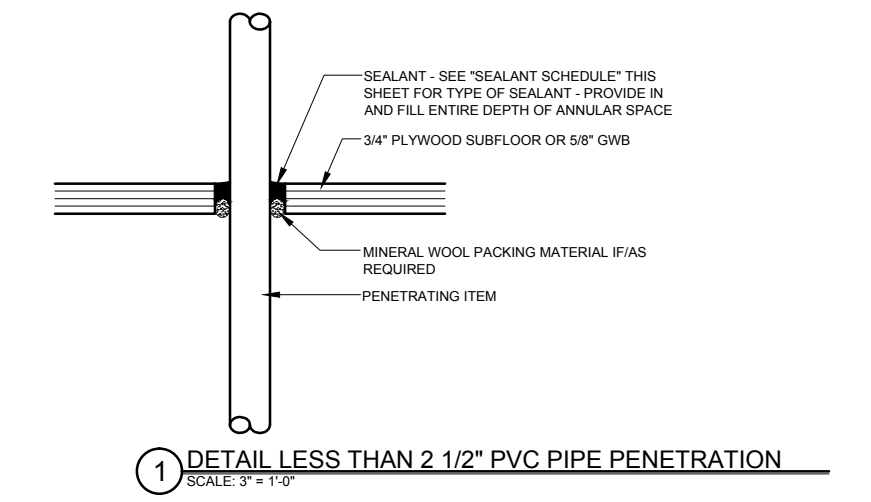
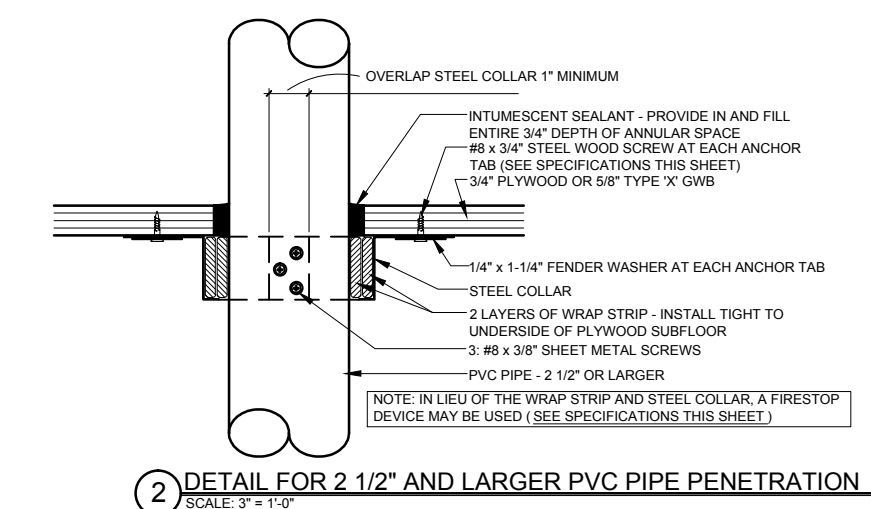

SPECIFICATIONS

WRAP STRIP - 1/4\"/>

STEEL COLLAR: WRAP STRIP MANUFACTURER'S STEEL COLLAR, FABRICATED FROM .016 INCH THICK GALVANIZED SHEET STEEL, WIDTH TO MATCH WRAP STRIP (1 1/2\"/>

INTUMESCENT SEALANT: ONE-PART, INTUMESCENT, LATEX ELASTOMER TESTED TO ASTM E 814. MINIMUM EXPANSION OF 3x AT 1000°F. 3M \"FIRE BARRIER SEALANT CP 25WB+\" OR EQUAL.

FIRESTOP SEALANT: SINGLE COMPONENT NONCOMBUSTIBLE FIRE RATED SEALANT TESTED TO ASTM E 814. TESTED TO 3000°F. \"BOSS 136 FIRESTOP/DRAFT SEALANT\" MANUFACTURED BY ACCUMETRIC, LLC. OR EQUAL.

SEALANT SCHEDULE:

INTUMESCENT SEALANT: PROVIDE AT ALL PENETRATIONS THROUGH RATED CONSTRUCTION FOR PENETRATING ITEMS INCLUDING BUT NOT LIMITED TO: PVC PIPE, ROOF LEADER PIPES, GAS PIPES & LINES, SPRINKLER PIPES, ELECTRICAL & COMMUNICATIONS CABLES & WIRES, AND ALARM SYSTEM WIRES. DO NOT USE INTUMESCENT SEALANT AT DOMESTIC HOT WATER OR HYDRONIC HEATING SYSTEM PIPES.

FIRESTOP SEALANT: PROVIDE AT ALL PENETRATIONS THROUGH RATED CONSTRUCTION FOR PENETRATING ITEMS INCLUDING DOMESTIC HOT AND COLD WATER PIPES AND HYDRONIC HEATING SYSTEM PIPES.

NOTE:

FOR LOCATIONS OF RATED CONSTRUCTION, SEE ARCHITECTURAL FLOOR PLANS AND SECTIONS

DRAWING LEGEND

Legend for drawing symbols: EARTH, POROUS FILL, CONCRETE, CONCRETE MASONRY UNIT, BRICK, STEEL, WOOD - ROUGH, GYPSUM BOARD, RIGID INSULATION, BATT INSULATION, CELLULOSE INSULATION, ROOM NAME AND NUMBER, DOOR NUMBER, WINDOW NUMBER, FLOOR-CEILING TYPE, ROOF SYSTEM TYPE, SLAB TYPE, FIRE EXTINGUISHER, ELEVATION COMPASS NUMBER, INTERIOR ELEVATION SYMBOL, SHEET WHERE ELEVATION LOCATED, FLOORING TYPE TRANSITION, SECTION NUMBER, SHT WHERE SECTION LOCATED, DETAIL NUMBER, DETAIL MARK, SHT WHERE DETAIL LOCATED, PARTITION TYPE, PARTITION TYPE TAG, SHEET METAL AND AIR CONDITIONING NATIONAL ASSOCIATION, 1HR FIRE RATED WALL, 2HR FIRE RATED WALL



© 2014 RYAN SENATORE ARCHITECTURE

NEW ELEVATOR AND LOBBY
200 LANCASTER STREET
PORTLAND, MAINE



RYAN SENATORE ARCHITECTURE
565 CONGRESS STREET
PORTLAND, MAINE 04101
207.850.6414
senatorearchitecture.com

CONSULTANTS:
STRUCTURAL: Structural Integrity
77 Oak Street
Portland, ME 04101
207.774.4614

REVISIONS:
DATE: MARCH 11, 2014
PROJECT No. 1326
DRAWN BY:
CHECKED BY: RJS
SCALE: AS NOTED

SHEET TITLE: GENERAL NOTES

G1-0