

- S Smoke Detector-replace
- S New Smoke Detector
- P Manual Pull Station
- ◀ ADA strobe-only
- ◀◀ Horn/Strobe -replace
- H Existing Horn
- MM Monitor Module
- CRM Control Relay Module
- BR Sleeping Room Plaster or gypsum walls w/10' flat plaster ceiling

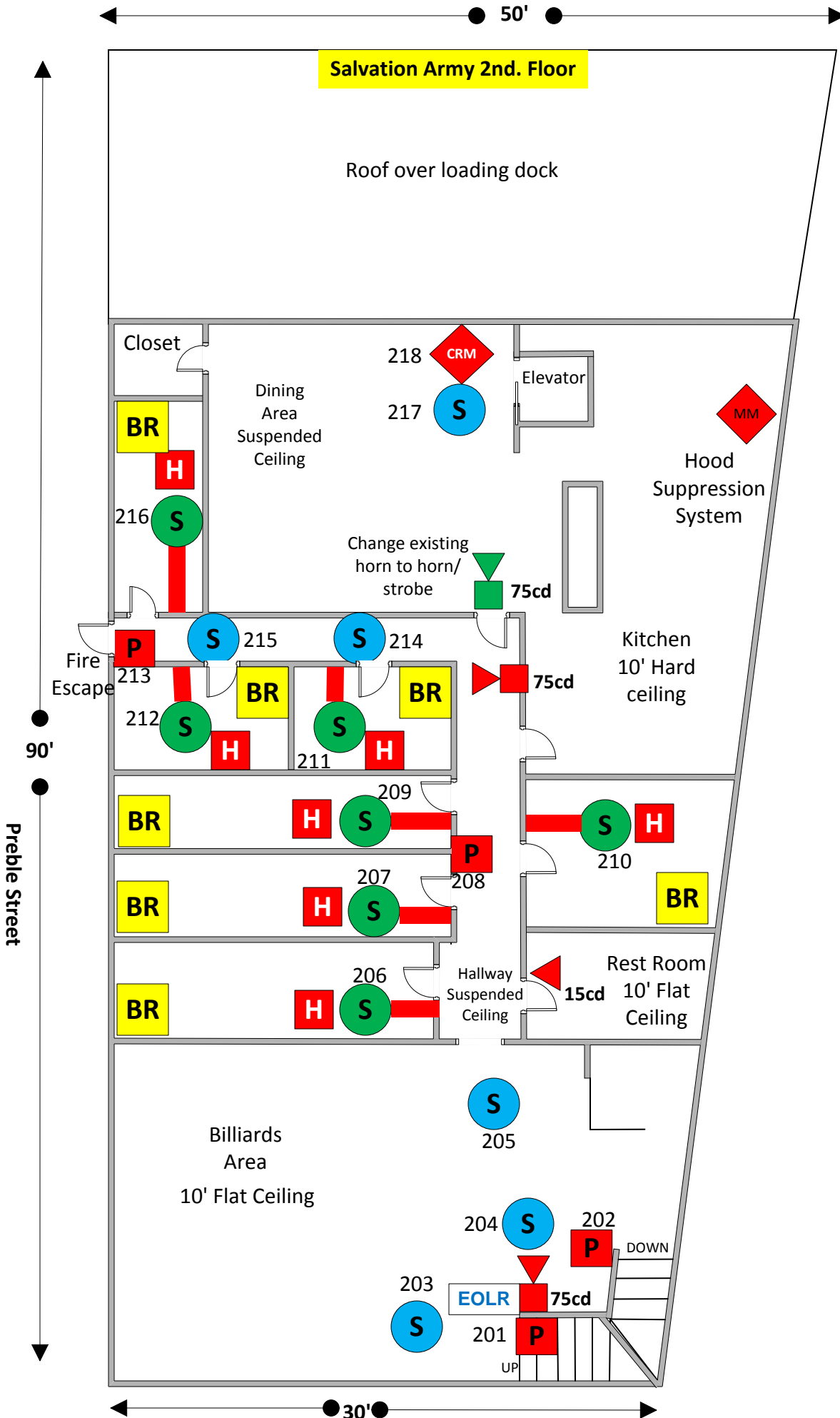

Eric Colby, Certified Engineering Technician, Level 3 NICET Cert. # 116800	Rev 0
20 Thomas Drive Westbrook ME 04092	5-1-2014

