

**City of Portland, Maine – Building or Use Permit Application** 389 Congress Street, 04101, Tel: (207) 874-8703, FAX: 874-8716

Location of Construction: 47 Alder St		Owner: Salvation Army		Phone:		Permit No: 70677	
Owner Address: 30 Warren Ave - Pld 41 04104		Lessee/Buyer's Name:		Phone:		Business Name:	
Contractor Name: The Signery		Address: 412 Forest Ave - Pld 15 04101		Phone: 3742790		Permit Issued: JUN 27 1997	
Past Use: <del>second-hand store</del> second-hand store		Proposed Use: <del>second-hand store</del> sign		COST OF WORK: \$		PERMIT FEE: \$ 35.30	
				FIRE DEPT. <input type="checkbox"/> Approved <input type="checkbox"/> Denied		INSPECTION: Use Group: Type:	
Proposed Project Description: erect sign 2' x 3' x 12'				Signature:		Signature:	
Permit Taken By: L Chase		Date Applied For: 5/17/97		PEDESTRIAN ACTIVITIES DISTRICT (P.A.D.) Action: <input type="checkbox"/> Approved <input type="checkbox"/> Approved with Conditions <input type="checkbox"/> Denied		Zoning Approval: Special Zone or Reviews: <input type="checkbox"/> Shoreland <input type="checkbox"/> Wetland <input type="checkbox"/> Flood Zone <input type="checkbox"/> Subdivision <input type="checkbox"/> Site Plan maj <input type="checkbox"/> minor <input type="checkbox"/> mm	
				Signature:		Date:	

**PERMIT ISSUED**  
JUN 27 1997  
**CITY OF PORTLAND**

1. This permit application does not preclude the Applicant(s) from meeting applicable State and Federal rules.
2. Building permits do not include plumbing, septic or electrical work.
3. Building permits are void if work is not started within six (6) months of the date of issuance. False information may invalidate a building permit and stop all work.

**Zoning Appeal**

Variance  
 Miscellaneous  
 Conditional Use  
 Interpretation  
 Approved  
 Denied

**Historic Preservation**

Not in District or Landmark  
 Does Not Require Review  
 Requires Review

**Action:**

Approved  
 Approved with Conditions  
 Denied

Date: \_\_\_\_\_

**CERTIFICATION**

I hereby certify that I am the owner of record of the named property, or that the proposed work is authorized by the owner of record and that I have been authorized by the owner to make this application as his authorized agent and I agree to conform to all applicable laws of this jurisdiction. In addition, if a permit for work described in the application is issued, I certify that the code official's authorized representative shall have the authority to enter all areas covered by such permit at any reasonable hour to enforce the provisions of the code(s) applicable to such permit

SIGNATURE OF APPLICANT: *L Chase* ADDRESS: DATE: PHONE:

RESPONSIBLE PERSON IN CHARGE OF WORK, TITLE: PHONE:

PERMIT ISSUED WITH REQUIREMENTS

CEO DISTRICT 7

**City of Portland, Maine – Building or Use Permit Application** 389 Congress Street, 04101, Tel: (207) 874-8703, FAX: 874-8716

Location of Construction: 49 Alder St		Owner: Salvation Army		Phone:		Permit No: 970677	
Owner Address: 30 Warren Ave- Ptld ME 04104		Lessee/Buyer's Name:		Phone:		BusinessName:	
Contractor Name: The Signery		Address: 449 Forest Ave- Ptld ME 04101		Phone: 8797700		Permit Issued: JUN 27 1997	
Past Use: <del>second-hand store</del> second-hand store		Proposed Use: second-hand store <del>sign</del> sign		COST OF WORK: \$		PERMIT FEE: \$ 35.80	
Proposed Project Description:  erect sign <del>3' x 10'</del> x3' X 10'		FIRE DEPT. <input type="checkbox"/> Approved <input type="checkbox"/> Denied		INSPECTION: Use-Group: Type:		Zone: CBL: B-2-033-D-008	
		Signature:		Signature: <i>[Signature]</i>		Zoning Approval: OK per reversal	
Permit Taken By: L Chase		Date Applied For: 6/12/97		PEDESTRIAN ACTIVITIES DISTRICT (P.A.D.) Action: <input type="checkbox"/> Approved <input type="checkbox"/> Approved with Conditions <input type="checkbox"/> Denied		Special Zone or Reviews: <input type="checkbox"/> Shoreland <input type="checkbox"/> Wetland <input type="checkbox"/> Flood Zone <input type="checkbox"/> Subdivision <input type="checkbox"/> Site Plan maj <input type="checkbox"/> minor <input type="checkbox"/> mm <input type="checkbox"/>	
				Signature: _____ Date: _____		No Roof Top Zoning Appeal <input type="checkbox"/> Variance <input type="checkbox"/> Miscellaneous <input type="checkbox"/> Conditional Use <input type="checkbox"/> Interpretation <input type="checkbox"/> Approved <input type="checkbox"/> Denied	

1. This permit application does not preclude the Applicant(s) from meeting applicable State and Federal rules.
2. Building permits do not include plumbing, septic or electrical work.
3. Building permits are void if work is not started within six (6) months of the date of issuance. False information may invalidate a building permit and stop all work..

**CERTIFICATION**

I hereby certify that I am the owner of record of the named property, or that the proposed work is authorized by the owner of record and that I have been authorized by the owner to make this application as his authorized agent and I agree to conform to all applicable laws of this jurisdiction. In addition, if a permit for work described in the application is issued, I certify that the code official's authorized representative shall have the authority to enter all areas covered by such permit at any reasonable hour to enforce the provisions of the code(s) applicable to such permit

*Just Gary*  
SIGNATURE OF APPLICANT

ADDRESS: \_\_\_\_\_ DATE: 6-12-97 PHONE: \_\_\_\_\_

RESPONSIBLE PERSON IN CHARGE OF WORK, TITLE \_\_\_\_\_ PHONE: \_\_\_\_\_

Permit Issued WITH REQUIREMENTS

**Historic Preservation**  
 Not in District or Landmark  
 Does Not Require Review  
 Requires Review

**Action:**  
 Approved  
 Approved with Conditions  
 Denied  
 Date: 6/13/97

*D. Andrews*  
 CEO DISTRICT 2  
*d. Rose*

Per Application

6/12/97

**SIGNAGE**

**PLEASE ANSWER ALL QUESTIONS**

ADDRESS: 49 ALDER ST., PORTLAND ZONE: B-2

OWNER: THE SALVATION ARMY

APPLICANT: THE SALVATION ARMY

ASSESSOR NO.: \_\_\_\_\_

SINGLE TENANT LOT? YES X NO \_\_\_\_\_

MULTI TENANT LOT? YES \_\_\_\_\_ NO \_\_\_\_\_

FREESTANDING SIGN? YES \_\_\_\_\_ NO \_\_\_\_\_ DIMENSIONS \_\_\_\_\_  
(ex. pole sign..)

MORE THAN ONE SIGN? YES \_\_\_\_\_ NO \_\_\_\_\_ DIMENSIONS \_\_\_\_\_

BLDG. WALL SIGN? YES X NO \_\_\_\_\_ DIMENSIONS 36" x 216"  
(attached to bldg)

MORE THAN ONE SIGN? YES \_\_\_\_\_ NO X DIMENSIONS \_\_\_\_\_

LIST ALL EXISTING SIGNAGE AND THEIR DIMENSIONS: \_\_\_\_\_

EXISTING SIGNAGE WILL BE REMOVED

LOT FRONTAGE (FEET) 150'

BLDG FRONTAGE (FEET) 60' x 2 = 120'

AWNING YES \_\_\_\_\_ NO X IS AWNING BACKLIT? YES \_\_\_\_\_ NO \_\_\_\_\_

HEIGHT OF AWNING: \_\_\_\_\_

IS THERE ANY COMMUNICATION, MESSAGE, TRADEMARK OR SYMBOL ON IT? N/A

Not Allowed  
↓  
Roof top  
3 x 18 = 54'

Note:  
see revised drawing that relocates sign to side of Bldg dated 6/25/97

**A SITE SKETCH AND BUILDING SKETCH SHOWING EXACTLY WHERE EXISTING AND NEW SIGNAGE IS LOCATED MUST BE PROVIDED. SKETCHES AND/OR PICTURES OF THE PROPOSED SIGNS ARE ALSO REQUIRED.**

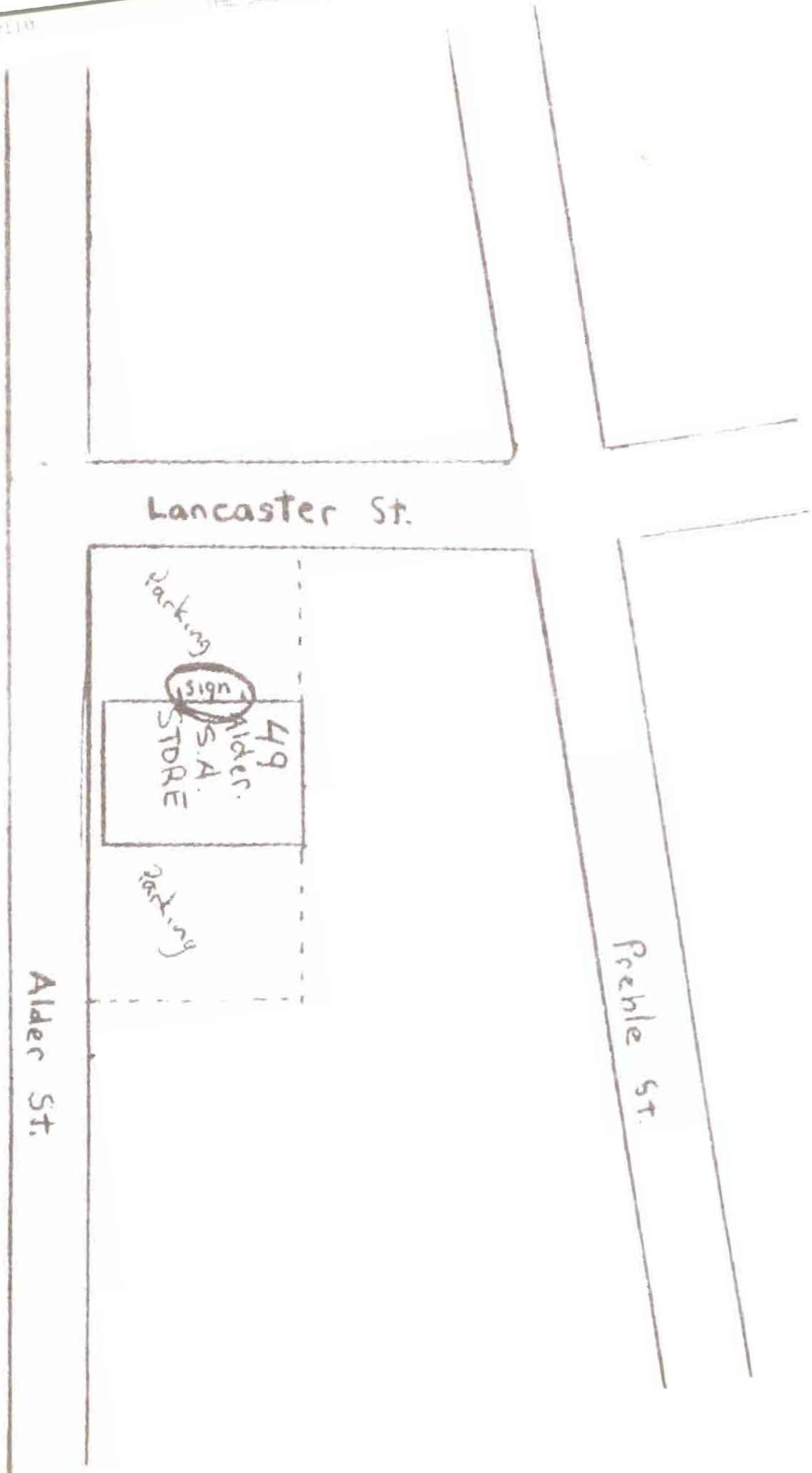

Lancaster St.

Alder St.

Prehle St.

Parking

Parking

49 Alder St.  
S.A. STORE

sign



# THE SALVAT N ARMY

Adult Rehabilitation  
P.O. Box 1274  
10 Warren Avenue  
Orland, Maine  
(207) 878-8555

## Facsimile Transmission Cover Sheet

DATE

6/15/14

9:30

21

SEND

878 8555

Don Wigg

The Signery

Darren Bantz

Stores

Map sketch for Alder St.

NO. OF PAGES

2

I'm a sketcher not what you need pls  
let me know and I will red. it

Please note that the map is for  
Lancaster St. The map is not to be placed  
directly over/above the present map

Thank

Don Wigg

1-2



Released  
6/25/97

The

Asst. Dir. of  
State Police  
Portland, Ore.

Dear Sir:  
I am  
writing  
you today

## BUILDING PERMIT REPORT

DATE: 26 June 97 ADDRESS: 49 Alder ST  
REASON FOR PERMIT: To erect sign  
BUILDING OWNER: Salvation Army  
CONTRACTOR: The Signery  
PERMIT APPLICANT: \*Mr. Gay APPROVAL: \*1 ~~DENIED~~

### CONDITION(S) OF APPROVAL

1. This permit does not excuse the applicant from meeting applicable State and Federal rules and laws.
2. Before concrete for foundation is placed, approvals from the Development Review Coordinator and Inspection Services must be obtained. (A 24 hour notice is required prior to inspection)
3. Precaution must be taken to protect concrete from freezing.
4. It is strongly recommended that a registered land surveyor check all foundation forms before concrete is placed. This is done to verify that the proper setbacks are maintained.
5. Private garages located beneath habitable rooms in occupancies in Use Group R-1, R-2, R-3 or I-1 shall be separated from adjacent interior spaces by fire partitions and floor/ceiling assembly which are constructed with not less than 1-hour fire resisting rating. Private garages attached side-by-side to rooms in the above occupancies shall be completely separated from the interior spaces and the attic area by means of ½ inch gypsum board or the equivalent applied to the garage means of ½ inch gypsum board or the equivalent applied to the garage side. (Chapter 4 Section 407.0 of the BOCA/1996)
6. All chimneys and vents shall be installed and maintained as per Chapter 12 of the City's Mechanical Code. (The BOCA National Mechanical Code/1993) U.L. 103.
7. Sound transmission control in residential building shall be done in accordance with Chapter 12 section 1214.0 of the city's building code.
8. Guardrail & Handrails A guardrail system is a system of building components located near the open sides of elevated walking surfaces for the purpose of minimizing the possibility of an accidental fall from the walking surface to the lower level. Minimum height all Use Groups 42" , except Use Group R which is 36". In occupancies in Use Group A, B, H-4, I-1, I-2 M and R and public garages and open parking structures, open guards shall have balusters or be of solid material such that a sphere with a diameter of 4" cannot pass through any opening. Guards shall not have an ornamental pattern that would provide a ladder effect.
9. Headroom in habitable space is a minimum of 7'6".
10. Stair construction in Use Group R-3 & R-4 is a minimum of 10" tread and 7 3/4" maximum rise. All other Use group minimum 11" tread. 7" maximum rise.
11. The minimum headroom in all parts of a stairway shall not be less than 80 inches.
12. Every sleeping room below the fourth story in buildings of use Groups R and I-1 shall have at least one operable window or exterior door approved for emergency egress or rescue. The units must be operable from the inside without the use of special knowledge or separate tools. Where windows are provided as means of egress or rescue they shall have a sill height not more than 44 inches (1118mm) above the floor. All egress or rescue windows from sleeping rooms shall have a minimum net clear opening height dimension of 24 inches (610mm). The minimum net clear opening width dimension shall be 20 inches (508mm), and a minimum net clear opening of 5.7 sq. ft.
13. Each apartment shall have access to two (2) separate, remote and approved means of egress. A single exit is acceptable when it exits directly from the apartment to the building exterior with no communications to other apartment units.
14. All vertical openings shall be enclosed with construction having a fire rating of at least one (1)hour, including fire doors with self closer's.
15. The boiler shall be protected by enclosing with (1) hour fire-rated construction including fire doors and ceiling, or by providing automatic extinguishment.
16. All single and multiple station smoke detectors shall be of an approved type and shall be installed in accordance with the provisions of the City's Building Code Chapter 9, Section 19, 920.3.2 (BOCA National Building Code/1996), and NFPA 101 Chapter 18 & 19. (Smoke detectors shall be installed and maintained at the following locations):
  - In the immediate vicinity of bedrooms
  - In all bedrooms
  - In each story within a dwelling unit, including basements

In addition to the required AC primary power source, required smoke detectors in occupancies in Use Groups R-2, R-3 and



I-1 shall receive power from a battery when the AC primary power source is interrupted. (Interconnection is required)

17. A portable fire extinguisher shall be located as per NFPA #10. They shall bear the label of an approved agency and be of an approved type.  
The Fire Alarm System shall be maintained to NFPA #72 Standard.
19. The Sprinkler System shall maintained to NFPA #13 Standard.
20. All exit signs, lights, and means of egress lighting shall be done in accordance with Chapter 10 Section & Subsections 1023. & 1024. Of the City's building code. (The BOCA National Building Code/1996)
21. All construction and demolition debris must be disposed at the City's authorized reclamation site. The fee rate is attached. Proof of such disposal must be furnished to the office of Inspection Services before final Certificate of Occupancy is issued or demolition permit is granted.
22. Section 25-135 of the Municipal Code for the City of Portland states, "No person or utility shall be granted a permit to excavate or open any street or sidewalk from the time of November 15 of each year to April 15 of the following year".
23. The builder of a facility to which Section 4594-C of the Maine State Human Rights Act Title 5 MRSA refers, shall obtain a certification from a design professional that the plans commencing construction of the facility, the builder shall submit the certification to the Division of Inspection Services.
24. This permit does not excuse the applicant from obtaining any license which may be needed from the City Clerk's office.
25. Ventilation shall meet the requirements of Chapter 12 Sections 1210. of the City's Building Code.
26. All electrical and plumbing permits must be obtained by a Master Licensed holders of their trade.
- X 27. ~~This permit doesn't authorize any roof top signs.~~
- X 28. ~~Before attaching sign to building, please submit a structural details of how the sign will be mounted on the building.~~
- 29.

  
P. Samuel Hoffes, Chief of Code Enforcement

Lt. McDougall, PFD  
Marge Schmuckal