

COPYRIGHT: Reuse or reproduction of the contents of this document is not permitted without written permission of Bild Architecture LLC

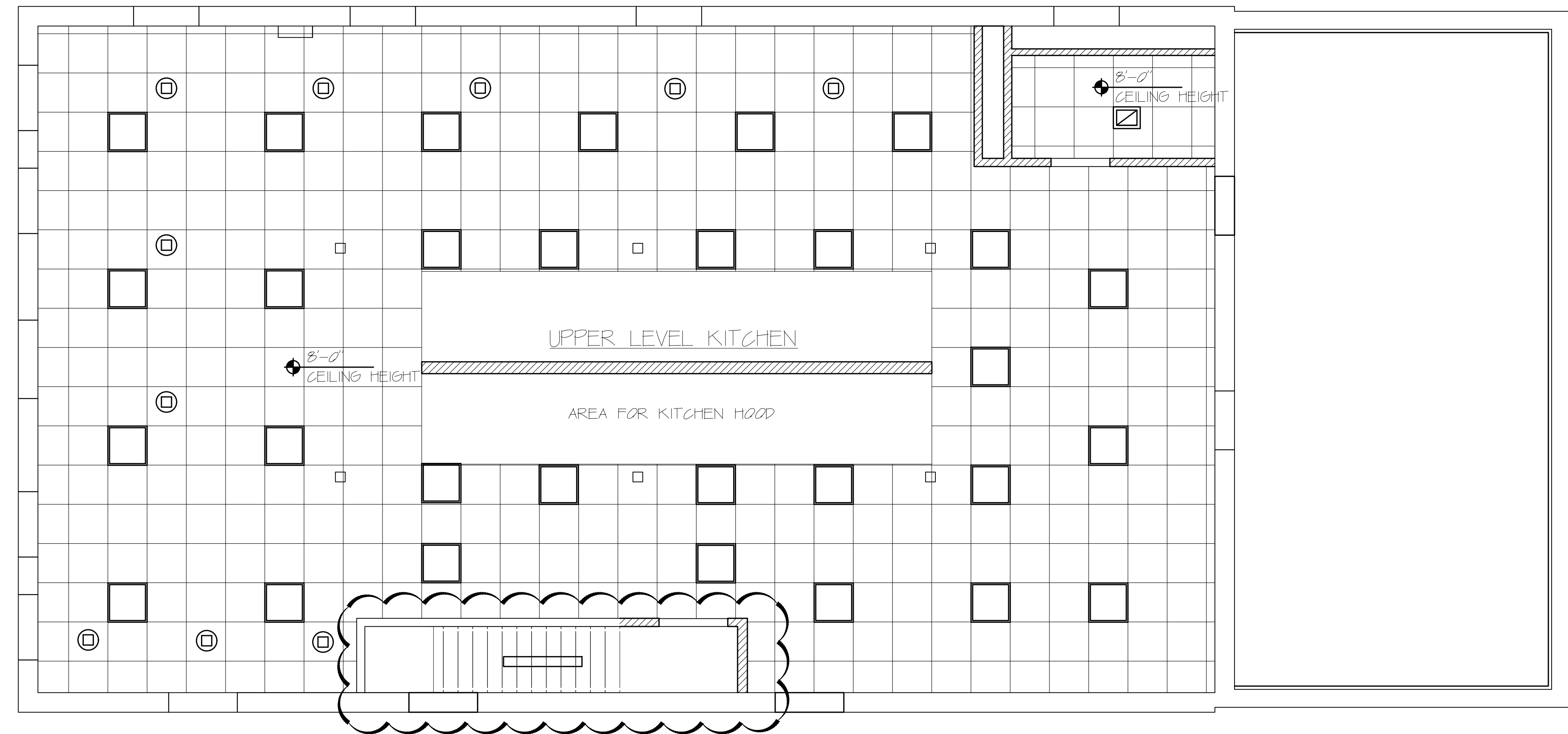
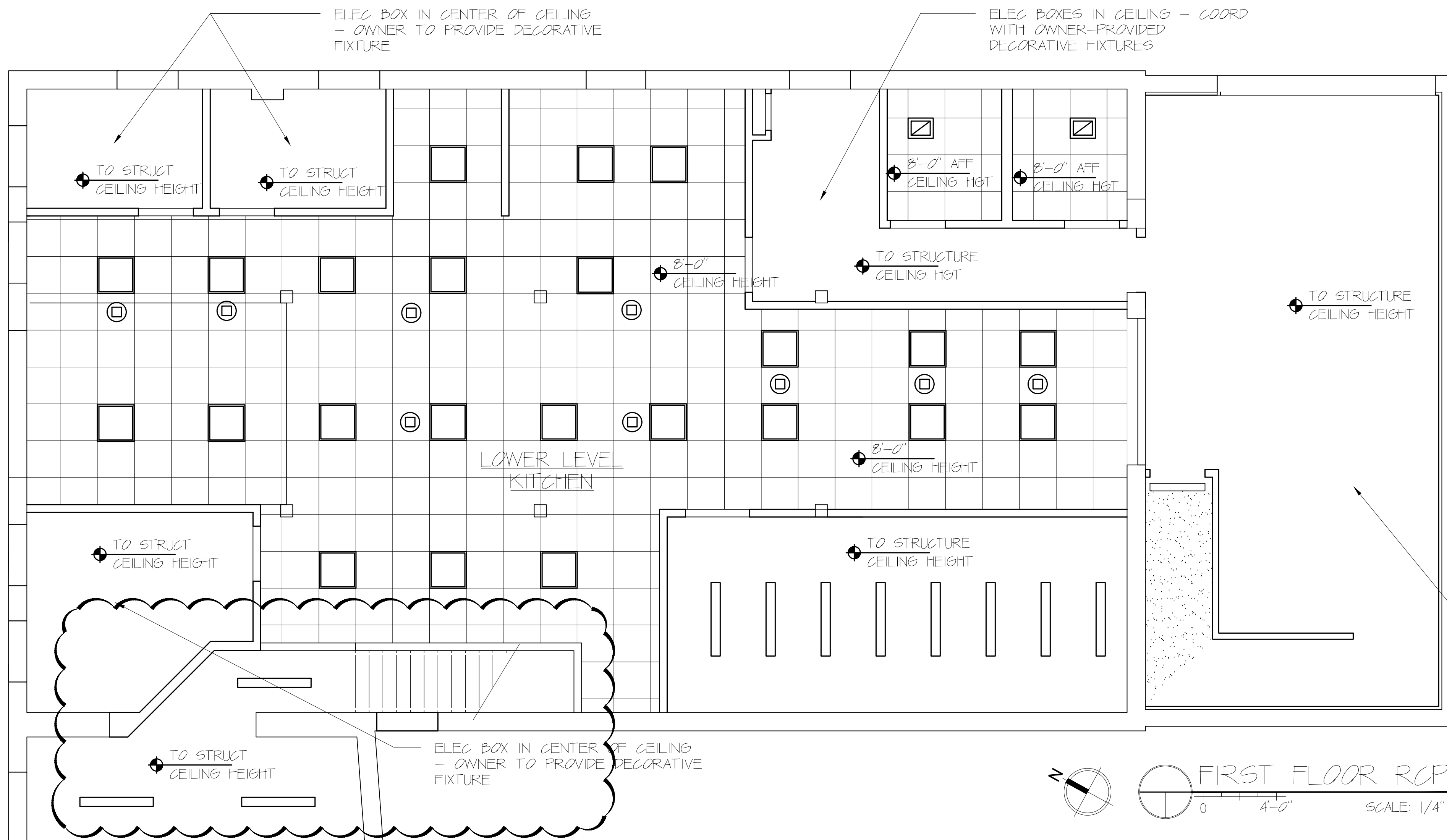

REFLECTED CEILING PLAN LEGEND:

- CEILING HEIGHT ELEVATION
- 2X2 CEILING GRID W/ ACOUSTICAL TILE (ACT-I)
- GYPSUM BOARD CEILING
- 2' X 2' LED LIGHTING
- BATH FAN/LIGHT
- RECESSED CAN
- ELECTRICAL CORD FROM CEILING
- TB OR SIMILAR LED FIXTURE
- ELEC BOXES IN CEILING - COORD WITH OWNER-PROVIDED DECORATIVE FIXTURES

REFLECTED CEILING PLAN NOTES:

1. ALL CEILING GRID AND TILE TO BE LOCATED IN CENTER OF ROOM UNLESS OTHERWISE SHOWN. INTENT OF ARCHITECTURAL DRAWING IS THAT ALL AREAS BE SHOWN WITH GRID AT CENTER OF ROOM. CONTACT ARCHITECT FOR DIRECTION BEFORE CEILING INSTALLATION IF CENTER ALIGNMENT IS NOT INDICATED ON PLAN.
2. ALL GYPSUM CEILING TO BE PAINTED UNLESS NOTED OTHERWISE.
3. ANY DISCREPANCIES BETWEEN ARCHITECTURAL RCP & ELECTRICAL DRAWINGS TO BE VERIFIED BY ARCHITECT BEFORE INSTALLATION.
4. SEE LIFE SAFETY DRAWINGS FOR LOCATIONS OF ALL EMERGENCY LIGHTING.
5. ALL HEIGHTS ARE FROM THE LOWEST FLOOR ELEVATION UNLESS OTHERWISE NOTED.
6. CORD WITH MECH ON DIFFUSERS AND GRILLES

APPLICANT
 FORQ, LLC
 Neil Spillane, Manager
 78 Winter Street
 Portland, Maine 04102
 Tell: 207-400-5145

Bild Architecture
 PO Box 8235
 Portland, ME 04104
 207.408.0168
 evan@bildarchitecture.com

FORQ FOOD LABS
 PORTLAND, MAINE

PROJECT NO. **15014**
 PROJECT NAME **FORQ FOOD LABS**

ISSUE DATE **1/13/16**
 SHEET SCALE **1/4" = 1'-0"**

DRAWN BY **AEW**
 SHEET TITLE **REFLECTED CEILING PLAN**

CONSTRUCTION SET
 SUBJECT TO CODE CHANGES

REVISIONS
 1 3/5/16
 2 3/18/16
 3
 4

ISSUED ARCHITECT
 1/13/16
 EVAN A. CARROLL
 No. 3687
 STATE OF MAINE

A
1.3