

WHARF STREET

DANA STREET

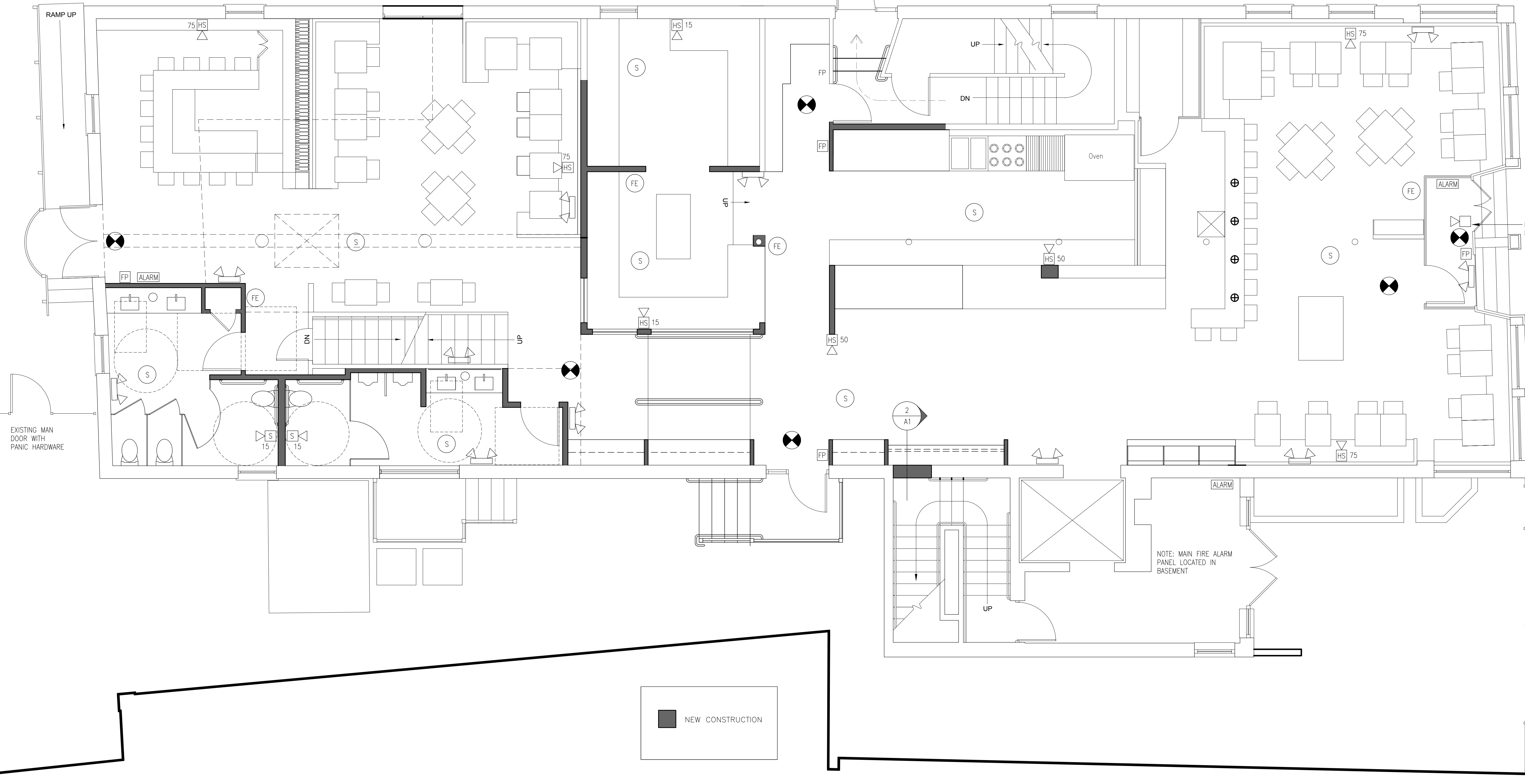

EXISTING, HS, EXIT, EMERGENCY LIGHT AND FIRE PULL

EXISTING MAN DOOR WITH PANIC HARDWARE

NOTE: MAIN FIRE ALARM PANEL LOCATED IN BASEMENT

NEW CONSTRUCTION

Restaurant Renovation

Vignola Cinque Terre  
10 Dana St. Portland Maine 04101 36 Wharf St. Portland Maine 04101

LIFE SAFETY PLAN

BUILDING ENVELOPE CONSULTANTS

191 STANFORD ST.  
SOUTH PORTLAND  
MAINE, 04106  
TEL. 207-400-0086

DRAWN BY: DPD

CHECKED BY: SRW

ISSUE DATE: 12-28-2011

PORTLAND PERMIT SET

DATE: 12-28-2011

REVISIONS

1 -

SCALE: 3/16"=1'-0"

1 LIFE SAFETY PLAN

LIFE SAFETY LEGEND

	FIRE ALARM PULL AT EACH EXIT
	EMERGENCY ILLUMINATION
	SMOKE DETECTOR
	FIRE ALARM HORN STROBE
	ILLUMINATED EXIT SIGN
	FIRE EXTINGUISHER
	FIRE REMOTE ALARM PANELS

- NOTES:
1. DESIGN AND INSTALLATION OF FIRE ALARM PANEL, AND OTHER ELEMENTS BY OTHERS. THIS DRAWING INTENDED TO SHOW BASIC LAYOUT OF LIFE SAFETY SYSTEMS FOR APPROVAL BY A.H.J. IT IS THE RESPONSIBILITY OF THE CONTRACTOR TO COORDINATE DESIGN AND INSTALLATION WITH SUBCONTRACTORS AND OWNER. CONTRACTOR TO INSTALL A COMPLETE APPROVED AND WORKING SYSTEM BASED ON APPROVED DESIGN BY A.H.J REGARDLESS THE INFORMATION IN THIS DRAWING - THIS DRAWING FOR DESIGN INTENT ONLY.
  2. REUSE EXISTING ALARM FIXTURES AS POSSIBLE, PROVIDE TWO NEW REMOTE ANNUNCIATOR PANELS AT EACH RESTAURANT ENTRANCE TIED INTO THE MAIN PANEL.
  3. UPDATE KITCHEN HOOD SUPPRESSION SYSTEM AS NEEDED
  4. TIE EXISTING FIRE PROTECTION IN BASEMENT INTO NEW SYSTEM.

2 NOTES

A2

DRAWING NUMBER

SCALE: 3/16"=1'-0"

PROJECT NUMBER: 050-11

SCALE: 3/16"=1'-0"