

**GENERAL NOTES**

**1: DRAWING NOTES:**  
CONTRACTOR TO FURNISH AND INSTALL ALL NOTED LABOR AND MATERIALS UNLESS OTHERWISE NOTED.

**2: CODE COMPLIANCE:**  
ALL WORK SHALL CONFORM TO THE LATEST EDITION OF STATE, LOCAL AND OTHER CODES WHICH APPLY TO THIS PROJECT OR HAVE JURISDICTION.

**3: COORDINATION:**  
IT IS THE RESPONSIBILITY OF THE CONTRACTOR TO COORDINATE ALL DISCIPLINES AND TRADES SO THAT ALL BUILDING SYSTEMS AND COMPONENTS CAN BE ASSEMBLED WITHOUT CONFLICTS. IN THE EVENT THAT THE CONSTRUCTOR DOCUMENTS DEFINE CONDITIONS WHICH PROHIBIT, OR MAY PROHIBIT, SUCH ASSEMBLY, THE CONTRACTOR SHALL BRING TO THE ARCHITECTS ATTENTION, IN WRITING AND IN A TIMELY FASHION, SUCH CONDITION. THE CONTRACTOR SHALL NOT PROCEED WITH RELATED WORK WITHOUT A WRITTEN RESOLUTION CLARIFICATION FROM THE ARCHITECT.  
THE CONTRACTOR AND HIS/HER SUBCONTRACTORS SHALL BE RESPONSIBLE FOR PROVIDING MATERIALS AND SYSTEMS SHOWN IN THE CONSTRUCTION DOCUMENTS REGARDLESS OF WHERE THE INFORMATION IS LOCATED. WHERE COMPONENTS OF A SYSTEM ARE INDICATED THE CONTRACTOR SHALL BE RESPONSIBLE FOR PROVIDING ALL LABOR AND MATERIALS NECESSARY TO COMPLETE THE SYSTEM.

**4: DISCREPANCIES & CLARIFICATIONS:**  
THIS PROJECT INVOLVES THE FIT-UP OF AN EXISTING BUILDING. EXISTING DIMENSIONS SHOWN ON THE DRAWINGS ARE BELIEVED TO BE ACCURATE, BUT CANNOT BE GUARANTEED. MEASURE AND VERIFY DIMENSIONS IN FIELD PRIOR TO FABRICATION AND CONSTRUCTION. IT IS THE RESPONSIBILITY OF THE CONTRACTOR TO BRING TO THE ARCHITECTS ATTENTION, IN WRITING, ANY DISCREPANCIES OR AMBIGUITIES IN THE DRAWINGS AND/OR SPECIFICATIONS. THE CONTRACTOR SHALL NOT PROCEED WITH RELATED WORK WITHOUT A WRITTEN RESOLUTION OR CLARIFICATION FROM THE ARCHITECT.

**5: LAYOUT:**  
UNLESS INDICATED OTHERWISE, CENTER WALL FRAMING AND PARTITION FRAMING ON COLUMN LINES. FLOOR PLAN DIMENSIONS ARE TO CENTER OF FRAMING, FACE OF CONCRETE, FACE OF CMU, OR FROM COLUMN CENTERLINES, UNLESS INDICATED OTHERWISE. DOORS AND WINDOWS ARE DIMENSIONED TO CENTERLINES UNLESS INDICATED OTHERWISE.

**6: CENTERING:**  
UNLESS INDICATED OTHERWISE, CENTER BUILDING ELEMENTS WITHIN OR BETWEEN OTHER BUILDING ELEMENTS WHEN CONDITIONS OR THE DRAWINGS INDICATE OR IMPLY THAT SUCH IS THE INTENT, WHETHER OR NOT DIMENSIONS ARE INCLUDED.

**7: SYMMETRY:**  
WHERE CONDITIONS OR THE DRAWINGS INDICATE OR IMPLY THAT SYMMETRY IS INTENDED, INFORMATION PROVIDED AT ONE SIDE APPLIES EQUALLY TO BOTH SIDES, UNLESS CONDITIONS CLEARLY PRECLUDE SUCH APPLICATION.

**8: ACCESSIBILITY:**  
ALL HANDICAPPED ACCESSIBLE BATHROOMS, GRAB BARS, AND DOOR OPENINGS SHALL MEET THE REQUIREMENTS OF TITLE 94-34B, CHAPTER 5 OF THE MAINE HUMAN RIGHTS COMMISSION TITLE LATEST EDITION & THE DEPARTMENT OF JUSTICE ADA STANDARDS FOR ACCESSIBLE DESIGN.

**9: DRAWING SCALES:**  
WORK FROM THE GIVEN DIMENSIONS ONLY. SCALE IS INDICATED ON THE DRAWINGS FOR CONVENIENCE ONLY. IT IS NOT INTENDED THAT INFORMATION BE DETERMINED BY SCALES IN THE DRAWINGS SINCE SOME ITEMS MAY NOT BE TO SCALE.

**10: WATER-RESISTANT GWB:**  
INSTALL WATER-RESISTANT GYPSUM WALL BOARD IN ALL REST ROOMS & TOILET ROOMS OR AT ANY WALL WITH PLUMBING FIXTURES.

**10A: HIGH IMPACT GWB:**  
INSTALL HIGH IMPACT GYPSUM WALL BOARD IN ALL STAIRWELLS

**11: INTERIOR ELEVATIONS:**  
INTERIOR ELEVATIONS MAY BE REVERSED FROM AND/OR SIMILAR TO ACTUAL CONDITIONS. SEE FLOOR PLANS FOR WINDOW AND DOOR QUANTITIES AND LOCATIONS, FOR CASEWORK LAYOUTS, AND FOR MONITOR LOCATIONS.

**12: BUILDING INSULATION:**  
PROVIDE AS INDICATED IN WALL SECTIONS AND IN ACCORDANCE WITH PARTITION TYPES, WHETHER OR NOT SHOWN IN DETAILS AND OTHER DRAWINGS. FOR CLARITY, INSULATION MAY NOT BE SHOWN IN SOME CASES, EVEN IF IT IS TO BE PROVIDED.

**13: BLOCKING:**  
INSTALL BLOCKING BEHIND ALL SURFACE-APPLIED FIXTURES TRIM, CASEWORK, SHELVES, BRACKETS, TOILET ACCESSORIES, CHAIR RAILS, PICTURE RAILS, GRAB BARS, BASE MOLDINGS, AND AS OTHERWISE REQUIRED, WHEN SUCH ITEMS ARE APPLIED ON STUD WALLS.

**14: PENETRATIONS AT STRUCTURAL MEMBERS:**  
BEFORE PENETRATING JOISTS, BEAMS OR OTHER STRUCTURAL MEMBERS, CONSULT WITH THE ARCHITECT.

**15: DAMAGED WORK:**  
BUILDING OR SITE COMPONENTS WHICH ARE AFFECTED BY NEW WORK, DEMOLITION, OR WHICH MAY BE DAMAGED BY THE GENERAL CONTRACTOR OR ANY SUB-CONTRACTOR SHALL BE REPLACED OR RESTORED TO ORIGINAL CONDITION AND COLOR TO MEET THE APPROVAL OF THE ARCHITECT.

**16: UTILITIES:**  
VERIFY THE SIZE AND LOCATION OF ALL UNDERGROUND UTILITIES AND REPORT ANY DISCREPANCIES TO THE ARCHITECT IN WRITING. DO NOT PROCEED WITH WORK UNTIL THE DISCREPANCY HAS BEEN RESOLVED TO THE SATISFACTION OF THE ARCHITECT.

**17: RATED CONSTRUCTION:**  
PROVIDE RATED CONSTRUCTION AS REQUIRED BY CODE, AS SPECIFIED, AND AS INDICATED ON DRAWINGS. IT IS THE RESPONSIBILITY OF THE CONTRACTOR TO PROVIDE AND INSTALL ALL COMPONENTS REQUIRED TO CREATE SUCH RATED CONSTRUCTION, REGARDLESS OF WHETHER OR NOT SUCH COMPONENTS ARE INDICATED. PROVIDE CONTINUITY OF SUCH RATED CONSTRUCTION AROUND AND BETWEEN SPACES, INCLUDING AT CHASES AND AT FLOORS, TO MAINTAIN COMPLETE SEPARATIONS, EVEN IF NOT SPECIFICALLY INDICATED.

**18: SHOP DRAWINGS:**  
SUBMIT SHOP DRAWINGS TO THE ARCHITECT FOR REVIEW PRIOR TO FABRICATIONS. SUBMITTALS REQUIRED INCLUDE, BUT ARE NOT LIMITED TO, SHOP DRAWINGS FOR ALL PREFABRICATED CONCRETE, STEEL, MILLWORK & SIGNAGE, SAMPLES OF ALL PROPOSED PAINTS, METALS, WALL COVERINGS, LAMINATES, SOLID SURFACE MATERIALS, CERAMIC TILE, AND HARDWARE. SUBMIT MANUFACTURERS' DATA FOR ALL LIGHTING SYSTEMS, AND HARDWARE.

**19: PERMITS:**  
THE GENERAL CONTRACTOR SHALL OBTAIN AND PAY FOR ANY BUILDING PERMITS REQUIRED AND CARRY ANY INSURANCE COVERAGES REQUIRED.

**20: INTERIOR FINISHES:**  
ALL INTERIOR FINISHES AND FURNISHINGS ARE TO BE CLASS 'A' FIRE-RATED AND ARE TO COMPLY WITH IBC CHAPTER-8 (INTERIOR FLAME SPREAD).

**21: ELECTRICAL DESIGN:**  
REFER TO ELECTRICAL DRAWINGS AND SPECIFICATIONS

**22: WASTE REMOVAL:**  
THE GENERAL CONTRACTOR SHALL DISPOSE OF ALL WASTE AND DEBRIS OFF THE PREMISES.

**23: LANDLORD COORDINATION:**  
THE GENERAL CONTRACTOR MUST COORDINATE WITH THE BUILDING OWNER ALL ACTIVITIES INCLUDING BUT NOT LIMITED TO WORK WHICH WILL GENERATE EXCESSIVE NOISE AND MODIFICATION TO UTILITIES. WORK MUST NOT INTERFERE WITH EXISTING SMOKE DETECTORS, ALARMS OR BUILDING SYSTEM MANAGEMENT.

**24: TEMPORARY FACILITIES:**  
PROVIDE ALL TEMPORARY FACILITIES AND SERVICES, CONSTRUCTION AND SUPPORT FACILITIES, AND SECURITY AND PROTECTION AS NEEDED TO PROTECT NEW AND EXISTING CONSTRUCTION FOR THE DURATION OF A COMPLETE INSTALLATION.

**25: FINAL CLEANING:**  
EMPLOY EXPERIENCED WORKERS FOR FINAL CLEANING. CLEAN EACH SURFACE TO THE CONDITION EXPECTED IN A COMMERCIAL BUILDING CLEANING PROGRAM.

**26: MANUFACTURERS INSTRUCTIONS:**  
ALL MATERIALS & EQUIPMENT SHALL BE INSTALLED ACCORDING TO MANUFACTURER'S SPECIFICATIONS.

**27: GUARANTEE:**  
GUARANTEE: ALL MATERIALS AND WORKMANSHIP SHALL BE GUARANTEED FOR A PERIOD OF ONE YEAR FROM THE DATE OF FINAL ACCEPTANCE UNLESS OTHERWISE SPECIFIED FOR A LONGER PERIOD OF TIME ON A CERTAIN ITEM.

**28: ASBESTOS:**  
ALL MATERIAL USED FOR THE CONSTRUCTION OF THIS PROJECT, WHETHER BUILDING MATERIALS OR APPURTENANCES, SHALL BE NON-ASBESTOS CONTAINING MATERIAL.

**29: HAZARDOUS FUMES:**  
THE GENERAL CONTRACTOR SHALL CONFIRM THAT ALL MATERIAL AND FINISHES SPECIFIED AND THEIR FABRICATION OR INSTALLATION WILL NOT RELEASE FUMES OR AROMAS DURING CONSTRUCTION WHICH MAY BE A HAZARD OR NUISANCE TO PERSONNEL.

**30: PEST CONTROL:**  
SEAL AND CALK AROUND ALL PENETRATIONS, CRACKS AND CREVICES AND ANY OPENINGS CAPABLE OF HARBORING INSECTS/RODENTS.

**31: EXPOSED UTILITIES:**  
ALL EXPOSED UTILITY WIRES AND PIPES (ELECTRICAL, PLUMBING, ETC.) SHALL BE INSTALLED IN A WAY THAT DOES NOT OBSTRUCT OR PREVENT THE CLEANING OF FLOORS, WALLS, AND CEILING AREAS. THEY SHALL BE INSTALLED A MINIMUM OF 6" OFF FLOORS AND 1" OFF WALLS, CEILINGS AND ADJACENT PIPES.

**32: OWNER SUPPLIED EQUIPMENT:**  
EQUIPMENT SUPPLIED BY THE OWNER AND INSTALLED BY THE GENERAL CONTRACTOR. EQUIPMENT INFORMATION AND SPECIFICATIONS ARE TO BE THE MOST CURRENT AVAILABLE AT THE TIME OF DOCUMENTATION PREPARATION. THE GENERAL CONTRACTOR SHALL BE RESPONSIBLE FOR VERIFYING WITH THE OWNER THE EXACT DIMENSIONS AND EQUIPMENT CONNECTION REQUIREMENTS (INCLUDING ELECTRICAL CIRCUIT REQUIREMENTS) OF EQUIPMENT TO BE SUPPLIED. THE GENERAL CONTRACTOR SHALL MAKE ALL FINAL CONNECTIONS AS NOTED ON THE DRAWINGS, INSTALL THE SET UP IN WORKING ORDER, CHECK WARRANTIES, TEST AND NOT VOID WARRANTIES. THE GENERAL CONTRACTOR SHALL COORDINATE WITH THE OWNER DELIVERY, STORAGE AND INSTALLATION OF ALL OWNER SUPPLIED EQUIPMENT. THE GENERAL CONTRACTOR SHALL STORE EQUIPMENT IF REQUESTED BY THE OWNER UNTIL INSTALLATION. SEE DRAWINGS FOR OTHER OWNER SUPPLIED/GENERAL CONTRACTOR INSTALLED ITEMS.

**33: FIRE PROTECTION NOTE:**  
EXISTING SPRINKLER HEADS, ALARM SYSTEM AND DETECTORS ARE TO BE MODIFIED TO CONFORM WITH THE PROPOSED PLAN. COORDINATE WITH THE ARCHITECT, ANY MODIFICATION OR LOCATIONS WHERE EXISTING SYSTEMS ARE AFFECTED BY THE NEW DESIGN.

**34: SOILS AT FOOTINGS:**  
REPORT THE LOCATION OF ALL UNSUITABLE SOILS AND MATERIALS BELOW ANTICIPATED LEVEL OF FOOTING TO THE ARCHITECT PRIOR TO THE SETTING OF FORMS.

**35: ACCESS PANELS:**  
CONTRACTOR IS RESPONSIBLE FOR COORDINATING QUANTITY AND LOCATION OF ALL REQUIRED ACCESS PANELS FOR ALL MEP CONTROLS, CLEANOUTS, DAMPERS, PULL BOXES, ETC.

**36: EXISTING HAZARDOUS MATERIALS**  
ALL HAZARDOUS MATERIALS INCLUDING BUT NOT LIMITED TO ASBESTOS AND LEAD PAINT ARE TO BE HANDLED, ENCAPSULATED, ABATED AND DISPOSED OF IN ACCORDANCE WITH ANY AND ALL FEDERAL, STATE AND LOCAL REQUIREMENTS AND REGULATIONS.

**37: INDUSTRY STANDARDS:**  
ALL WORK SHALL BE PERFORMED IN ACCORDANCE WITH INDUSTRY STANDARDS. STANDARDS INCLUDE BUT ARE NOT LIMITED TO THE FOLLOWING:

- AAMA AMERICAN ARCHITECTURAL MANUFACTURERS ASSOCIATION
- ACI AMERICAN CONCRETE INSTITUTE
- ANSI AMERICAN NATIONAL STANDARDS INSTITUTE
- ASTM AMERICAN SOCIETY FOR TESTS AND MATERIALS
- AWI ARCHITECTURAL WOODWORK INSTITUTE
- "CUSTOM GRADE"
- AWS AMERICAN WELDING SOCIETY
- IGMA INSULATING GLASS MANUFACTURERS ALLIANCE
- NAAMM NATIONAL ASSOCIATION OF ARCHITECTURAL METAL MANUFACTURERS
- NRCA NATIONAL ROOFING CONTRACTORS ASSOCIATION
- NCA NATIONAL TILE CONTRACTORS ASSOCIATION
- SMAACNA SHEET METAL AND AIR CONDITIONING NATIONAL ASSOCIATION
- WDMA WINDOW AND DOOR MANUFACTURERS ASSOCIATION

**ABBREVIATIONS**

A	AC	AIR CONDITIONING	L	LAB	LABORATORY
	ACT	ACOUSTICAL CEILING TILE		LAM	LAMINATED
	AD	AREA DRAIN		LB	LEAD
	ADAAG	AMERICANS WITH DISABILITIES ACT ACCESSIBILITY'S GUIDELINES		LH	LEFT-HAND
	ADD	ADDENDUM		LCC	LEAD COATED COPPER
	AFF	ABOVE FINISHED FLOOR	M	MACH	MACHINE
	AHU	AIR-HANDLING UNIT		MAS	MASONRY
	AL	ALUMINUM		MATL	MATERIAL
	ARCH	ARCHITECT/ARCHITECTURAL		MAX	MAXIMUM
	AWP	ACOUSTIC WALL PANEL		MDO	MEDIUM-DENSITY OVERLAY
B	B	BACK-TO-BACK ANGLES		MECH	MECHANICAL
	B to BLS	BASE BUILDING GENERAL CONTRACTOR		MEMB	MEMBRANE
	B.B.G.C.	BUILDING LINE		MEZZ	MEZZANINE
	BLDG	BUILDING		MET	METAL
	BLKS	BLOCKING		MFR	MANUFACTURER
	BMT	BASEMENT		MIN	MINIMUM
	BTWN	BETWEEN		MISC	MISCELLANEOUS
	BO	BY OTHERS		MO	MASONRY OPENING
				MTD	MOUNTED
C	C	COURSE (MASONRY)		MTL	METAL
	CER	CERAMIC		MB	MARKER BOARD
	CG	CORNER GUARD	N	N	NORTH
	CH	CHAT HOOK		#	NUMBER
	CJ	CONTROL JOINT		NC	NOT IN CONTACT
	CLG	CENTER LINE		NOM	NOMINAL DIMENSION
	CLM	COLUMN		NTS	NOT TO SCALE
	CMU	CONCRETE MASONRY UNIT	O	O	ON/OVER
	COL	COLUMN		OC	ON CENTER
	CONC	CONCRETE		OD	OUTSIDE DIAMETER/OUTSIDE DIMENSION
	COND	CONSTRUCTION		OFF	OFFICE
	CONN	CONNECT/CONNECTION		OPNG	OPENING
	CONSTR	CONSTRUCTION		OPP	OPPOSITE
	CONT	CONTINUOUS		OPH	OPPOSITE HAND
	CORR	CORRIDOR		OSB	ORIENTED STRAND BOARD
	CUH	CERAMIC TILE CABINET UNIT HEATER		Q	QUARTER
D	DBL	DOUBLE	P	P	PURCHASED BY OWNER INSTALLED BY CONTRACTOR
	DF	DRINKING FOUNTAIN		PBO/BC	PRECAST
	DIA	DIAMETER		PL	PLATE
	DIFF	DIFFUSER		PLM	PLASTIC LAMINATE
	DIM	DIMENSION		PR	PAIR
	DN	DOWN		PRE FAB	PREFABRICATE
	DR	DOOR		PRIV	PRIVACY
	DSP	DRY STAND PIPE		PRIM	PRIMED
	DWG	DRAWING		PSF	POUNDS PER SQUARE FOOT
E	E	EAST		PSI	POUNDS PER SQUARE INCH
	EACH	EACH		PTD	PAINTED
	ELEV	ELEVATION		PTN	PARTITION
	ELEC	ELECTRICAL		PVC	POLYVINYL CHLORIDE
	ELEV	ELEVATOR		PWD	PAINTED
	ENTR	ENTRANCE		PERF	PRESSURE TREATED PERFORATED
	EQU	EQUAL	Q	Q	QUARRY TILE
	EQUIP	EQUIPMENT		QTR	QUARTER
	EXP	EXPANSION	R	R	RISER/RADIUS
	EXPB	EXPANSION BOLT		RAD	RADIUS
	EXPJ	EXPANSION JOINT		RB	RUBBER BASE
	EXT	EXTERIOR		RCB	REFLECTED CEILING PLAN
	EPDM	ETHYLENE PROPYLENE DIENE MONOMER		RD	ROOF DRAIN
	EWIC	ELECTRIC WATER COOLER		REBAR	REINFORCING BAR
F	F	FAHRENHEIT		REF	REFRIGERATOR
	FB	FLAT BAR		REIN	REINFORCED
	FC	FIRE EXTINGUISHER AND CABINET		REQ	REQUIRED
	FD	FLOOR DRAIN		RES	RESILIENT
	FE	FIRE EXTINGUISHER		REV	REVERSE
	FEC	FIRE EXTINGUISHER CABINET		RM	ROOM
	FTWD	FIRE TREATED WOOD		RO	ROUGH OPENING
	FIN	FINISH		ROW	RIGHT OF WAY
	FL	FLOOR	S	S	SOUTH
	FOB	FACE OF BRICK		SCHED	SCHEDULE
	FOC	FACE OF CONCRETE		SCHD	SCHEDULE
	FOF	FACE OF FINISH		SIM	SIMILAR
	FOS	FACE OF STUDS		SPEC	SPECIFICATION
	FOW	FIRE SUPPRESSION SYSTEM		SO	SQUARE
	FSS	FOOT		SST	STAINLESS STEEL
	FT	FOOTING		STD	STANDARD
	FTG	FIBER REINFORCED GYPSUM		STL	STEEL
	FTR	FIN TUBE RADIATION FUME HOOD		STR	STRUCTURE/STRUCTURAL
				SUSP	SUSPENSION
G	GA	GAUGE	T	T	TONGUE&GROOVE
	GALV	GALVANIZED		T&G	TONGUE&GROOVE
	GB	GRAB BAR		TEL	TELEPHONE
	GC	GENERAL CONTRACTOR		THK	THICK
	GFI	GROUND-Fault INTERRUPTER		TOD	TOP OF DECK
	GL	GLASS/LAMINATED		TOS	TOP OF STEEL
	GLAM	GLUE LAMINATED WOOD		TOS	TYPICAL
	GND	GROUND		TB	TACK BOARD
	GWB	GYPSUM WALL BOARD		TOC	TOP OF CONCRETE
H	HB	HOSE BIB	U	U	UNDERWRITERS LABORATORIES, INC.
	HC	HANDICAP		UV	UNIT VENTILATOR
	HM	HOLLOW METAL	V	V	VINYL COMPOSITION TILE
	HORIZ	HORIZONTAL		VERT	VERTICAL
	HP	HORSE/HIGH POINT/HEAT PUMP		VIF	VERIFY IN FIELD
	HR	HOUR		VOL	VOLUME
	HW	HOT WATER	W	W	WEST
	HVAC	HEATING VENTILATION AIR CONDITIONING		WO	WITHOUT
I	I	INSIDE DIMENSION/INSIDE DIAMETER		WID	WIDE
	IN	INCHES		WF	WIDE FLANGE
	INFO	INFORMATION		WP	WORK POINT
	INSUL	INSULATION		WT	WEIGHT
J	JST	JOIST			
	JT	JOINT			
K	K	KILN-DRIED			
	KIP	1000 POUNDS			

**DRAWING LEGEND**

	EARTH		ROOM NAME AND NUMBER
	POROUS FILL		DOOR NUMBER
	CONCRETE		WINDOW NUMBER
	CONCRETE MASONRY UNIT		REVISION NUMBER
	BRICK		FLOOR-CEILING TYPE
	STEEL		ROOF SYSTEM TYPE
	WOOD - ROUGH		SLAB TYPE
	GYPSUM BOARD		FLOORING TYPE TRANSITION
	RIGID INSULATION		
	BATT INSULATION		
	CELLULOSE INSULATION		

**FIRESTOPPING DETAILS**

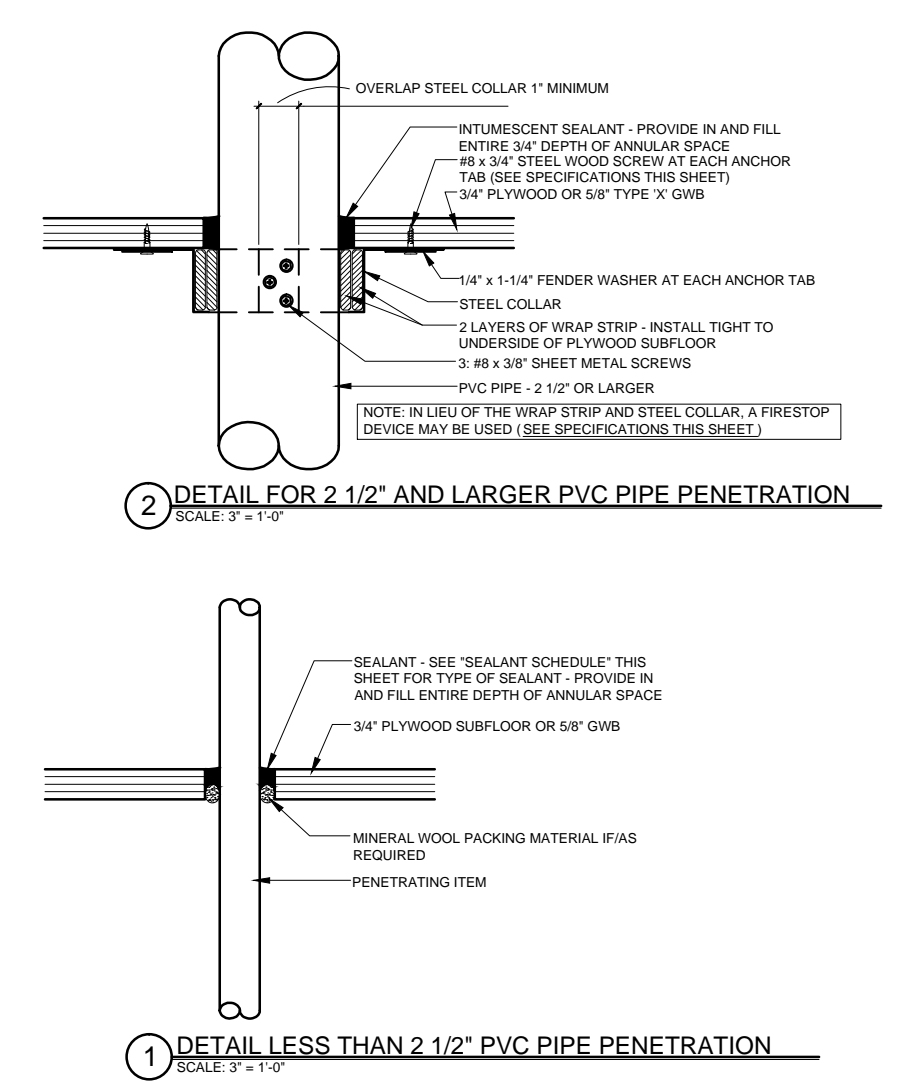

**SPECIFICATIONS**

**WRAP STRIP:** 1/4" THICK x 1 1/2" MINIMUM WIDTH INTUMESCENT MATERIAL WITH PLASTIC FILM FACING BOTH SIDES. TEMPORARILY SECURE WITH MAKING TAPE. SPECIFIED TECHNOLOGIES INC. (STI) "SpecSeal RED Wrap Strip" OR "SpecSeal BLU Wrap Strip" OR EQUAL.

**STEEL COLLAR:** WRAP STRIP MANUFACTURER'S STEEL COLLAR, FABRICATED FROM .016 INCH THICK GALVANIZED SHEET STEEL. WIDTH TO MATCH WRAP STRIP (1 1/2" MINIMUM), WITH 1 INCH x 2 INCH ANCHOR TABS AND RETAINER TABS. ANCHOR TABS TO BE SYMMETRICALLY OPPOSED AROUND COLLAR; PROVIDE 3 TABS FOR 2 1/2" AND 3" PIPE; PROVIDE 4 TABS FOR 4" PIPE.

**INTUMESCENT SEALANT:** ONE-PART, INTUMESCENT, LATEX ELASTOMER TESTED TO ASTM E 814. MINIMUM EXPANSION OF 3x AT 1000°F. 3M "FIRE BARRIER SEALANT CP 25WB" OR EQUAL.

**FIRESTOP SEALANT:** SINGLE COMPONENT NONCOMBUSTIBLE FIRE RATED SEALANT TESTED TO ASTM E 814. TESTED TO 3000°F. "BOSS 136 FIRESTOP/DRAFT SEALANT" MANUFACTURED BY ACCUMETRIC, LLC. OR EQUAL.

**SEALANT SCHEDULE:**

**INTUMESCENT SEALANT:** PROVIDE AT ALL PENETRATIONS THROUGH RATED CONSTRUCTION FOR PENETRATING ITEMS INCLUDING BUT NOT LIMITED TO: PVC PIPE; ROOF LEADER PIPES; GAS PIPES & LINES; SPRINKLER PIPES; ELECTRICAL & COMMUNICATIONS CABLES & WIRES; AND ALARM SYSTEM WIRES. DO NOT USE INTUMESCENT SEALANT AT DOMESTIC HOT WATER OR HYDRONIC HEATING SYSTEM PIPES.

**FIRESTOP SEALANT:** PROVIDE AT ALL PENETRATIONS THROUGH RATED CONSTRUCTION FOR PENETRATING ITEMS INCLUDING DOMESTIC HOT AND COLD WATER PIPES AND HYDRONIC HEATING SYSTEM PIPES.

**NOTE:**  
FOR LOCATIONS OF RATED CONSTRUCTION, SEE ARCHITECTURAL FLOOR PLANS AND SECTIONS

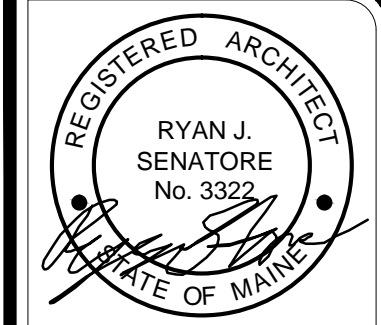

© 2018 RYAN SENATORE ARCHITECTURE

DELI FIT-UP  
UNION STREET  
PORTLAND, MAINE



**RYAN SENATORE ARCHITECTURE**  
565 CONGRESS STREET  
PORTLAND, MAINE 04101  
207-650-6414  
senatorearch@comcast.net

CONSULTANTS:

REVISIONS:

DATE: 20 FEBRUARY 2018  
PROJECT No. 1778  
DRAWN BY: RRT, RJS, JPF  
CHECKED BY: RJS  
SCALE: AS NOTED

SHEET TITLE:  
**GENERAL NOTES, ABBREVIATIONS, AND LEGENDS**

**G0-1**