

Z:\Elevation_Burger\C1613001 - Portland - ME\3_Construction Documents\3.2_Drawings\3.2.2_Architectural\A1-3_Noted Second Floor Plan.dwg --- ID Studio 4, LLC --- Monday, November 18, 2013 9:30:22 AM

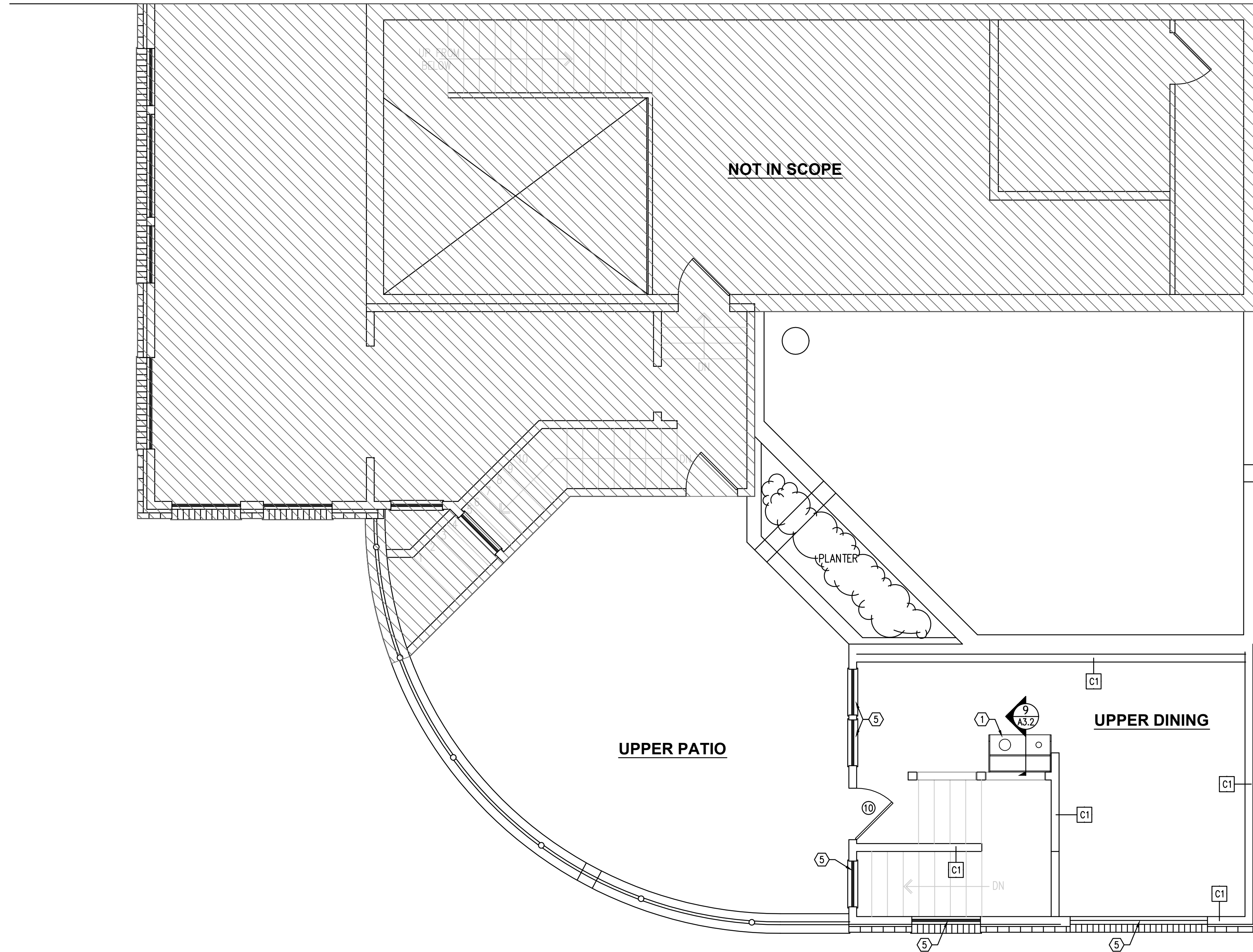

- GENERAL NOTES**
- CONSIDERATION WILL NOT BE GRANTED FOR ANY ALLEGED MISUNDERSTANDINGS OF THE AMOUNT OF WORK TO BE PERFORMED. TENDER OF PROPOSAL SHALL CONVEY FULL AGREEMENT TO THE ITEMS AND CONDITIONS INDICATED ON THE DRAWINGS. SHOULD THE CONTRACTOR FIND DISCREPANCIES OR OMISSIONS IN THE CONTRACT DOCUMENT OR BE IN DOUBT AS TO THE INTENT THEREOF, THE CONTRACTOR SHALL OBTAIN CLARIFICATION FROM THE ARCHITECT AND/OR THE OWNER'S REPRESENTATIVE PRIOR TO SUBMITTING HIS PROPOSAL FOR WORK.
 - ALL DIMENSIONS ARE SHOWN TO FACE OF STUD UNLESS NOTES OTHERWISE.
 - REFER TO SHEET A2.1 FOR INTERIOR ELEVATIONS.
 - WALLS TO STRUCTURAL DECK MUST BE THOROUGHLY SEALED AROUND PENETRATIONS.
 - REFER TO WALL TYPE SCHEDULE ON SHEET A3.3 FOR ALL NEW WALLS.
 - ALL INSTALLED INTERIOR FINISHES SHALL COMPLY WITH THE FLAME SPREAD REQUIREMENTS OF 2009 IBC, CHAPTER 8.
 - REFER TO SHEET A1.0 FOR ALL DIMENSIONS.
 - REFER TO SHEET K1.0 FOR ALL EQUIPMENT AND SPECIFICATIONS.
 - G.C. TO COORDINATE AND PROVIDE ALL BLOCKING FOR EQUIPMENT, MILLWORK, AND FIXTURES.
 - KEY NOTES:**
 - CASEWORK BY VENDOR - SEE SHEET A3.2 AND MILLWORK SHOP DRAWINGS.
 - ELECTRICAL PANELS. SEE ELECTRICAL SHEETS.
 - ALLOW AIR GAP AROUND WALK-IN COOLER PER MANUFACTURE SPECIFICATIONS.
 - CONTRACTOR SHALL COORDINATE OVERHEAD ROUTING OF SODA LINES WITHIN WALL FROM BIB RACK AND TERMINATE BEHIND FREESTYLE SODA UNIT.
 - EXISTING STOREFRONT WINDOW TO REMAIN, GC TO RESEAL AND REPAIR AS NEEDED.
 - G.C. TO VERIFY EXISTING COLUMN LOCATION. NOTIFY ARCHITECT OF ANY DISCREPANCIES.
 - INFILL WALL AS REQUIRED TO MATCH EXISTING.
 - G.C. TO INFILL SLAB TO MATCH ADJACENT.
 - STEEL TUBE, REFER TO 11/A3.0.
 - NEW CONCRETE INFILL TO MATCH EXISTING FLOOR HEIGHT, RE:2/A1.2.
 - WALL SCREEN RE: X/XX

WALL LEGEND

[Pattern: Diagonal lines /]	EXISTING WALL TO REMAIN
[Pattern: Diagonal lines \]	NEW WALL
[Pattern: Horizontal lines]	NEW WALL WITH R-11 SOUND BATT INSULATION
[Pattern: Dotted]	COOLER/FREEZER WALL, BY KEC
[Pattern: Vertical lines]	LOW WALL

ARCHITECT:
THOMAS A. EDSON, RA
 1431 GREENWAY DRIVE
 SUITE 510
 IRVING, TX 75038
 PHONE 972.870.1288

CLIENT:
 ELEVATION BURGER FRANCHISE VENTURES
 4100 NORTH FAIRFAX DR. STE 730
 ARLINGTON, VA 22203
 703.243.7894
 www.elevationburger.com



11/18/2013

ELEVATION BURGER
 205 COMMERCIAL ST.
 PORTLAND, ME 04101
 CLIENT: BETTER BURGER OLD PORT, LLC
 ONE LONG WHARF
 PORTLAND, ME 04101



DATE	DESCRIPTION
11/18/13	PERMIT ISSUE

SHEET TITLE:
NOTED SECOND FLOOR PLAN

SHEET NUMBER:
A1.3

PROJECT NUMBER:
EVB130001

NOTED SECOND FLOOR PLAN 1/4"=1'-0" **1**