

DISPLAY THIS CARD ON PRINCIPAL FRONTAGE OF WORK
CITY OF PORTLAND

BUILDING INSPECTION

PERMIT

Permit Number: 061448

Read
Instruction And
Notes, If Any,
Attached

is to certify that 10 DANA STREET LLC
is permission to outside seating 6 Tables & 2 chairs
10 DANA ST

PERMIT ISSUED
OCT 15 2006
032 V001001

Provided that the person or persons who accept this permit shall comply with all the provisions of the Statutes of the State and of the Ordinances of the City of Portland regulating the construction, maintenance and use of buildings and structures, and of the application on file in this department.

Apply to Public Works for street line and grade if nature of work requires such information.

Notification of inspection must be given and when permission procedure is completed or service closed-in 4 HOUR NOTICE REQUIRED.

A certificate of occupancy must be procured by owner before this building or part thereof is occupied.

OTHER REQUIRED APPROVALS

Fire Dept. _____
Health Dept. _____
Appeal Board _____
Other _____
Department Name

[Signature]
10/12/06
Director - Building & Inspection Services

PENALTY FOR REMOVING THIS CARD



City of Portland, Maine - Building or Use Permit Application

389 Congress Street, 04101 Tel: (207) 874-8703, Fax: (207) 874-8716

| | | |
|-----------------------|-------------------------------------|---------------------|
| Permit No: 06-1448 | Issue Date: PERMIT ISSUED | CBL: 032 V001001 |
|-----------------------|-------------------------------------|---------------------|

| | | | |
|--|--|--|---------------------|
| Location of Construction: 10 DANA ST | Owner Name: 10 DANA STREET LLC | Owner Address: 10 DANA ST. STE 300 | Phone: |
| Business Name: Vignola | Contractor Name: | Contractor Address: | Phone: |
| Lessee/Buyer's Name: Dan Kary | Phone: 207-576-9430 | Permit Type: Outdoor Seating | Zone: B-3 |

| | | | | |
|--|---|---|---|---------------------------|
| Past Use: Commercial/ Restaurant <i>VIGNOLA'S</i> | Proposed Use: Commercial/ Restaurant - outside seating 6 Tables & 24 Chairs <i>on private property</i> | Permit Fee: \$75.00 | Cost of Work: \$75.00 | CEO District: 1 |
| Proposed Project Description: outside seating 6 Tables & 24 Chairs - <i>on private property</i> | | FIRE DEPT: <input type="checkbox"/> Approved <input type="checkbox"/> Denied <i>N/A</i> | INSPECTION: Use Group: <i>U</i> Type: <i>Seating</i> <i>City Ordinance</i> | |
| | | Signature: <i>[Signature]</i> | Signature: <i>[Signature]</i> | |
| PEDESTRIAN ACTIVITIES DISTRICT (P.A.D.) | | | | |
| Action: <input type="checkbox"/> Approved <input type="checkbox"/> Approved w/Conditions <input type="checkbox"/> Denied | | | | |
| | | Signature: | Date: | |

| | | | | |
|------------------------------------|--|------------------------|--|--|
| Permit Taken By: Idobson | Date Applied For: 10/03/2006 | Zoning Approval | | |
|------------------------------------|--|------------------------|--|--|

| | | | |
|---|--|---|--|
| <ol style="list-style-type: none"> This permit application does not preclude the Applicant(s) from meeting applicable State and Federal Rules. Building permits do not include plumbing, septic or electrical work. Building permits are void if work is not started within six (6) months of the date of issuance. False information may invalidate a building permit and stop all work.. | Special Zone or Reviews <input type="checkbox"/> Shoreland <input type="checkbox"/> Wetland <input type="checkbox"/> Flood Zone <input type="checkbox"/> Subdivision <input type="checkbox"/> Site Plan Maj <input type="checkbox"/> Minor <input type="checkbox"/> MM <input type="checkbox"/> Date: <i>10/4/06</i> | Zoning Appeal <input type="checkbox"/> Variance <input type="checkbox"/> Miscellaneous <input type="checkbox"/> Conditional Use <input type="checkbox"/> Interpretation <input type="checkbox"/> Approved <input type="checkbox"/> Denied Date: | Historic Preservation <input type="checkbox"/> Not in District or Landmark <input type="checkbox"/> Does Not Require Review <input type="checkbox"/> Requires Review <input checked="" type="checkbox"/> Approved <input checked="" type="checkbox"/> Approved w/Conditions <input type="checkbox"/> Denied Date: <i>10/4/06</i> |
| | <i>to D.A. 10/6/06</i> D. Anderson 10/6/06 | | |

CERTIFICATION

I hereby certify that I am the owner of record of the named property, or that the proposed work is authorized by the owner of record and that I have been authorized by the owner to make this application as his authorized agent and I agree to conform to all applicable laws of this jurisdiction. In addition, if a permit for work described in the application is issued, I certify that the code official's authorized representative shall have the authority to enter all areas covered by such permit at any reasonable hour to enforce the provision of the code(s) applicable to such permit.

| | | | |
|---|---------|------|-------|
| SIGNATURE OF APPLICANT | ADDRESS | DATE | PHONE |
| RESPONSIBLE PERSON IN CHARGE OF WORK, TITLE | | DATE | PHONE |

City of Portland, Maine - Building or Use Permit

389 Congress Street, 04101 Tel: (207) 874-8703, Fax: (207) 874-8716

| | | |
|------------------------------|--|----------------------------|
| Permit No: 06-1448 | Date Applied For: 10/03/2006 | CBL: 032 V001001 |
|------------------------------|--|----------------------------|

| | | | |
|--|--|--|---------------|
| Location of Construction: 10 DANA ST | Owner Name: 10 DANA STREET LLC | Owner Address: 10 DANA ST. STE 300 | Phone: |
| Business Name: Vignola | Contractor Name: | Contractor Address: | Phone: |
| Lessee/Buyer's Name Dan Kary | Phone: 207-576-9430 | Permit Type: Outdoor Seating | |

| | |
|---|--|
| Proposed Use: Commercial/ Restaurant - outside seating 6 Tables & 24 Chairs on private property | Proposed Project Description: outside seating 6 Tables & 24 Chairs |
|---|--|

Dept: Historical **Status:** Approved with Conditions **Reviewer:** Deborah Andrews **Approval Date:** 10/06/2006**Note:** **Ok to Issue:**

- 1) * Site improvements to conform to HP Board's 9/0606 decision, with following conditions of approval:
- 1) Both landscape beds in front of the building to be included in project, to maintain current symmetry.
 - 2) All stantions to be on weighted bases, so as to be temporary and removable.
 - 3) Infill material to be granite paving blocks. Color to match existing granite to extent feasible.
 - 4) If lighting is desired at the main building entrance, such lighting to be recessed in canopy.
 - 5) The top slab of granite that currently forms the southern edge of the planting bed is to be pushed back (toward the building entrance) to create a top step.
 - 6) Any additional modifications (additional lighting, e.g.) requires separate review and approval.

Dept: Zoning **Status:** Approved with Conditions **Reviewer:** Marge Schmuckal **Approval Date:** 10/04/2006**Note:** **Ok to Issue:**

- 1) Separate permits shall be required for any new signage.
- 2) This permit is being approved on the basis of plans submitted. Any deviations shall require a separate approval before starting that work.
- 3) Please be aware that a separate liquor licensing permit may be required through the City Clerk's office.

Dept: Building **Status:** Approved with Conditions **Reviewer:** Tammy Munson **Approval Date:** 10/12/2006**Note:** **Ok to Issue:**

- 1) This permit approves outside seating only. Any food, alcohol or entertainment in this space requires licensing approvals from the City Clerk.
- 2) The tables and chairs must not block any means to egress the building

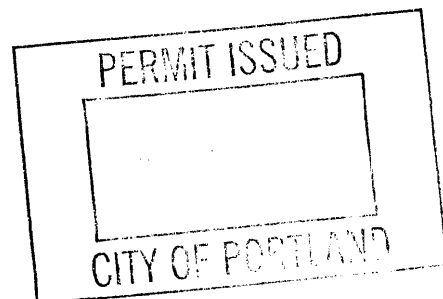



Outdoor Seating Permit Application

If you or the property owner owes real estate or personal property taxes or user charges on any property within the City, payment arrangements must be made before permits of any kind are accepted.

| | | |
|---|--|---|
| Location/Address of Construction: <u>10 DANA Street</u> | | |
| Total Square Footage of Proposed Structure | | Square Footage of Lot |
| Tax Assessor's Chart, Block & Lot Chart# Block# Lot# <u>32</u> <u>V1.</u> | Owner: <u>10 DANA LLC.</u> | Telephone: |
| Lessee/Buyer's Name (If Applicable) <u>CINQUE TERRE LLC.</u> | Owner's/Purchaser/Lessee Address <u>36 WHARF ST. PORTLAND, ME 04101</u> | Cost Of Work: \$ <u>0</u> Fee: \$75.00 |
| Current use: <u>PATIO</u> Business name: <u>DBA "VIGNOLA" / CINQUE TERRE LLC.</u> If the location is currently vacant, what was prior use: _____ Approximately how long has it been vacant: _____ Proposed use: <u>PRIVATE PATIO FOR OUTSIDE SEATING/RESTAURANT</u> Project description: <u>Outside Seating</u> How many chairs? <u>24</u> How many tables? <u>6</u> Please contact the City Clerk's Office @ 874-8557 before you commence any serving of food or alcohol outside. | | |
| Contractor's name: <u>N/A</u> Address & telephone: _____ | | |
| Who should we contact when the permit is ready: <u>DAN KARY</u> Mailing address: <u>c/o CINQUE TERRE 36 WHARF ST. PORTLAND, ME 04101</u> Phone: <u>cell: 576-9430</u> | | |

Please submit all of the information outlined in the Outdoor Seating Application Checklist. Failure to do so will result in the automatic denial of your permit.

In order to be sure the City fully understands the full scope of the project, the Planning and Development Department may request additional information prior to the issuance of a permit. For further information visit us on-line at www.portlandmaine.gov, stop by the Building Inspections office, room 315 City Hall or call 874-8703.

I hereby certify that I am the Owner of record of the named property, or that the owner of record authorizes the proposed work and that I have been authorized by the owner to make this application as his/her authorized agent. I agree to conform to all applicable laws of this jurisdiction. In addition, if a permit for work described in this application is issued, I certify that the Code Official's authorized representative shall have the authority to enter all areas covered by this permit at any reasonable hour to enforce the provisions of the codes applicable to this permit.

DAN KARY

| | |
|---|----------------------|
| Signature of applicant: <u>Dan Kary</u> | Date: <u>9/27/06</u> |
|---|----------------------|

This is not a permit; you may not commence ANY work until the permit is issued.

DANVA STREET

1/4" = 1 foot

COPY FOR PORTLAND

SIDE WALK

15 feet

GATE

PASSAGE TO PATIO

ROPE AND STANCHIONS

SMALL LAMP HARDWIRED INTO STATION

MINI TRACK TO GRAZE BAR FRONT DETAIL

T2/4/13

GRAZE WALL

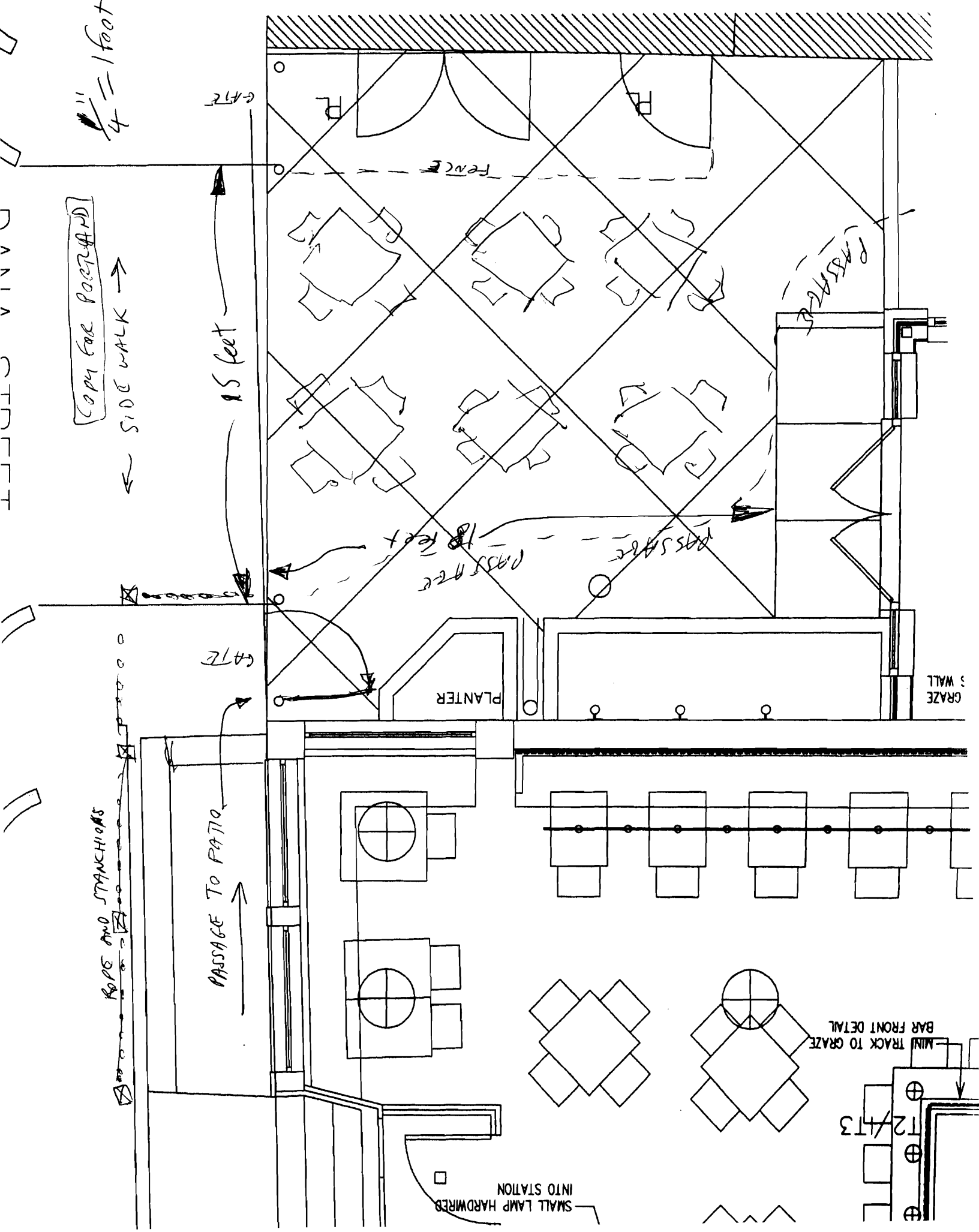

SMALL LAMP HARDWIRED INTO STATION

T2/T3

MINI TRACK TO GRAZE BAR FRONT DETAIL

PASSAGE TO PATIO

ROPE AND SPRINGS

GRAZE S WALL

PLANTER

GATE

18 feet

15 feet

PATIO SEATING AREA PROPOSED: 2 SEATS

COFFIN FOR LIQUOR LICENSURE.

FENCE

GATE

1/4" = 1 foot.

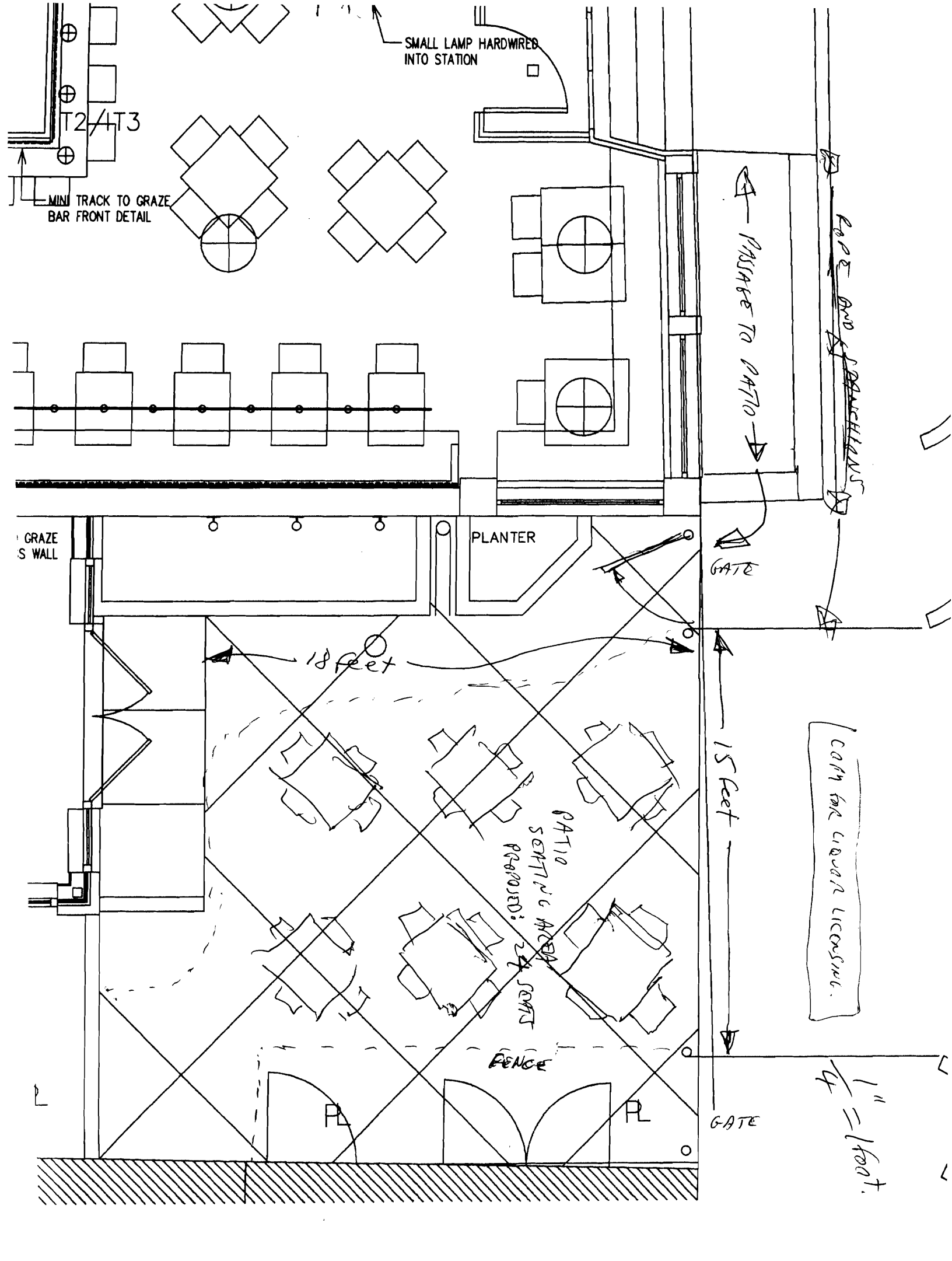

SIDEWALK

DANA STREET

ADD PANAL
VIEW

PLANTER

fence

LOBBY

R

R

R

ceiling

3)

R

o

