

FLOOR/CEILING/WALL TYPES

[C1]
FLOOR/CEILING – TYPE 1
 2 hr WOOD FRAMED

UL NO. L505
 BASE LAYER 5/8" TYPE X GYPSUM WALLBOARD APPLIED AT RIGHT ANGLES TO 2x10 WOOD JOISTS 16" O.C.
 W/ 8d NAILS, 2 1/2" LONG, 0.113" SHANK, 19/64" HEAD, 7" O.C. RESISTANT FINISHING CHANNELS 3/4" O.C. APPLIED
 AT RIGHT ANGLES TO JOISTS THROUGH BASE LAYER W/ ONE 8d NAIL, 3 1/2" LONG, 0.113" SHANK, 19/64" HEAD. AT
 EACH JOIST FACE LAYER 5/8" TYPE X GYPSUM WALLBOARD APPLIED AT RIGHT ANGLES TO FINISHING
 CHANNELS W/ 1" TYPE 3 DRYWALL SCREWS 12" O.C. DOUBLE CHANNELS INSTALLED AT FACE LAYER END JOISTS.
 WOOD JOISTS SUPPORTING 1" NOMINAL T&G WOOD SUBFLOOR AND 1" NOMINAL WOOD FINISH FLOOR.

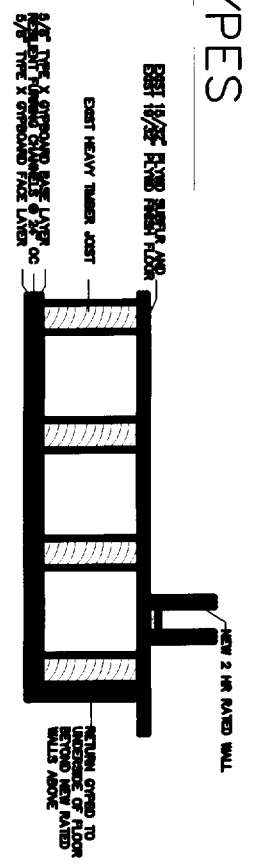

[C2]
FLOOR/CEILING – TYPE 2
 2 hr WOOD FRAMED

WOOD FLOOR, WOOD JOISTS, GYPSUM WALLBOARD,
 RESISTANT CHANNELS
 Base layer 5/8" proprietary type X gypsum wallboard applied at right angles to 2 x 10 wood
 joists 16" o.c. with 8d cement coated nails, 2 1/2" long, 0.113 shank, w/4" heads, 7" o.c.
 finishing channel 3/4" o.c. applied at right angles to wood framing through base layer
 with 1 1/2" long screws. Double channel installed at face layer and joists. Face layer 5/8"
 proprietary type X gypsum wallboard applied at right angles to resistant finishing channels
 with 1" type 3 screws 12" o.c. Wood joists supporting 5/8" plywood subfloor and w/4"
 plywood finish floor applied at right angles to joists with joints staggered. Consult
 gypsum board manufacturer for other finishing options.
PROPRIETARY GYPSUM BOARD
 G-2 Gypsum – 5/8" Toughboard Frequent C
 Loder's North America Inc. – 5/8" Frequent C
 National Gypsum Company – 5/8" Old Brand Brand FIRE-SHIELD C
 Gypsum Wallboard
 PABCO Gypsum – 5/8" FLAME CLIMB Saver "C"
 United States Gypsum Company – 5/8" SHEETROCK Brand Gypsum
 Panels, FREEDDIT C Core

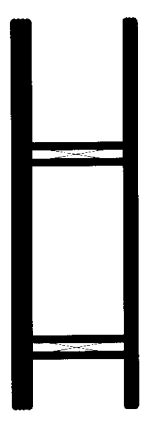

Approx. Ceiling
 Weight: 6 psf
 Fire Test: U.L. R1318-114, 7-21-87,
 U.L. Design L511

[C3]
FLOOR/CEILING – TYPE 3
 1 hr WOOD FRAMED

WOOD JOISTS, GYPSUM WALLBOARD, RESISTANT CHANNELS
 One layer 1/2" type X gypsum wallboard or gypsum veneer base applied at right angles to
 resistant finishing channels 2 1/2" o.c. with 1" Type S drywall screws 11" o.c. Gypsum board
 and joints located midway between continuous channels and attached to additional
 pieces of channel 6 1/2" long with screws 12" o.c. Resistant finishing channels applied at right
 angles to 2 x 10 wood joists 16" o.c. with 1 1/2" Type W drywall screws or 8d common
 nails. Wood joists supporting 1" nominal T & G wood subfloor and 1" nominal wood finish
 floor, or 5/8" plywood finished floor with long edges T & G and 1/2" thicker plywood with
 exterior glue exterior perpendicular to joists with joints staggered.

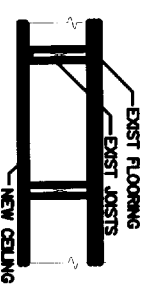

Approx. Ceiling
 Weight: 2 psf
 Fire Test: U.L. R5043-8, 7-8-88,
 U.L. Design L517
 Sound Test: Saw FC 5240
 (CX 6812-6, -7, 4-15-85)

[W1]
WALL – TYPE 1
 2 hr WOOD FRAMED

GYPSUM WALLBOARD, WOOD STUDS
 Base layer 5/8" type X gypsum wallboard or gypsum
 veneer base applied at right angles to
 each side of 2 x 4 wood studs 24" o.c. with 8d coated
 nails, 1 1/2" long, 0.085" shank, 1/2"
 heads, 2 1/2" o.c. Face layer 5/8" type X gypsum wallboard
 or gypsum veneer base applied
 at right angles to each side with 8d coated nails, 2 1/2"
 long, 0.100" shank, 1/2" heads, 8"
 o.c.
 Joints staggered 24" each layer and side. Sound tested
 for base layer spaced 8" o.c. (LOAD-BEARING)



Thickness: 5/8"
 Approx. Weight: 12 psf
 Fire Test: FM 190 350, 9-27-74
 Sound Test: NRC 2583, 4-1-70

1 STAIR SECTION/HANDRAIL ELEVATION

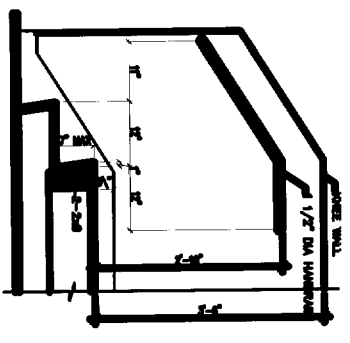

2 STAIR SECTION/HANDRAIL ELEVATION

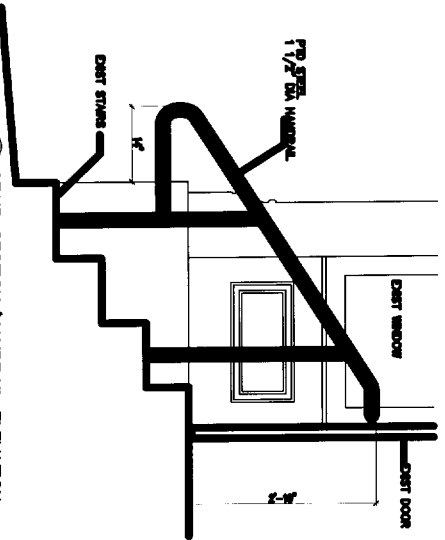

3 STAIR SECTION/HANDRAIL ELEVATION

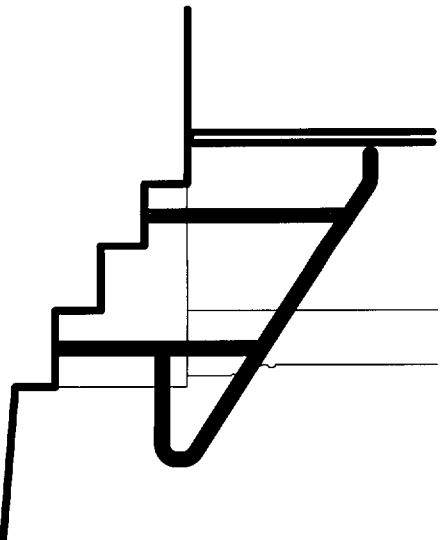

4 TYPICAL BUILDING SECTION

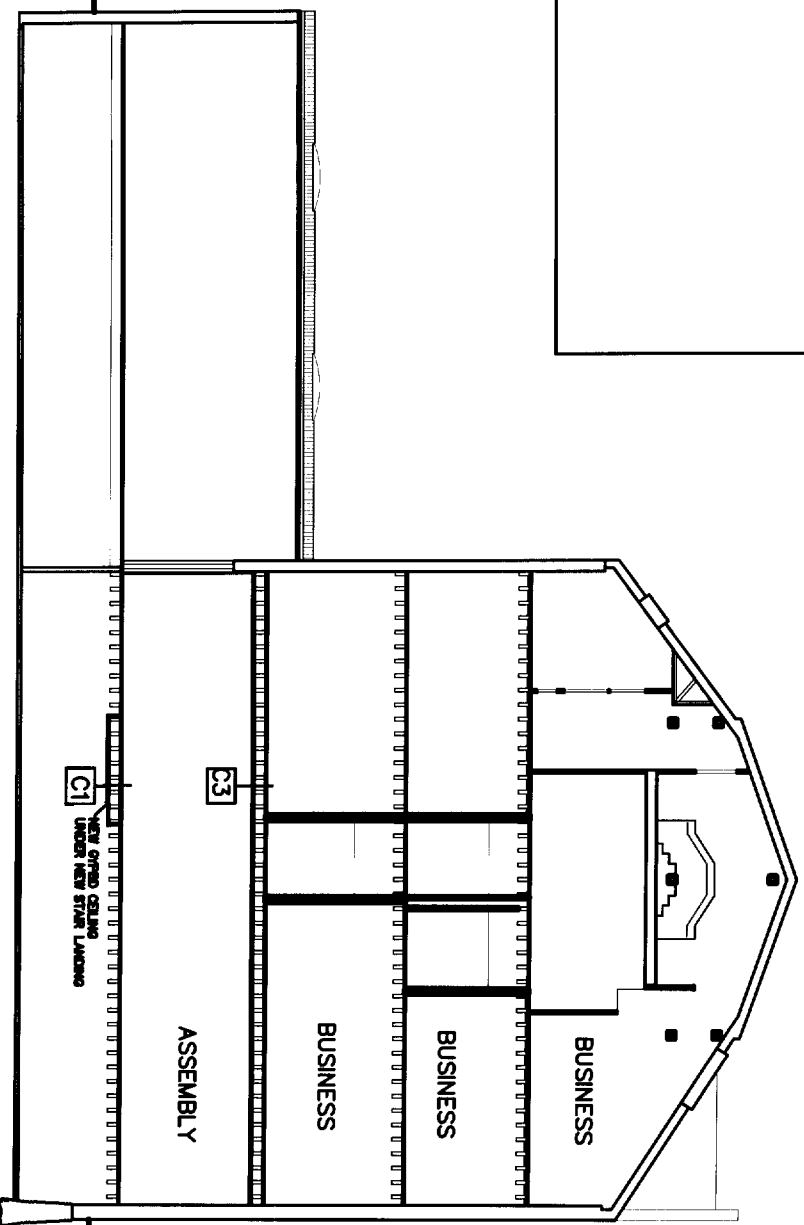

A	FLOOR/CEILING & WALL TYPES	Date: January 26, 2006	Scale: 1/4" = 1'-0"	ARCHETYPE, P.A. ARCHITECTS 48 Union Wharf Portland, Maine 04101 (207) 772-6022 Fax (207) 7724056	Project 10 DANA STREET 1ST FLOOR ALTERATIONS	Owner
	HANDRAIL DETAILS	Checked By:				