

Revisions

Amigos Mexican  
Restaurant &  
Bar  
Roof Deck &  
Patio

9 Dana Street  
Portland, Maine 04101

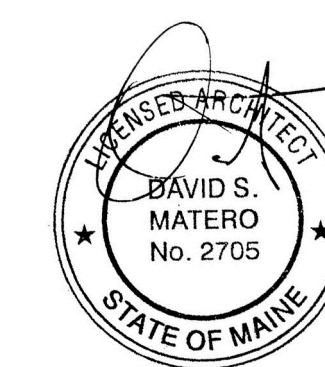

Job Number: 15.000

Date: 12.28.15

Scale: 1/4" = 1'-0"

Drawing Title:

Code Review  
and Life  
Safety Plan

R.2

Issued for  
Permit

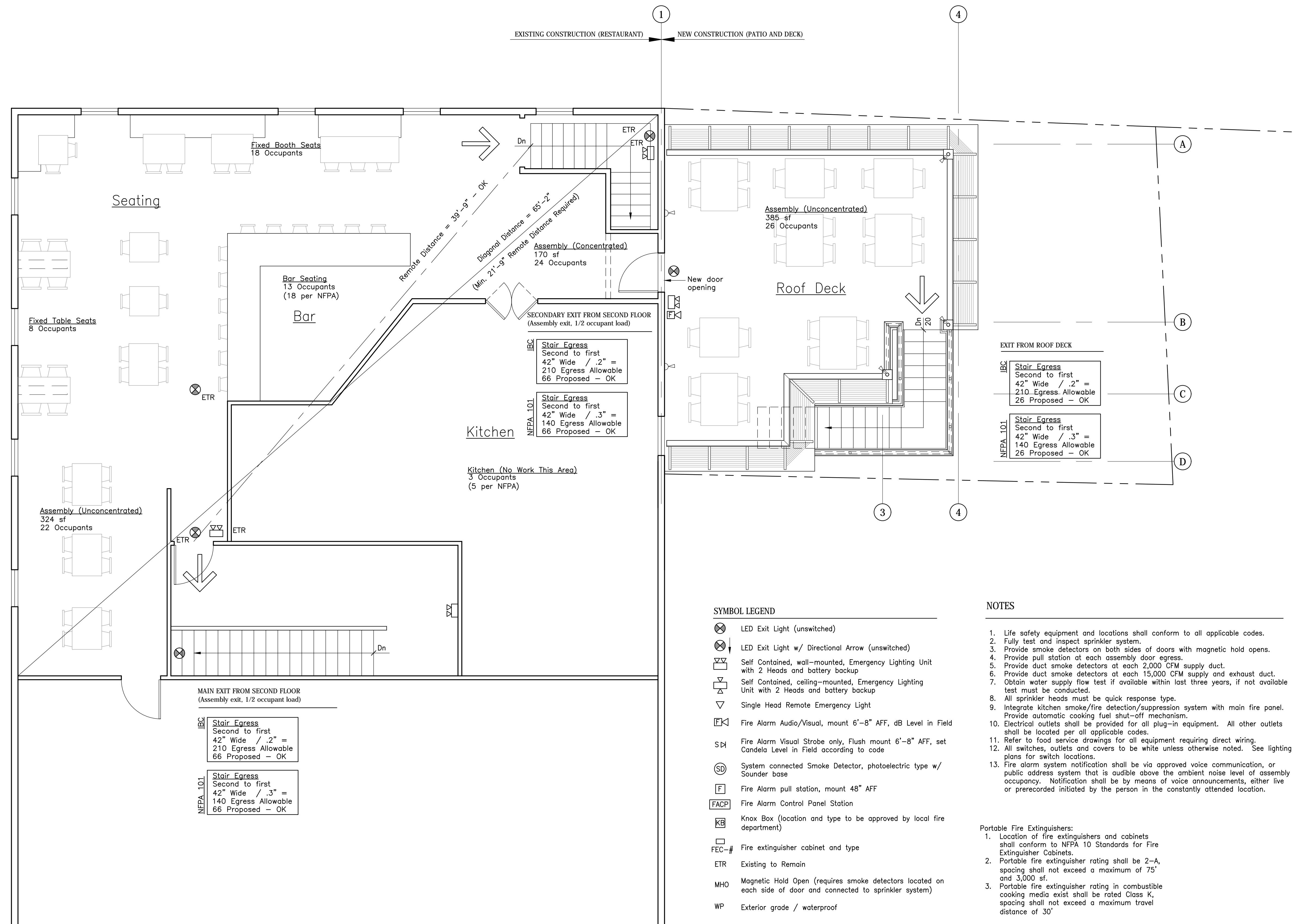

SYMBOL LEGEND

- ⊗ LED Exit Light (unswitched)
- ⊗ LED Exit Light w/ Directional Arrow (unswitched)
- ⊞ Self Contained, wall-mounted, Emergency Lighting Unit with 2 Heads and battery backup
- ⊞ Self Contained, ceiling-mounted, Emergency Lighting Unit with 2 Heads and battery backup
- ▽ Single Head Remote Emergency Light
- ⊞ Fire Alarm Audio/Visual, mount 6'-8" AFF, dB Level in Field
- ⊞ Fire Alarm Visual Strobe only, Flush mount 6'-8" AFF, set Candela Level in Field according to code
- ⊞ System connected Smoke Detector, photoelectric type w/ Sounder base
- ⊞ Fire Alarm pull station, mount 48" AFF
- ⊞ Fire Alarm Control Panel Station
- ⊞ Knox Box (location and type to be approved by local fire department)
- ⊞ Fire extinguisher cabinet and type
- ETR Existing to Remain
- MHO Magnetic Hold Open (requires smoke detectors located on each side of door and connected to sprinkler system)
- WP Exterior grade / waterproof

NOTES

1. Life safety equipment and locations shall conform to all applicable codes.
  2. Fully test and inspect sprinkler system.
  3. Provide smoke detectors on both sides of doors with magnetic hold opens.
  4. Provide pull station at each assembly door egress.
  5. Provide duct smoke detectors at each 2,000 CFM supply duct.
  6. Provide duct smoke detectors at each 15,000 CFM supply and exhaust duct.
  7. Obtain water supply flow test if available within last three years, if not available test must be conducted.
  8. All sprinkler heads must be quick response type.
  9. Integrate kitchen smoke/fire detection/suppression system with main fire panel. Provide automatic cooking fuel shut-off mechanism.
  10. Electrical outlets shall be provided for all plug-in equipment. All other outlets shall be located per all applicable codes.
  11. Refer to food service drawings for all equipment requiring direct wiring.
  12. All switches, outlets and covers to be white unless otherwise noted. See lighting plans for switch locations.
  13. Fire alarm system notification shall be via approved voice communication, or public address system that is audible above the ambient noise level of assembly occupancy. Notification shall be by means of voice announcements, either live or prerecorded initiated by the person in the constantly attended location.
- Portable Fire Extinguishers:
1. Location of fire extinguishers and cabinets shall conform to NFPA 10 Standards for Fire Extinguisher Cabinets.
  2. Portable fire extinguisher rating shall be 2-A, spacing shall not exceed a maximum of 75' and 3,000 sf.
  3. Portable fire extinguisher rating in combustible cooking media exist shall be rated Class K, spacing shall not exceed a maximum travel distance of 30'

1 Second Floor Code Review Plan

Scale: 1/4" = 1'-0"