

Consultants  
Casco Bay Engineering  
Structural Engineer

Revisions

Amigos Mexican  
Restaurant &  
Bar  
Roof Deck &  
Patio  
9 Dana Street  
Portland, Maine 04101

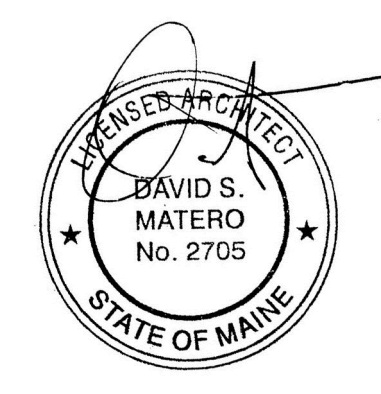

Job Number: 15.000  
Date: 12.28.15  
Scale: 1/4" = 1'-0"

Drawing Title:  
Code Review  
and Life  
Safety Plan

R.1  
Issued for  
Permit

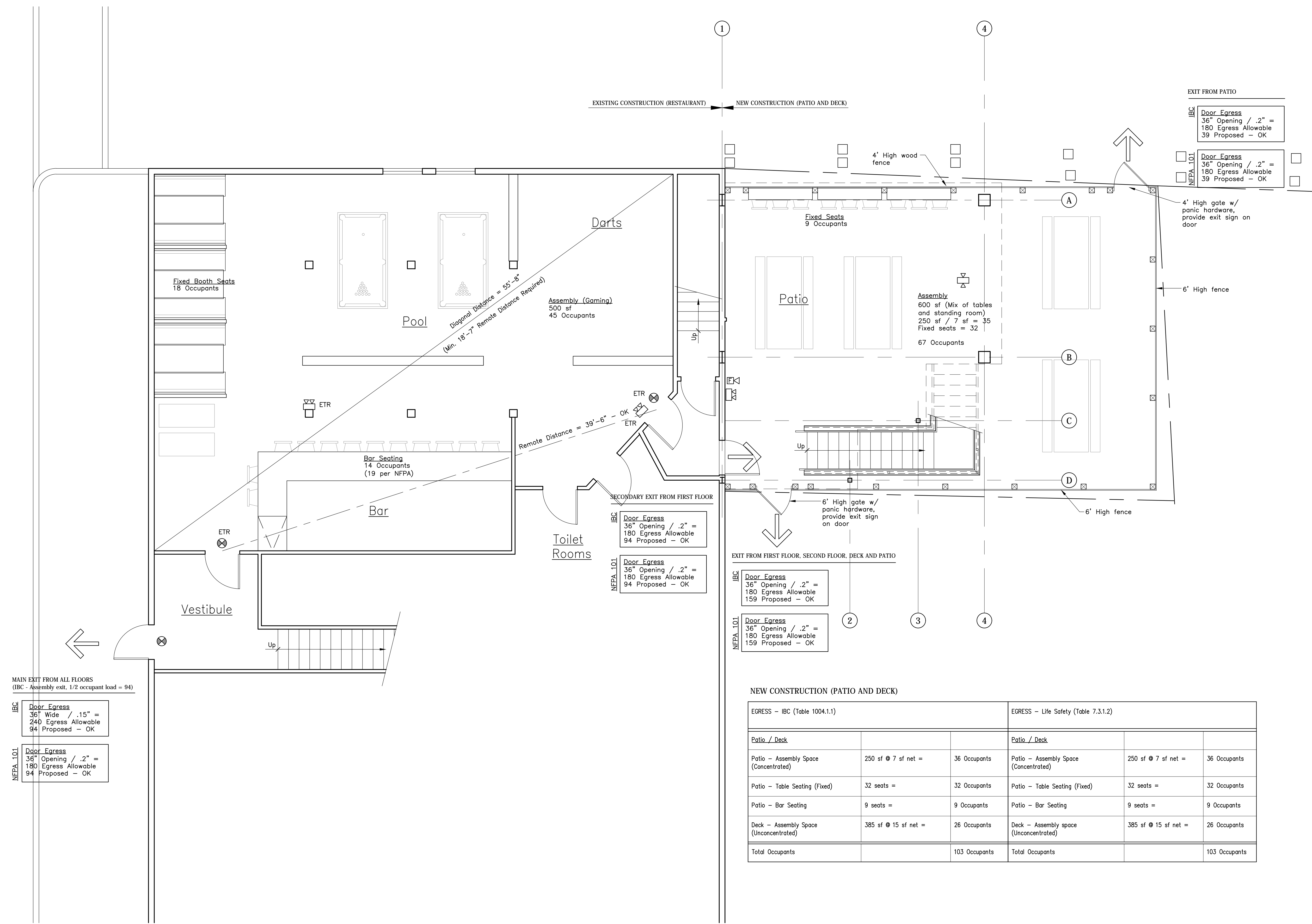

MAIN EXIT FROM ALL FLOORS  
(IBC - Assembly exit, 1/2 occupant load = 94)

IBC	Door Egress 36" Wide / .15" = 240 Egress Allowable 94 Proposed - OK
NEPA 101	Door Egress 36" Opening / .2" = 180 Egress Allowable 94 Proposed - OK

EXISTING CONSTRUCTION (RESTAURANT) ← NEW CONSTRUCTION (PATIO AND DECK)

EXIT FROM PATIO

IBC	Door Egress 36" Opening / .2" = 180 Egress Allowable 39 Proposed - OK
NEPA 101	Door Egress 36" Opening / .2" = 180 Egress Allowable 39 Proposed - OK

SECONDARY EXIT FROM FIRST FLOOR

IBC	Door Egress 36" Opening / .2" = 180 Egress Allowable 94 Proposed - OK
NEPA 101	Door Egress 36" Opening / .2" = 180 Egress Allowable 94 Proposed - OK

EXIT FROM FIRST FLOOR, SECOND FLOOR, DECK AND PATIO

IBC	Door Egress 36" Opening / .2" = 180 Egress Allowable 159 Proposed - OK
NEPA 101	Door Egress 36" Opening / .2" = 180 Egress Allowable 159 Proposed - OK

NEW CONSTRUCTION (PATIO AND DECK)

EGRESS - IBC (Table 1004.1.1)		EGRESS - Life Safety (Table 7.3.1.2)	
Patio / Deck		Patio / Deck	
Patio - Assembly Space (Concentrated)	250 sf @ 7 sf net = 36 Occupants	Patio - Assembly Space (Concentrated)	250 sf @ 7 sf net = 36 Occupants
Patio - Table Seating (Fixed)	32 seats = 32 Occupants	Patio - Table Seating (Fixed)	32 seats = 32 Occupants
Patio - Bar Seating	9 seats = 9 Occupants	Patio - Bar Seating	9 seats = 9 Occupants
Deck - Assembly Space (Unconcentrated)	385 sf @ 15 sf net = 26 Occupants	Deck - Assembly space (Unconcentrated)	385 sf @ 15 sf net = 26 Occupants
<b>Total Occupants</b>	<b>103 Occupants</b>	<b>Total Occupants</b>	<b>103 Occupants</b>

1 First Floor Code Review Plan

Scale: 1/4" = 1'-0"