

City of Portland, Maine – Building or Use Permit Application 389 Congress Street, 04101, Tel: (207) 874-8703, FAX: 874-8716

Location of Construction: 366 - 374 Fore Street 11 Molton street		Owner: Portland Grog Shop Inc ***** 774-0444 ****		Phone:		Permit No: 990812	
Owner Address: 11 molton Street Portland ME 04101		Lessee/Buyer's Name:		Phone:		BusinessName:	
Contractor Name:		Address:		Phone:		Permit Issued: AUG 3 1999	
Past Use: restaurant/tavern		Proposed Use: same		COST OF WORK: \$		PERMIT FEE: \$	
				FIRE DEPT. <input type="checkbox"/> Approved <input type="checkbox"/> Denied		INSPECTION: Use Group: Type:	
				Signature:		Signature:	
Proposed Project Description: 3 Side Walk Signs				PEDESTRIAN ACTIVITIES DISTRICT (P.A.D.) Action: Approved <input type="checkbox"/> Approved with Conditions: <input type="checkbox"/> Denied <input type="checkbox"/> Signature: Date:			
Permit Taken By: K.		Date Applied For: July 29, 1999 K.					

1. This permit application does not preclude the Applicant(s) from meeting applicable State and Federal rules.
2. Building permits do not include plumbing, septic or electrical work.
3. Building permits are void if work is not started within six (6) months of the date of issuance. False information may invalidate a building permit and stop all work..

PERMIT ISSUED
WITH REQUIREMENTS

CERTIFICATION

I hereby certify that I am the owner of record of the named property, or that the proposed work is authorized by the owner of record and that I have been authorized by the owner to make this application as his authorized agent and I agree to conform to all applicable laws of this jurisdiction. In addition, if a permit for work described in the application is issued, I certify that the code official's authorized representative shall have the authority to enter all areas covered by such permit at any reasonable hour to enforce the provisions of the code(s) applicable to such permit

July 29, 1999

SIGNATURE OF APPLICANT ADDRESS: DATE: PHONE:

RESPONSIBLE PERSON IN CHARGE OF WORK, TITLE PHONE:

Zoning Appeal

- ☐ Variance
- ☐ Miscellaneous
- ☐ Conditional Use
- ☐ Interpretation
- ☐ Approved
- ☐ Denied

Historic Preservation

- ☐ Not in District or Landmark
- ☐ Does Not Require Review
- ☐ Requires Review

Action:

- ☐ Approved
- ☐ Approved with Conditions
- ☐ Denied

Date: _____

CEO DISTRICT

**THIS IS NOT A PERMIT/CONSTRUCTION CANNOT COMMENCE UNTIL THE
PERMIT IS ISSUED**

**Sign Permit Pre-Application
Attached Single Family Dwellings/Two-Family Dwelling
Multi-Family or Commercial Structures and Additions Thereto**

In the interest of processing your application in the quickest possible manner, please complete the Information below for a Building or Use Permit.

NOTEIf you or the property owner owes real estate or personal property taxes or user charges on ANY PROPERTY within the City, payment arrangements must be made before permits of any kind are accepted.**

Location/Address of Construction (include Portion of Building): <u>366-374 FARE ST AND 11 MOULTON ST</u>

Total Square Footage of Proposed Structure <u>18368 SF +/-</u>	Square Footage of Lot <u>4591.80 SF</u>
---	---

Tax Assessor's Chart, Block & Lot Number Chart# <u>032</u> Block# <u>9</u> Lot# <u>001</u>	Owner: <u>PORTLAND GROC SHOP INC</u>	Telephone#: <u>774-0444</u>
---	---	--------------------------------

Owner's Address: <u>11 MOULTON ST</u> <u>PORTLAND, ME 04101</u>	Lessee/Buyer's Name (If Applicable) <u>N/A</u>	Total Sq. Ft. of Sign <u>3 SIGNS</u> <u>EACH IS</u> <u>16 SF</u> Fee <u>39.60</u> \$ 84.60
---	---	--

Proposed Project Description: (Please be as specific as possible) <u>THREE DOUBLE SIDED SIDEWALK SIGNS.</u> <u>EACH IS 2' X 4'</u>
--

Contractor's Name, Address & Telephone <u>N/A</u>	Rec'd By <u>(X)</u>
--	---------------------

Current Use: <u>MIXED USE</u> <u>COMMERCIAL BUILDING</u>	Proposed Use: <u>N/A</u>
---	--------------------------

Signature of applicant: <u>R. McGee</u>	Date: <u>7-29-99</u>
---	----------------------

Signage Permit Fee: \$30.00 plus .20 per square foot of signage



ACORD CERTIFICATE OF LIABILITY INSURANCEDATE (MM/DD/YY)
07/28/1999

PRODUCER (207)773-5641 FAX (207)879-6127

Bradish-Young Insurance
PO Box 3899
Portland, ME 04104-5099THIS CERTIFICATE IS ISSUED AS A MATTER OF INFORMATION
ONLY AND CONFERS NO RIGHTS UPON THE CERTIFICATE
HOLDER. THIS CERTIFICATE DOES NOT AMEND, EXTEND OR
ALTER THE COVERAGE AFFORDED BY THE POLICIES BELOW.

COMPANIES AFFORDING COVERAGE

Commercial Union Ins. Co.

Attn:

Ext:

COMPANY
ACOMPANY
BCOMPANY
CCOMPANY
DINSURED
Portland Grog Shop
Charles Mcgee
11 Moulton Street
Portland, ME 04101

COVERAGES

THIS IS TO CERTIFY THAT THE POLICIES OF INSURANCE LISTED BELOW HAVE BEEN ISSUED TO THE INSURED NAMED ABOVE FOR THE POLICY PERIOD
INDICATED, NOTWITHSTANDING ANY REQUIREMENT, TERM OR CONDITION OF ANY CONTRACT OR OTHER DOCUMENT WITH RESPECT TO WHICH THIS
CERTIFICATE MAY BE ISSUED OR MAY PERTAIN, THE INSURANCE AFFORDED BY THE POLICIES DESCRIBED HEREIN IS SUBJECT TO ALL THE TERMS,
EXCLUSIONS AND CONDITIONS OF SUCH POLICIES. LIMITS SHOWN MAY HAVE BEEN REDUCED BY PAID CLAIMS.

CO LTR	TYPE OF INSURANCE	POLICY NUMBER	POLICY EFFECTIVE DATE (MM/DD/YY)	POLICY EXPIRATION DATE (MM/DD/YY)	LIMITS
	GENERAL LIABILITY				GENERAL AGGREGATE \$ 2,000,000
	X COMMERCIAL GENERAL LIABILITY				PRODUCTS COMP/PROP AGG \$ 2,000,000
A	CLAIMS MADE X OCCUR	YMR568876	12/18/1997	12/18/1998	PERSONAL & ADV INJURY \$ 1,000,000
	OWNERS & CONTRACTORS PROT				EACH OCCURRENCE \$ 1,000,000
					FIRE DAMAGE (Any one fire) \$ 100,000
					MED EXP (Any one person) \$ 10,000
	AUTOMOBILE LIABILITY				COMBINED SINGLE LIMT \$
	ANY AUTO				BODILY INJURY (Per person) \$
	ALLOWED AUTOS				BODILY INJURY (Per accident) \$
	SCHEDULED AUTOS				PROPERTY DAMAGE \$
	HIRED AUTOS				
	NON OWNED AUTOS				
	GARAGE LIABILITY				AUTO ONLY - EA ACCIDENT \$
	ANY AUTO				OTHER THAN AUTO ONLY \$
					EACH ACCIDENT \$
					AGGREGATE \$
	EXCESS LIABILITY				EACH OCCURRENCE \$
	UMBRELLA FORM				AGGREGATE \$
	OTHER THAN UMBRELLA FORM				\$
	WORKERS COMPENSATION AND EMPLOYERS LIABILITY				WC STATUTORY LIMITS OTHER \$
	THE PROPRIETARY PARTNERS/EXECUTIVE OFFICERS ARE EXCL				EL EACH ACCIDENT \$
					EL DISEASE - POLICY LIMT \$
					EL DISEASE - EA EMPLOYEE \$
	OTHER Business Personal				\$255,600 limit Ded: \$1,000
A	Property Special Cov Incl Theft	YMR568876	12/18/1998	12/18/1999	

DESCRIPTION OF OPERATIONS/LOCATIONS/VEHICLES/SPECIAL ITEMS

The Certificate Holder is Named Add'l Insured in regards to the Named Insured sidewalk sign

CERTIFICATE HOLDER

City of Portland
389 Congress St
Portland, ME 04101

CANCELLATION

SHOULD ANY OF THE ABOVE DESCRIBED POLICIES BE CANCELLED BEFORE THE
EXPIRATION DATE THEREOF, THE ISSUING COMPANY WILL ENDEAVOR TO MAIL
10 DAYS WRITTEN NOTICE TO THE CERTIFICATE HOLDER NAMED TO THE LEFT
BUT FAILURE TO MAIL SUCH NOTICE SHALL IMPOSE NO OBLIGATION OR LIABILITY
OF ANY KIND UPON THE COMPANY, ITS AGENTS OR REPRESENTATIVES

AUTHORIZED REPRESENTATIVE

Sandra Wing/VGP

Sandra L Wing

CHURCH ST. D.

ST. TERRIEN ARCHITECTS
ENGINEER; STRUCTURAL DESIGN, ME.
BOX 565, PORTLAND, ME.
ST., PORTLAND, ME.

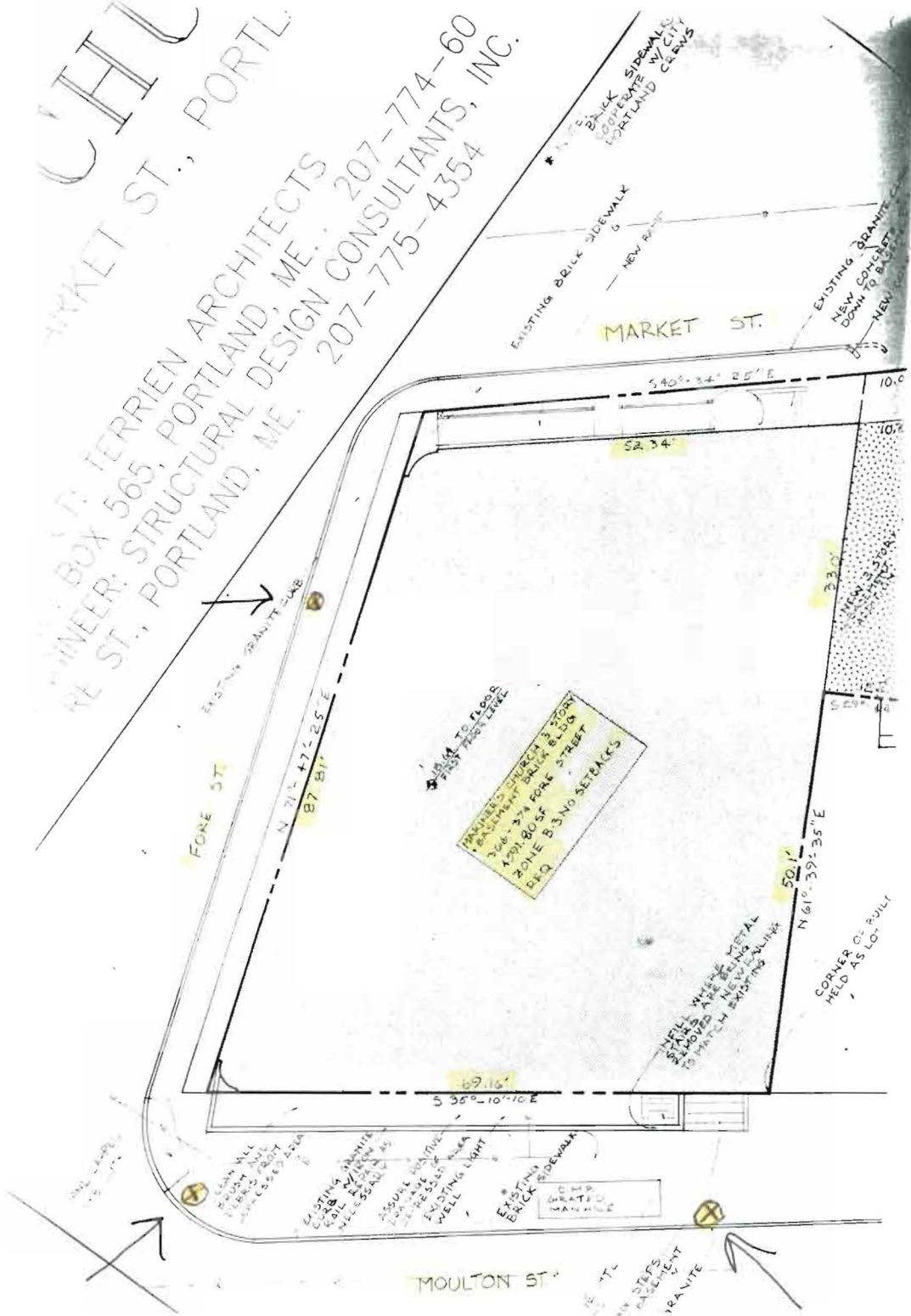

SIGNAGE PRE-APPLICATION

PLEASE ANSWER ALL QUESTIONS

ADDRESS: 11 MOULTON STREET ZONE: B-3

OWNER: PORTLAND GROG SHOP, INC.

APPLICANT: PORTLAND GROG SHOP, INC.

ASSESSOR NO. UNKNOWN

SINGLE TENANT LOT? YES NO X

MULTI TENANT LOT? YES X NO

FREESTANDING SIGN? YES X NO

DIMENSIONS 2'X4' DOUBLE SIDED
SIDEWALK SIGN

(ex. pole sign. . .)

MORE THAN ONE SIGN? YES X NO DIMENSIONS 2 ADDITIONAL 2'X4' DOUBLE
SIDED SIDEWALK SIGNS

BLDG. WALL SIGN? YES NO X DIMENSIONS N/A

(attached to bldg)

MORE THAN ONE SIGN? YES N/A NO N/A DIMENSIONS N/A

LIST ALL EXISTING SIGNAGE AND THEIR DIMENSIONS:

3 - 2'X4' DOUBLE SIDED
SIDEWALK SIGNS

LOT FRONTAGE (FEET): 87.81

BLDG FRONTAGE (FEET): 87.81

AWNING YES NO X IS AWNING BACKLIT? YES N/A NO N/A

HEIGHT OF AWNING: N/A

IS THERE ANY COMMUNICATION, MESSAGE, TRADEMARK OR SYMBOL ON IT? N/A

*** TENANT BLDG. FRONTAGE (IN FEET) N/A

*** REQUIRED INFORMATION

AREA FOR COMPUTATION

**A SITE SKETCH AND BUILDING SKETCH SHOWING EXACTLY WHERE
EXISTING AND NEW SIGNAGE IS LOCATED MUST BE PROVIDED. SKETCHES
AND/OR PICTURES OF PROPOSED ARE ALSO REQUIRED.**

SIGNATURE OF APPLICANT: GTW/Ger

DATE: 7-29-99

BUILDING PERMIT REPORT

DATE: 30 July 99 ADDRESS: 366-374 Fore St. CBL: 032-S001
REASON FOR PERMIT: 3 Side walk Signs
BUILDING OWNER: Portland Grog Shop Inc
PERMIT APPLICANT: _____ /Contractor_____
USE GROUP Signage CONSTRUCTION TYPE _____

The City's Adopted Building Code (The BOCA National Building Code/1996 with City Amendments)
The City's Adopted Mechanical Code (The BOCA National Mechanical Code/1993)

CONDITION(S) OF APPROVAL

This permit is being issued with the understanding that the following conditions are met: X1, *34

Approved with the following conditions:

- X 1. This permit does not excuse the applicant from meeting applicable State and Federal rules and laws.
2. Before concrete for foundation is placed, approvals from the Development Review Coordinator and Inspection Services must be obtained. (A 24 hour notice is required prior to inspection)
3. Foundation drain shall be placed around the perimeter of a foundation that consists of gravel or crushed stone containing not more than 10 percent material that passes through a No. 4 sieve. The drain shall extend a minimum of 12 inches beyond the outside edge of the footing. The thickness shall be such that the bottom of the drain is not higher than the bottom of the base under the floor, and that the top of the drain is not less than 6 inches above the top of the footing. The top of the drain shall be covered with an approved filter membrane material. Where a drain tile or perforated pipe is used, the invert of the pipe or tile shall not be higher than the floor elevation. The top of joints or top of perforations shall be protected with an approved filter membrane material. The pipe or tile shall be placed on not less than 2" of gravel or crushed stone, and shall be covered with not less than 6" of the same material. Section 1813.5.2
4. Foundations anchors shall be a minimum of 1/2" in diameter, 7" into the foundation wall, minimum of 12" from corners of foundation and a maximum 6' o.c. between bolts. (Section 2305.17)
5. Waterproofing and dampproofing shall be done in accordance with Section 1813.0 of the building code.
6. Precaution must be taken to protect concrete from freezing. Section 1908.0
7. It is strongly recommended that a registered land surveyor check all foundation forms before concrete is placed. This is done to verify that the proper setbacks are maintained.
8. Private garages located beneath habitable rooms in occupancies in Use Group R-1, R-2, R-3 or I-1 shall be separated from adjacent interior spaces by fire partitions and floor/ceiling assembly which are constructed with not less than 1-hour fire resisting rating. Private garages attached side-by-side to rooms in the above occupancies shall be completely separated from the interior spaces and the attic area by means of 1/2 inch gypsum board or the equivalent applied to the garage means of 1/2 inch gypsum board or the equivalent applied to the garage side. (Chapter 4, Section 407.0 of the BOCA/1996)
9. All chimneys and vents shall be installed and maintained as per Chapter 12 of the City's Mechanical Code. (The BOCA National Mechanical Code/1993). Chapter 12 & NFPA 211
10. Sound transmission control in residential building shall be done in accordance with Chapter 12, Section 1214.0 of the City's Building Code.
11. Guardrails & Handrails: A guardrail system is a system of building components located near the open sides of elevated walking surfaces for the purpose of minimizing the possibility of an accidental fall from the walking surface to the lower level. Minimum height all Use Groups 42", except Use Group R which is 36". In occupancies in Use Group A, B, H-4, I-1, I-2, M and R and public garages and open parking structures, open guards shall have balusters or be of solid material such that a sphere with a diameter of 4" cannot pass through any opening. Guards shall not have an ornamental pattern that would provide a ladder effect. (Handrails shall be a minimum of 36" but not more than 38". Use Group R-3 shall not be less than 30", but not more than 38".) Handrail grip size shall have a circular cross section with an outside diameter of at least 1 1/4" and not greater than 2". (Sections 1021 & 1022.0) - Handrails shall be on both sides of stairway. (Section 1014.7)
12. Headroom in habitable space is a minimum of 7'6". (Section 1204.0)
13. Stair construction in Use Group R-3 & R-4 is a minimum of 10" tread and 7 1/4" maximum rise. All other Use Group minimum 11" tread, 7" maximum rise. (Section 1014.0)
14. The minimum headroom in all parts of a stairway shall not be less than 80 inches. (6'8") 1014.4
15. Every sleeping room below the fourth story in buildings of Use Groups R and I-1 shall have at least one operable window or exterior door approved for emergency egress or rescue. The units must be operable from the inside without the use of special knowledge or separate tools. Where windows are provided as means of egress or rescue they shall have a sill height not more than 44 inches (1118mm) above the floor. All egress or rescue windows from sleeping rooms shall have a minimum net clear opening height dimension of 24 inches (610mm). The minimum net clear opening width dimension shall be 20 inches (508mm), and a minimum net clear opening of 5.7 sq. ft. (Section 1018.6)
16. Each apartment shall have access to two (2) separate, remote and approved means of egress. A single exit is acceptable when it exits directly from the apartment to the building exterior with no communications to other apartment units. (Section 1010.1)

INFORMATION REQUIREMENTS FOR SIGN PERMIT APPLICATION

Applicants for a sign permit will be asked to submit the following information to the Code Enforcement Office:

1. Proof of insurance — ENCLOSED
2. Letter of permission from the owner N/A
3. A sketch plan of lot, indicating location of buildings, driveways and any abutting streets or right of ways. Lengths of building frontages and street frontages should be noted. (see attached) — ENCLOSED
4. Indicate on the plan all existing and proposed signs — ENCLOSED
5. Computation of the following:
 - A) Sign area of each existing ~~and proposed~~ building sign 16 SF EACH
 - B) Sign area height and setback of each existing ~~and proposed~~ freestanding sign
THREE 2' X 4' DOUBLE SIDED SIDEWALK SIGNS
6. A sketch of any proposed sign(s), indicating dimensions, materials, source of illumination and construction method (see attached). N/A
7. Certificate of flammability required for awning/canopy at time of application. N/A
8. UL # required for lighted signs at the time of application. N/A

Fee for permit - \$30.00 plus \$0.20 per square foot

Fee for awning based on cost of work - \$30.00 for the first \$1,000.00, \$6.00 for each additional \$1,000.000.

NOTE: Once a sketch plan has been filed for a property, the code enforcement office will keep a record of the plan so that a new sketch plan will not be required for later changes to signage on the property. In such an instance, applicants will only be required to submit information applicable to the new sign.

17. All vertical openings shall be enclosed with construction having a fire rating of at least one (1) hour, including fire doors with self closer's. (Over 3 stories in height requirements for fire rating is two (2) hours.) (Section 710.0)
18. The boiler shall be protected by enclosing with (1)hour fire rated construction including fire doors and ceiling, or by providing automatic extinguishment. (Table 302.1.1)
19. All single and multiple station smoke detectors shall be of an approved type and shall be installed in accordance with the provisions of the City's Building Code Chapter 9, Section 920.3.2 (BOCA National Building Code/1996), and NFPA 101 Chapter 18 &19. (Smoke detectors shall be installed and maintained at the following locations):
 - In the immediate vicinity of bedrooms
 - In all bedrooms
 - In each story within a dwelling unit, including basementsIn addition to the required AC primary power source, required smoke detectors in occupancies in Use Groups R-2, R-3 and I-1 shall receive power from a battery when the AC primary power source is interrupted. (Interconnection is required) Section 920.3.2.
20. A portable fire extinguisher shall be located as per NFPA #10. They shall bear the label of an approved agency and be of an approved type. (Section 921.0)
21. The Fire Alarm System shall maintained to NFPA #72 Standard.
22. The Sprinkler System shall maintained to NFPA #13 Standard.
23. All exit signs, lights and means of egress lighting shall be done in accordance with Chapter 10 Section & Subsections 1023.0 & 1024.0 of the City's Building Code. (The BOCA National Building Code/1996)
24. Section 25-135 of the Municipal Code for the City of Portland states, "No person or utility shall be granted a permit to excavate or open any street or sidewalk from the time of November 15 of each year to April 15 of the following year".
25. The builder of a facility to which Section 4594-C of the Maine State Human Rights Act Title 5 MRSA refers, shall obtain a certification from a design professional that the plans commencing construction of the facility, the builder shall submit the certification the Division of Inspection Services.
26. Ventilation shall meet the requirements of Chapter 12 Sections 1210.0 of the City's Building Code. (Crawl spaces & attics).
27. All electrical, plumbing and HVAC permits must be obtained by a Master Licensed holders of their trade. **No closing in of walls until all electrical (min.72 hours notice) and plumbing inspections have been done.**
28. All requirements must be met before a final Certificate of Occupancy is issued.
29. All building elements shall meet the fastening schedule as per Table 2305.2 of the City's Building Code (the BOCA National Building Code/1996).
30. Ventilation of spaces within a building shall be done in accordance with the City's Mechanical Code (The BOCA National Mechanical Code/1993). (Chapter M-16)
31. Please read and implement the attached Land Use Zoning report requirements.
32. Boring, cutting and notching shall be done in accordance with Sections 2305.4.4, 2305.5.1 and 2305.5.3 of the City's Building Code.
33. Glass and glazing shall meet the requirements of Chapter 24 of the building code.
34. All signage, shall be done in accordance with Section 3102.0 signs of the City's Building Code, (The BOCA National Building Code 1996).
35. _____
36. _____
37. _____
38. _____

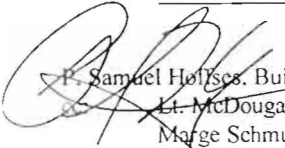
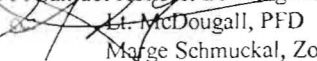
 P. Samuel Holystes, Building Inspector
 Lt. McDougall, PFD
Marge Schmuckal, Zoning Administrator

PS11 7/24/99

****On the basis of plans submitted and conditions placed on these plans any deviations shall require a separate approval.**

**OLD POET TAVERN
RESTAURANT**

Dover's people

01/10/2007

17. $\frac{1}{2}$

2)

Supra

11

1



10

10

10

10



old port tavern
**BIILIARD'S
ROOM**

368 FOSTER ST. PORTLAND, ME

LUNCH

11:30AM-5:00PM

DINNER

5:00PM-9:30PM

FOOD SPECIALS 7 DAYS A WEEK

MON-FRI / 11:30-5PM

1HR FREE POOL W/ LUNCH

Happy Hour 4-6:30PM Mon-Fri

OPEN 7 DAYS A WEEK / 11:30AM-10:00AM

MC - VISA - AM. EXPRESS

Join the
Millennium
League