

| PLUMBING/FIXTURE/EQUIPMENT SCHEDULE | | | | | |
|-------------------------------------|------------------------|-------------------|-------------|--------|-------|
| QUANTITY | DESCRIPTION | MFG | MODEL | FINISH | NOTES |
| 1 | ESPRESSO MACHINE | SYNESSO | MVP | .. | .. |
| 1 | DECAF ESPRESSO GRINDER | MASSER | MINI | .. | .. |
| 1 | ESPRESSO GRINDER | MASSER | KONY | .. | .. |
| 1 | WATER FILTER | CUND | 3M 0P90 | .. | .. |
| 1 | MILK FRIDGE | TURBO AIR | MUR-48 | .. | .. |
| 1 | BACK STOCK FRIDGE | EMPURA | ETM-23R 27" | .. | .. |
| 1 | COLD BREW FRIDGE | EDGESTAR | KC300TWIN | .. | .. |
| 1 | ICE MAKER | SCOTSMAN | CC330SA-1D | .. | .. |
| 1 | ICE BIN | SCOTSMAN | 8330P | .. | .. |
| 1 | FRONT COUNTER ICE BIN | REGENCY | 18X24 | .. | .. |
| 1 | DRIP GRINDER | EK | EK-43 | .. | .. |
| 1 | DRIP BREWER | FETCO | CBS-2142XTS | .. | .. |
| 1 | HOT WATER TOWER | FETCO | HWD-2150 | .. | .. |
| 1 | TOASTER OVEN | EQUIPEX | BAR-100 | .. | .. |
| 1 | PITCHER RINSE | PRISMA | RINSER | .. | .. |
| 1 | WATER DISPENSER | DELFIELD | 307 SERIES | .. | .. |
| 2 | TOILETS | EXISTING RETAINED | .. | .. | .. |
| 2 | LAVATORY SINKS | EXISTING RETAINED | .. | .. | .. |
| 1 | 24"X24" LAUNDRY SINK | TBD BY OWNER | .. | .. | .. |
| 1 | 3-BAY SINK | EXISTING RETAINED | .. | .. | .. |

NOTES:
 1. REFER TO ARCHITECTURAL FLOOR PLANS FOR PLACEMENT.
 2. CONFIRM ALL INSTALL CLEARANCES TO MEET ADA REQUIREMENTS.

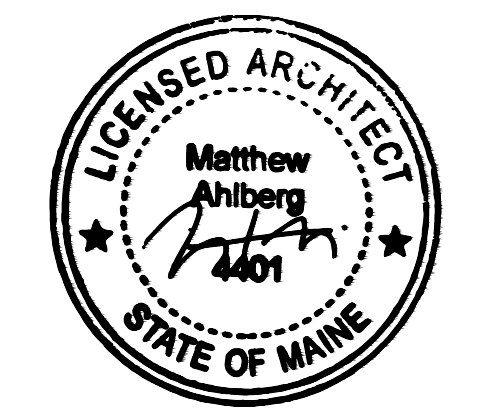
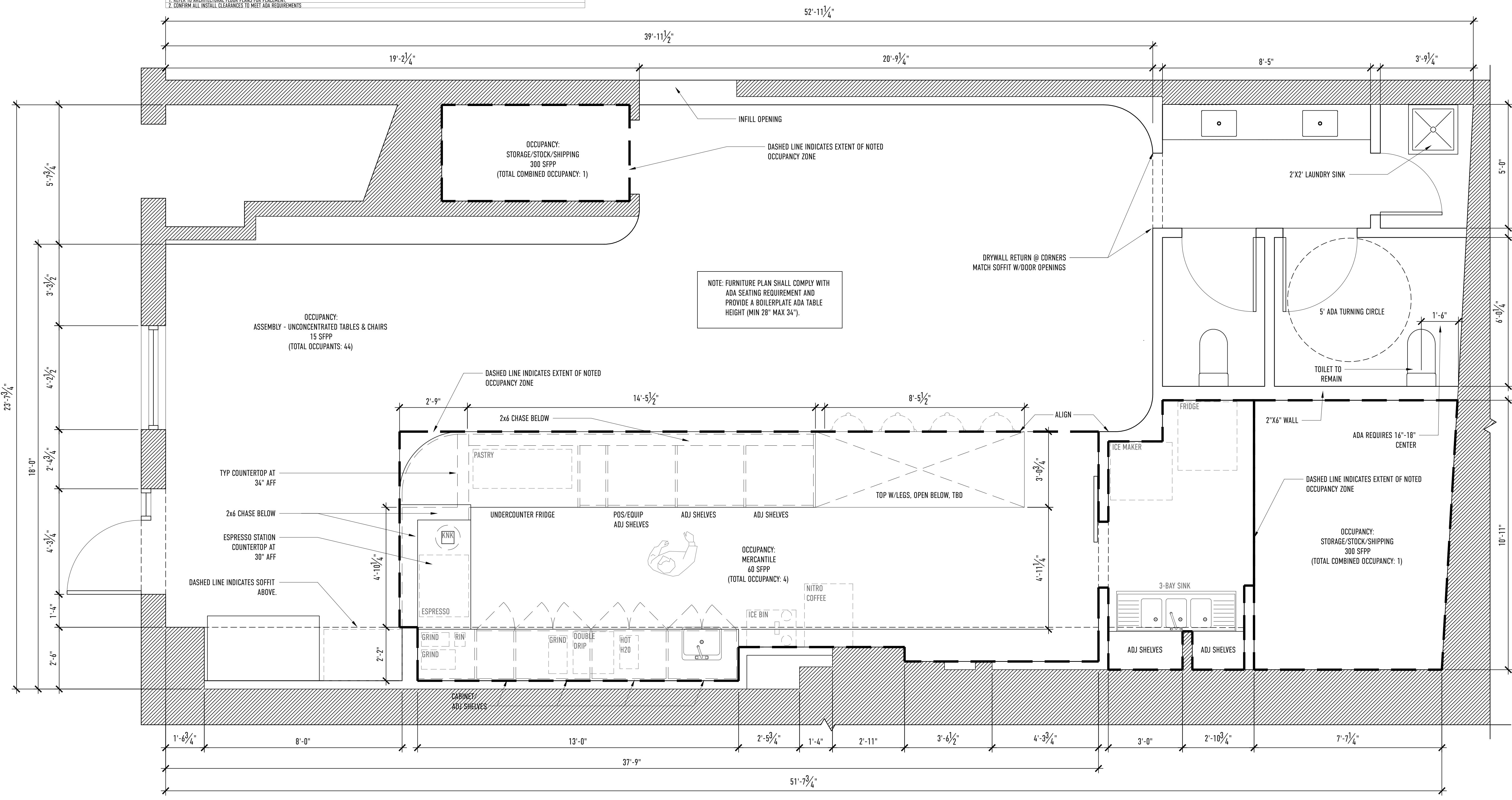

REVISIONS:

PROPOSED FLOOR PLAN

A.101
 PROJECT NAME: HIGHER GROUNDS
 51 WHARF STREET
 PORTLAND, MAINE 04101

DATE OF ISSUE: AUGUST 04, 2017
 ISSUED FOR: PERMITTING
 SCALE: 1/2" = 1'-0"
THIS DRAWING IS THE PROPERTY OF BARRETT MADE AND IS NOT TO BE COPIED OR REPRODUCED IN ANY MANNER WITHOUT THE WRITTEN CONSENT OF BARRETT MADE.



1 FLOOR PLAN
 SCALE: 1/2" = 1'-0"

