

# DISPLAY THIS CARD ON PRINCIPAL FRONTAGE OF WORK CITY OF PORTLAND

## BUILDING INSPECTION

Please Read Application And Notes, If Any, Attached

Permit Number: 060707

*Application expired as abandoned - 1/14/08*

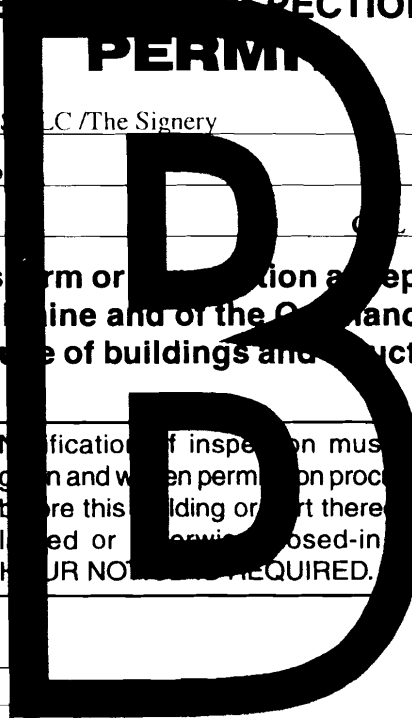

This is to certify that FORE STREET HOLDINGS LLC /The Signery

has permission to Attatch a 20" x 40" sign to b

AT 436 FORE ST

032 R007001

provided that the person or persons who accept this permit shall comply with all of the provisions of the Statutes of the State and of the Ordinances of the City of Portland regulating the construction, maintenance and use of buildings and structures, and of the application on file in this department.

Apply to Public Works for street line and grade if nature of work requires such information.

Notification of inspection must be given and when permission is procured before this building or part thereof is altered or service is closed-in. 4 HOUR NOTICE REQUIRED.

A certificate of occupancy must be procured by owner before this building or part thereof is occupied.

### OTHER REQUIRED APPROVALS

Fire Dept. \_\_\_\_\_

Health Dept. \_\_\_\_\_

Appeal Board \_\_\_\_\_

Other \_\_\_\_\_

Department Name

Director - Building & Inspection Services

**PENALTY FOR REMOVING THIS CARD**

**City of Portland, Maine - Building or Use Permit Application**  
 389 Congress Street, 04101 Tel: (207) 874-8703, Fax: (207) 874-8716

Permit No: 06-0707	Issue Date:	CBL: 032 R004001
-----------------------	-------------	---------------------

Location of Construction: 434 Fore St/ 45 Wharf St	Owner Name: Fore Street Holdings Llc	Owner Address: 6 Webber Way	Phone:
Business Name:	Contractor Name: The Signery	Contractor Address: 299 Forest Avenue Portland	Phone: 2078797700
Lessee/Buyer's Name	Phone:	Permit Type: Signs - Permanent	Zone: B-3

Past Use: Commercial - retail furniture "Third in knots"	Proposed Use: Commercial Attach 20" x 40" sign to bldg.	Permit Fee: \$46.50	Cost of Work: \$46.50	CEO District: 1
Proposed Project Description: Attach a 20" x 40" sign to bldg.		FIRE DEPT: <input type="checkbox"/> Approved <input type="checkbox"/> Denied	INSPECTION: Use Group: Type:	
		Signature:	Signature:	

*expired + abandoned permit application 1/14/08*

**PEDESTRIAN ACTIVITIES DISTRICT (P.A.D.)**

Action:  Approved  Approved w/Conditions  Denied

Signature: Date:

Permit Taken By: dmartin	Date Applied For: 05/15/2006	<b>Zoning Approval</b>
-----------------------------	---------------------------------	------------------------

- This permit application does not preclude the Applicant(s) from meeting applicable State and Federal Rules.
- Building permits do not include plumbing, septic or electrical work.
- Building permits are void if work is not started within six (6) months of the date of issuance. False information may invalidate a building permit and stop all work..

Special Zone or Reviews	Zoning Appeal	Historic Preservation
<input type="checkbox"/> Shoreland	<input type="checkbox"/> Variance	<input type="checkbox"/> Not in District or Landmark
<input type="checkbox"/> Wetland	<input type="checkbox"/> Miscellaneous	<input type="checkbox"/> Does Not Require Review
<input type="checkbox"/> Flood Zone	<input type="checkbox"/> Conditional Use	<input type="checkbox"/> Requires Review
<input type="checkbox"/> Subdivision	<input type="checkbox"/> Interpretation	<input type="checkbox"/> Approved
<input type="checkbox"/> Site Plan	<input type="checkbox"/> Approved	<input checked="" type="checkbox"/> Approved w/Conditions
Maj <input type="checkbox"/> Minor <input type="checkbox"/> MM <input type="checkbox"/>	<input type="checkbox"/> Denied	<input type="checkbox"/> Denied
Date: <i>5/31/06</i>	Date:	Date: <i>5/31/06</i>

*6/08/06  
D. Auden*

**CERTIFICATION**

I hereby certify that I am the owner of record of the named property, or that the proposed work is authorized by the owner of record and that I have been authorized by the owner to make this application as his authorized agent and I agree to conform to all applicable laws of this jurisdiction. In addition, if a permit for work described in the application is issued, I certify that the code official's authorized representative shall have the authority to enter all areas covered by such permit at any reasonable hour to enforce the provision of the code(s) applicable to such permit.

SIGNATURE OF APPLICANT	ADDRESS	DATE	PHONE
------------------------	---------	------	-------

RESPONSIBLE PERSON IN CHARGE OF WORK, TITLE	DATE	PHONE
---	------	-------

**City of Portland, Maine - Building or Use Permit**

389 Congress Street, 04101 Tel: (207) 874-8703, Fax: (207) 874-8716

<b>Permit No:</b> 06-0707	<b>Date Applied For:</b> 05/15/2006	<b>CBL:</b> 032 R004001
------------------------------	--	----------------------------

<b>Location of Construction:</b> 434 Fore St/ 45 Wharf St	<b>Owner Name:</b> Fore Street Holdings Llc	<b>Owner Address:</b> 6 Webber Way	<b>Phone:</b>
<b>Business Name:</b>	<b>Contractor Name:</b> The Signery	<b>Contractor Address:</b> 299 Forest Avenue Portland	<b>Phone</b> (207) 879-7700
<b>Lessee/Buyer's Name</b>	<b>Phone:</b>	<b>Permit Type:</b> Signs - Permanent	

<b>Proposed Use:</b> Commercial Attatch 20" x 40" sign to bldg.	<b>Proposed Project Description:</b> Attatch a 20" x 40" sign to bldg.
--	---

<b>Dept:</b> Historical	<b>Status:</b> Approved with Conditions	<b>Reviewer:</b> Deborah Andrews	<b>Approval Date:</b> 06/08/2006
<b>Note:</b>			<b>Ok to Issue:</b> <input checked="" type="checkbox"/>
1) * Sign application does not include request for lighting; any proposed lighting would require approval.			
<b>Dept:</b> Zoning	<b>Status:</b> Approved	<b>Reviewer:</b> Marge Schmuckal	<b>Approval Date:</b> 05/31/2006
<b>Note:</b> had to reprint permit - CBL was wrong			<b>Ok to Issue:</b> <input checked="" type="checkbox"/>
<b>Dept:</b> Building	<b>Status:</b> Pending	<b>Reviewer:</b> Mike Nugent	<b>Approval Date:</b>
<b>Note:</b>			<b>Ok to Issue:</b> <input type="checkbox"/>

**Comments:**  
6/13/2006-mjn: Spoke with Owner need fastener detail and height above the sidewalk



# Signage/Awning Permit Application

If you or the property owner owes real estate or personal property taxes or user charges on any property within the City, payment arrangements must be made before permits of any kind are accepted.

Location/Address of Construction: <u>45 WHARF ST. PORTLAND, ME</u>		
Tax Assessor's Chart, Block & Lot Chart#      Block#      Lot# <u>32      R      004</u>	Owner: <u>STEVE BAUMAN</u>	Telephone: <u>774-8700</u> <u>730-1000</u>
Lessee/Buyer's Name (If Applicable) <u>CATHY JOHNSON</u>	Contractor name, address & telephone:	Total s.f. of signage x \$2.00 Per s.f. plus \$30.00/\$65.00 For H.D. signage= Total Fee: \$ <u>46.50</u> Awning Fee= cost of work _____ Total Fee: \$ _____

Who should we contact when the permit is ready: CATHY JOHNSON phone: 730-1000

Tenant/allocated building space frontage (feet): Length: 18'6" Height 14' 18.5 x 2 = 37#  
 Lot Frontage (feet) \_\_\_\_\_ Single Tenant or Multi Tenant Lot \_\_\_\_\_ max Allocated

Current Specific use: TEAK FURNITURE - RETAIL  
 If vacant, what was prior use: \_\_\_\_\_  
 Proposed Use: \_\_\_\_\_

Information on proposed sign(s):  
 Freestanding (e.g., pole) sign? Yes \_\_\_ No  Dimensions proposed: 20" x 40" = 800 ÷ 144 = 5.6# Height from grade: 10ft  
 Bldg. wall sign? (attached to bldg) Yes  No \_\_\_ Dimensions proposed: \_\_\_\_\_

Proposed awning? Yes \_\_\_ No  Is awning backlit? Yes \_\_\_ No \_\_\_  
 Height of awning: \_\_\_\_\_ Length of awning: \_\_\_\_\_ Depth: \_\_\_\_\_  
 Is there any communication, message, trademark or symbol on it? Yes \_\_\_ No \_\_\_  
 If yes, total s.f. of panels w/communications, message, trademark or symbol: \_\_\_\_\_ s.f.

Information on existing and previously permitted sign(s):  
 Freestanding (e.g., pole) sign? Yes \_\_\_ No \_\_\_ Dimensions: \_\_\_\_\_  
 Bldg. wall sign? (attached to bldg) Yes \_\_\_ No \_\_\_ Dimensions: \_\_\_\_\_  
 Awning? Yes \_\_\_ No \_\_\_ Sq. ft. area of awning w/communication: \_\_\_\_\_

DEPT. OF BUILDING INSPECTION  
 CITY OF PORTLAND, ME  
 MAY 12 2006  
 RECEIVED

A site sketch and building sketch showing exactly where existing and new signage is located must be provided.  
 Sketches and/or pictures of proposed signage and existing building are also required.

Please submit all of the information outlined in the Sign/Awning Application Checklist.  
Failure to do so may result in the automatic denial of your permit.

In order to be sure the City fully understands the full scope of the project, the Planning and Development Department may request additional information prior to the issuance of a permit. For further information visit us on-line at [www.portlandmaine.gov](http://www.portlandmaine.gov), stop by the Building Inspections office, room 315 City Hall or call 874-8703.

I hereby certify that I am the Owner of record of the named property, or that the owner of record authorizes the proposed work and that I have been authorized by the owner to make this application as his/her authorized agent. I agree to conform to all applicable laws of this jurisdiction. In addition, if a permit for work described in this application is issued, I certify that the Code Official's authorized representative shall have the authority to enter all areas covered by this permit at any reasonable hour to enforce the provisions of the codes applicable to this permit.

Signature of applicant: <u>Cathy A Johnson</u>	Date: <u>5-5-06</u>
--	---------------------

This is not a permit, you may not commence ANY work until the permit is issued.

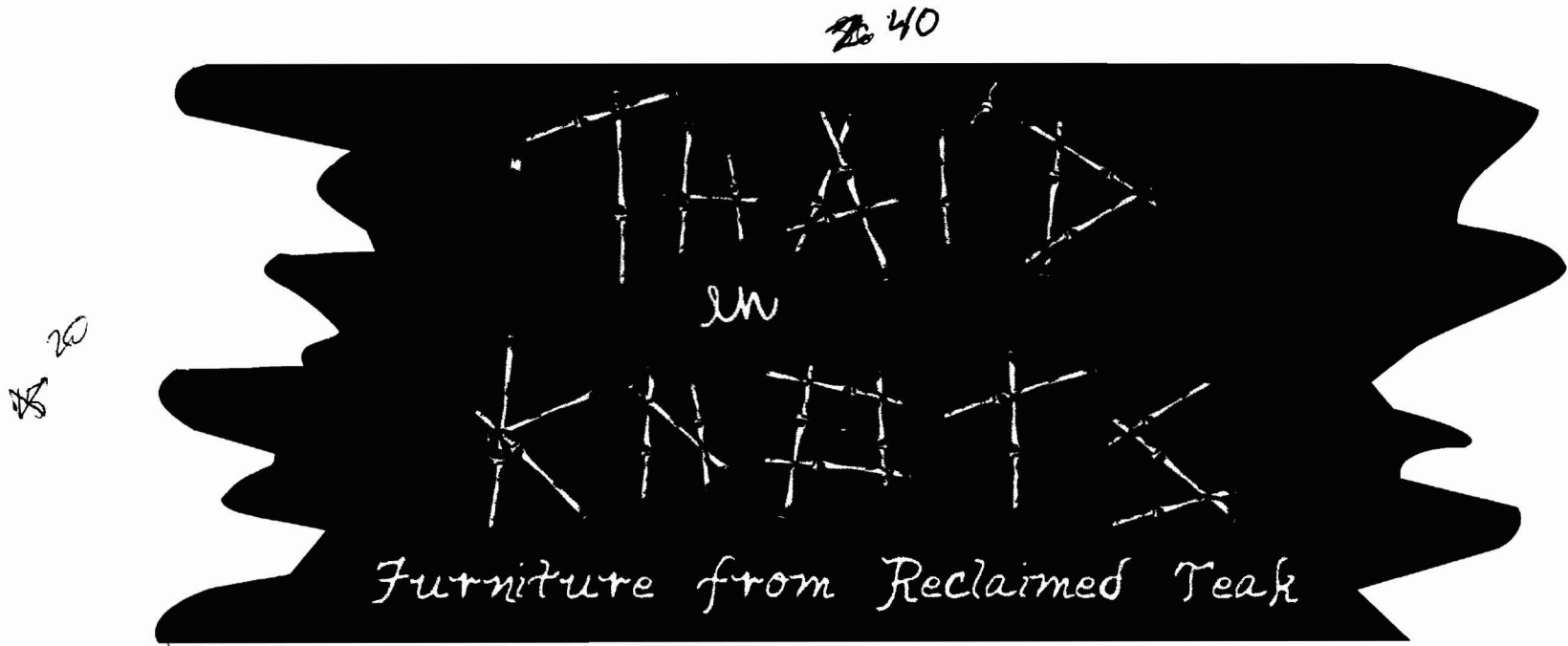

Approved BY: \_\_\_\_\_  
Date: \_\_\_\_\_

PLEASE REVIEW THIS PROOF CAREFULLY!  
AND SEND COPY BACK TO THE SIGNERY THANK YOU

 <small>THE SIGNERY COMPANY, WINDY HILLS, MA</small> 299 FOREST AVE PORTLAND, ME PHONE: 679-7700 FAX: 679-1579	<b>JOB INFO</b> 10171 <b>DESIGNER</b> KM	<b>SEE ABOVE FOR DETAILS</b>	<b>INSTALL</b> <input type="checkbox"/> M <input type="checkbox"/> V <input type="checkbox"/> B	
--	---	------------------------------	--	---

BY SIGNING OFF ON THIS PROOF, YOU ARE GIVING THE SIGNERY THE GO TO PRODUCE THIS WORK TO THE SPECIFICATIONS LISTED

Until approved Job and Deposit is made, This proof is property of The Signery

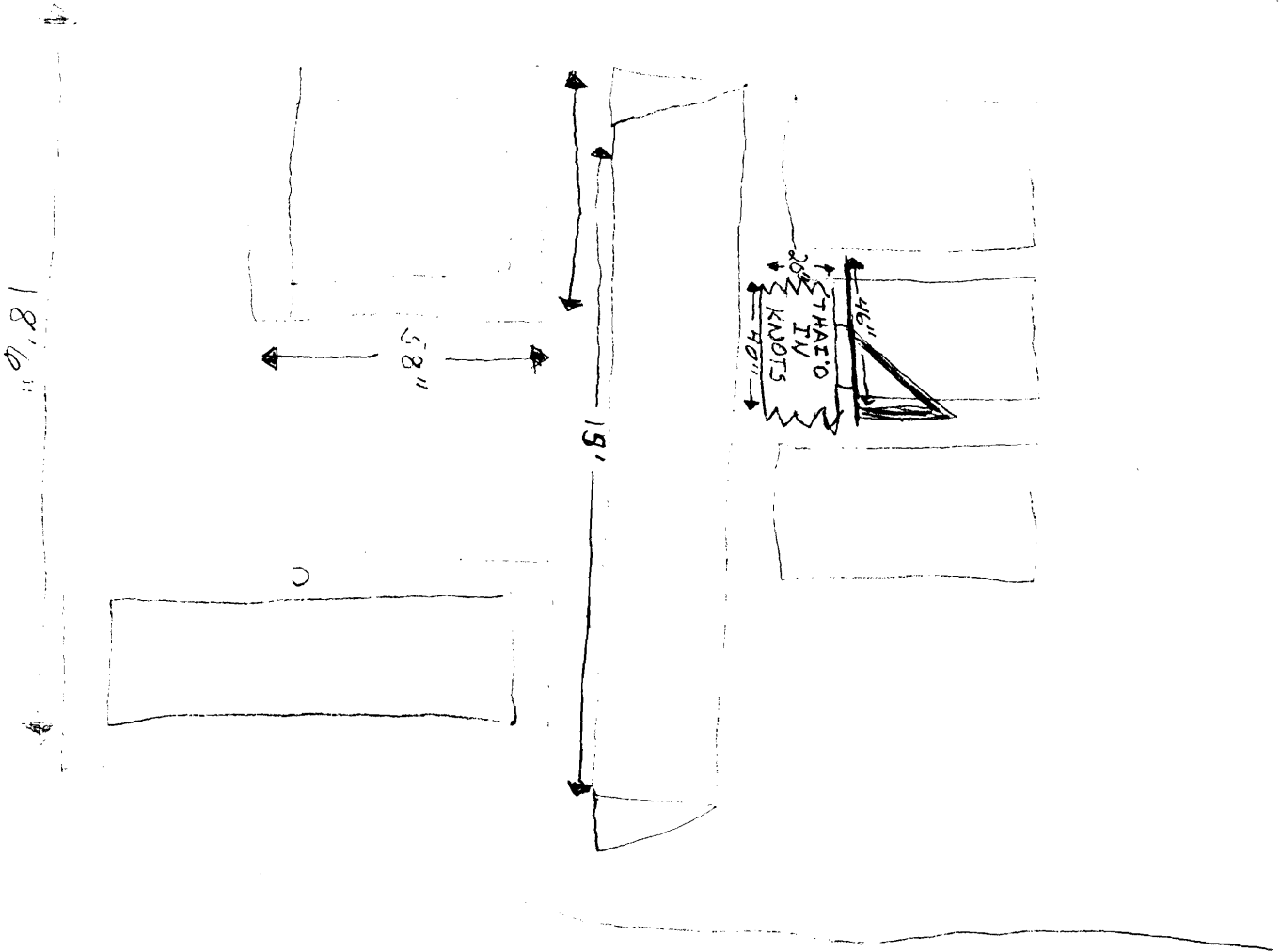

# ACORD™ CERTIFICATE OF LIABILITY INSURANCE

DATE (MM/DD/YYYY)  
05/08/2006

PRODUCER (207)829-3450 FAX (207)829-6350  
Norton Insurance Agency  
275 US Route 1  
Cumberland Foreside, ME 04110

THIS CERTIFICATE IS ISSUED AS A MATTER OF INFORMATION ONLY AND CONFERS NO RIGHTS UPON THE CERTIFICATE HOLDER. THIS CERTIFICATE DOES NOT AMEND, EXTEND OR ALTER THE COVERAGE AFFORDED BY THE POLICIES BELOW.

INSURED Thai'd in Knots LLC  
224 Pigeon Brook Rd  
W. Baldwin, ME 04091

INSURERS AFFORDING COVERAGE		NAIC #
INSURER A:	Peerless Insurance Company	24198
INSURER B:		
INSURER C:		
INSURER D:		
INSURER E:		

## COVERAGES

THE POLICIES OF INSURANCE LISTED BELOW HAVE BEEN ISSUED TO THE INSURED NAMED ABOVE FOR THE POLICY PERIOD INDICATED. NOTWITHSTANDING ANY REQUIREMENT, TERM OR CONDITION OF ANY CONTRACT OR OTHER DOCUMENT WITH RESPECT TO WHICH THIS CERTIFICATE MAY BE ISSUED OR MAY PERTAIN, THE INSURANCE AFFORDED BY THE POLICIES DESCRIBED HEREIN IS SUBJECT TO ALL THE TERMS, EXCLUSIONS AND CONDITIONS OF SUCH POLICIES. AGGREGATE LIMITS SHOWN MAY HAVE BEEN REDUCED BY PAID CLAIMS.

INSR ADD'L LTR INSRE	TYPE OF INSURANCE	POLICY NUMBER	POLICY EFFECTIVE DATE (MM/DD/YY)	POLICY EXPIRATION DATE (MM/DD/YY)	LIMITS
A	<b>GENERAL LIABILITY</b> <input checked="" type="checkbox"/> COMMERCIAL GENERAL LIABILITY CLAIMS MADE <input type="checkbox"/> OCCUR <input checked="" type="checkbox"/>	TBD	05/01/2006	05/01/2007	EACH OCCURRENCE \$ <b>1,000,000</b> DAMAGE TO RENTED PREMISES (Ea occurrence) \$ <b>100,000</b> MED EXP (Any one person) \$ <b>5,000</b> PERSONAL & ADV INJURY \$ <b>1,000,000</b> GENERAL AGGREGATE \$ <b>1,000,000</b> PRODUCTS - COMP/OP AGG \$ <b>2,000,000</b>
	<b>AUTOMOBILE LIABILITY</b> <input type="checkbox"/> ANY AUTO <input type="checkbox"/> ALL OWNED AUTOS <input type="checkbox"/> SCHEDULED AUTOS <input type="checkbox"/> HIRED AUTOS <input type="checkbox"/> NON-OWNED AUTOS				COMBINED SINGLE LIMIT (Ea accident) \$ BODILY INJURY (Per person) \$ BODILY INJURY (Per accident) \$ PROPERTY DAMAGE (Per accident) \$
	<b>GARAGE LIABILITY</b> <input type="checkbox"/> ANY AUTO				AUTO ONLY - EA ACCIDENT \$ OTHER THAN EA ACC \$ AUTO ONLY: AGG \$
	<b>EXCESS/UMBRELLA LIABILITY</b> <input type="checkbox"/> OCCUR <input type="checkbox"/> CLAIMS MADE DEDUCTIBLE RETENTION \$				EACH OCCURRENCE \$ AGGREGATE \$ \$ \$ \$
	<b>WORKERS COMPENSATION AND EMPLOYERS' LIABILITY</b> ANY PROPRIETOR/PARTNER/EXECUTIVE OFFICER/MEMBER EXCLUDED? If yes, describe under SPECIAL PROVISIONS below				WC STATUTORY LIMITS <input type="checkbox"/> OTH-ER <input type="checkbox"/> E.L. EACH ACCIDENT \$ E.L. DISEASE - EA EMPLOYEE \$ E.L. DISEASE - POLICY LIMIT \$
	<b>OTHER</b>				

DESCRIPTION OF OPERATIONS / LOCATIONS / VEHICLES / EXCLUSIONS ADDED BY ENDORSEMENT / SPECIAL PROVISIONS  
City of Portland is named as an additional insured with respects to General Liability for purpose of Sign hung on building for clients business

CERTIFICATE HOLDER	CANCELLATION
City of Portland	SHOULD ANY OF THE ABOVE DESCRIBED POLICIES BE CANCELLED BEFORE THE EXPIRATION DATE THEREOF, THE ISSUING INSURER WILL ENDEAVOR TO MAIL <b>10</b> DAYS WRITTEN NOTICE TO THE CERTIFICATE HOLDER NAMED TO THE LEFT, BUT FAILURE TO MAIL SUCH NOTICE SHALL IMPOSE NO OBLIGATION OR LIABILITY OF ANY KIND UPON THE INSURER, ITS AGENTS OR REPRESENTATIVES.
	AUTHORIZED REPRESENTATIVE Marcie Nason

May 8, 2006

Cathy Johnson  
Thai'd in Knots  
45 Wharf Street  
Portland, ME 04101

To Whom It May Concern, City of Portland:

As representative of the property owner at 45 Wharf Street, Portland, I give permission to our tenant, Cathy Johnson dba Thai'd in Knots, to affix signage she deems necessary to the successful operation of her business located at 45 Wharf Street.

With regards,

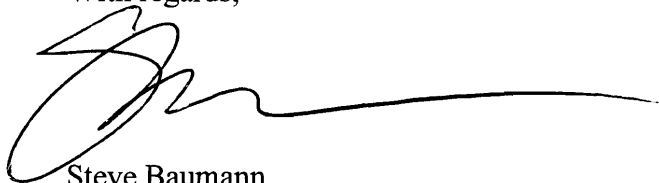

Steve Baumann  
Fore Street Holdings, LLC

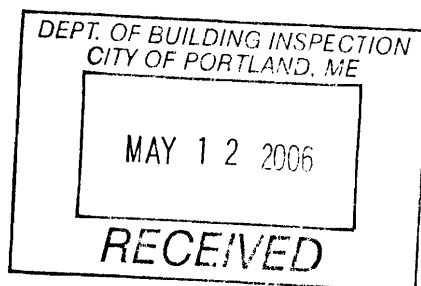





## Signage/Awning Permit Application Checklist

All of the following information is required and must be submitted. Checking off each item as you prepare your application package will ensure your package is complete and will help to expedite the permitting process.

- Certificate of Liability listing the City as additional insured if any portion of the sign abuts or encroaches on any public right of way, or can fall into any public right of way.
- Letter of permission from the owner indicating the permissions granted and the tenant/space building frontage.
- A sketch plan of lot indicating location of buildings, driveways and any abutting streets or rights of way, lengths of building frontages, street frontages and all existing setbacks. Please indicate on the plan all existing and proposed signs with their dimensions and specific locations. Be sure to include distance from the ground and building façade dimensions for any signage attached to the building.
- A sketch or photo of any proposed sign(s) indicating content, dimensions, materials, source of illumination, construction method as well as specifics of installation/attachment.
- Certificate of flammability required for awning or canopy.
- A UL# is required for lighted signs at the time of final inspection.
- Pre-application questionnaire completed and attached.
- Photos of existing signage
- Details for sign fastening, attachment or mounting in the ground.

Permit fee for signage or awning-with-signage: \$30.00 plus \$2.00 per square foot of sign.

Permit fee for awning-without-signage is based on cost of work:  
\$30.00 for the first \$1,000.00, \$9.00 per additional \$1,000.00 of cost.

Base application fee for any Historic District signage is \$65.00.