



**GAWRON
TURGEON
ARCHITECTS**
32 Black Point Road
Scarborough, Maine 04074
www.gawronturgeon.com
TEL: 207. 883. 6307
FAX: 207. 883. 0361

45-37-35 WHARF STREET
Proposed Renovations
Portland, Maine

REVISIONS

#	DATE	DESCRIPTION

DATE:	10.25.05
PROJECT #	100065
DESIGNED BY:	DMR
CHECKED BY:	DMR
DRAWING SCALE	1/8" = 1'-0"

SHEET TITLE:

PLANS

A100

© COPYRIGHT 1985-2005
GAWRON TURGEON ARCHITECTS
ALL RIGHTS RESERVED. NO PART OF THIS
DRAWING MAY BE REPRODUCED OR
TRANSMITTED IN ANY FORM OR BY ANY
MEANS, ELECTRONIC OR MECHANICAL,
INCLUDING PHOTOCOPYING, RECORDING,
OR BY ANY INFORMATION STORAGE
RETRIEVAL SYSTEM, WITHOUT
PERMISSION IN WRITING FROM
GAWRON TURGEON ARCHITECTS

DEMOLITION PLAN LEGEND

- [01] REMOVE STAIRS - PROVIDE SMOOTH LEVEL SURFACE FOR APPLICATION OF SCHEDULED FLOORING
- [02] REMOVE STAIR HANDRAILS & BALUSTERS
- [03] REMOVE WALL AS REQUIRED FOR NEW CONSTRUCTION
- [04] REMOVE MILLWORK - PROVIDE SMOOTH LEVEL SURFACE FOR APPLICATION OF SCHEDULED FLOORING
- [05] REMOVE DOOR - LEAVE IN PLACE & ALL ASSOCIATED HARDWARE AS REQUIRED FOR NEW CONSTRUCTION
- [06] REMOVE EXISTING UNTIL & RESTORE EXISTING OPENING - REPAIR ALL EXISTING FINISHES TO MATCH EXISTING FINISHES. APPLICATION OF SCHEDULED FINISHES

EXISTING EMERGENCY LIGHTING LEGEND

- Off Existing Fire Emergency
- Existing Emergency Light
- Existing Exit Sign

NOTE: EXISTING TENANT SPACES EQUIPPED w/ SPRINKLER FIRE SUPPRESSION

J16 LEGEND

NTS EXISTING CONDITIONS PLAN & PROPOSED DEMOLITION PLAN

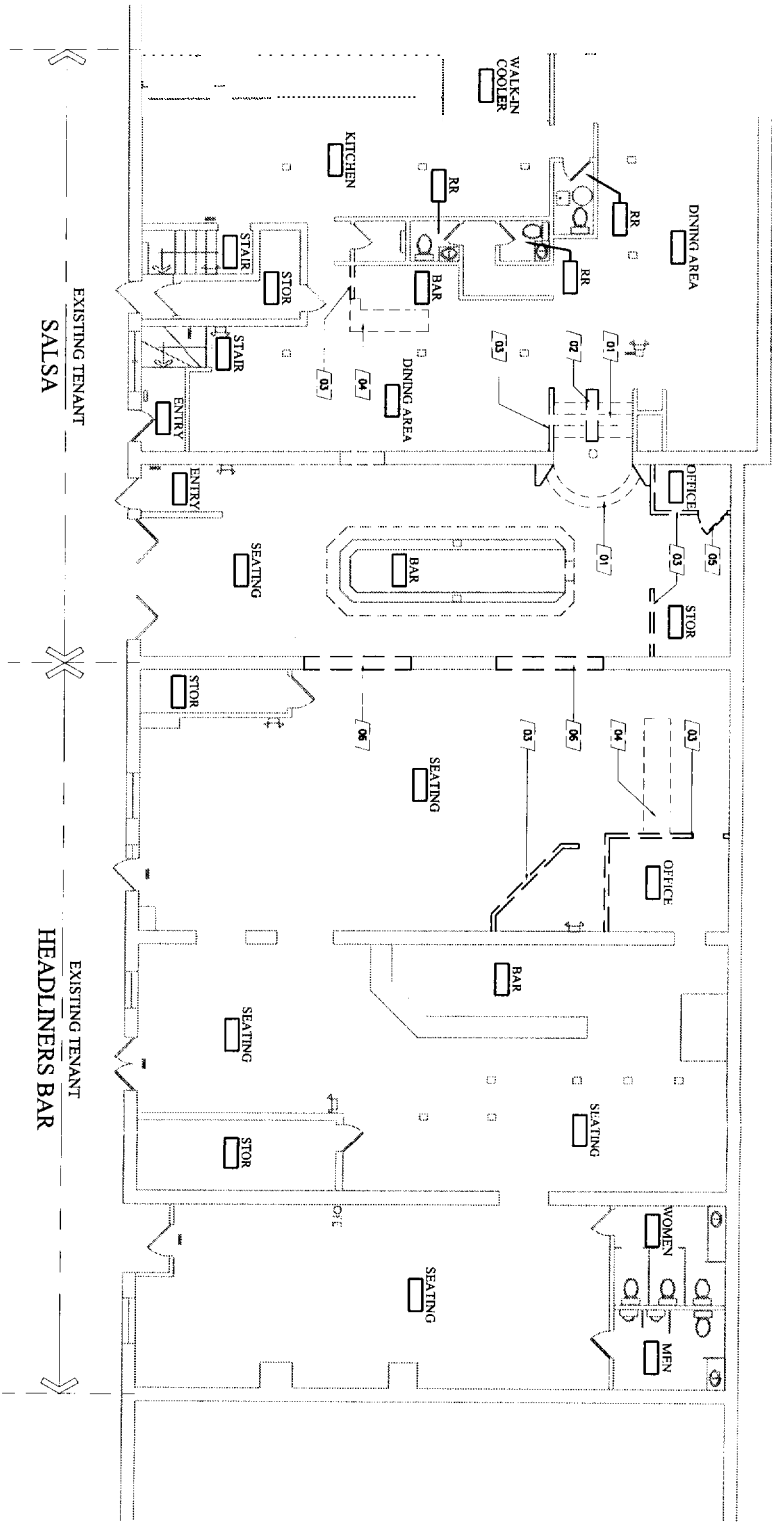

J1 EXISTING CONDITIONS PLAN & PROPOSED DEMOLITION PLAN

1/8" = 1'-0"

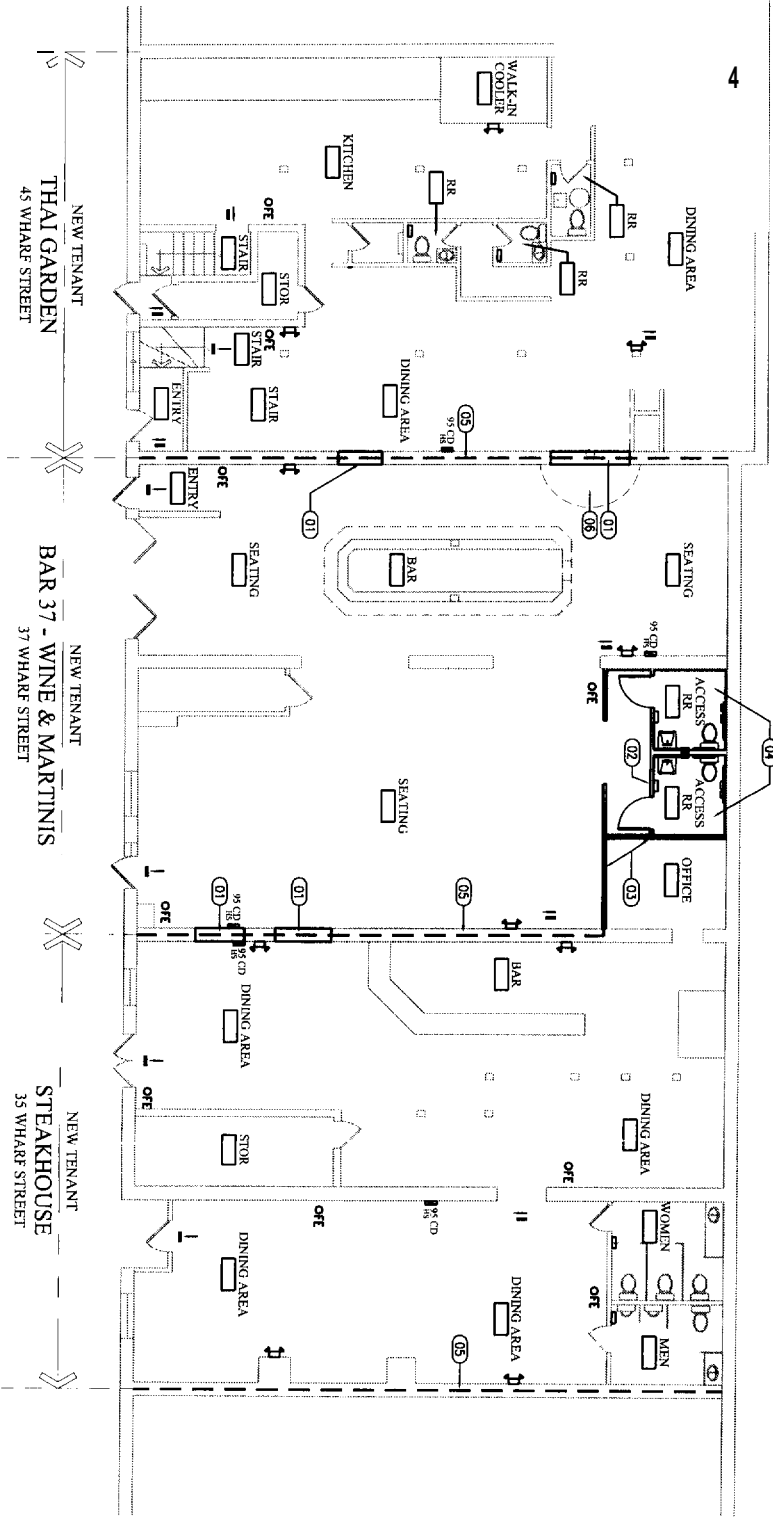

A1 PROPOSED REVISED FLOOR PLAN

1/8" = 1'-0"

EMERGENCY LIGHTING LEGEND

- Off Fire Emergency
 - Human Strobe
 - Strobe
 - Human Strobe
- NOTE: EXISTING SPRINKLER FIRE SUPPRESSION SYSTEM SHALL BE MODIFIED TO MATCH NEW

FLOOR PLAN LEGEND

- [01] INTEL EXISTING WALL w/ BRICK - MATCH EXISTING BRICK SIZE, CORNER & BRANDING - PROVIDE 2 HOUR FIRE RATING TO MATCH EXISTING FIRE RATING
- [02] WALL PARTITION - 5/8" TYPE 'X' GWB w/ EACH SIDE OF 1/2" W/1 ABOVE & BELOW FLOOR TO UNDERSIDE OF FLOOR DECK AREAS EXCEPT @ RATED WALL ASSEMBLIES
- [03] 2 HOUR FIRE RATED WALL ASSEMBLY AT NO. 4271 - 12' X 10'6" TYPE 'X' GWB w/ EACH SIDE OF 3/8" W/1 STUDS w/ 5/8" FIBERGLASS INSULATION TO UNDERSIDE OF FLOOR DECK ABOVE
- [04] ACCESSIBLE RESTROOM - ALL FIXTURES AND CLEARANCE PER ADA/CURBELINES
- [05] EXISTING 2 HOUR RATED BRICK FIRE ASSEMBLY
- [06] INTEL EXISTING STAIR OPENING - SMOOTH & FINISH AS REQUIRED FOR SMOOTH LEVEL APPLICATION OF SCHEDULED FLOORING

— 2 HOUR FIRE RATE ASSEMBLY - TENANT DEMISING WALL