

J1 EXISTING CONDITIONS PLAN & PROPOSED DEMOLITION PLAN

J16 LEGEND

N/S EXISTING CONDITIONS PLAN & PROPOSED DEMOLITION PLAN

- DEMOLITION PLAN LEGEND**
- [01] REMOVE STAIRS - PROVIDE SMOOTH LEVEL SURFACE FOR APPLICATION OF SCHEDULED FLOORING.
 - [02] REMOVE STAIR HANDRAILS & BALUSTRES.
 - [03] REMOVE WALL AS REQUIRED FOR NEW CONSTRUCTION.
 - [04] REMOVE MILL WORK - PROVIDE SMOOTH LEVEL SURFACE FOR APPLICATION OF SCHEDULED FLOORING.
 - [05] REMOVE DOOR, DOOR FRAME & ALL ASSOCIATED HARDWARE AS REQUIRED FOR NEW CONSTRUCTION.
 - [06] REMOVE EXISTING INTEL. & RESTORE EXISTING OPENING - PREPARE ALL AFFECTED SURFACE SMOOTH & LEVEL FOR APPLICATION OF SCHEDULED FINISHES.

EXISTING EMERGENCY LIGHTING LEGEND

- ☐ Fire Exit Sign
- ☐ Existing Emergency Light
- ☐ Existing Exit Sign

NOTE: EXISTING TENANT SPACES EQUIPPED W/ SPRINKLER FIRE SUPPRESSION

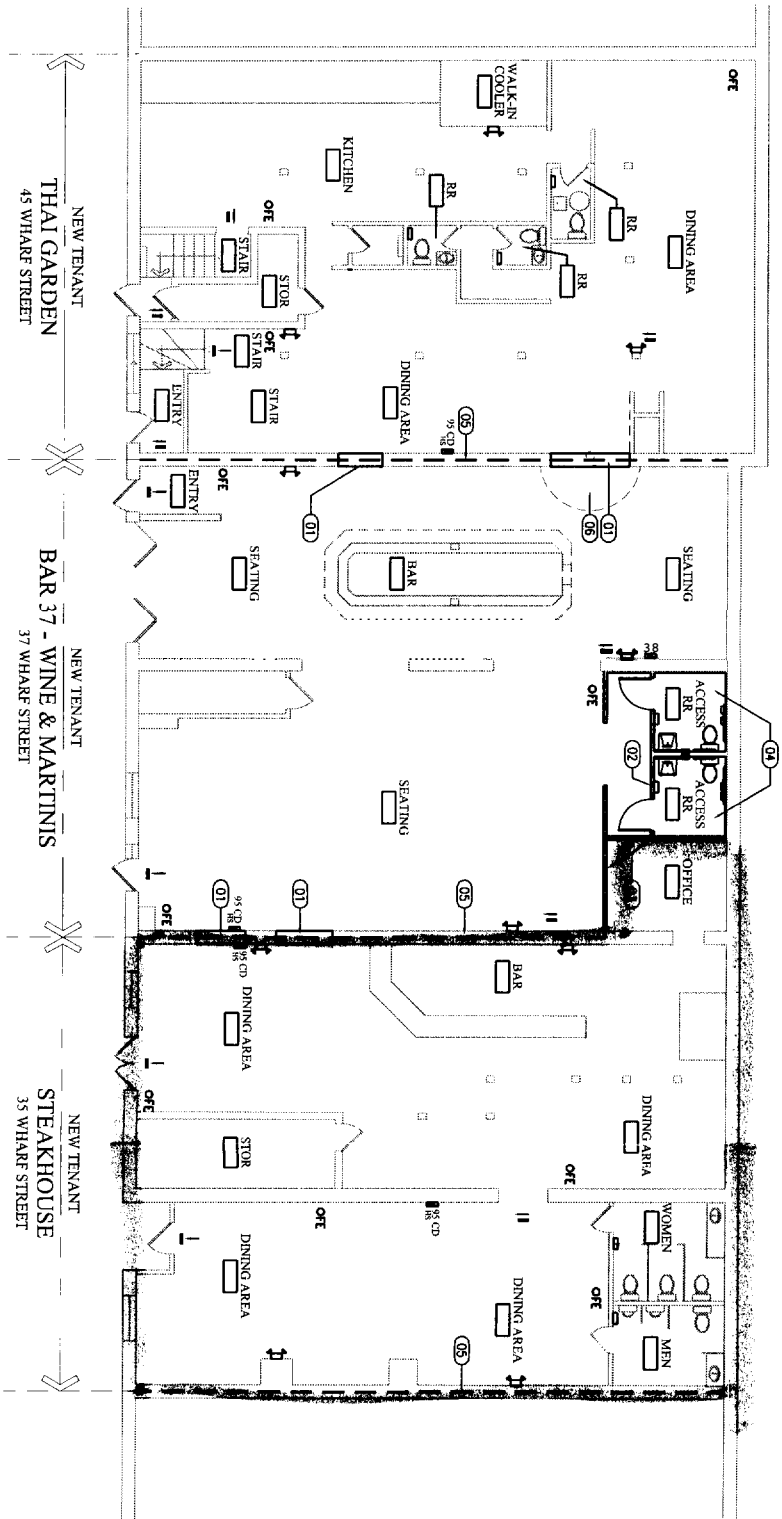

A1 PROPOSED REVISED FLOOR PLAN

A16 LEGEND

N/S PROPOSED REVISED FLOOR PLAN

FLOOR PLAN LEGEND

- [01] INTEL. EXISTING WALL w/ BRICK - MATCH EXISTING BRICK SIZE, COLOR & FINISH. PROVIDE 2 HOUR FIRE RATING TO MATCH EXISTING FIRE RATING.
- [02] WALL PARTITION - 5/8" TYPE X GIBB w/ EACH SIDE OF 1.5/8" MIN. STUDS @ 16" OC FROM TOP FLOOR TO UNDERSIDE OF FLOOR DECK ABOVE - PROVIDE MOSTLY RESISTANT GIBB IN ALL WET AREAS EXCEPT @ BATED WALL ASSEMBLIES.
- [03] 2 HOUR FIRE RATED WALL ASSEMBLY (UL NO. 451) - 2 LAYERS 5/8" TYPE X GIBB w/ EACH SIDE OF 1.5/8" MIN. STUDS @ 16" OC FROM TOP OF FLOOR DECK TO UNDERSIDE OF FLOOR DECK ABOVE.
- [04] ACCESSIBLE RESTROOM - ALL FIXTURES AND CLEARANCE PER ADA/2010/ENHANCED.
- [05] EXISTING 2 HOUR RATED BRICK FIRE ASSEMBLY.
- [06] INTEL. EXISTING STAIR OPENING - SUPPORT & FINISH ASSEMBLED FOR SAME LEVEL APPLICATION OF SCHEDULED FINISHES.

--- 2 HOUR FIRE RATE ASSEMBLY - TENANT DEMISING WALL

EMERGENCY LIGHTING LEGEND

- ☐ Fire Exit Sign
- ☐ Emergency Light
- ☐ Exit Sign
- ☐ HOBN STROBE
- ☐ STROBE

NOTE: EXISTING SPRINKLER FIRE SUPPRESSION SYSTEM SHALL BE MODIFIED TO MATCH NEW

45-37-35 WHARF STREET
Proposed Renovations
Portland, Maine

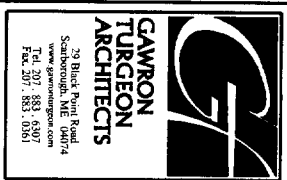

REVISIONS

#	DATE	DESCRIPTION

DATE:	10.25.05
PROJECT #:	100305
DESIGN BY:	DMR
CHECKED BY:	DMR
DRAWING SCALE:	1/8" = 1'-0"
SHEET TITLE:	PLANS

A100

© 2005 GAMMON TURGEON ARCHITECTS
ALL RIGHTS RESERVED
THIS DOCUMENT IS UNLAWFULLY REPRODUCED WITHOUT THE WRITTEN PERMISSION OF GAMMON TURGEON ARCHITECTS