

SKETCH - NOT TO SCALE
 PLAN, 1ST FLOOR, 37-39 WHARF STREET, PORTLAND, ME
 ALL WORK TO BE PER MUBEC

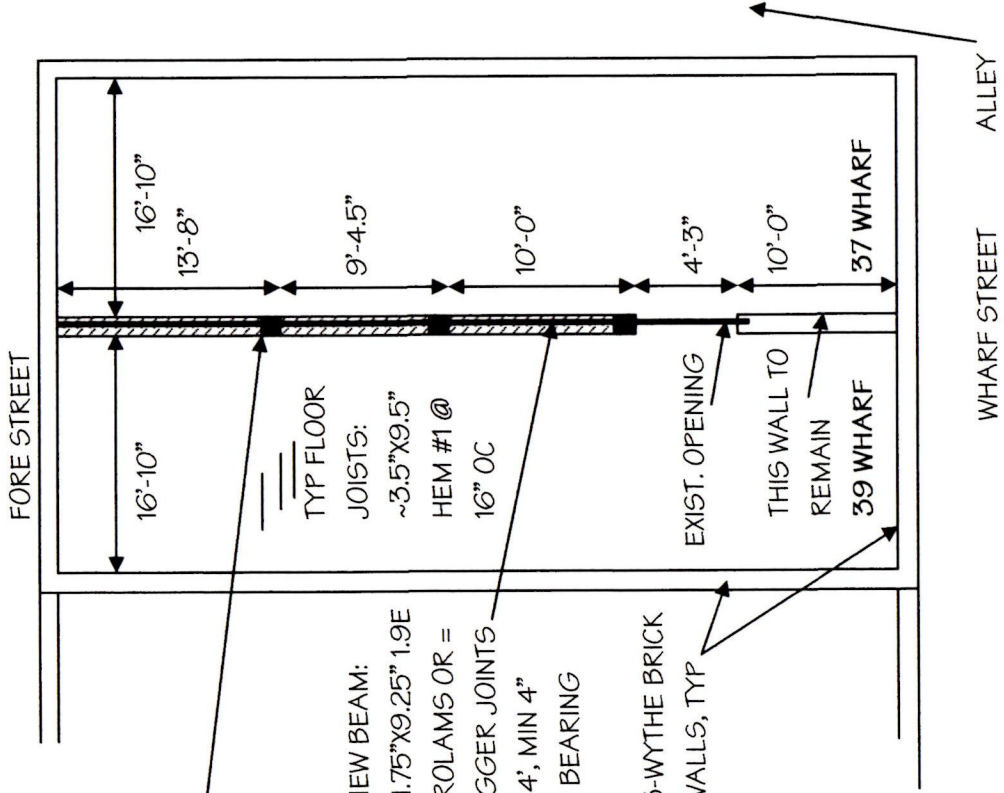

REMOVE 3-WYTHE BRICK
 MASONRY WALL & REPLACE
 W/ 3 NEW COLUMNS

NEW COLUMNS TO BE
 A500 GRADE 46 HSS 6X4X1/2
 OR TWO HSS 6X3X5/16 OR
 TWO HEM-FIR #2 12X12S

NEW BEAM:
 3 - 1.75"X9.25" 1.9E
 MICROLAMS OR =
 STAGGER JOINTS
 MIN 4', MIN 4"
 END BEARING

HSS COLS TO HAVE 12"X12"X1/2"
 TOP AND BOTTOM PLATES, A36,
 TACK WELDED. GROUT PLATE
 TO ASHLAR WALL BELOW.

3-WYTHE BRICK
 WALLS, TYP

NEW BEAM TO HAVE 4" MIN
 BEARING ON MASONRY AT ENDS.

LOAD ON BEAM:
 24 PSF FACTORED SNOW LOAD
 15 PSF DEAD LOAD
 40 PSF LIVE LOAD } EACH, 4 FLOORS
 15 PSF DEAD LOAD }

WALL IN BASEMENT BELOW REMOVED
 WALL = ASHLAR, GROUTED, GOOD CONDITION



HELEN WATTS ENGINEERING PLLC
 455 Litchfield Road, Bowdoin, ME 04287
 207-522-9366
 04/02/2014
 Helen C. Watts, P.E.

STRUCTURAL MODIFICATIONS:
 37-39 WHARF ST., PORTLAND, ME
 TANNER HERGET, BONFIRE LLC
 HWE P/N 14-007
 SHEET 1 OF 2