

© 2017 RYAN SENATORE ARCHITECTURE

**LIO RESTAURANT AND RETAIL**  
 6 CITY CENTER  
 PORTLAND, MAINE



RYAN SENATORE ARCHITECTURE  
 565 CONGRESS STREET  
 PORTLAND, MAINE 04101  
 207-650-6414  
 senatorearchitecture.com

CONSULTANTS:

REVISIONS:  
 ▲ REVISION #1 3/1/17

DATE: 2 MARCH 2017

PROJECT No. 1646

DRAWN BY: RRT, RJS

CHECKED BY: RJS

SCALE: AS NOTED

SHEET TITLE:  
**SECOND FLOOR REFLECTED CEILING PLAN**

**A1-3**

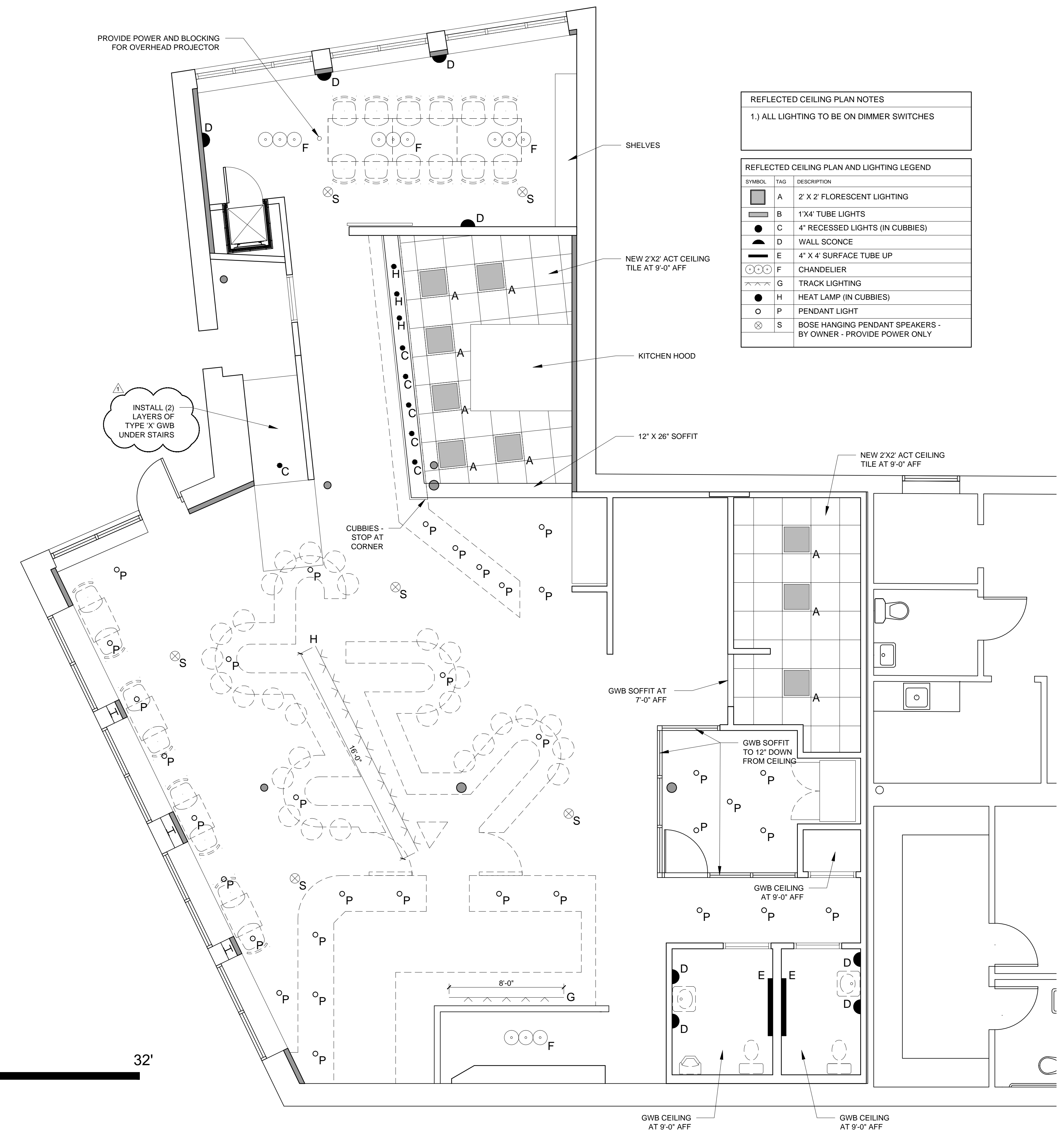

REFLECTED CEILING PLAN NOTES  
 1.) ALL LIGHTING TO BE ON DIMMER SWITCHES

SYMBOL	TAG	DESCRIPTION
■	A	2' X 2' FLORESCENT LIGHTING
—	B	1'X4' TUBE LIGHTS
●	C	4" RECESSED LIGHTS (IN CUBBIES)
◐	D	WALL SCONCE
—	E	4' X 4' SURFACE TUBE UP
○	F	CHANDELIER
—	G	TRACK LIGHTING
●	H	HEAT LAMP (IN CUBBIES)
○	P	PENDANT LIGHT
⊗	S	BOSE HANGING PENDANT SPEAKERS - BY OWNER - PROVIDE POWER ONLY

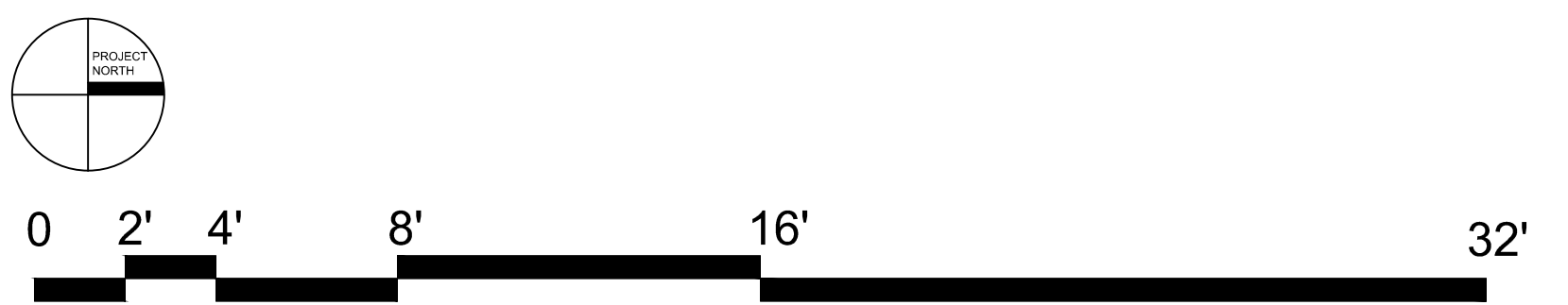

1 SECOND FLOOR REFLECTED CEILING PLAN  
 1/4" = 1'-0"