

COPYRIGHT (C) BY CUBELLIS ASSOCIATES INC. ALL RIGHTS RESERVED.
 NO PART OF THIS DOCUMENT MAY BE REPRODUCED, STORED IN A RETRIEVAL SYSTEM, OR TRANSMITTED IN ANY FORM OR BY ANY MEANS, ELECTRONIC, MECHANICAL, PHOTOCOPYING, RECORDING OR OTHERWISE, WITHOUT THE EXPRESS WRITTEN CONSENT OF CUBELLIS ASSOCIATES, INC. ANY MODIFICATIONS MADE TO THIS DOCUMENT WITHOUT THE WRITTEN PERMISSION OF CUBELLIS ASSOCIATES, INC. SHALL RENDER IT INVALID AND UNUSABLE.

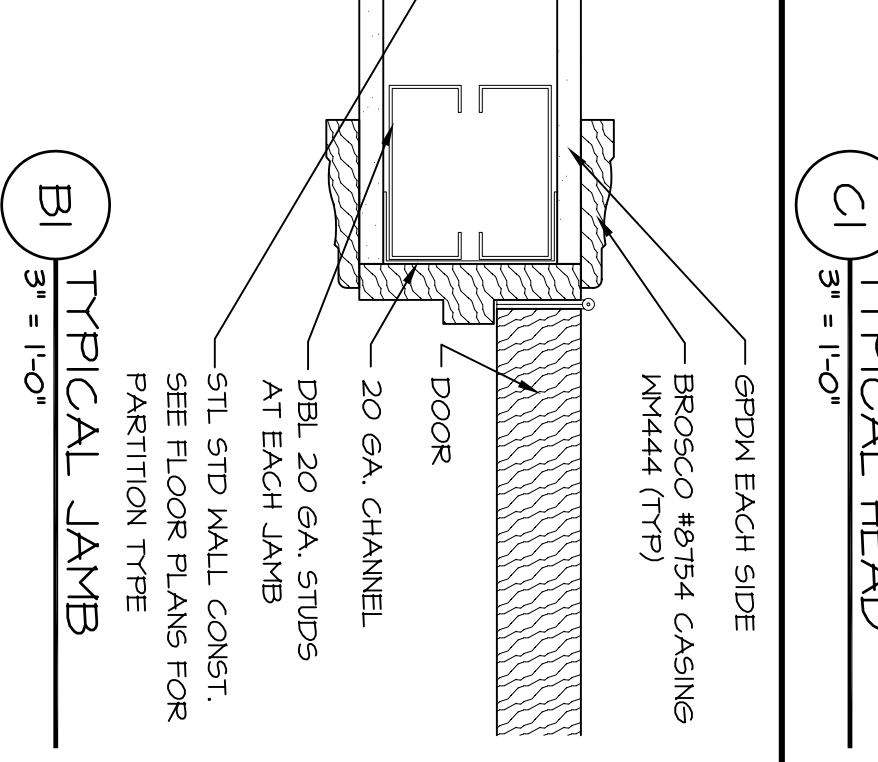
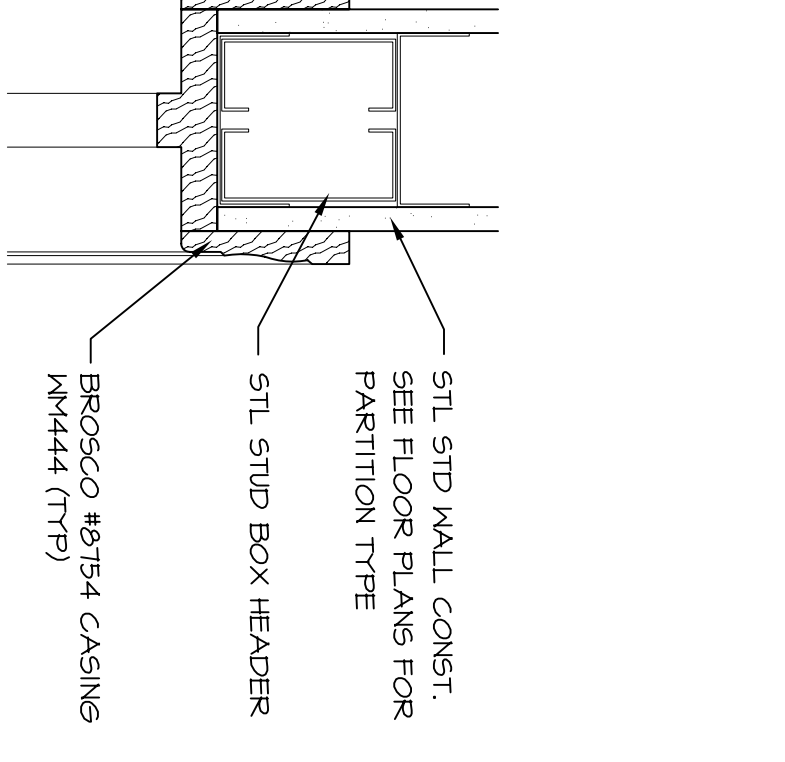
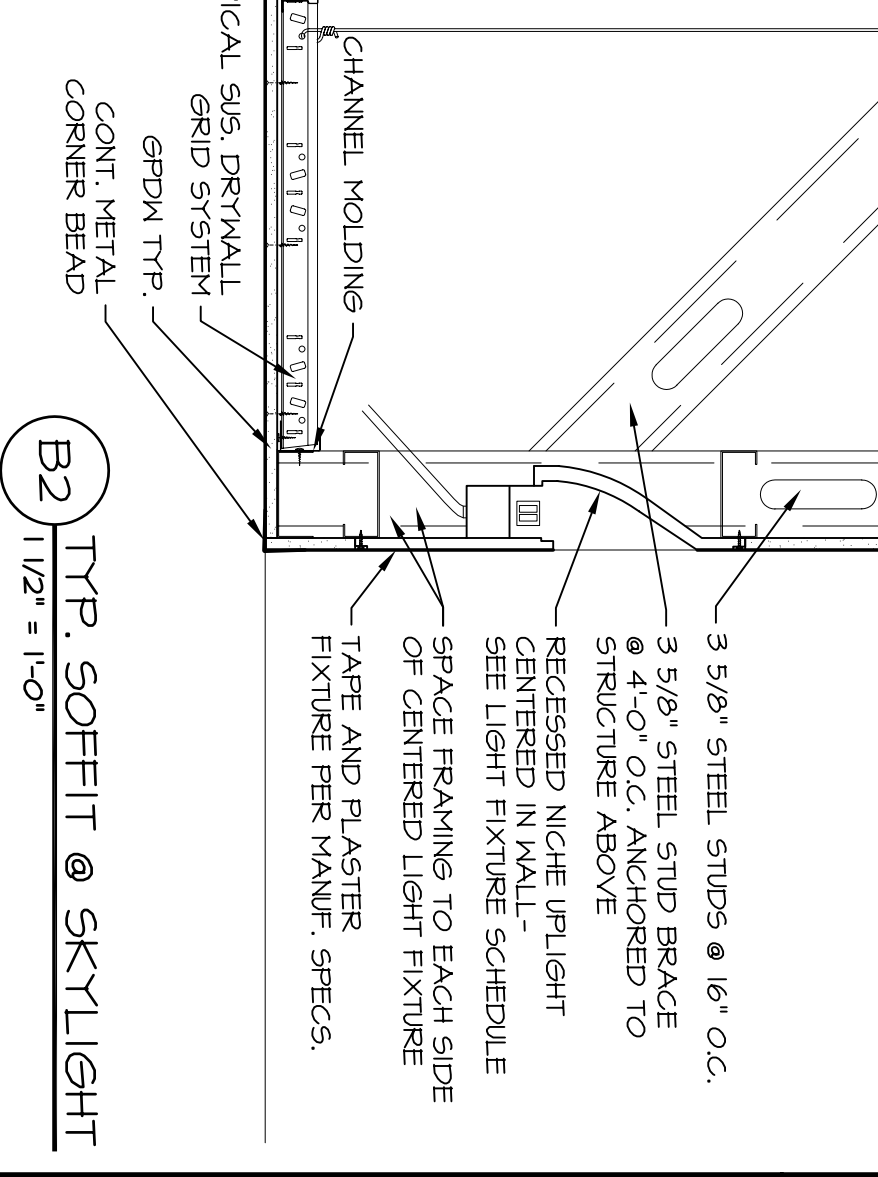
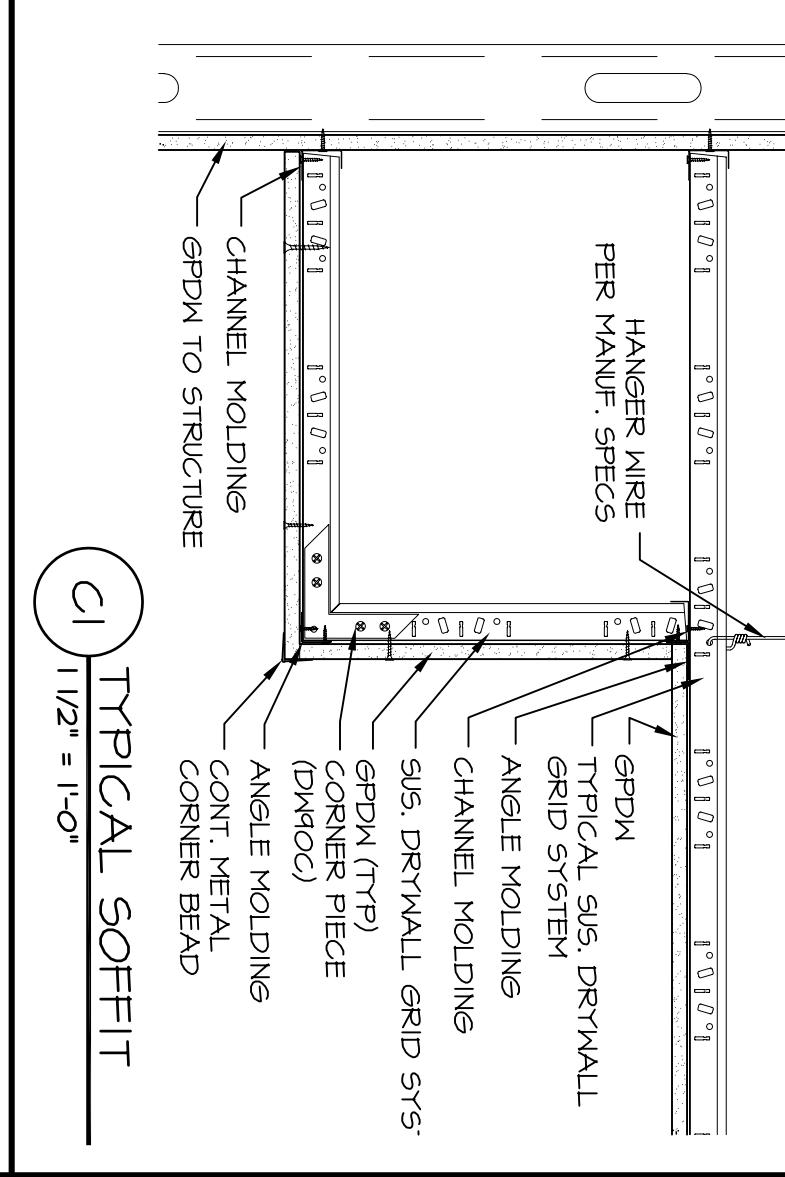
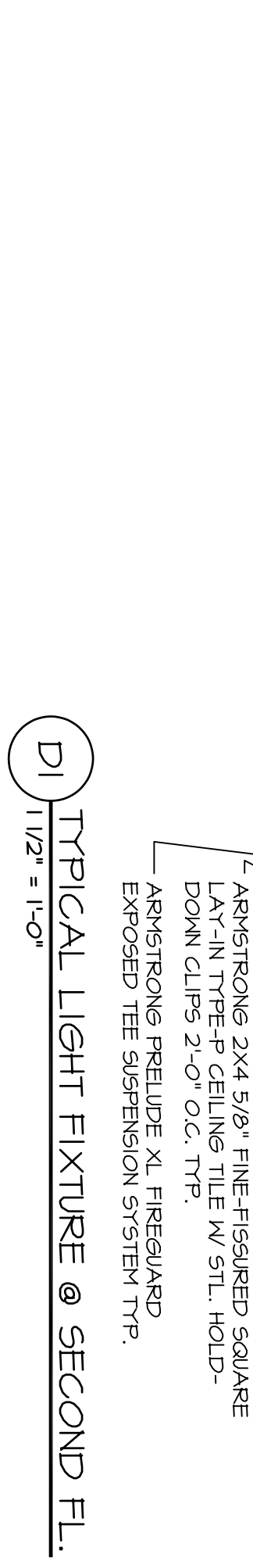
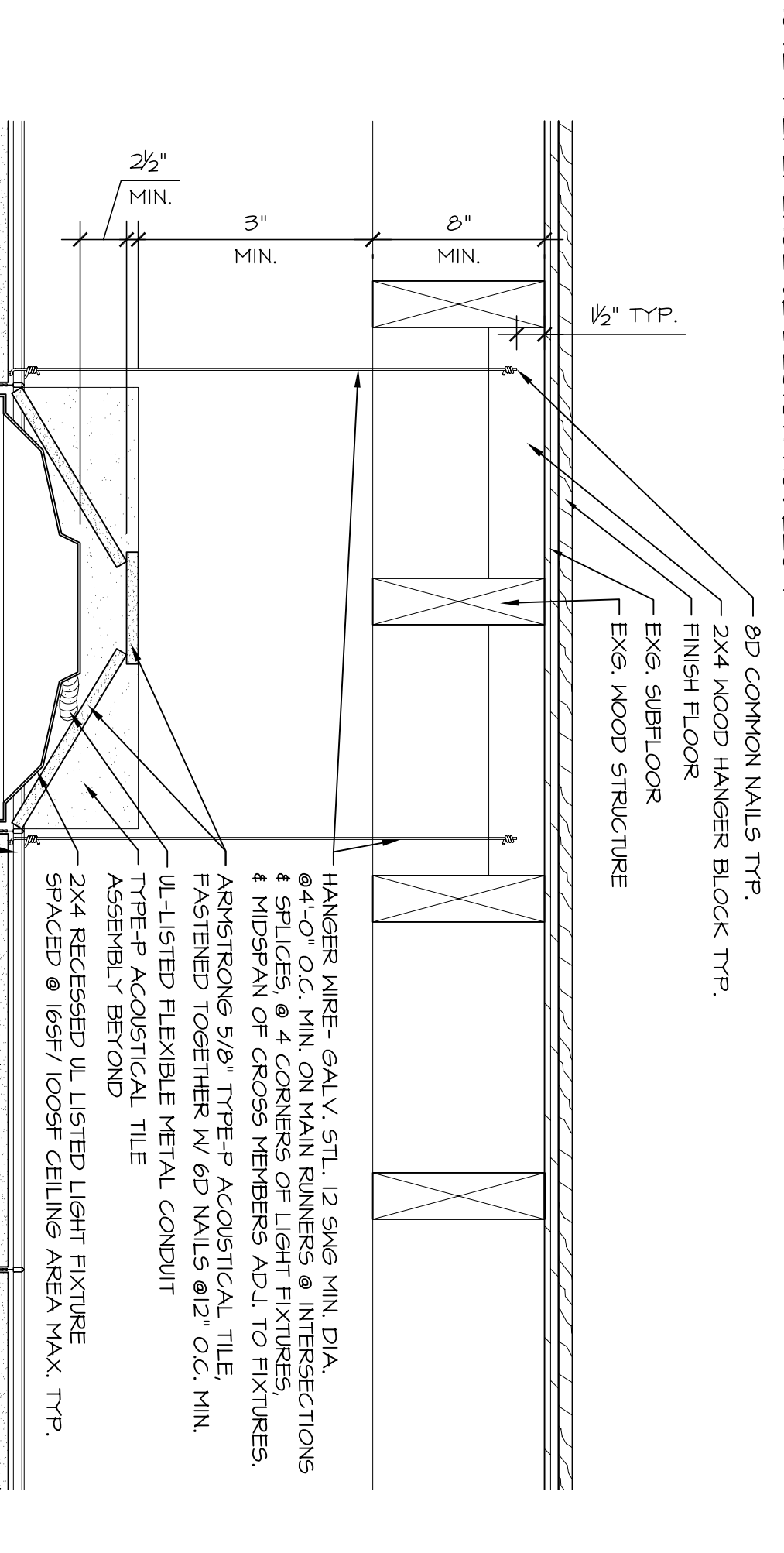
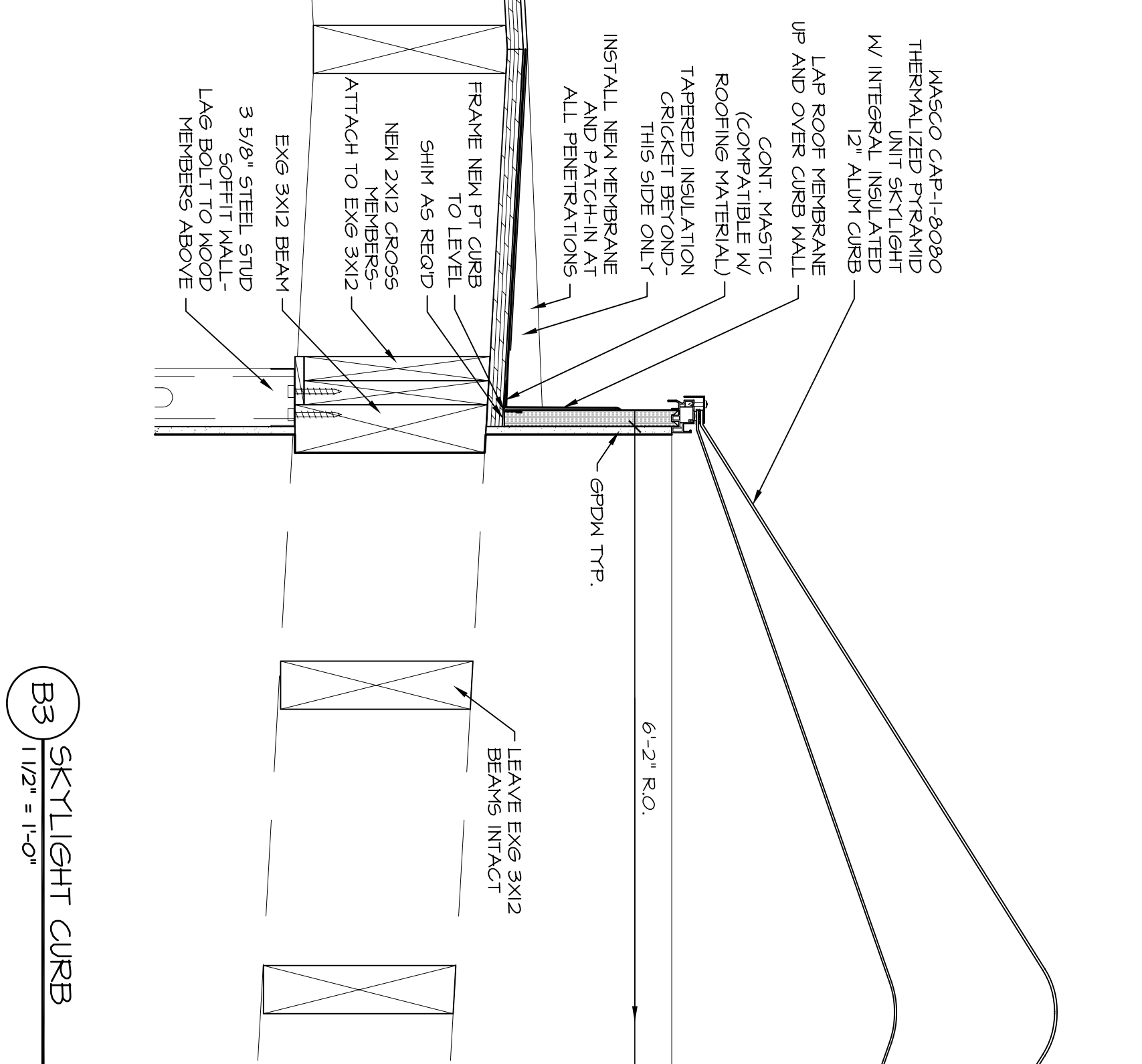
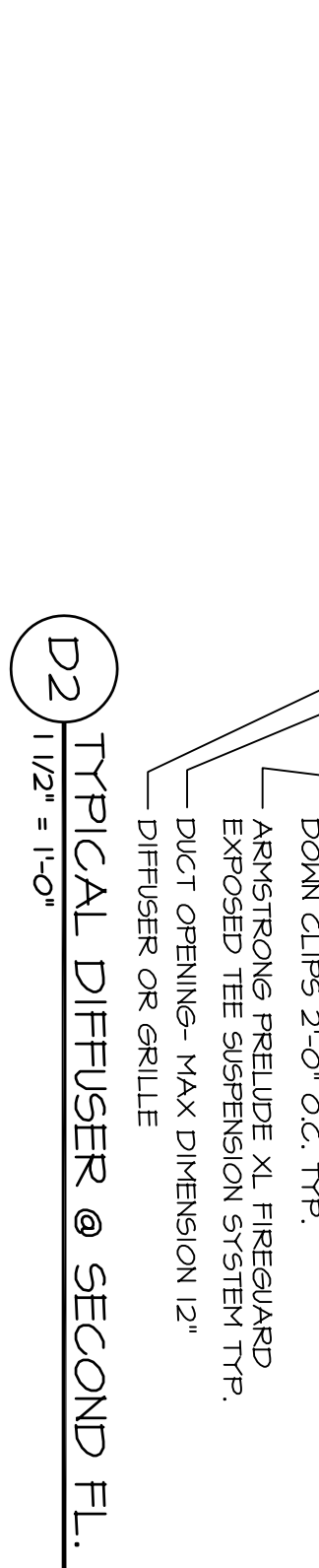
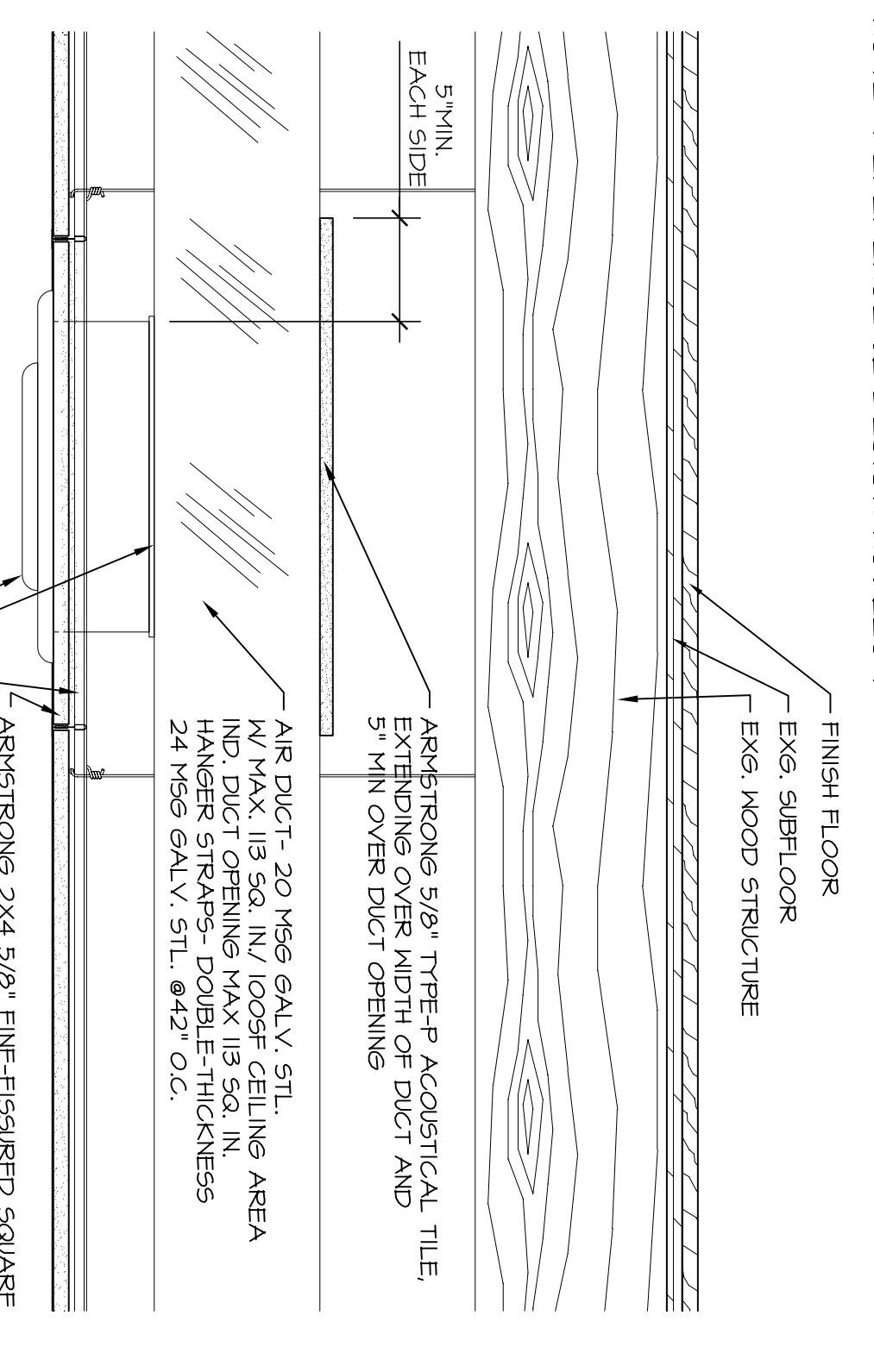
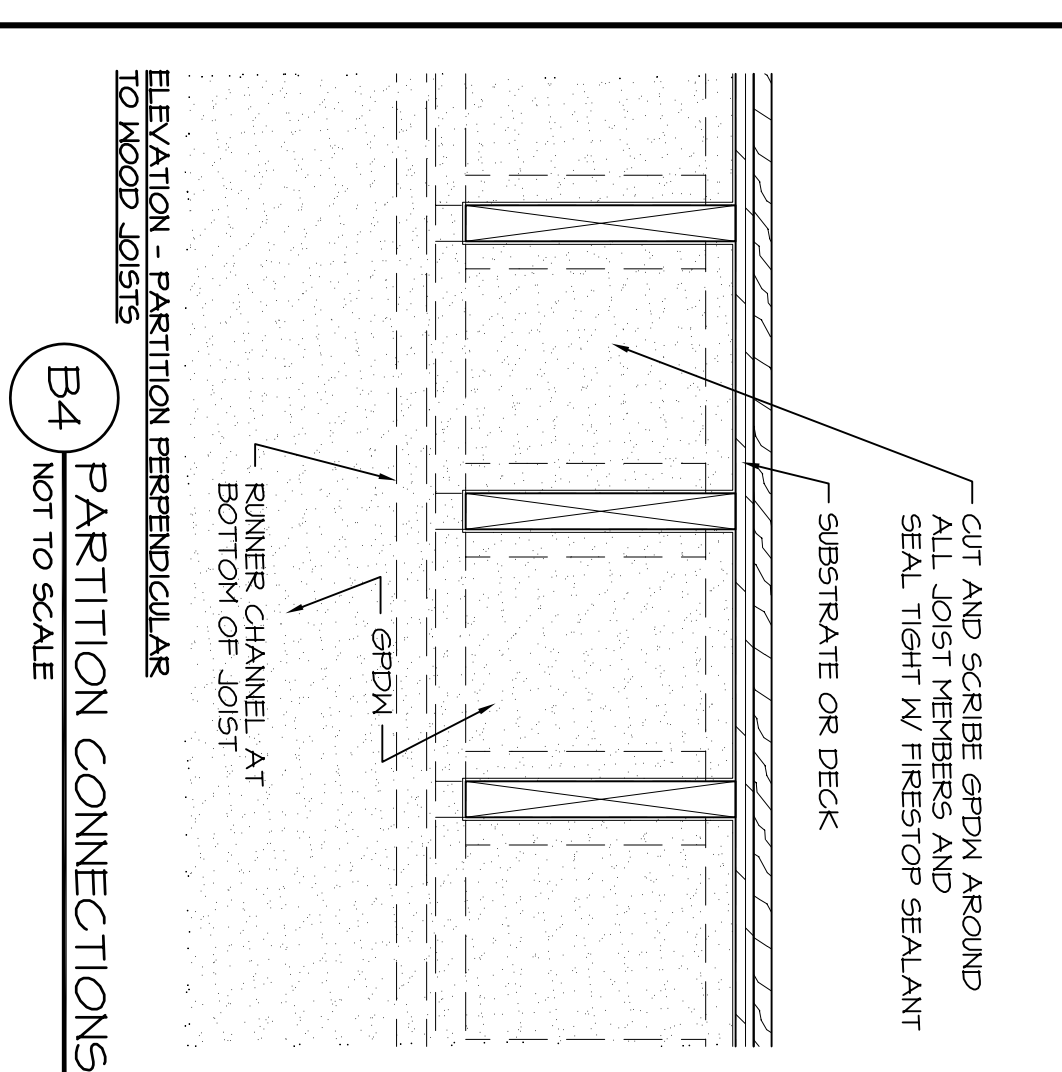
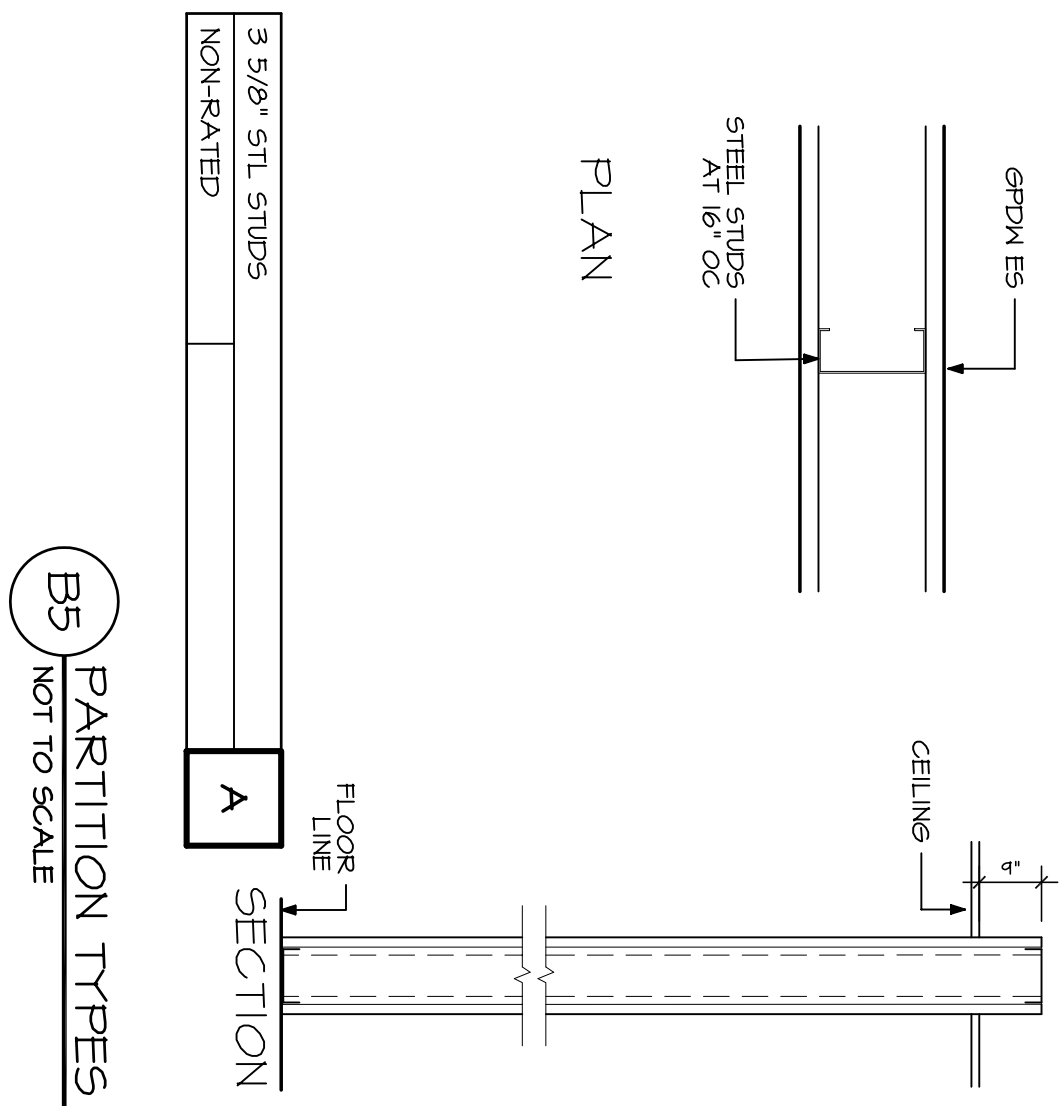
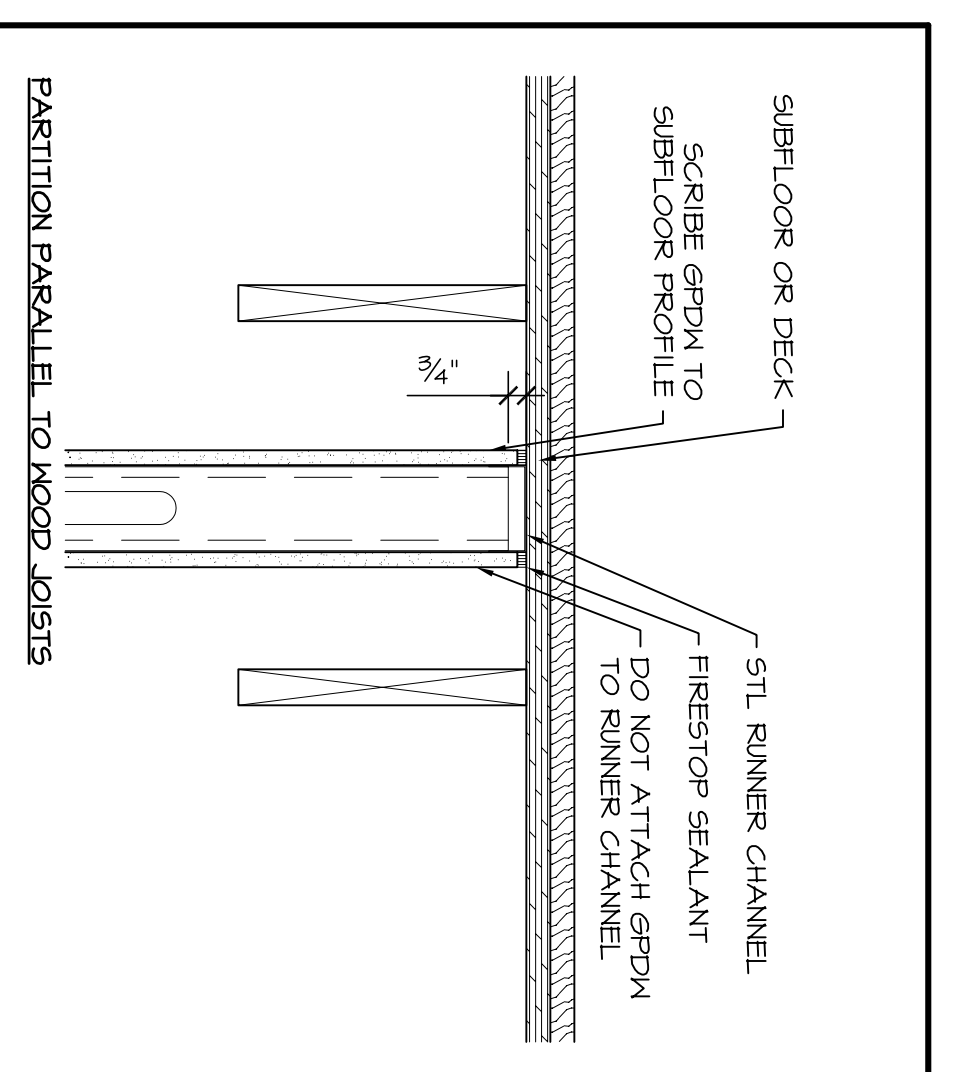
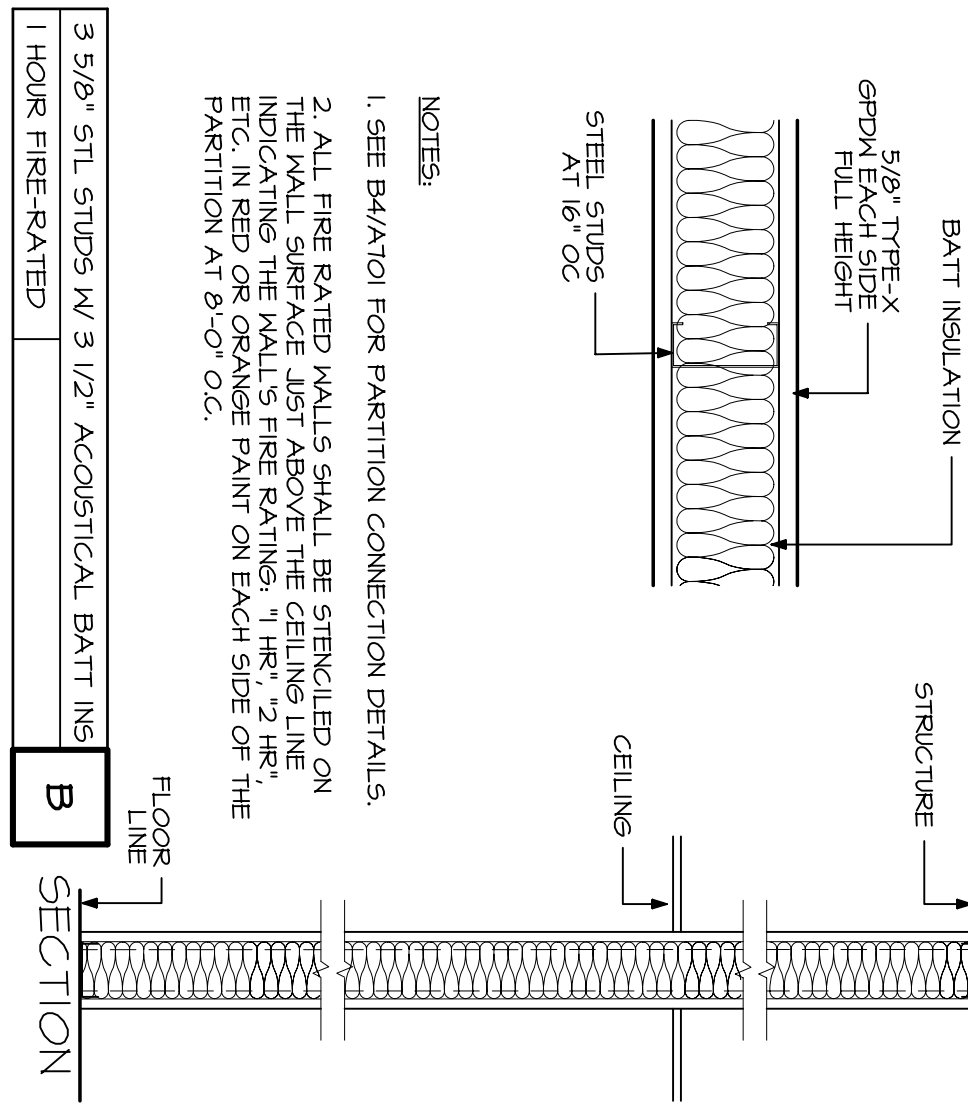
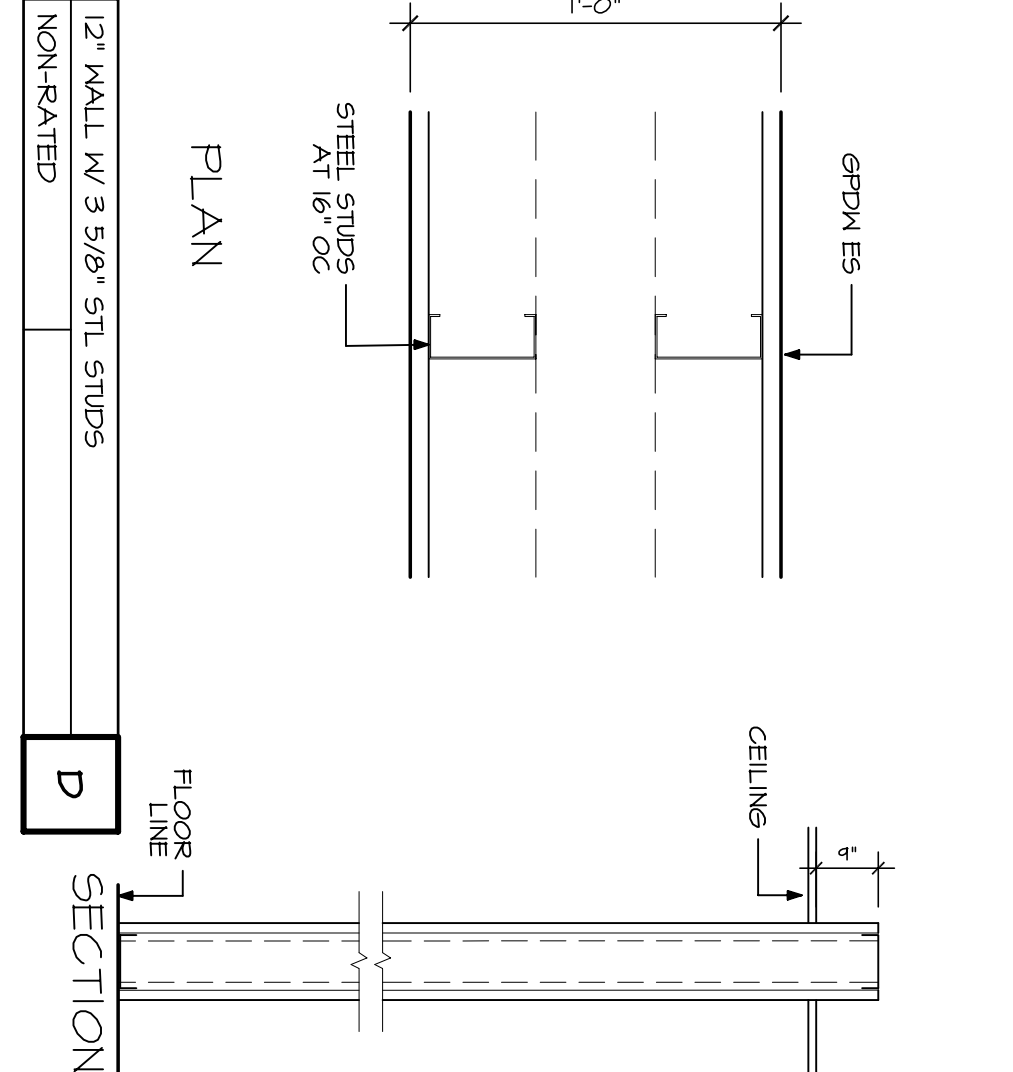
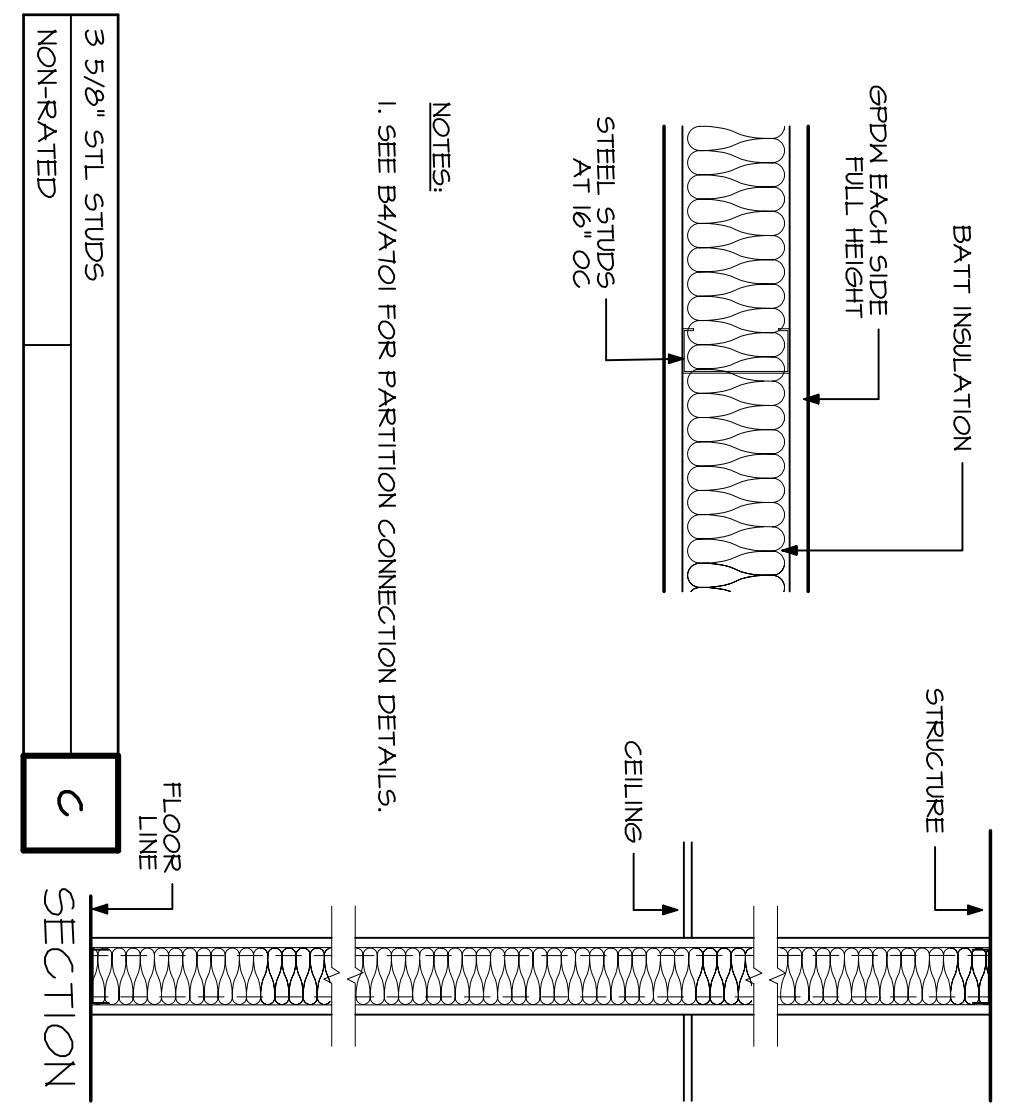

NO.	MATERIAL	MANUF.	MFR. NUMBER/STYLE	COLOR	REMARKS/LOCATION
WB-1	WOOD BASE	BROSOCO	B400 SPEED BASE	PRIMED	THROUGHOUT LIMIT OF WORK U.O.N.
CM-1	WD MOLDING	BROSOCO	8027 GROWN	PRIMED	SEE A1 & B1/A401.
WB-1	HARDWOOD	T.B.D.	T.B.D.	T.B.D.	THROUGHOUT LIMIT OF WORK U.O.N.
CP2	CARPET	T.B.D.	T.B.D.	T.B.D.	BEDROOMS 413, 414.
CT-1	CERAMIC TILE	T.B.D.	T.B.D.	T.B.D.	BATHROOMS 307, 405, 407, 412.

NO.	FINISHES	W	E	S	W	FIELD ACC.	WANS	SCOTT	GROWN	NOTES
301	PAINT	WB-1	WB-1	WB-1	WB-1	WB-1	WB-1	WB-1	WB-1	---
302	PAINT	WB-1	WB-1	WB-1	WB-1	WB-1	WB-1	WB-1	WB-1	---
303	PAINT	WB-1	WB-1	WB-1	WB-1	WB-1	WB-1	WB-1	WB-1	---
304	PAINT	WB-1	WB-1	WB-1	WB-1	WB-1	WB-1	WB-1	WB-1	---
305	PAINT	WB-1	WB-1	WB-1	WB-1	WB-1	WB-1	WB-1	WB-1	---
306	PAINT	WB-1	WB-1	WB-1	WB-1	WB-1	WB-1	WB-1	WB-1	---
307	PAINT	WB-1	WB-1	WB-1	WB-1	WB-1	WB-1	WB-1	WB-1	---
308	PAINT	WB-1	WB-1	WB-1	WB-1	WB-1	WB-1	WB-1	WB-1	---
309	PAINT	WB-1	WB-1	WB-1	WB-1	WB-1	WB-1	WB-1	WB-1	---
310	PAINT	WB-1	WB-1	WB-1	WB-1	WB-1	WB-1	WB-1	WB-1	---
311	PAINT	WB-1	WB-1	WB-1	WB-1	WB-1	WB-1	WB-1	WB-1	---
312	PAINT	WB-1	WB-1	WB-1	WB-1	WB-1	WB-1	WB-1	WB-1	---
313	PAINT	WB-1	WB-1	WB-1	WB-1	WB-1	WB-1	WB-1	WB-1	---
314	PAINT	WB-1	WB-1	WB-1	WB-1	WB-1	WB-1	WB-1	WB-1	---
315	PAINT	WB-1	WB-1	WB-1	WB-1	WB-1	WB-1	WB-1	WB-1	---
401	PAINT	WB-1	WB-1	WB-1	WB-1	WB-1	WB-1	WB-1	WB-1	---
402	PAINT	WB-1	WB-1	WB-1	WB-1	WB-1	WB-1	WB-1	WB-1	---
403	PAINT	WB-1	WB-1	WB-1	WB-1	WB-1	WB-1	WB-1	WB-1	---
404	PAINT	WB-1	WB-1	WB-1	WB-1	WB-1	WB-1	WB-1	WB-1	---
405	PAINT	WB-1	WB-1	WB-1	WB-1	WB-1	WB-1	WB-1	WB-1	---
406	PAINT	WB-1	WB-1	WB-1	WB-1	WB-1	WB-1	WB-1	WB-1	---
407	PAINT	WB-1	WB-1	WB-1	WB-1	WB-1	WB-1	WB-1	WB-1	---
408	PAINT	WB-1	WB-1	WB-1	WB-1	WB-1	WB-1	WB-1	WB-1	---
409	PAINT	WB-1	WB-1	WB-1	WB-1	WB-1	WB-1	WB-1	WB-1	---
410	PAINT	WB-1	WB-1	WB-1	WB-1	WB-1	WB-1	WB-1	WB-1	---
411	PAINT	WB-1	WB-1	WB-1	WB-1	WB-1	WB-1	WB-1	WB-1	---
412	PAINT	WB-1	WB-1	WB-1	WB-1	WB-1	WB-1	WB-1	WB-1	---
413	PAINT	WB-1	WB-1	WB-1	WB-1	WB-1	WB-1	WB-1	WB-1	---
414	PAINT	WB-1	WB-1	WB-1	WB-1	WB-1	WB-1	WB-1	WB-1	---

NO.	SIZE	HT	THK	MATL	TYPE	GLASS	FRAME	FIRE RATING	HARDW.	DETAILS	NOTES
303	2'-8"	8'-1 1/2"	1/2"	FE	---	---	PRE-HING	---	---	---	EXISTING TO REMAIN
305	2'-8"	8'-1 1/2"	1/2"	FE	---	---	PRE-HING	---	---	---	EXISTING TO REMAIN
306	2'-8"	8'-1 1/2"	1/2"	FE	---	---	PRE-HING	---	---	---	EXISTING TO REMAIN
307	2'-8"	8'-1 1/2"	1/2"	FE	---	---	PRE-HING	---	---	---	EXISTING TO REMAIN
308	2'-8"	8'-1 1/2"	1/2"	FE	---	---	PRE-HING	---	---	---	EXISTING TO REMAIN
309	2'-8"	8'-1 1/2"	1/2"	FE	---	---	PRE-HING	---	---	---	EXISTING TO REMAIN
310	2'-8"	8'-1 1/2"	1/2"	FE	---	---	PRE-HING	---	---	---	EXISTING TO REMAIN
311	2'-8"	8'-1 1/2"	1/2"	FE	---	---	PRE-HING	---	---	---	EXISTING TO REMAIN
312	2'-8"	8'-1 1/2"	1/2"	FE	---	---	PRE-HING	---	---	---	EXISTING TO REMAIN
313	2'-8"	8'-1 1/2"	1/2"	FE	---	---	PRE-HING	---	---	---	EXISTING TO REMAIN
314	2'-8"	8'-1 1/2"	1/2"	FE	---	---	PRE-HING	---	---	---	EXISTING TO REMAIN
315	2'-8"	8'-1 1/2"	1/2"	FE	---	---	PRE-HING	---	---	---	EXISTING TO REMAIN
401	2'-8"	8'-1 1/2"	1/2"	FE	---	---	PRE-HING	---	---	---	EXISTING TO REMAIN
402	2'-8"	8'-1 1/2"	1/2"	FE	---	---	PRE-HING	---	---	---	EXISTING TO REMAIN
403	2'-8"	8'-1 1/2"	1/2"	FE	---	---	PRE-HING	---	---	---	EXISTING TO REMAIN
404	2'-8"	8'-1 1/2"	1/2"	FE	---	---	PRE-HING	---	---	---	EXISTING TO REMAIN
405	2'-8"	8'-1 1/2"	1/2"	FE	---	---	PRE-HING	---	---	---	EXISTING TO REMAIN
406	2'-8"	8'-1 1/2"	1/2"	FE	---	---	PRE-HING	---	---	---	EXISTING TO REMAIN
407	2'-8"	8'-1 1/2"	1/2"	FE	---	---	PRE-HING	---	---	---	EXISTING TO REMAIN
408	2'-8"	8'-1 1/2"	1/2"	FE	---	---	PRE-HING	---	---	---	EXISTING TO REMAIN
409	2'-8"	8'-1 1/2"	1/2"	FE	---	---	PRE-HING	---	---	---	EXISTING TO REMAIN
410	2'-8"	8'-1 1/2"	1/2"	FE	---	---	PRE-HING	---	---	---	EXISTING TO REMAIN
411	2'-8"	8'-1 1/2"	1/2"	FE	---	---	PRE-HING	---	---	---	EXISTING TO REMAIN
412	2'-8"	8'-1 1/2"	1/2"	FE	---	---	PRE-HING	---	---	---	EXISTING TO REMAIN
413	2'-8"	8'-1 1/2"	1/2"	FE	---	---	PRE-HING	---	---	---	EXISTING TO REMAIN
414	2'-8"	8'-1 1/2"	1/2"	FE	---	---	PRE-HING	---	---	---	EXISTING TO REMAIN

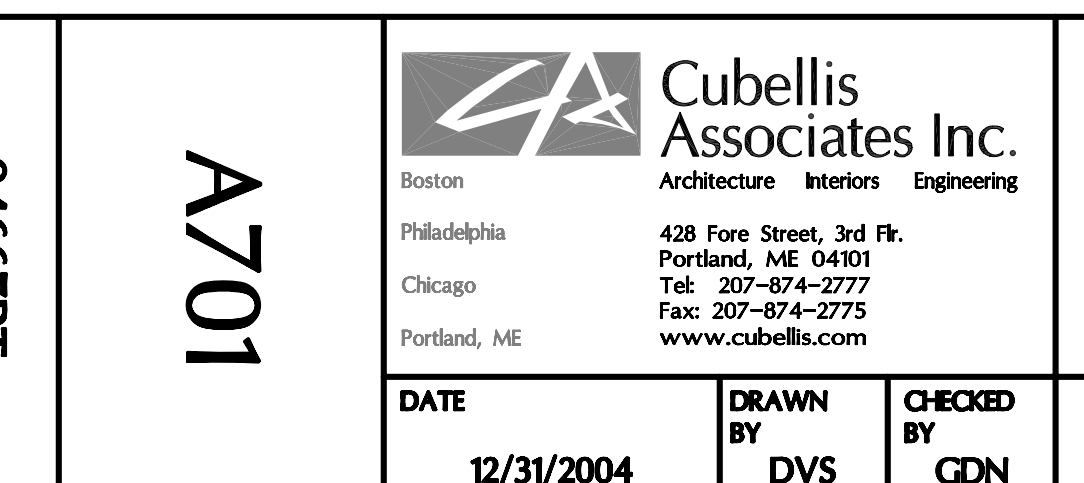

<p>Cubellis Associates Inc. Architecture Interiors Engineering Boston Philadelphia Chicago Portland, ME 428 Fore Street, 3rd Fl. Portland, ME 04101 Tel: 207-874-2777 Fax: 207-874-2775 www.cubellis.com</p>		<p>DATE 12/31/2004</p> <p>DRAWN BY DVS</p> <p>CHECKED BY GDN</p>	<p>SCALE AS NOTED</p>	<p>OWNER JERRY ADE</p>	<p>TITLE SCHEDULES & DETAILS</p>	<p>PROJECT NORTH</p>	<p>NO. 1</p> <p>DATE 12/30/04</p> <p>REVISIONS ISSUED FOR PERMITTING</p>
---	--	---	------------------------------	-------------------------------	---	-----------------------------	---