

### SHEET NOTES

- 1 SANITARY LINE IS TO BE LOCATED AND RUN THROUGH CEILING SPACE. CONNECT TO EXISTING SANITARY PIPING AND FIELD VERIFY EXACT LOCATION.
- 2 PROVIDE 1/2" VALVED TAP OFF OF COLD WATER TO SINK AND EXTEND WATER LINE UP THROUGH COUNTER TO COFFEE MAKER. EXTEND DRAIN LINE FROM COFFEE MAKER TO NEW 1" HUB OUTLET UNDER COUNTER. REFER TO COFFEE MAKER AND SINK PIPING DETAIL. COORDINATE EXACT LOCATION IN FIELD WITH EQUIPMENT INSTALLER. PROVIDE BACKFLOW PREVENTER AS REQUIRED BY CODE.
- 3 CONNECT TO NEAREST EXISTING VENT MAIN. FIELD VERIFY EXACT LOCATION.
- 4 SHELF MOUNT ELECTRIC WATER HEATER ABOVE CEILING. WITH DRAIN PAN. EXTEND DRAIN LINE TO NEAREST HUB OUTLET UNDER COUNTER.
- 5 PLUMBING CONTRACTOR SHALL PROVIDE PLUMBING AND FINAL CONNECTION TO DISHWASHER. PROVIDE 1/2" VALVED TAP OFF OF HOT WATER TO SINK AND EXTEND PIPING TO DISHWASHER. EXTEND DRAIN LINE FROM DISHWASHER AND CONNECT TO SINK DRAIN CONNECTION. COORDINATE CONNECTION WITH FOOD SERVICE EQUIPMENT INSTALLER.
- 6 PLUMBING CONTRACTOR SHALL PROVIDE PLUMBING AND FINAL CONNECTION TO WATER DISPENSER. PROVIDE 1/2" VALVED TAP OFF OF COLD WATER TO SINK AND EXTEND LINE TO WATER DISPENSER. COORDINATE CONNECTION WITH FOOD SERVICE EQUIPMENT INSTALLER.

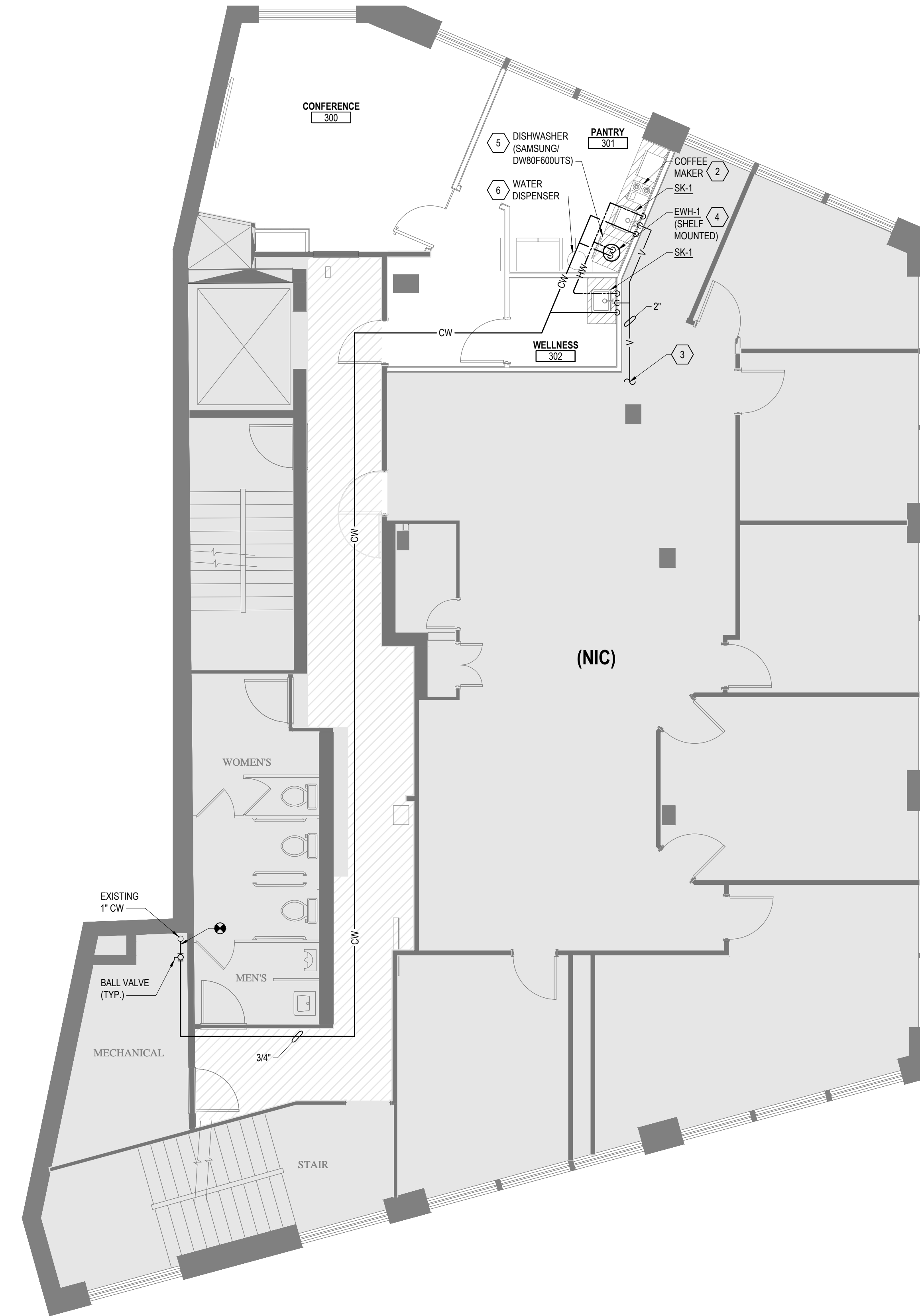

1 SECOND FLOOR PLUMBING PLAN  
SCALE 3/16"=1'-0"



2 THIRD FLOOR PLUMBING PLAN  
SCALE 3/16"=1'-0"

### GENERAL NOTES

1. NO PLUMBING PIPING SHALL RUN THROUGH OR IN ELECTRICAL ROOM.
2. FIELD VERIFY EXACT LOCATION OF FLOOR PENETRATIONS WITH EXISTING STRUCTURAL BEAMS, AND ADJUST LOCATIONS AS REQUIRED.
3. HVAC AND PLUMBING LAYOUT IS BASED ON LIMITED DRAWINGS AND FIELD INVESTIGATION. MECHANICAL AND PLUMBING CONTRACTORS SHALL VISIT THE SITE PRIOR TO PLACING BID AND FIELD INVESTIGATE EXISTING CONDITIONS. NOTIFY GENERAL CONTRACTOR, OWNER, AND ARCHITECT/ENGINEER OF ANY DISCREPANCIES THAT WILL AFFECT THE BID. ADDITIONAL WORK REQUIRED DUE TO NOT DOING A PRE-BID SITE SURVEY SHALL BE DONE AT NO ADDITIONAL COST TO OWNER/TENANT.
4. MECHANICAL PLUMBING CONTRACTOR SHALL BE RESPONSIBLE FOR REMOVAL AND REINSTALLATION OF EXISTING CEILING AS REQUIRED TO PERFORM WORK. REPLACED DAMAGED TILES AND GRID WITH SIMILAR IN PLACE. CUT EXISTING FIRE RATED CEILING AS REQUIRED TO PERFORM WORK. PATCH AND SEAL FIRE RATED CEILING WHERE WORK WAS PERFORMED OR PENETRATIONS ARE REQUIRED.
5. SHADED AREAS ON PLAN ARE NOT IN CONTRACT (NIC).

Date	Description
------	-------------

Seal / Signature

Project Name

URS - PORTLAND

Project Number

59 6222 900

Scale

As indicated

Description

PLUMBING PLANS - LEVEL 02 & 03

M01-02