

**SPECIAL APPLICATIONS:**  
 NO. DESCRIPTION:  
 1. FIRE CAULK WALL PENETRATION WHERE REQUIRED TO MEET BUILDING SPECIFIC RATINGS.

**LEGEND:**  
 ○ IN PIPE RISER UP  
 ○ IN PIPE RISER DOWN  
 △ PROPOSED STEEL SYSTEM RISER  
 ⊙ HYDRAULIC CALC. POINT

**DESIGN NOTES:**  
 ALL PIPING 1/2" & LARGER TO BE SCHEDULE 40 WITH PROVED FITTINGS.  
 ALL PIPING TO BE SCHEDULE 40 WITH APPROPRIATE FITTINGS.  
 POSITION, LOCATION, SPACING, AND USE OF SPRINKLERS SHALL BE IN ACCORDANCE WITH NFPA 13 HUNDERS SHALL BE IN ACCORDANCE WITH NFPA 13.  
 HYDRAULIC CALCULATION PROCEDURES HAVE BEEN USED TO DETERMINE THE LOCATION OF HEADS, HYDRAULIC CALC. POINTS, AND SYSTEM DEMANDS.  
 HIGH TEST FIRE PROTECTION IS TO BE INSTALLED TO PROTECT ALL PENETRATIONS THROUGH ROOF, FLOOR, AND CEILING ASSEMBLIES AND TO ACCOMMODATE ALL ACTUAL FIELD CONDITIONS.  
 ALL EQUIPMENT, ELECTRICAL AND PLUMBING SHALL BE INSTALLED TO PREVENT WATER LEAKING AND DAMAGE TO BUILDING.  
 ALL ELECTRICAL, ELECTRICAL AND PLUMBING SHALL BE INSTALLED TO PREVENT WATER LEAKING AND DAMAGE TO BUILDING.  
 ALL ELECTRICAL WORK IS TO BE DONE BY OTHERS.

**HEAD LEGEND:**  
 GLOBE  
 MODEL QLS601  
 2/7155  
 K=5.6  
 1/2" WHITE PENDENT MAX SPACING 10X12  
 GLOBE  
 MODEL QLS615  
 6/7200  
 K=5.6  
 1/2" BRASS UPRIGHT DEFLECTORS 1" TO 12" BELOW NON-COMBUSTIBLE CEILINGS 12X12 MAX SPACING  
 GLOBE  
 MODEL QLS626  
 27/7200  
 K=5.6  
 1/2" HORIZONTAL SIDEWALL DEFLECTORS 4" TO 6" BELOW NON-COMBUSTIBLE CEILINGS 14X14 MAX SPACING

**REVISIONS:**  
 NO. DATE DESCRIPTION:  
 DATE: MAY 22, 2015  
 DESIGNER: RAY PENNELL  
 CHECKER: EDWIN J. FLOSS  
 NICET LEVEL: RAS508. III 128301  
 LOCATION: 420 FORE STREET PORTLAND, ME  
 DRAWING TITLE: FIRE PROTECTION PLAN (NFPA 13 2010ed.)  
 DRAWING NO.: FP-02

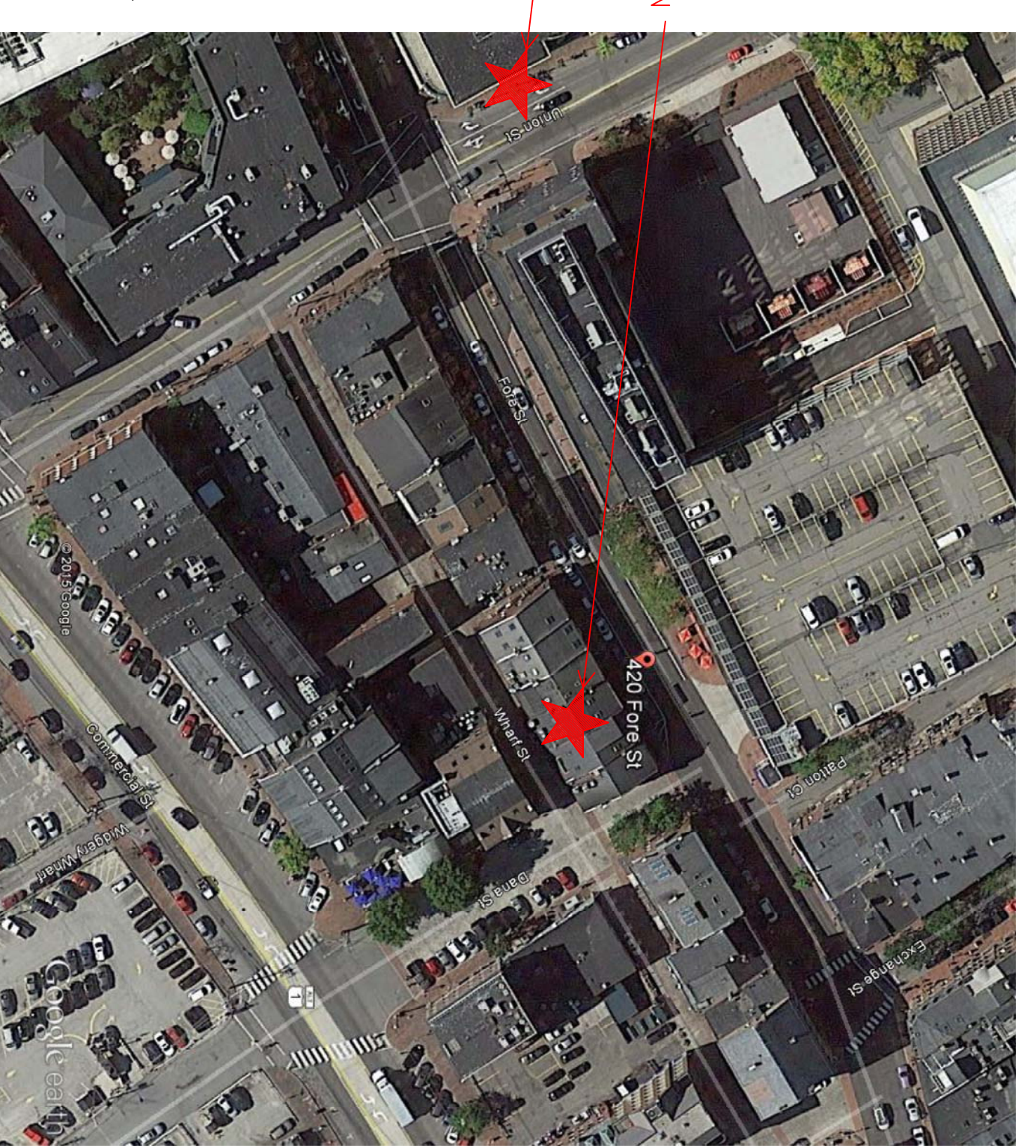

**PLOT PLAN**  
 SCALE: N.T.S.

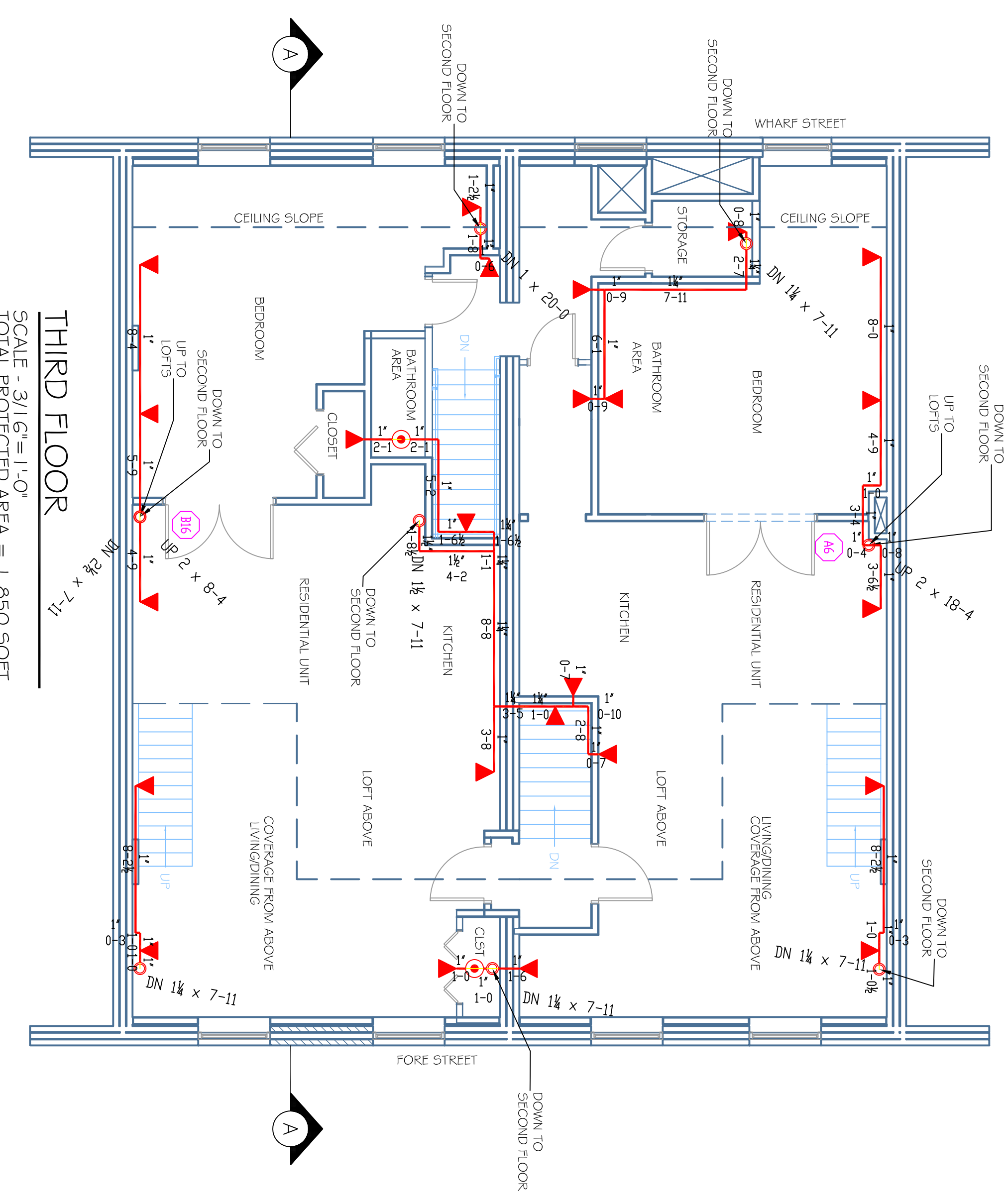
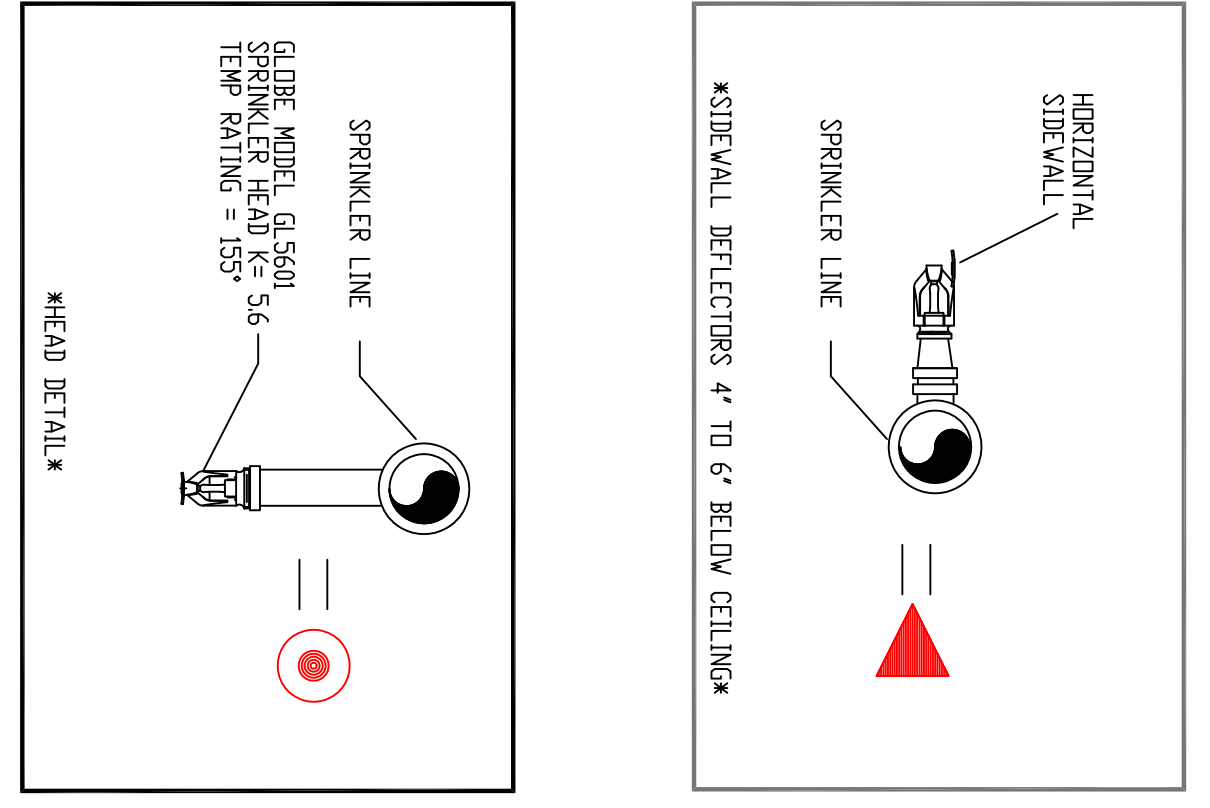

**THIRD FLOOR LOFTS**  
 SCALE: 3/16"=1'-0"  
 TOTAL PROTECTED AREA = 1,400 SQFT

**\*DESIGN AREA NUMBER 1\***  
**HYDRAULIC DESIGN CRITERIA**  
 LOCATION: PORTLAND, ME  
 AREA OF PROTECTION: 200 SQFT  
 DESIGN: 1.5" HDPE DRAINAGE  
 HEAD SPACING: 200 SQFT  
 SYSTEM DEMAND: INCLUDING HEADS & SYSTEM RISERS  
 SAFETY MARGIN: 11-PSI

**\*DESIGN AREA NUMBER 2\***  
**HYDRAULIC DESIGN CRITERIA**  
 LOCATION: PORTLAND, ME  
 AREA OF PROTECTION: 600-900 SQFT  
 DESIGN: 1.5" HDPE DRAINAGE  
 HEAD SPACING: 196 SQFT  
 SYSTEM DEMAND: INCLUDING HEADS & SYSTEM RISERS  
 SAFETY MARGIN: 13-PSI

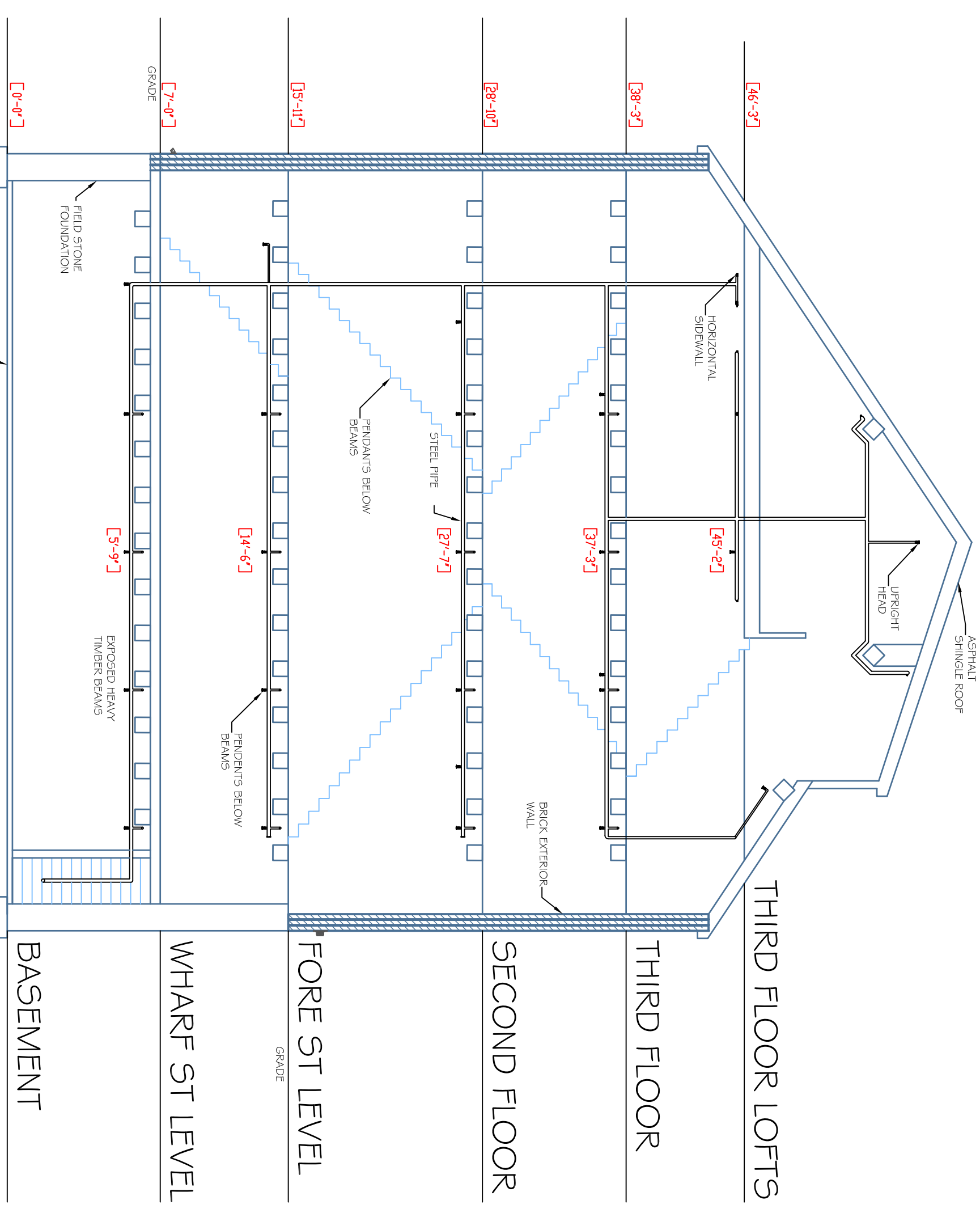

**SECTION DETAIL "A-A"**  
 SCALE = N.T.S.

\*OR APPROVED EQUAL\*

SCALE: 1/8" = 1'-0"  
 SCALE 9/8"=1'-0"

TOTAL HEADS ON THIS SHEET: 39