

DEMOLITION LEGEND

- SYMBOL DESCRIPTION**
- EXISTING BLOCK CORE, PARTITION AND MILLWORK TO REMAIN
 - EXISTING CONSTRUCTION TO BE DEMOLISHED
 - NEW CONSTRUCTION

KEY NOTES

1. PLUMBING FIXTURES AND WATER LINES TO BE REMOVED AND CAPPED WITHIN WALL ENCLOSURE OR FLOOR.
2. DEAD WALL AS REQUIRED TO ACCOMMODATE FOR NEW RECURVE DOORS.
3. EXISTING TO REMAIN.
4. REMOVE EXISTING TOILET &/OR SINK. SWAP OUT FLOOR AND WALL FINISHES. PREP TO RECEIVE TO FINISHES.
5. REMOVE EXISTING MOVABLE WALL.
6. NOT USED.
7. REMOVE ALL EXISTING CURB CUTS, WALL SLOTS, TRIMWORK, SASHES, AND WINDOW/DOOR UNITS AND DRYPANALS. REMOVE ALL EXISTING WINDOW AND DRYPANALS TO REMAIN. PREPARE WALL AS REQUIRED TO RECEIVE NEW TRANSLATION WINDOW. SEE WINDOW SCHEDULE FOR WINDOW SCHEDULE. REMOVE WINDOWS AND EXPOSE TO CREATE OPENINGS AS REQUIRED.
8. NO DEAD IN THIS ROOM. C.C. TO GENERAL ALL WALLS GO TO DECK.
9. NOT USED.
10. COLUMN TO REMAIN AS IS.
11. REMOVE EXISTING BRIMWALL AS REQUIRED TO MAKE COLUMN ENCLOSURE 2'-0" DEEP OR AS CLOSE TO 2'-0" DEEP AS POSSIBLE TO COINCIDE WITH EXISTING BRIMWALL AS REQUIRED AND PER CONSTRUCTION PLAN.
12. REMOVE EXISTING BRIMWALL AS REQUIRED AND MAKE COLUMN ENCLOSURE AS NOTED AS POSSIBLE PER CONSTRUCTION PLAN.
13. REMOVE EXISTING PASS THROUGH WINDOW AND PATCH WALL TO MATCH EXISTING PARTITION.

GENERAL KEY NOTES-TYPICAL

1. REMOVE EXISTING DOOR, DOOR FRAME, SILE LIGHTS, SILE LIGHT FRAMES, WOOD WALL BASE, CHAIR RAIL, AND DOOR MOLDING. REMOVE ALL TO BE REINSTALLED TO MATCH EXISTING SPECIFICATION.
2. ALL WALL AND FLOOR FINISHES TO BE REMOVED AND REFINISHED. PREPARE TO RECEIVE NEW FINISHES.
3. EXISTING CEILING GYPOCK TYLE AND LIGHTS TO BE REMOVED AND RECYCLED.
4. ALL EXISTING MILLWORK TO BE REMOVED.
5. ALL WALLS TO REMAIN. C.C. TO GENERAL. COMPONENT WITH PER CONSTRUCTION PLAN.
6. ALL WOOD, MILLWORK, CONSIGNMENT, WATER, ETC. IN SPACE TO BE REMOVED.

DEMOLITION NOTES

- CONSTRUCTION**
1. REMOVE ALL EXISTING CONSTRUCTION AS INDICATED ON THESE PLANS INCLUDING DOORS, FRAMES, & ALL HANGING CLIPS, STRIPS, HANGERS ETC. FROM SLAB ABOVE.
 2. REMOVE ALL EXISTING BRIMWALL SURROUNDS ON COLUMNS.
 3. KEEP GYPSUM BOARD FIRING COLUMNS AS INDICATED. CORE AND REINFORCE CONSTRUCTION UN.
 4. WORK INTENDED TO REMAIN BUT IMPROPERLY DAMAGED SHALL BE REPAIRED TO A PRE-DEMOLITION CONDITION AT THE CONTRACTOR'S EXPENSE.
 5. COORDINATE WITH BUILDING MANAGEMENT, BUILDING RULES & REGULATIONS, INCLUDING ELEVATOR TRUCKS, NOISE RESTRICTIONS AND DOCK PROCEDURES.
- FLOOR**
6. REMOVE ALL FLOOR FINISHES INCLUDING BUILDING MATERIALS, SLAG AND RIBBED FLOOR CLEAN AND LEVEL FOR NEW FINISH APPLICATION.
 7. PLUS/FILL ALL UNFILLED FLOOR CORES WITH SMOOTH MATERIAL TO MATCH EXISTING ADJACENT.
- CEILING**
8. REMOVE ALL EXISTING CEILING CONSTRUCTION INCLUDING, BUT NOT LIMITED TO: GRID FOR ACoustICAL CEILING SYSTEM AND GYPSUM BOARD CEILING AND SUPPORT SYSTEMS.
- RECYCLING**
9. CEILING TILES WILL BE RECYCLED. COORDINATE REQUIREMENTS WITH NEW CEILING TILE MANUFACTURER.
 10. CARPET WILL BE RECYCLED. COORDINATE REQUIREMENTS WITH NEW CEILING TILE MANUFACTURER.
- ELECTRICAL / TELEPHONE / DATA**
11. IT SHALL BE THE GENERAL CONTRACTOR'S RESPONSIBILITY TO REMOVE, TRANSPORT AND DISPOSE OF DEBRIS, 25% OF ALL DEBRIS SHALL BE RECYCLED. JOB SITE SHOULD BE RECYCLED ACCORDING TO CHICAGO CODE.
 12. REMOVE ALL EXISTING TELEPHONE SWITCHES, WIRING AND CONNECTING CONDUIT BACK TO ELECTRICAL PANEL. PLUG HOLES WITH LIGHTWEIGHT CONCRETE.
 13. CW / C.C. WILL BE RESPONSIBLE TO TRACE, PROTECT & MAINTAIN EXISTING VOICE / DATA & SECURITY CABLES ETC., DURING CONSTRUCTION THAT MAY SERVE OUTSIDE OUR SCOPE OF WORK.
 14. TELEPHONE WIRING IS TO BE PROTECTED, AS PER CODE, DURING AND AFTER DEMOLITION WORK IS COMPLETED.
- GENERAL**
15. COORDINATE DEMOLITION AS REQUIRED IN GENERAL TO MEET DESIGN INTENT FOR THE ENTIRE SCOPE OF THE PROJECT (ARCHITECTURAL, STRUCTURAL, MEP, ETC.,)
 16. C.C. SHALL COORDINATE & CONFER ALL ACTIVITIES IN CONNECTION WITH WHEN AND HOW WORK IS TO BE PERFORMED WITH OWNER & INCLUDED UNDER BASE CONTRACT.
 17. THE GENERAL CONTRACTOR SHALL ASCERTAIN THAT THE AREA OF DEMOLITION HAS BEEN CLEARED BY OTHERS OF ALL MOVABLE C.C. SHALL NOTIFY OWNER IMMEDIATELY OF ANY SUCH CONDITIONS THAT PREVENTS PROCEEDING WITH DEMOLITION.
 18. PROVIDE ALL LABOR, MATERIAL, GOT AND SERVICES FOR ALL DEMOLITION OF WORK, INCLUDING REMOVAL FROM THE BUILDING AS NOTED ON THE DRAWINGS. THE WORK SHALL INCLUDE, BUT NOT BE LIMITED TO:
 - a. REMOVAL OF EXISTING WINDOW, METAL, BRIMWALL AND GLASS INCLUDING EXCESS COLUMN FIRING, DOORS
 - b. CEILING, LIGHT FIXTURES, WIPERSSES, GRILLES, ETC.,
 - c. UNNECESSARY MECHANICAL EQUIPMENT, STRUCTURAL DRAWINGS, AND ASSOCIATED PANEL. (SEE ENGINEERING UNNECESSARY CONSULTS, WIRING, THERMOSTATS, CONTROL DEVICES, LIGHT SWITCHES AND JUNCTION BOXES. (SEE ALL OTHER ITEMS AS DEFINED ON DRAWINGS.
 - d. REFER TO ENGINEERING DRAWINGS FOR COORDINATION OF ALL DEMOLITION, REMEDIATION OF SMOKE DETECTORS, ELECTRICAL, OUTLETS, FIRE PROTECTION DEVICES AND ELECTRICAL OUTLETS.
 19. PROTECTION OF ADJACENT SURFACES & FINISHES ARE REQUIRED, INCLUDING WINDOW BLINDS.
 20. ALL BUILDING STRAPERS CONNECTORS TO BE PROTECTED & SEALED DURING DEMOLITION.
 21. C.C. TO COORDINATE DEMOLITION AS REQUIRED IN GENERAL TO MEET DESIGN INTENT IN THE ENTIRE SCOPE OF THE PROJECT (ARCHITECTURAL, STRUCTURAL, MEP ETC.,) BEFORE PLACING BID AND MAKE THIS SCOPE OF WORK PART OF THE BASE CONTRACT. (NO DISCUSSIONS ACCEPTED)
 22. C.C. MUST NOTIFY BUILDING MANAGER OR CHIEF ENGINEER OF ALL APPROVALS OBTAINED PRIOR TO COMMENCEMENT OF THIS WORK.
 23. ALL removal of furniture, equipment & ceiling, suspension of air system including plumbing, heating, electrical, air conditioning, etc., shall be coordinated with the building manager & owner.
 24. C.C. SHALL BE RESPONSIBLE FOR FIELD VENTILATION & WALK THROUGH WITH SUBCONTRACTORS TO DOCUMENT CONDITIONS & EXCLUSION ACCEPTED)
 25. ALL DEMOLITION WORK REGARDING THE SAFETY EQUIPMENT (FIRE ALARMS, SMOKE DETECTORS, FIRE EXTINGUISHERS, ETC.) SHALL BE SHIELDED FOR THE DISCONNECT OF THE APPROPRIATE FIRE ALARM EQUIPMENT. ALL NECESSARY FIRE SAFETY EQUIPMENT AND ASSOCIATED CONDUIT & WIRING SHALL BE PROTECTED DURING DEMOLITION. ALL NECESSARY SAFETY EQUIPMENT SHALL BE REPLACED OR REPAIRS MADE AT ALL TIMES. FLOOR & ELEVATOR LBBY) TO HAVE ADEQUATE COVERAGE.
 26. C.C. IS TO PROTECT ACCESS AREAS TO THE FLOOR DURING DEMOLITION TO AVOID DAMAGING ADJACENT AREAS (FINISH FLOOR RESPONSIBILITY OF THE OWNER). THE CONTRACTOR IS RESPONSIBLE FOR THE OWNERS APPROVAL FOR REPAIRS OF REPLACING ANY DAMAGED ITEM TO THE SATISFACTION OF BUILDING OWNER/MANAGER.
 27. C.C. TO INSTALL A TEMPORARY FILTER ON THE RETURN AIR DUCT SOURCE BEFORE STARTING DEMOLITION. SEE BUILDING ENGINEER FOR ADEQUATE LOCATION.
 28. SHALL PROVIDE FOR DAILY REMOVAL OF ALL DEMOLITION DEBRIS, LEFT BEHIND CLEAN. DEMOLITION WORK ALL AREAS ARE TO BE LEFT BEHIND CLEAN.
 29. TRUCKS SHALL STAY ON FOR DEMOLITION WHEN REQUIRED. C.C. SHALL INCLUDE IN PRICES IF TO STAY WORK.
 30. EXISTING FURNITURE REMOVAL BY OWNER.
 31. DEMOLITION SUBCONTRACTORS TO REVIEW DURING WALK THROUGH THE AMOUNT OF DEBRIS REQUIRED FOR REMOVAL.



REVISIONS

NO.	DATE	DESCRIPTION

ISSUE

NO.	DATE	COPIES	ISSUE TO WHOM
2	07/13/07		ISSUE FOR BID
1	07/13/07		ISSUE FOR PERMIT
	06/26/07		ISSUE FOR CLIENT REVIEW
	06/13/07		ISSUE TO ENGINEER

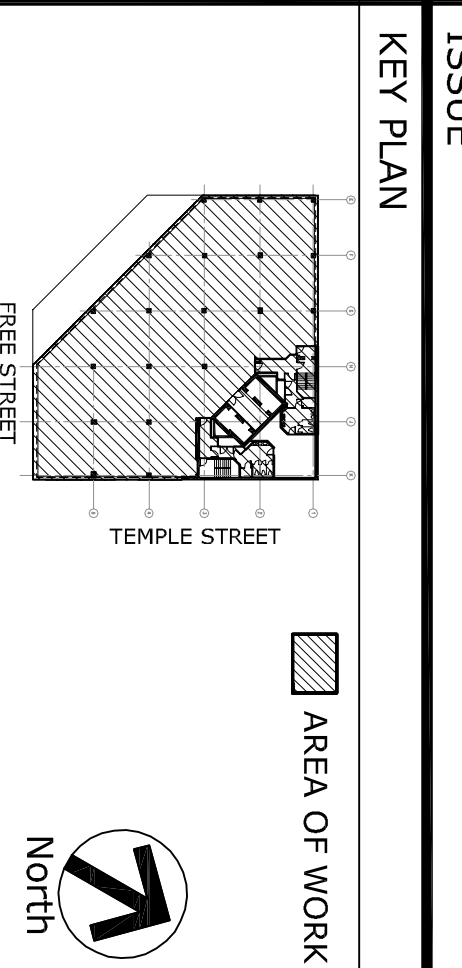

Ted Moulds Architects
 ARCHITECTURE
 INTERIORS
 NEWARK, CONNECTICUT

One Financial Place
 New York, NY 10017
 Tel: 212 261 2000
 Fax: 212 261 2000
 www.tedmoulds.com

PROJECT NUMBER
107126.01

SCALE
1/8" = 1'-0"

DATE
07/13/07

PROJECT ARCHITECT
AE

PROJECT MANAGER
AE

CAD FILE
R:\3007\107126\101

10th Fl. DEMOLITION PLAN

UBS
ONE CITY CENTER
PORTLAND, ME 04101

A-101.10