

Portland Press Herald
 MaineToday Media
 One City Center
 Portland, Maine

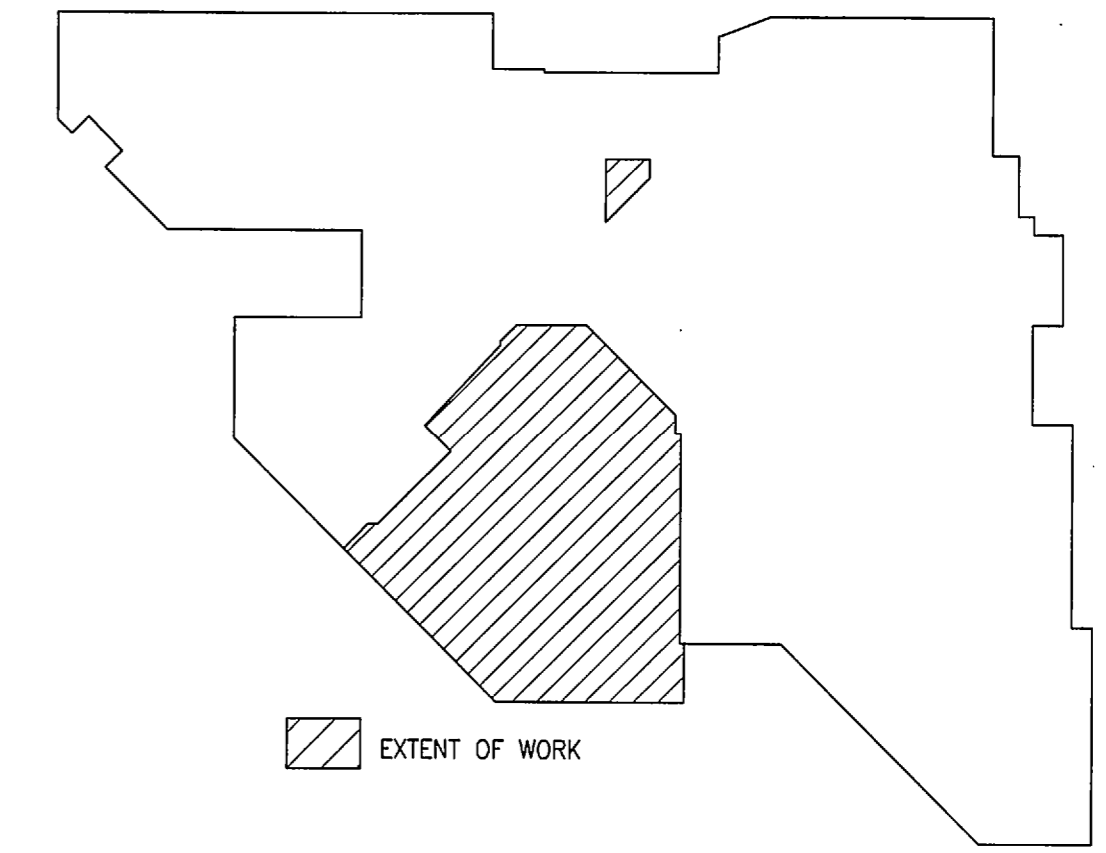

K17 KEY PLAN - SECOND FLOOR PLAN

- GENERAL DEMOLITION NOTES:**
1. COORDINATE PRIOR TO ANY DEMOLITION ALL DEMOLITION WORK SHALL BE COORDINATED WITH ALL NEW CONSTRUCTION BY ALL TRADES. GENERAL CONTRACTOR SHALL NOTIFY ARCHITECT IN WRITING OF ANY AND ALL FIELD CONDITIONS NOT SHOWN IN THE CONSTRUCTION DOCUMENTS PRIOR TO COMMENCEMENT OF DEMOLITION CONSTRUCTION. IN ASSOCIATION WITH INFORMATION INDICATING OTHERWISE, CONTRACTOR SHALL BRING AREAS UP TO STANDARDS UP TO STANDARDS OF NEW CONSTRUCTION IN THE AREAS CALLING FOR NEW CONSTRUCTION.
 2. DAMAGE: EXISTING BUILDING, BUILDING SYSTEM OR SITE COMPONENTS AFFECTED BY NEW WORK DEMOLITION OR WHICH MAY BE DAMAGED BY THE GENERAL CONTRACTOR OR SUBCONTRACTORS SHALL BE REPLACED OR RESTORED TO ORIGINAL CONDITION AND COLOR BY METHODS DESCRIBED IN THESE DOCUMENTS, OR AS APPROVED BY THE ARCHITECT.
 3. EQUIPMENT AND FIXTURES - NEW OR RELOCATED ITEMS SHALL BE VERIFIED BY CONTRACTOR AS APPROPRIATE TO THE ADJACENT AND CONTIGUOUS CONSTRUCTION PRIOR TO INSTALLATION OR RESTORATION. CONTRACTOR SHALL DETERMINE APPROPRIATE ANCHORING TYPES UNLESS OTHERWISE INDICATED.
 4. FINISHES: AFTER ALL REMOVALS OF WALLS, DOORS, WINDOWS, CEILING AND OTHER COMPONENTS, PATCH AND PREPARE THE REMAINING EXPOSED DAMAGED SURFACES TO PREPARE FOR NEW WORK AND NEW FINISH. INSTALL PRECED UNDERLAYMENT TO FLOORS AT WALL REMOVALS. INSTALL NEW WALKERS BY PATCHES IN AND FINISHING FLOOR AND FINISHING OR FINISHING AS NECESSARY.
 5. CONCEALED SPACES: DAMAGED CONSTRUCTION IN CONCEALED SPACES IS NOT REQUIRED TO BE REPAIRED, EXCEPT AS REQUIRED TO MAINTAIN FIRE RATINGS, STRUCTURAL INTEGRITY, WATERPROOFING AND OR HEAT LOSS OR GAIN.
 6. PIPE REMOVALS: AFTER REMOVALS OF PIPING, RADIATORS, AND OTHER EQUIPMENT, REPAIR THE PIPE PENETRATIONS TO MATCH ADJACENT EXISTING SURFACE AND TO MAINTAIN RATINGS. FILL HOLES AND REPAIR WALL SURFACES.

- INSTRUCTIONS FOR DEMOLITION:**
1. LEVEL EXISTING FLOORS TO RECEIVE NEW FINISHES AS INDICATED IN THE DRAWINGS - SEE INTERIOR FINISH SCHEDULE AND NOTES - AND SHALL BE CERTIFIED AS SUITABLE FOR THE NEW FINISHES BY THE INSTALLER PRIOR TO THE NEW WORK.
 2. COVER PLATES: PROVIDE COVER PLATES OVER ABANDONED ELECTRICAL DEVICES. PAINT WITH WALL.
 3. FIRE EXTINGUISHERS: CONTRACTOR SHALL REMOVE EXISTING EXTINGUISHERS AND INSTALL THEM AFTER THEIR WORK. NEW EXTINGUISHERS AND CABINETS SHALL BE INSTALLED BY THE CONTRACTOR FOR CODE. REMOVE EXISTING P.E. AND REINSTALL ADD NEW P.E. & CABINET TO MEET CODE.

- INSTRUCTIONS FOR DEMOLITION:**
1. CONTRACTOR IS RESPONSIBLE FOR SECURITY AND PROTECTION FROM DAMAGE AND WEATHER OF ANY EXPOSED BUILDING COMPONENTS RESULTING FROM DEMOLITION, REMOVALS AND NEW WORK.
 2. PLANS: SEE DEMOLITION PLANS FOR REMOVAL WORK. REFER TO ALL CONSTRUCTION DOCUMENTS FOR COORDINATION OF DEMOLITION AND NEW WORK. COORDINATE WITH ALL TRADES.
 3. VERIFY STRUCTURAL CONDITIONS WITH DRAWINGS AND ACTUAL CONDITIONS PRIOR TO WALL AND FLOOR REMOVALS. REPORT DISCREPANCIES TO ARCHITECT BEFORE PROCEEDING WITH WORK. CONTRACTOR IS RESPONSIBLE FOR SHOWING AND OTHER TEMPORARY SUPPORT METHODS AS MAY BE NEEDED.
 4. REUSE/SALVAGE: CONTRACTOR SHALL SALVAGE CERTAIN COMPONENTS FOR LIMITED USE TO MATCH EXISTING CONDITIONS TO PATCH AND REPAIR INCLUDING:
 - SALVAGE ALL EXISTING PERIMETER BLINDS
 - SALVAGE ALL EXISTING PERIMETER BLINDS
 5. SALVAGE FOR OWNERS: PRIOR TO ANY AND ALL DEMOLITION, CONTRACTOR SHALL MEET WITH OWNERS REPRESENTATIVE TO DETERMINE REQUIRED SALVAGED ITEMS.
 6. CONSULT WITH PORTLAND PRESS HERALDS DATA & TELEPHONE SYSTEM VENDOR ON EQUIPMENT TO BE REMOVED AND RELOCATED.

- DEMOLITION NOTES:**
- 01 REMOVE DOOR, FRAME AND ALL ASSOCIATED HARDWARE AS REQUIRED FOR NEW CONSTRUCTION SALVAGE FOR REUSE.
 - 02 REMOVE WALL AS REQUIRED FOR NEW CONSTRUCTION.
 - 03 REMOVE EXISTING CEILING GROSS, TILE AND ASSOCIATED HARDWARE AS REQUIRED DUE TO DEMOLITION AND NEW CONSTRUCTION.
 - 04 REMOVE ALL WALL FINISHES AND ASSOCIATED ADHESIVES AS REQUIRED FOR A SMOOTH AND LEVEL APPLICATION OF NEW FINISHES.
 - 05 REMOVE ALL FLOOR COVERING AND ASSOCIATED ADHESIVES, SOIL AND DEBRIS AND PREPARE EXISTING SUBFLOOR AS REQUIRED FOR SMOOTH AND LEVEL APPLICATION OF NEW FINISHING.
 - 06 REMOVE WALL BRACE AND ASSOCIATED ADHESIVES. PREPARE EXISTING WALL AS REQUIRED FOR SMOOTH AND LEVEL APPLICATION OF NEW BRACE.
 - 07 REMOVE EXISTING DND SCOTTS.
 - 08 REMOVE WINDOW TREATMENT & ACCESSORIES - SALVAGE FOR REUSE - TYPICAL AT ALL EXTERIOR WINDOWS. STORE IN A DUST FREE ENVIRONMENT.
 - 09 REPAIR ANY DAMAGED WOOD SILLS IN THEIR ENTIRETY TO MATCH EXISTING.
 - 10 REMOVE EXISTING FOLDING PARTITION DOOR - SALVAGE FOR REUSE FOR CITY CENTER NEWS.
 - 11 REMOVE EXISTING HANG FLOOR UNIT AND UPS UNIT - CIP AND REMOVE ANY AND ALL DUCTWORK ASSOCIATED WITH REMAIN - WORK TO BE DONE BY BUILDING MANAGEMENT COMPANY.
 - 12 EXISTING ROOF DRAIN TO BE REMOVED AND REDIRECTED. PROVIDE THROUGH PENETRATION FIRE STOPPING AT ALL FLOOR CORE LOCATIONS. TYPICAL.

REVISIONS		
#	DATE	DESCRIPTION
1	02/01/10	ISSUED FOR PERMITTING ONLY

DATE:	02-01-10
PROJECT #:	011010.00
DRAWN BY:	DLP
CHECKED BY:	MET
DRAWING SCALE:	1/8"=1'-0"

SHEET TITLE
 SECOND FLOOR DEMOLITION PLAN NOTES/KEYPLAN

D100

© COPYRIGHT 1985-2003
 REPRODUCTION OR RESALE OF
 THIS DOCUMENT WITHOUT
 WRITTEN PERMISSION OF
 GAWRON ARCHITECTS IS PROHIBITED

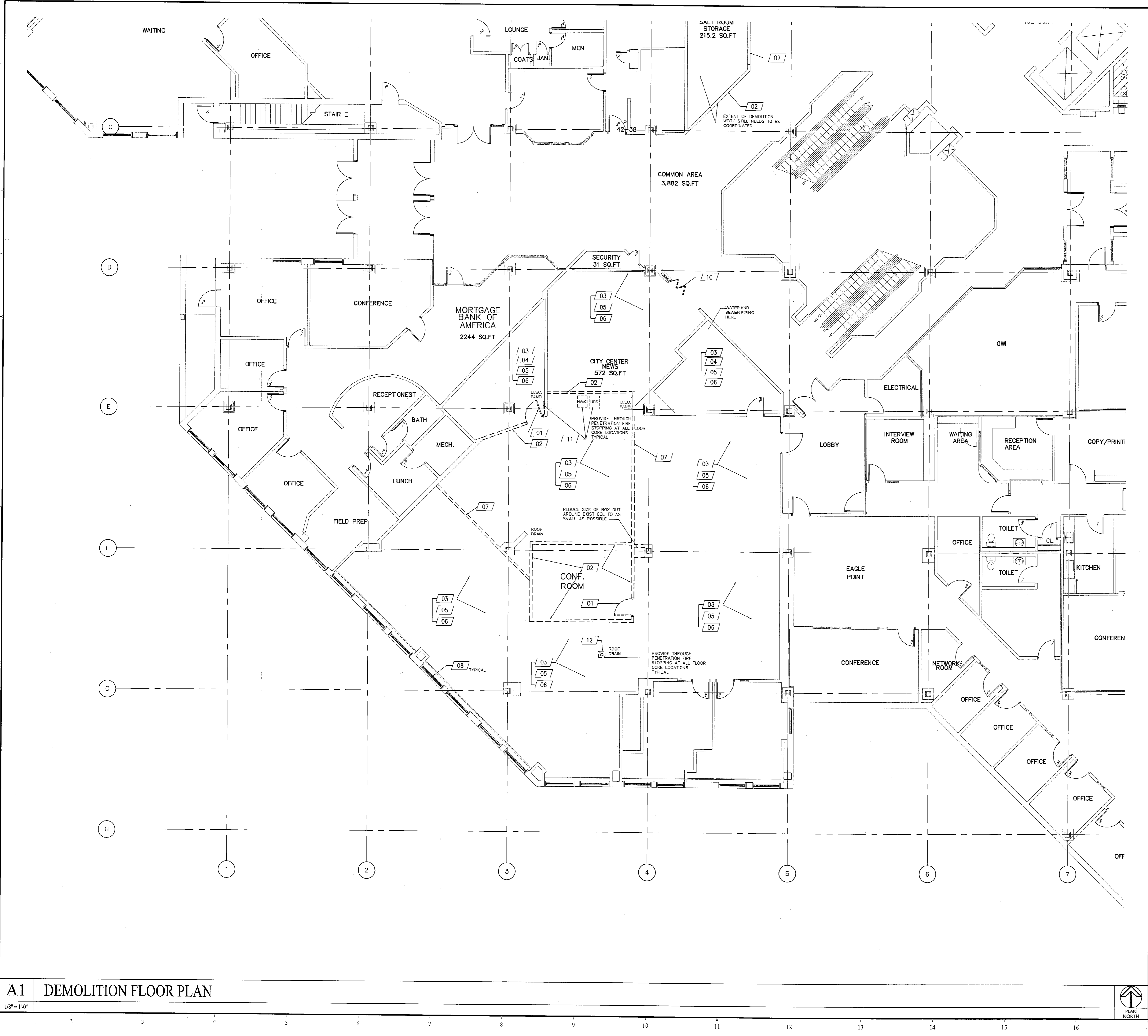

A1 DEMOLITION FLOOR PLAN
 1/8" = 1'-0"

A17 DEMOLITION NOTES