

**City of Portland, Maine – Building or Use Permit Application** 389 Congress Street, 04101, Tel: (207) 874-8703, FAX: 874-8716

Location of Construction: <b>own City Center</b>		Owner: <b>Dirigo Management</b>		Phone:		Permit No: <b>960589</b>	
Owner Address:		Leasee/Buyer's Name: <b>Faina Webber</b>		Phone:		BusinessName:	
Contractor Name: <b>Bailey Sign</b>		Address: <b>9 Thomas Dr., Westbrook 04092</b>		Phone: <b>774-2843</b>		<div style="border: 2px solid black; padding: 5px; text-align: center;"> <b>PERMIT ISSUED</b>                  Permit Issued:  <b>JUN 25 1996</b>  <b>CITY OF PORTLAND</b> </div>	
Past Use: <b>Office</b>		Proposed Use: <b>same with 1'6" x 8'9" sign</b>		COST OF WORK: \$			
Proposed Project Description: <b>Erect signage as per plans</b>		FIRE DEPT. <input type="checkbox"/> Approved <input type="checkbox"/> Denied  Signature: _____		INSPECTION: Use Group: Type:		Zone: <b>B-3</b> CBL: <b>032-L-002</b>	
				PEDESTRIAN ACTIVITIES DISTRICT (P.A.D.) Action: Approved <input checked="" type="checkbox"/> Approved with Conditions: <input type="checkbox"/> Denied: <input type="checkbox"/>  Signature: _____ Date: _____		Zoning Approval: Special Zone or Reviews: <input type="checkbox"/> Shoreland <input type="checkbox"/> Wetland <input type="checkbox"/> Flood Zone <input type="checkbox"/> Subdivision <input type="checkbox"/> Site Plan maj <input type="checkbox"/> minor <input type="checkbox"/> mm <input type="checkbox"/>	
Permit Taken By: <b>Vicki Dova</b>		Date Applied For: <b>June 19, 1996</b>					

1. This permit application doesn't preclude the Applicant(s) from meeting applicable State and Federal rules.
2. Building permits do not include plumbing, septic or electrical work.
3. Building permits are void if work is not started within six (6) months of the date of issuance. False information may invalidate a building permit and stop all work..

UL # AS-597694  
 AS-597695  
 AS-597696

**CERTIFICATION**

I hereby certify that I am the owner of record of the named property, or that the proposed work is authorized by the owner of record and that I have been authorized by the owner to make this application as his authorized agent and I agree to conform to all applicable laws of this jurisdiction. In addition, if a permit for work described in the application issued, I certify that the code official's authorized representative shall have the authority to enter all areas covered by such permit at any reasonable hour to enforce the provisions of the code(s) applicable to such permit

SIGNATURE OF APPLICANT Judy Bailey ADDRESS: 9 Thomas Dr., Westbrook, ME 04092 DATE: June 19, 1996 PHONE: \_\_\_\_\_

RESPONSIBLE PERSON IN CHARGE OF WORK, TITLE \_\_\_\_\_ PHONE: \_\_\_\_\_

White-Permit Desk Green-Assessor's Canary-D.P.W. Pink-Public File Ivory Card-Inspector

**Zoning Appeal**

Variance  
 Miscellaneous  
 Conditional Use  
 Interpretation  
 Approved  
 Denied

**Historic Preservation**

Not in District or Landmark  
 Does Not Require Review  
 Requires Review

Action:

Approved  
 Approved with Conditions  
 Denied

Date: \_\_\_\_\_

CEO DISTRICT 2



U.L. #s for signage 3 section label

AS-597694  
AS-597695  
AS-597696

SIGNAGE APPLICATION

B-3 - PAD

ADDRESS: One City Center, Portland, Maine  
OWNER: Dirigo Management  
APPLICANT: Bailey Sign/Paine Webber  
ASSESSORS NO.: \_\_\_\_\_

SINGLE TENANT LOT? YES: \_\_\_\_\_ NO: \_\_\_\_\_

MULTI-TENANT LOT? YES:  NO: \_\_\_\_\_

FREESTANDING SIGN? YES: \_\_\_\_\_ NO:

DIMENSIONS: \_\_\_\_\_

MORE THAN ONE SIGN? \_\_\_\_\_

DIMENSIONS: \_\_\_\_\_

BLDG. WALL SIGN? YES:  NO: \_\_\_\_\_

DIMENSIONS: 1'8" x 8'9"

MORE THAN ONE SIGN? \_\_\_\_\_

DIMENSIONS: 1.66 x 8.75 = 14.5'

LIST ALL EXISTING SIGNAGE, INCLUDING THEIR DIMENSIONS: on file - see plot/  
plan ok

LOT FRONTAGE (IN FEET): \_\_\_\_\_

BLDG FRONTAGE (IN FEET): \_\_\_\_\_

AWNING? YES: \_\_\_\_\_ NO:  IS AWNING BACKLIT? YES: \_\_\_\_\_ NO: \_\_\_\_\_

HEIGHT OF AWNING: \_\_\_\_\_

IS THERE ANY COMM. MESSAGE, TRADEMARK, OR SYMBOL ON IT? \_\_\_\_\_

PLEASE PROVIDE A SITE SKETCH AND A BUILDING SKETCH, SHOWING EXACTLY WHERE  
EXISTING AND NEW SIGNAGE IS LOCATED.

WE WILL NEED SKETCHES AND/OR PICTURES OF THE PROPOSED SIGNS INCLUDING  
STRUCTURAL COMPONENTS.

*See Attached drawing*

Templest.

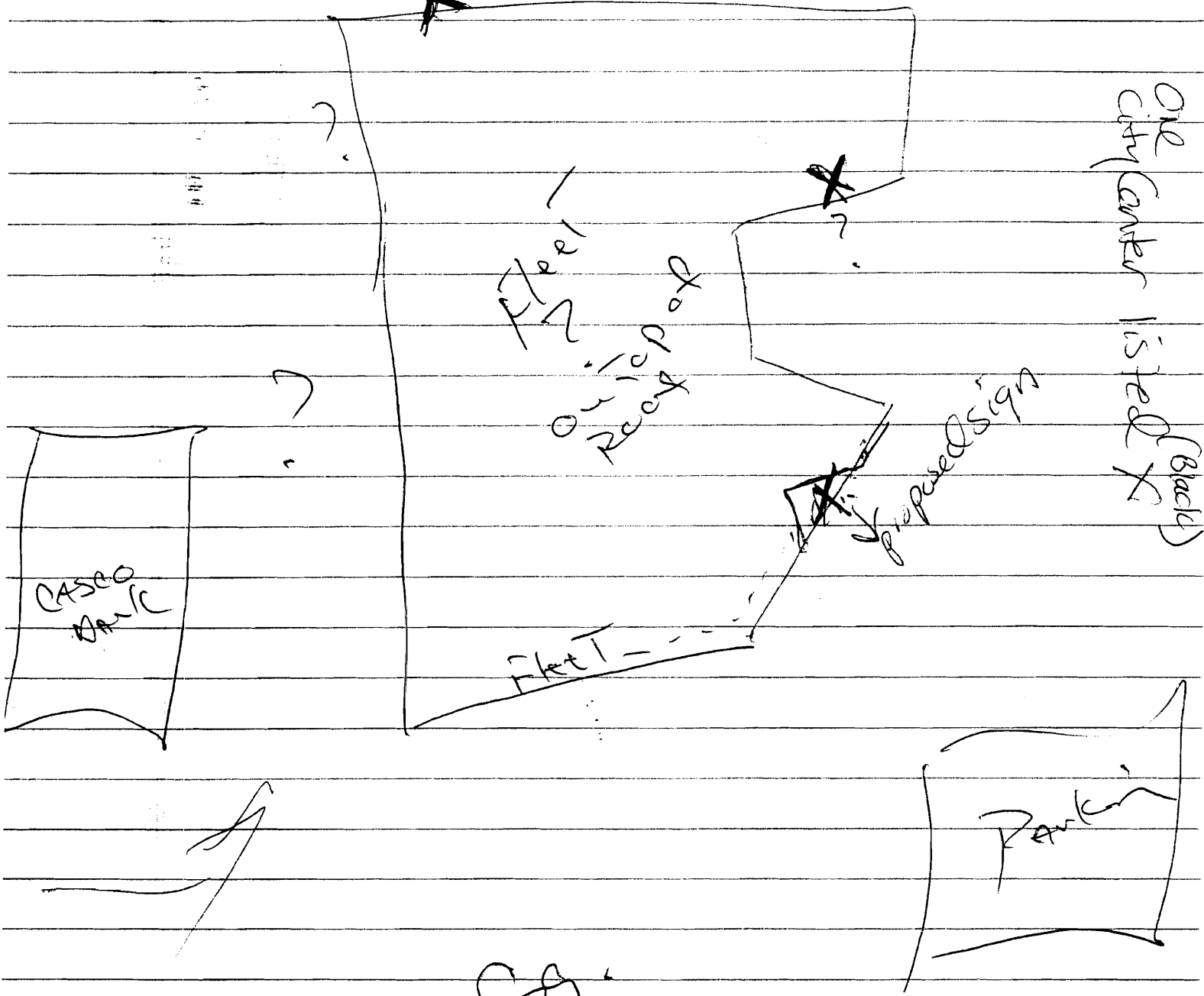

Congress

**Certificate of Insurance**

THIS CERTIFICATE IS ISSUED AS A MATTER OF INFORMATION ONLY AND CONFERS NO RIGHTS UPON YOU THE CERTIFICATE HOLDER. THIS CERTIFICATE IS NOT AN INSURANCE POLICY AND DOES NOT AMEND, EXTEND, OR ALTER THE COVERAGE AFFORDED BY THE POLICIES LISTED BELOW.

**This is to Certify that**

PAINWEBBER GROUP, INC.  
 LINCOLN HARBOR  
 1000 HARBOR BLVD.  
 WEEHAWKEN, NJ 07087

← Name and address of Insured.



Is, at the issue date of this certificate, insured by the Company under the policy(ies) listed below. The insurance afforded by the listed policy(ies) is subject to all their terms, exclusions and conditions and is not altered by any requirement, term or condition of any contract or other document with respect to which this certificate may be issued.

TYPE OF POLICY	EXP. DATE		POLICY NUMBER	LIMIT OF LIABILITY	
	* <input type="checkbox"/> CONTINUOUS	<input type="checkbox"/> EXTENDED			
<b>WORKERS COMPENSATION</b>	<input type="checkbox"/>	<input type="checkbox"/>	8/31/96	WC7-631-066980-035  WC1-631-066980-025	COVERAGE AFFORDED UNDER WC LAW OF THE FOLLOWING STATES:
					California
					All Other States
					Bodily Injury By Disease \$500,000 Policy Limit
					Bodily Injury By Disease \$500,000 Each Person
<b>GENERAL LIABILITY</b> <input checked="" type="checkbox"/> OCCURRENCE <input type="checkbox"/> CLAIMS MADE	<input type="checkbox"/>	8/31/96	TB2-631-066980-055	RETRO DATE <input type="text"/>	General Aggregate - Other than Products/Completed Operations \$5,000,000
					Products/Completed Operations Aggregate \$1,000,000
					Bodily Injury and Property Damage Liability \$1,000,000 Per Occurrence
					Personal Injury \$1,000,000 Per Person/Organization
					Other
<b>AUTOMOBILE LIABILITY</b> <input checked="" type="checkbox"/> OWNED <input checked="" type="checkbox"/> NON-OWNED <input checked="" type="checkbox"/> HIRED	<input type="checkbox"/>	8/31/96	AS2-631-066980-065 AS2-631-066980-105 AS2-631-066980-115		\$1,000,000 Each Accident - Single Limit B.I. and P.D. Combined
					Each Person
					Each Accident or Occurrence
					Each Accident or Occurrence
<b>OTHER</b> Umbrella Excess Liability	<input type="checkbox"/>	8/31/96	TH1-631-066980-015		\$15,000,000 BI & PD each occurrence \$15,000,000 general aggregate - excluding products \$15,000,000 products-completed operations aggregate

ADDITIONAL COMMENTS

\* If the certificate expiration date is continuous or extended term, you will be notified if coverage is terminated or reduced before the certificate expiration date.

**SPECIAL NOTICE-OHIO:** ANY PERSON WHO, WITH INTENT TO DEFRAUD OR KNOWING THAT HE IS FACILITATING A FRAUD AGAINST AN INSURER, SUBMITS AN APPLICATION OR FILES A CLAIM CONTAINING A FALSE OR DECEPTIVE STATEMENT IS GUILTY OF INSURANCE FRAUD.

**NOTICE OF CANCELLATION:** (NOT APPLICABLE UNLESS A NUMBER OF DAYS IS ENTERED BELOW.) BEFORE THE STATED EXPIRATION DATE THE COMPANY WILL NOT CANCEL OR REDUCE THE INSURANCE AFFORDED UNDER THE ABOVE POLICIES UNTIL AT LEAST 30 DAYS

NOTICE OF SUCH CANCELLATION HAS BEEN MAILED TO:

Liberty Mutual Group

324

*Mary A. Taylor*  
 Mary A. Taylor  
 AUTHORIZED REPRESENTATIVE

CERTIFICATE HOLDER

*FOR INFORMATION Purposes*

Roseland, NJ

(201) 740-9400

OFFICE

PHONE NUMBER

DATE ISSUED



**DIRIGO  
MANAGEMENT  
COMPANY**

To: Bruce Bailey  
From: Jim O'Donnell

June 5, 1996

Ms. Elizabeth S. Duckman  
Divisional Vice President  
Corporate Real Estate  
PaineWebber Inc.  
1000 Harbor Blvd.  
Weehawken, NJ 07087-6790

RE: Exterior Signage

Dear Liz:

Please regard this letter as written approval for PaineWebber to install its corporate sign on the exterior wall of the Monument Square entrance to One City Center (below the existing One City Center sign).

This approval is consistent with the lease provision granting PaineWebber exterior signage rights.

Should you have any questions, please contact me.

Sincerely,

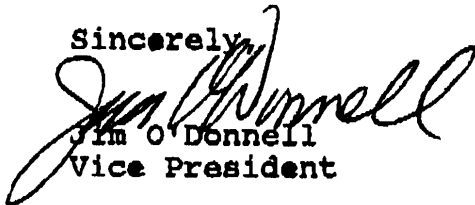
  
Jim O'Donnell  
Vice President

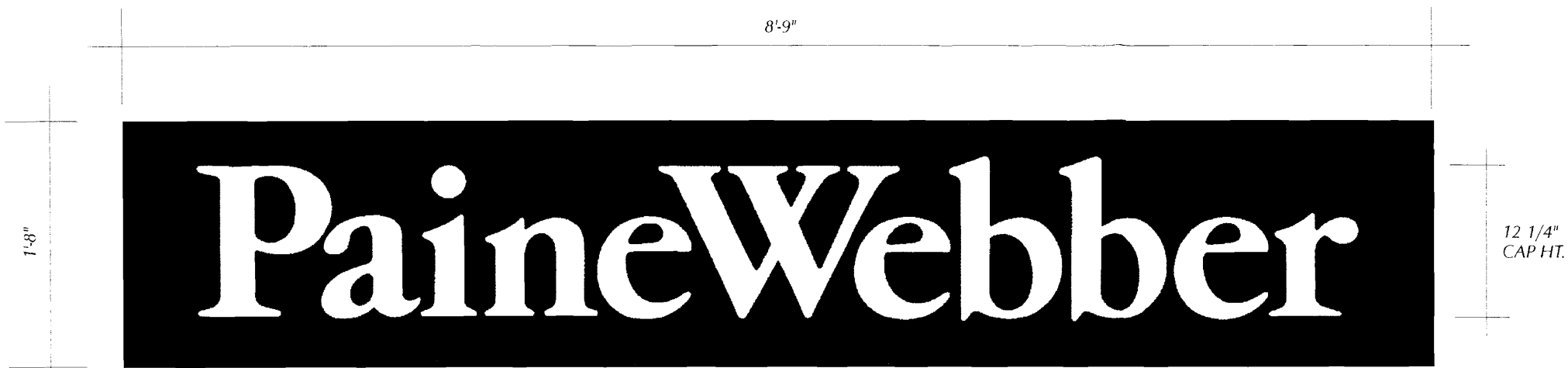

1 SET of 12 1/4" BACKLIT FAB. LETTERS on B/G

1'-8" X 8'-9" X 1" B/G = BRONZE

12 1/4" BACKLIT FAB. LETTERS (1 1/2" DEPTH); FACES = WHITE RETURNS = BRONZE WHITE NEON

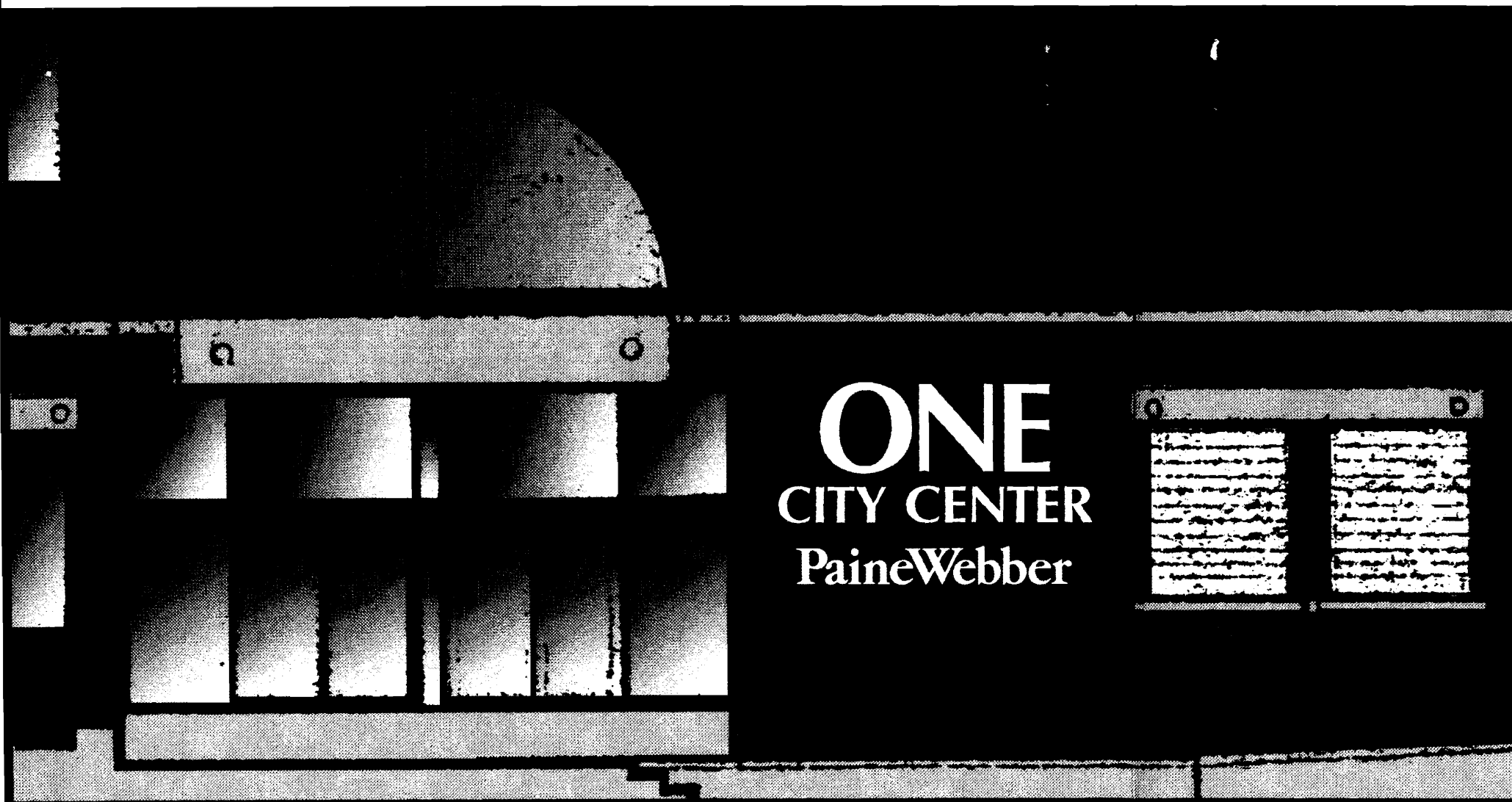

EXISTING 30" & 12 1/4" CAP HT.  
BACKLIT FAB. LTRS.  
WHITE FACES / BRONZE RETURNS  
WHITE NEON  
O.A. LENGTH = 8'-9"

**PERMIT PRINT**

PLOT PLAN  
APPROX. SCALE 1/4"=1'

VOLTAGE 120



**ART INFORMATION**

CAMERA READY ART  
 ON FILE  REQUIRED   
 RECEIVED DATE: \_\_\_\_\_

**PLEASE NOTE:**  
 THIS IS A PROGRESS PRINT - FIELD MEASUREMENTS MAY OR MAY NOT NEED TO BE VERIFIED.  
 THIS DESIGN IS THE EXCLUSIVE PROPERTY OF BAILEY SIGN INCORPORATED AND ALL RIGHTS TO ITS USE OR REPRODUCTION ARE RESERVED.  
 COLORS SHOWN HERE ARE FOR DISTRIBUTION ONLY COLOR MATCH NUMBERS WILL BE NEEDED  
 IF AN ELECTRIC SIGN, THEN INSTALLATION MUST BE ACCOMPLISHED IN TOTAL COMPLIANCE WITH THE NATIONAL ELECTRIC CODE. THE REQUIREMENTS OF UNDERWRITERS LABORATORY, CANADIAN STANDARDS ASSOCIATION, AND APPLICABLE LOCAL CODES.

9 Thomas Drive  
Col. Westbrook Executive Park  
Westbrook, ME 04092  
207-774-2843 / 1-800-539-SIGN  
© COPYRIGHT 1995

CUSTOMER: **DIRIGO MANAGEMENT**  
 LOCATION: **PAINE WEBBER ONE CITY CTR. PORTLAND, ME**

SALESPERSON: **B. BAILEY**

DRAWN BY: **L.W. MERRIFIELD**

ACCEPTANCE SIGNATURE \_\_\_\_\_ DATE \_\_\_\_\_  
 SALES CLIENT \_\_\_\_\_

P.S. # **D-565** W.O. # \_\_\_\_\_

SCALE **1"=1'** DATE **3/12/96**

REVISIONS: **4/2/96 INC. B/G & LTR. HT.**

DRAWING NO: \_\_\_\_\_ SHEET **03306 R1**