

**LIST OF ABUTERS**

| CITY OF PORTLAND |                                   |  |
|------------------|-----------------------------------|--|
| MAP/BLOCK/LOT    | RECORD OWNER                      | ADDRESS                                    |
| 27/F/23          | PETER E. & MAURA H. RODWAY JTS    | 3102 MAIN STREET HANOVER, ME 04237         |
| 27/F/24          | BROWN JB & SONS                   | P.O. BOX 207 PORTLAND, ME 04112            |
| 27/F/26          |                                   |  |
| 27/F/27          |                                   |  |
| 32/H/4           | CITY OF PORTLAND                  | 389 CONGRESS STREET PORTLAND, ME 04101     |
| 32/G/1           | AJ&M                              | 120 EXCHANGE STREET PORTLAND, ME 04101     |
| 32/K/1           | 800 NORTHERN CORP.                | 25 SOUTH SERVICE ROAD JERICHO, NY 11755    |
| 32/K/12          | FINARD MURRAY W/ TR               | ONE MONUMENT SQUARE PORTLAND, ME 04101     |
| 32/P/1           | MDA LLC                           | P.O. BOX 100 YORK HARBOR, ME 03911         |
| 32/P/3           | FOUR CITY CENTER PROPERTIES LLC   | P.O. BOX 403 PORTLAND, ME 04101            |
| 32/P/4           | CHASE CUSTOM HOMES & FINANCE INC. | 290 BRIDGTON ROAD STE2 WESTBROOK, ME 04092 |
| 32/P/17          | MINA BUILDING LLC                 | 10 CITY CENTER PORTLAND, ME 04101          |

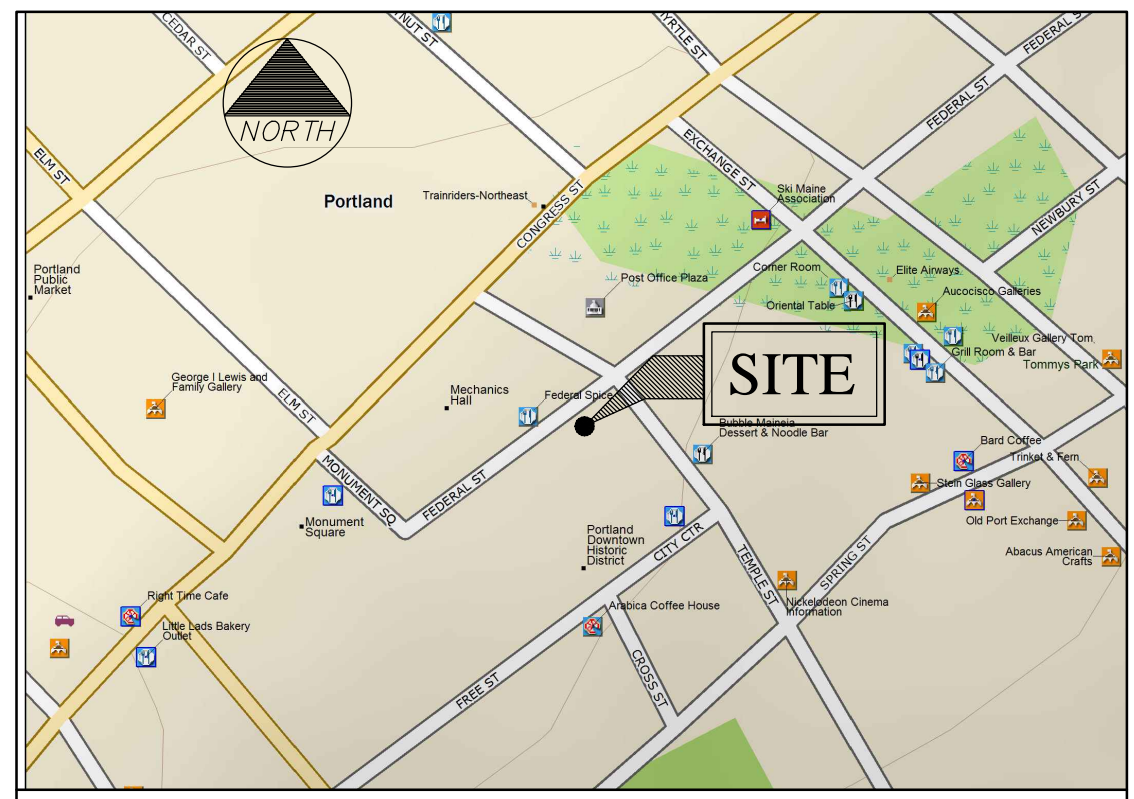

**PLAN REFERENCE**

1. PLAN ENTITLED "OMNIPPOINT COMMUNICATION INC.—ONE CITY CENTER" DATED MARCH 11, 1998. DONE BY EDARDS & KELCEY WIRELESS—529 MAIN STREET, BOSTON MA 02129.

- GENERAL NOTES**
- DATES OF FIELD SURVEY: DECEMBER 2014
  - SITE NAME: ONE CITY CENTER
  - SITE NUMBER: XXXXX
  - SITE ADDRESS: ONE CITY CENTER PORTLAND, ME 04101 CUMBERLAND COUNTY
  - OWNER: ONE CITY CENTER ASSOCIATES LLC ONE CITY CENTER PORTLAND, ME 04101 CUMBERLAND COUNTY
  - APPLICANT: REDZONE WIRELESS 413 MAIN STREET #205 ROCKLAND, ME 04841
  - JURISDICTION: PORTLAND, MAINE
  - ZONING DISTRICT: DOWNTOWN BUSINESS (B3)
  - TAX IDENTIFICATION: MAP 32 BLOCK L LOT 2 DEED BOOK/PAGE: 19188/209
  - VERTICAL DATUM: NATIONAL GEODETIC VERTICAL DATUM OF 1929, (MEAN SEA LEVEL).
  - HORIZONTAL DATUM: NORTH AMERICAN DATUM OF 1983 (NAD83)
  - CENTER OF EXISTING ROOFTOP TOWER: LATITUDE: 43° 39' 27.96" N (NAD 83) LONGITUDE: 70° 15' 26.53" W (NAD 83) GROUND EL. = 66.0'±
  - BEARINGS ARE BASED ON MAINE STATE GRID COORDINATE SYSTEM, WEST ZONE, (NAD83).
  - ALL UNDERGROUND UTILITY INFORMATION PRESENTED HEREON WAS DETERMINED FROM SURFACE EVIDENCE AND PLANS OF RECORD. ALL UNDERGROUND UTILITIES SHOULD BE LOCATED IN THE FIELD PRIOR TO COMMENCEMENT OF ALL SITE WORK. CALL DIGSAFE 1(888) 344 -7233 A MINIMUM OF 72 HOURS PRIOR TO PLANNED ACTIVITY.
  - PROPERTY IS LOCATED IN FLOOD ZONE "C" AS SHOWN ON FLOOD INSURANCE RATE MAP IN THE CITY OF PORTLAND MAINE, CUMBERLAND COUNTY PANEL 14 OF 17, COMMUNITY PANEL NUMBER 20054-0014-B EFFECTIVE DATE JULY 17, 1986. ZONE C IS DEFINED AS AN AREA OF MINIMAL FLOODING.

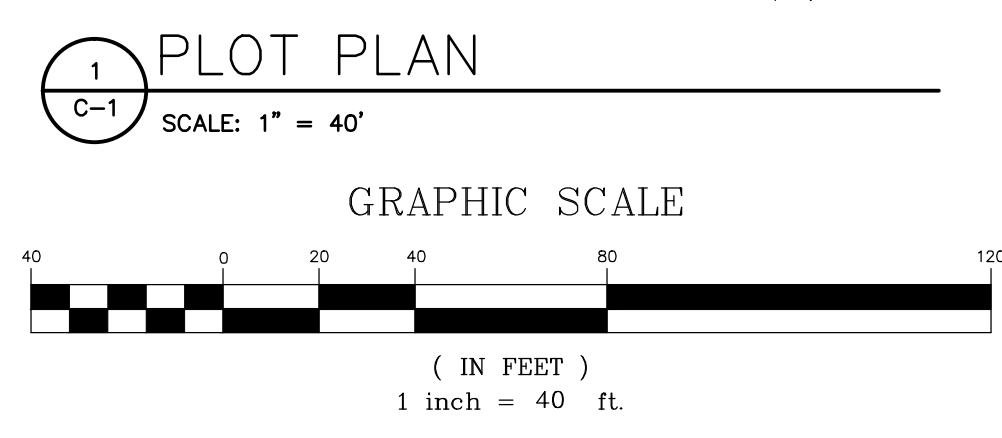

**TILSON**  
4944 Ver Plank Road, Clay NY 13041  
P: (207) 591-6427 F: (207) 772-3427

**amec**  
511 Congress Street Suite 200, Portland ME 04101  
P: (207) 775-6401 F: (207) 772-4762 www.amec.com

APPLICANT:  
**redZone WIRELESS**

SURVEYOR

ENGINEER  
**FOR COMMENT**

PROJECT NO: 3618148398

DRAWN BY: CBM

RELEASED BY: MSD

**SUBMITTALS**

| NO. | DATE | DESCRIPTION |
|-----|------|-------------|
|     |      |             |
|     |      |             |
|     |      |             |
|     |      |             |
|     |      |             |
|     |      |             |
|     |      |             |
|     |      |             |
|     |      |             |
|     |      |             |

ONE CITY CENTER

ONE CITY CENTER  
PORTLAND, ME 04101

SHEET TITLE  
PLOT PLAN

SHEET NUMBER  
**C-1**

**NOTE:**  
THIS NOT A STANDARD BOUNDARY SURVEY. EXCEPT AS IDENTIFIED BY MONUMENTATION FOUND ALL BOUNDARIES SHOWN ON THIS PLAN HAVE BEEN COMPILED FROM RECORD DEEDS AND TAX MAPS AND ARE INTENDED TO SHOW THE LOCATIONS OF ABUTTERS LOTS AND ZONING BOUNDARIES ONLY.  
EQUIPMENT INSTALLATION SHALL MEET ALL LOCAL, STATE AND FEDERAL REQUIREMENTS FOR EQUIPMENT EMISSIONS.