

Gawron Turgeon ARCHITECTS
 29 Black Point Road
 Scarborough, Maine 04074
 www.gawronturgeon.com
 207-883-6307 ext. 207-883-0361 fax

MainePERS
 ONE CITY CENTER-8TH FLOOR
 PORTLAND, MAINE

REVISIONS		
#	DATE	DESCRIPTION

DATE:	08.07.13
PROJECT #:	010613
DRAWN BY:	DLP
CHECKED BY:	MET
DRAWING SCALE:	

SHEET TITLE
 EIGHTH FLOOR PLAN
 PARTITION TYPES
 DETAILS

A100

© COPYRIGHT 1985-2008
 REPRODUCTION OR USE OF THIS
 DOCUMENT WITHOUT WRITTEN
 PERMISSION OF GAWRON TURGEON
 ARCHITECTS IS PROHIBITED

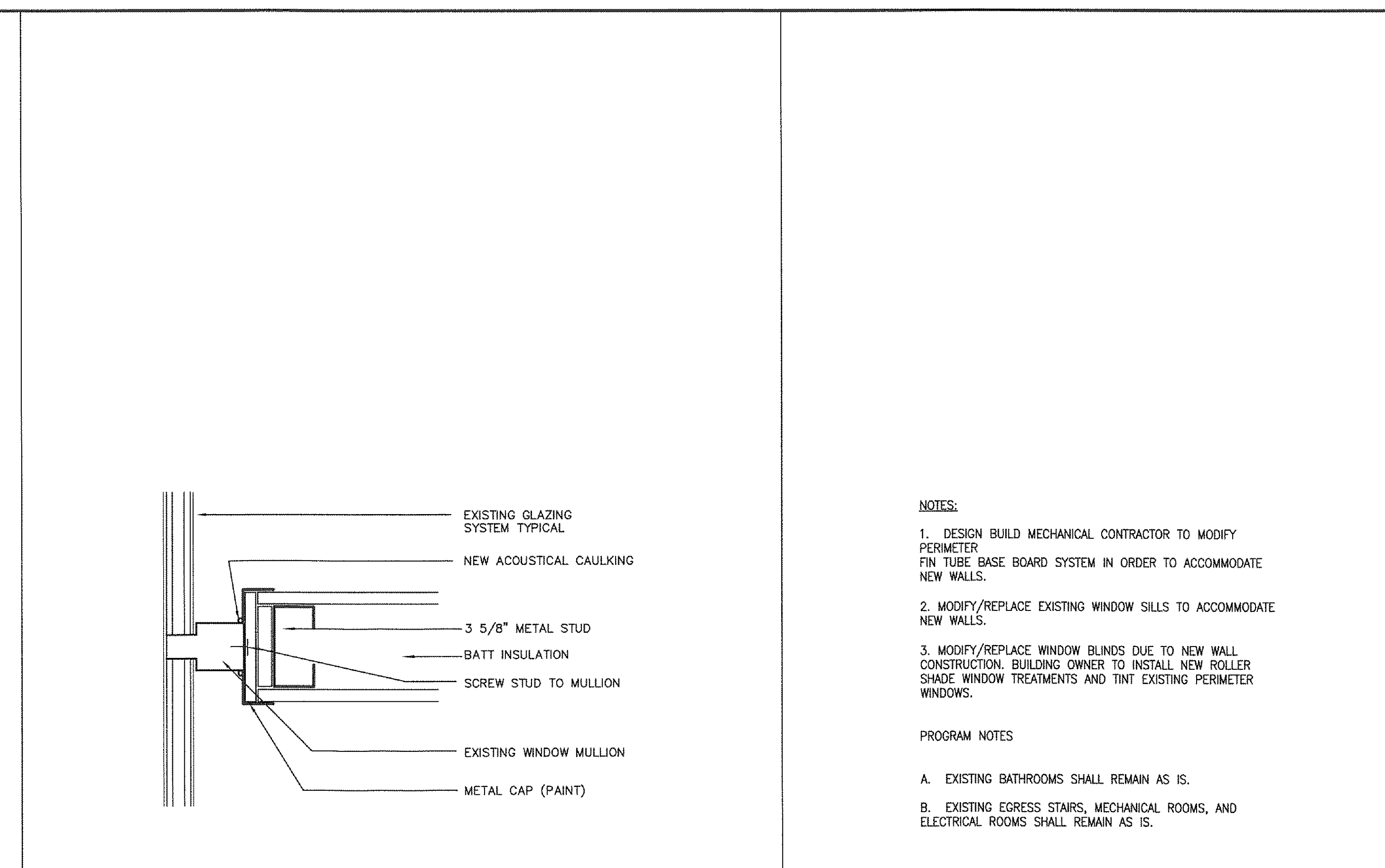
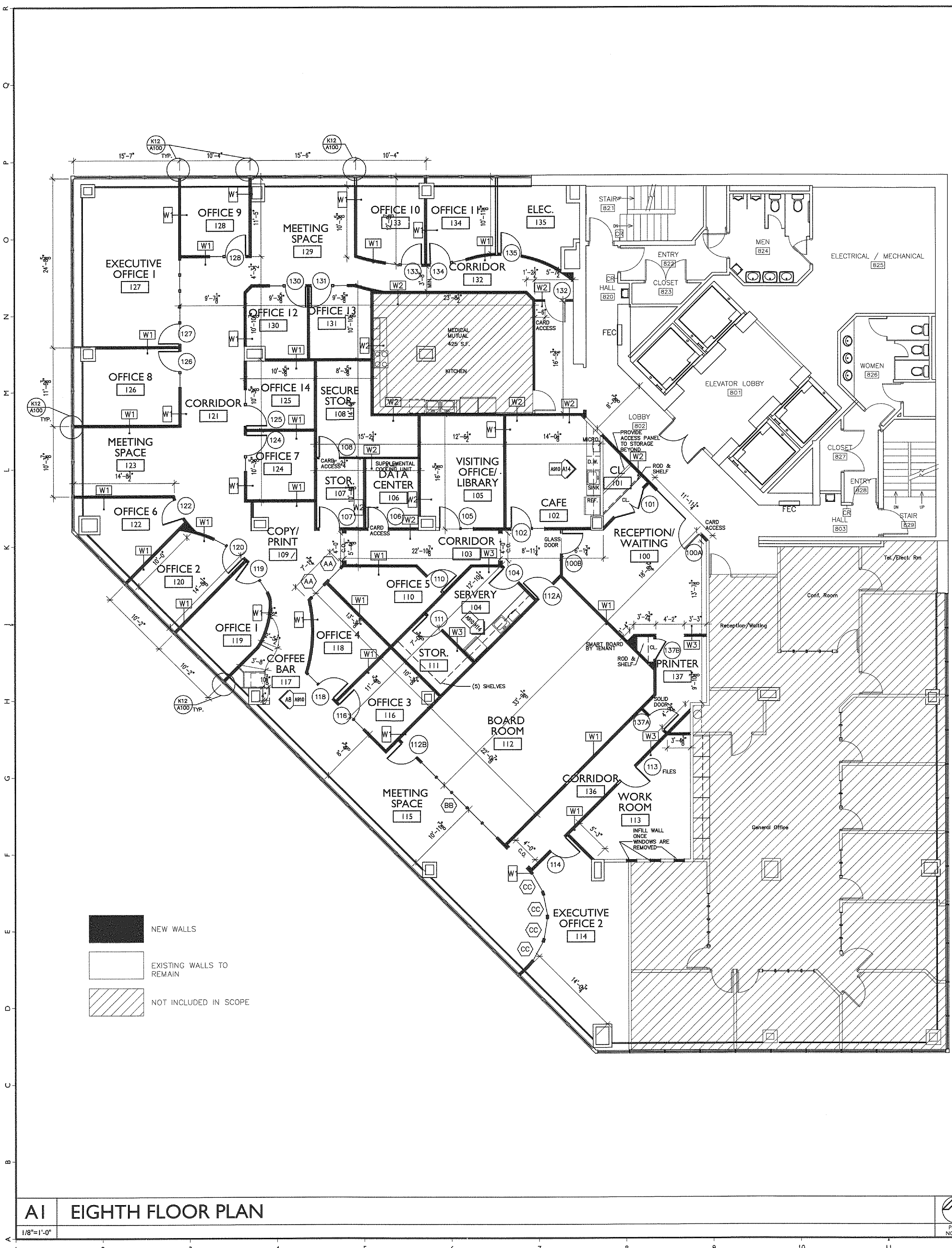

K12 WALL MULLION DETAIL
 3/4"=1'-0"

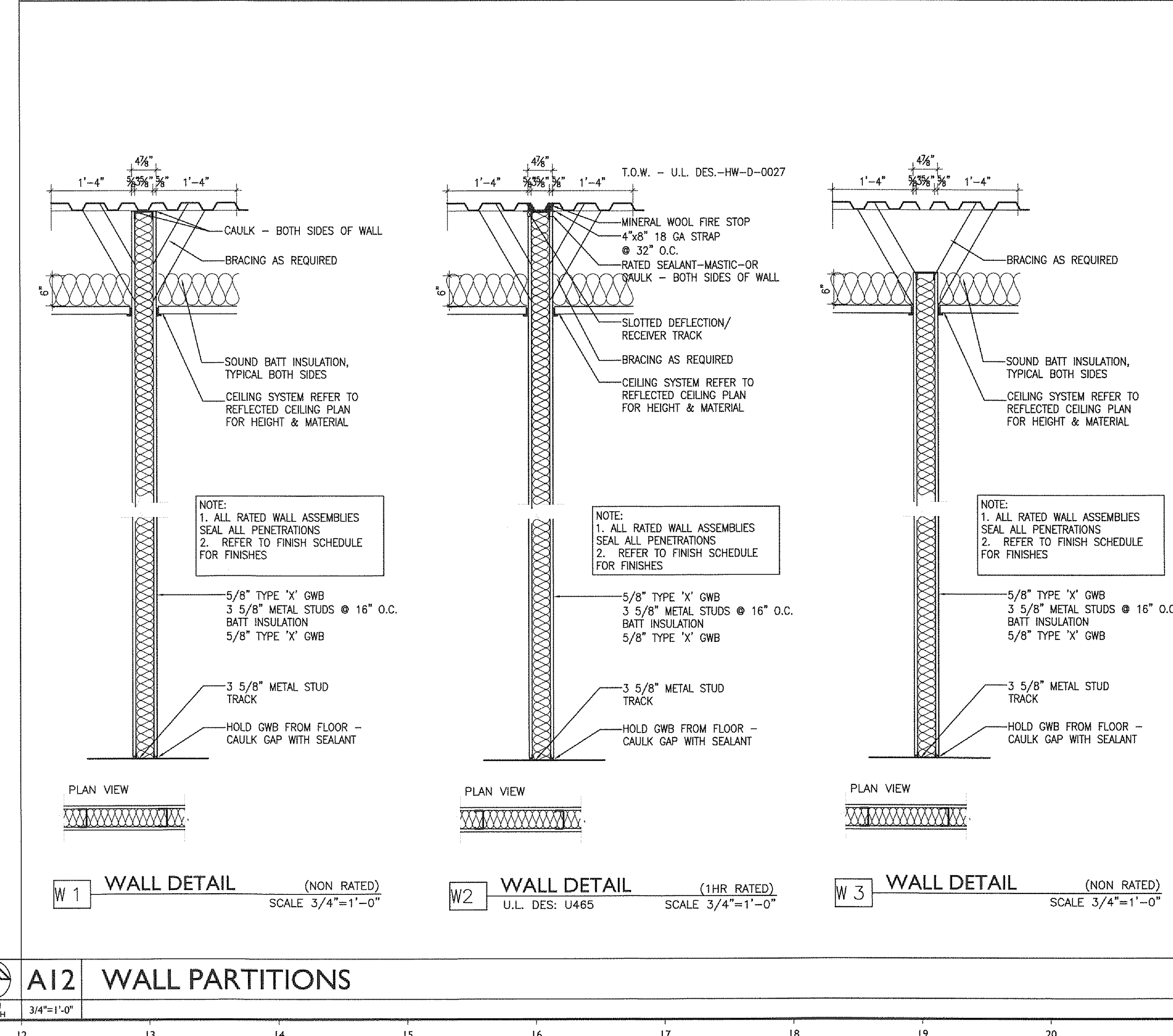

K17 NOTES
W1 WALL DETAIL (NON RATED) SCALE 3/4"=1'-0"
W2 WALL DETAIL (1HR RATED) U.L. DES. U485 SCALE 3/4"=1'-0"
W3 WALL DETAIL (NON RATED) SCALE 3/4"=1'-0"

A1 EIGHTH FLOOR PLAN
 1/8"=1'-0"

A12 WALL PARTITIONS
 3/4"=1'-0"

131017000-01-001-001.dwg (Rev. 08/07/13) Stanley Turgeon, P.E., Architectural & Mechanical Engineering, 1100 Reg. Ave., Portland, ME 04103