

EQUIPMENT PLAN
SCALE: 1/4"=1'-0"

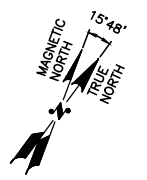

AAV SCOPE OF WORK NOTES:

- 1 **MEET POINT:** EXISTING TELCO BACKBOARD INSIDE GROUND FLOOR TELCO ROOM.
- 2 **FIBER RUN:** PROPOSED FAIRPOINT FIBER TO ORIGINATE FROM EXISTING TELCO ROOM AND RUN WITHIN EXISTING 4" RGS ABOVE GROUND CONDUIT TO EXISTING PULL BOX ON 14TH FLOOR. (APPROX. 350'±)
- 3 **PROPOSED FIBER TO CONTINUE FROM EXISTING PULL BOX WITHIN PROPOSED 2" RGS ABOVE GROUND CONDUIT TO PROPOSED METRONID MOUNTED ON PROPOSED BACKBOARD INSIDE SPRINT LEASE AREA. (APPROX. 80'±)**
- 4 **SPRINT TO PROVIDE MULE TAPE AND INNERDUCT FOR THE FIBER. (APPROX. 430'±)**
- 5 **PROPOSED METRONID MOUNTED ON PROPOSED 2'x3' BACKBOARD INSIDE SPRINT LEASE AREA BY FAIRPOINT.**
- 6 **PROPOSED FIBER TO CONTINUE FROM PROPOSED METRONID AND RUN WITHIN PROPOSED 2" RGS ABOVE GROUND CONDUIT TO PROPOSED MM-BTS CABINET (APPROX. 10'±)**
- 7 **PROPOSED FIBER FROM EXISTING TELCO ROOM TO PROPOSED MM-BTS CABINET (APPROX. 440'± TOTAL)**
- 8 **POWER RUN:** PROPOSED INSTALL 1 1/4" RGS CONDUIT FROM THE PROPOSED MM-BTS TO PROPOSED METRONID (APPROX. 10'±) (DC POWER CONDUCTORS *TBD BY SPRINT GC*)

CALL
BEFORE YOU DIG
CALL TOLL FREE 888-DIG-SAFE

SPRINT TO PROVIDE MULE TAPE AND INNERDUCT IN EXISTING/PROPOSED CONDUIT PATHS UNLESS OTHERWISE NOTED

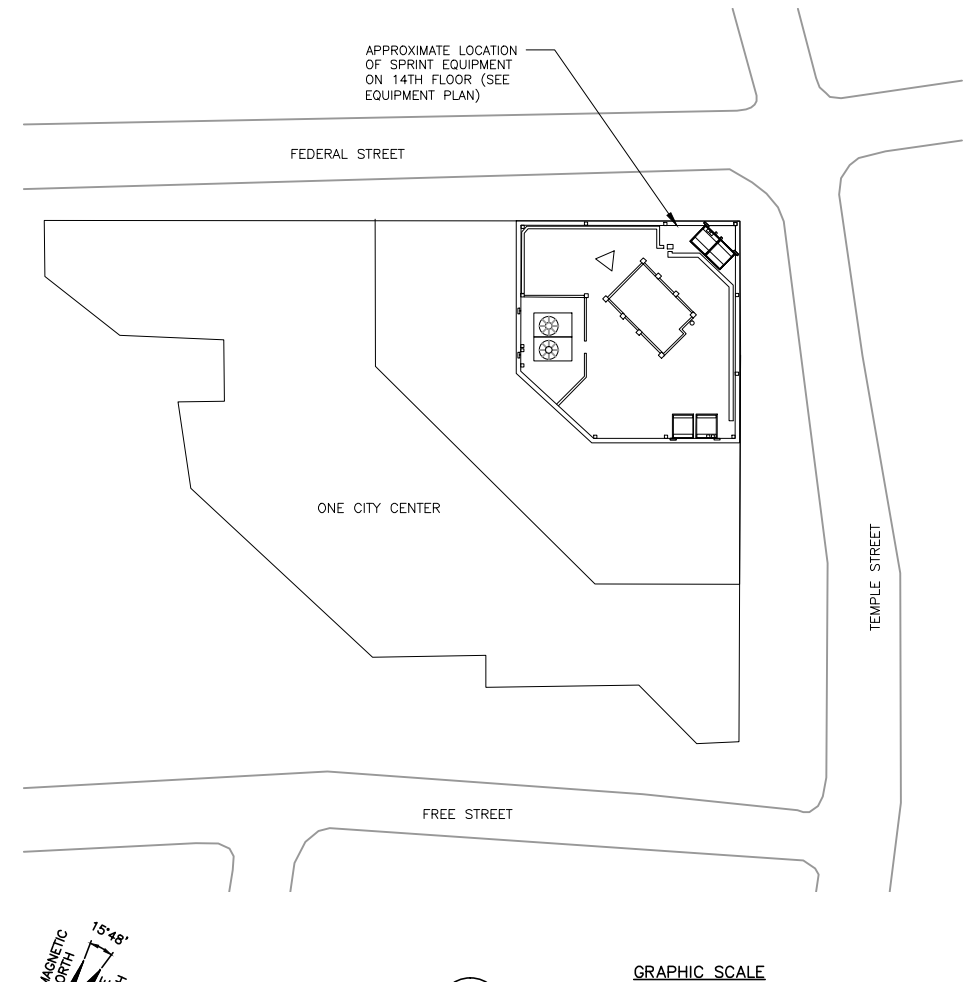

SITE PLAN
SCALE: 1/32"=1'-0"

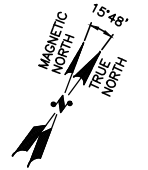
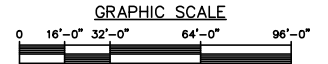

Sprint VISION
1 INTERNATIONAL BLVD, SUITE 800
MAHWAH, NJ 07495
TEL: (800) 357-7641

Alcatel-Lucent
1 ROBBINS ROAD
WESTFORD, MA 01886
TEL: (978) 932-1600

Hudson Design Group, Inc.
1600 OSGOOD STREET
BUILDING 20 NORTH, SUITE 3090
N. ANDOVER, MA 01845
TEL: (978) 557-5553
FAX: (978) 536-5384

CHECKED BY: KB

APPROVED BY: DPH

SUBMITTALS			
REV.	DATE	DESCRIPTION	BY
0	09/12/12	FOR REVIEW	TH

SITE NUMBER:
NM03XC067
SITE NAME:
ONE CITY CENTER
PORTLAND
SITE ADDRESS:
1 CITY CENTER
PORTLAND, ME 04101

SHEET TITLE
COMPOUND PLAN

SHEET NUMBER
A-1