

REVISIONS		
#	DATE	DESCRIPTION

DATE:	06.03.13
PROJECT #	060113
DRAWN BY:	DLP
CHECKED BY:	DLP
DRAWING SCALE	AS NOTED

SHEET TITLE
OVERALL FIRST FLOOR PLAN FLOOR PLAN EQUIPMENT SCHEDULE LIFE SAFETY PLAN

A1

City Deli: Equipment Schedule (5/18/13)

Item:	Qty.:	Manufacturer:	Description:
#1	2	Captive-Aire	Exhaust Hood
#2	1	Firesafe	Fire Suppression System
#3	1	Southbend	60" Range w/six(6) burners and 24" griddle
#4	1	Superior	Convection Oven
#5	1	Pitco	40 lb. Gas Fryer
#6	1	Bev-Air	Two Section Freezer
#7	1	Unknown	30"x72" Wood Top Work Table
#8	1	Advance/Tabco	24"x18" Pass Thru Shelf
#9	1	Advance/Tabco	30"x48" S.S. Work Table
#10	1	Advance/Tabco	30"x72" S.S. Work Table w/partial undershelf
#11	1	Delfield	Undercounter Refrigerator
#12	1	Advance/Tabco	Microwave Shelf
#13	2	Amana	Commercial Microwave Oven
#14	1	Waring	Panini Grill
#15	2	TRUE	Sliding Glass Door Merchandiser
#16	1	Unknown	Chip Rack
#17	1	Unknown	P.O.S. System
#18	1	Millwork	Front Service Counter
#19	1	TRUE	72" Sandwich Unit
#20	2	Delfield	Four(4)-Well Drop-In Hot Food
#21	1	Brass Smith	Sneeze-guard
#22	1	Advance/Tabco	Hand Wsh Sink
#23	1	Advance/Tabco	30"x78" S.S. Enclosed Cabinet
#24	1	Advance/Tabco	Three Compartment Pot Sink
#25	1	Advance/Tabco	30"x48" S.S. Work Table w/prep sink
#26	1	Unknown	30"x72" S.S. Work Table
#27	2	Advance/Tabco	12"x120" S.S. Wall Shelf
#28	1	TRUE	Three Section Refrigerator
#29	Lot	Intermetro	Five-Tier Shelving Unit
#30	1	Globe	Automatic Slicer

H1 OVERALL FIRST FLOOR PLAN - KEY PLAN

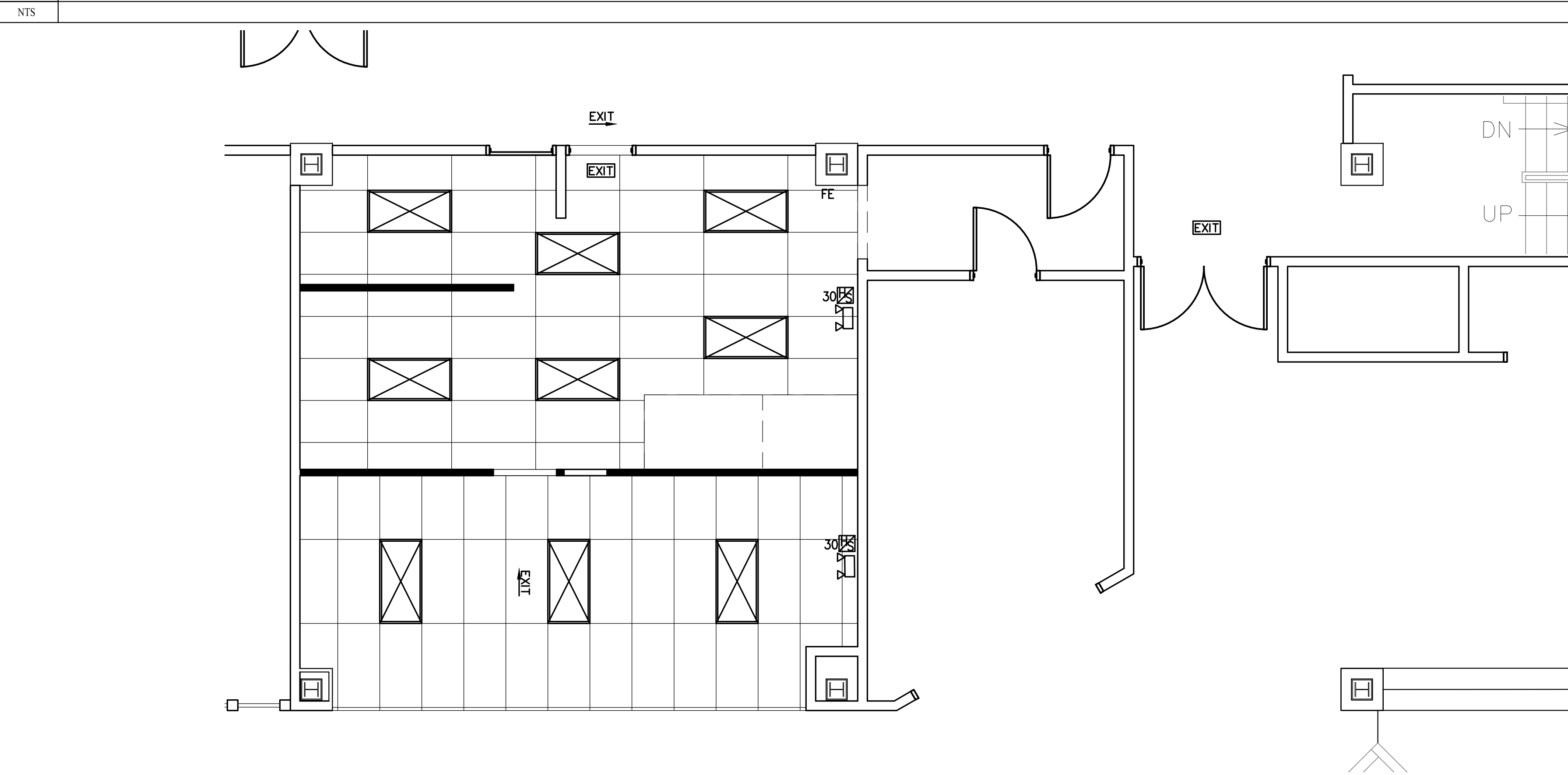

A1 LIFE SAFETY PLAN

1/4"=1'-0"

H12 EQUIPMENT SCHEDULE

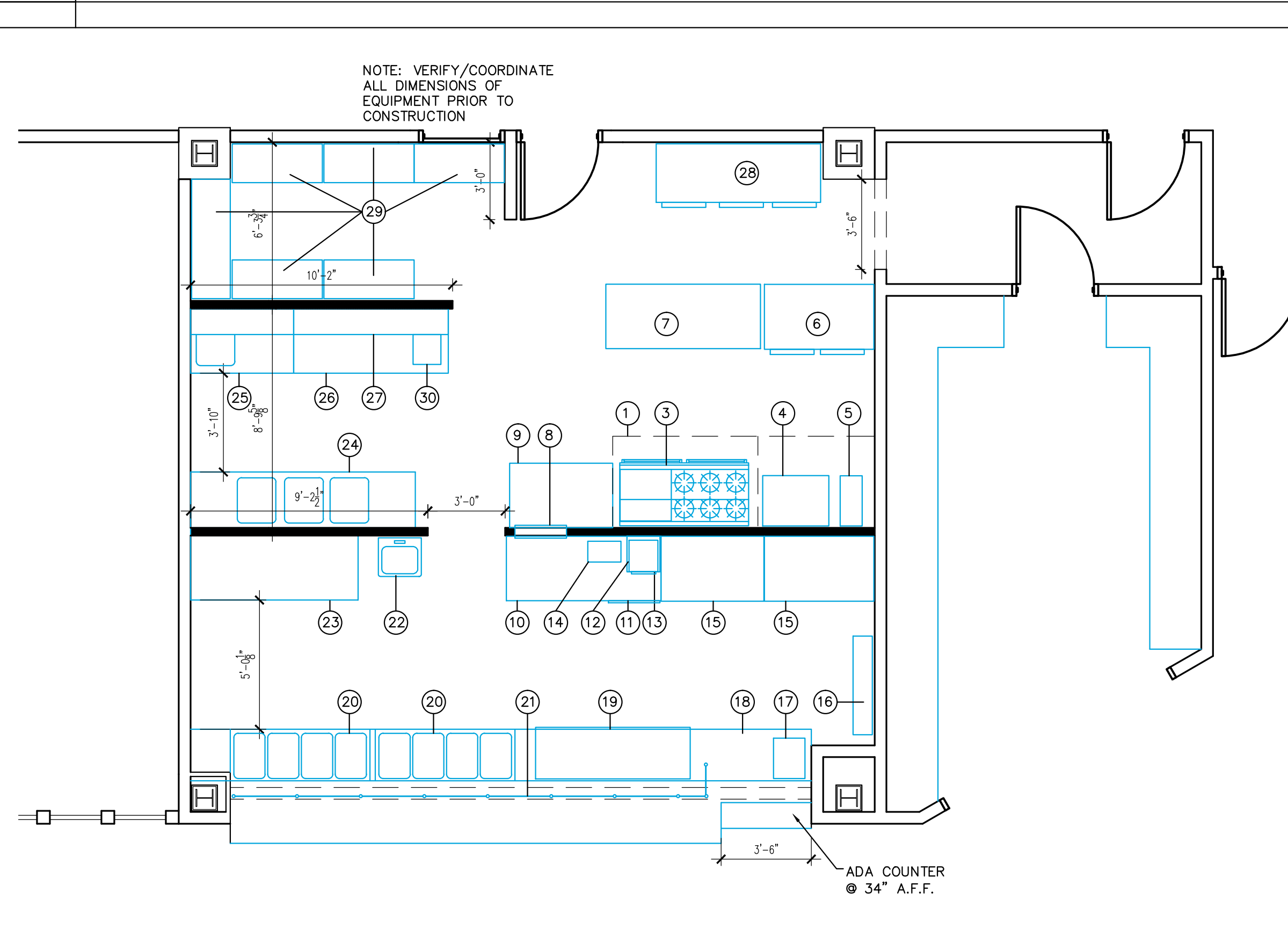

A12 FLOOR PLAN

1/4"=1'-0"