

**Gawron Turgeon ARCHITECTS**  
 29 Black Point Road  
 Scarborough, Maine 04074  
 www.gawronturgeon.com  
 207-883-6307 tel 207-883-0361 fax

**RED THREAD**  
 ONE CITY CENTER, FIRST FLOOR  
 PORTLAND, MAINE

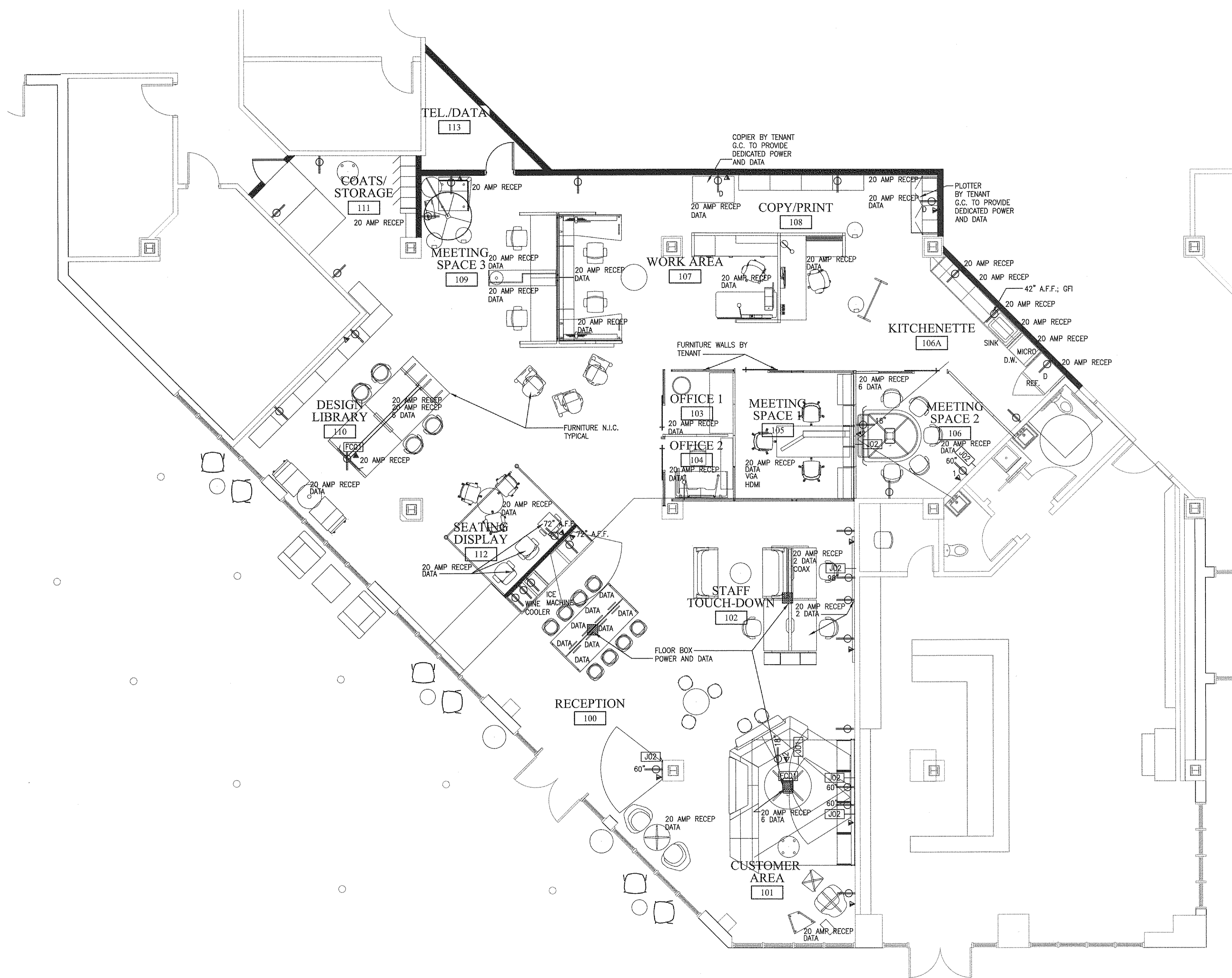

- POWER PLAN LEGEND**
- J01 LCD LOCATION (CHIEF PACS11) CUSTOM SIZE 1.25" CONDUIT STUBBED UP
  - J02 AV CREDENZA (NO RACK) 4 GA 1.25" CONDUIT STUBBED UP
  - FCD1 FLOOR CORE, WIREMOLD 8 AT CUSTOM SIZE 1.25" CONDUIT STUBBED UP

- ▼ TEL./DATA OUTLET - ONE PHONE/ONE DATA
- ▼ TEL./DATA OUTLET - 2 PHONE 2 DATA
- ⊕ DUPLEX OUTLET
- ⊕ DEDICATED DUPLEX OUTLET
- FLOOR BOX - POWER AND DATA - CORE DRILL REQUIRED
- RAISED FLOOR SYSTEM

- NOTES:**
1. CONFIRM THAT ALL EXISTING POWER AND DATA IS IN WORKING ORDER
  2. POWER AND DATA FOR TEL./DATA 113 TO BE COORDINATED W/ TENANT
  3. EXISTING POWER ON PERIMETER WALLS TO REMAIN AS IS
  4. VERIFY HEIGHT AND LOCATIONS OF DUPLEX OUTLETS & TEL./DATA IN FIELD
  5. COORDINATE ALL POWER AND DATA LOCATIONS WITH TENANTS FURNITURE & POWER REQUIREMENTS.
  6. ALL POWER AND DATA TO TEL./DATA 113 TO BE COORDINATED WITH THE TENANTS VENDOR.

**REVISIONS**

#	DATE	DESCRIPTION

DATE:	08.28.13
PROJECT #:	060413
DRAWN BY:	DLP
CHECKED BY:	SWG
DRAWING SCALE:	AS NOTED

**SHEET TITLE**  
 POWER PLAN  
 LEGEND / NOTES

**A200**

