

CONSTRUCTION LEGEND

- EXISTING PARTITIONS TO REMAIN
- NEW INTERIOR G.M.B. PARTITIONS-METAL STUDS, 16" O.C. W/ G.M.B. EACH SIDE OF STUD FROM FLOOR TO UNDER SIDE OF A.C.T.
- NEW DOOR (TENANT STANDARD)
- ROOM NAME & NUMBER

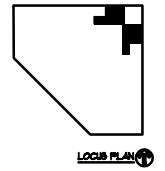

1 8TH FLOOR BATHROOMS
1/8" = 1'-0"

NO	DATE	REVISIONS



PROJECT
MEDICAL MUTUAL
INSURANCE COMPANY
ONE CITY CENTER-PORTLAND

TITLE
BATHROOM
NEW-8TH
SCALE
1/8"=1'-0"

Cubellis Associates Inc.
 428 Fore Street, 3rd Fl.
 Portland, ME 04101
 Tel: 207-874-2777 • Fax: 207-874-2775

DATE
 9/15/03

DRAWN BY
 JAT

CHECKED BY
 MW

SK-1
02278.01