

12 9TH FL OPPOSITE ELEVATOR & TYP. CONFERENCE ROOM GLAZING  
 1/2" = 1'-0"

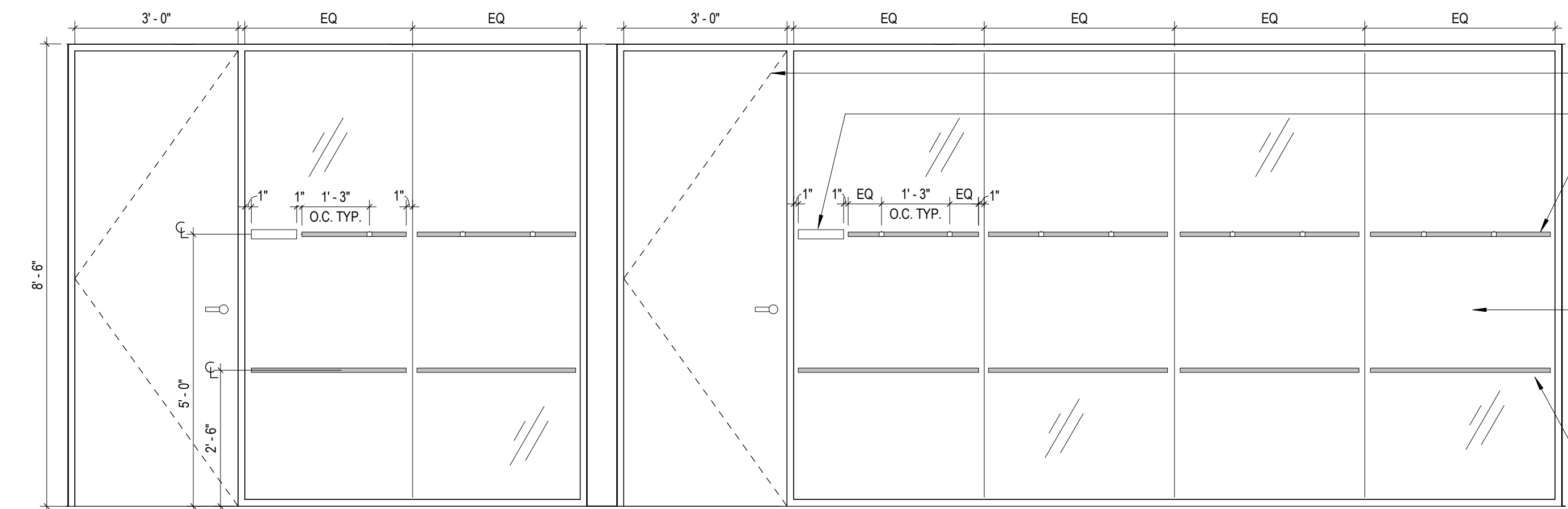

11 9TH FL TYP. PRIVATE OFFICE 225 & 120 GLAZING ELEVATION  
 1/2" = 1'-0"

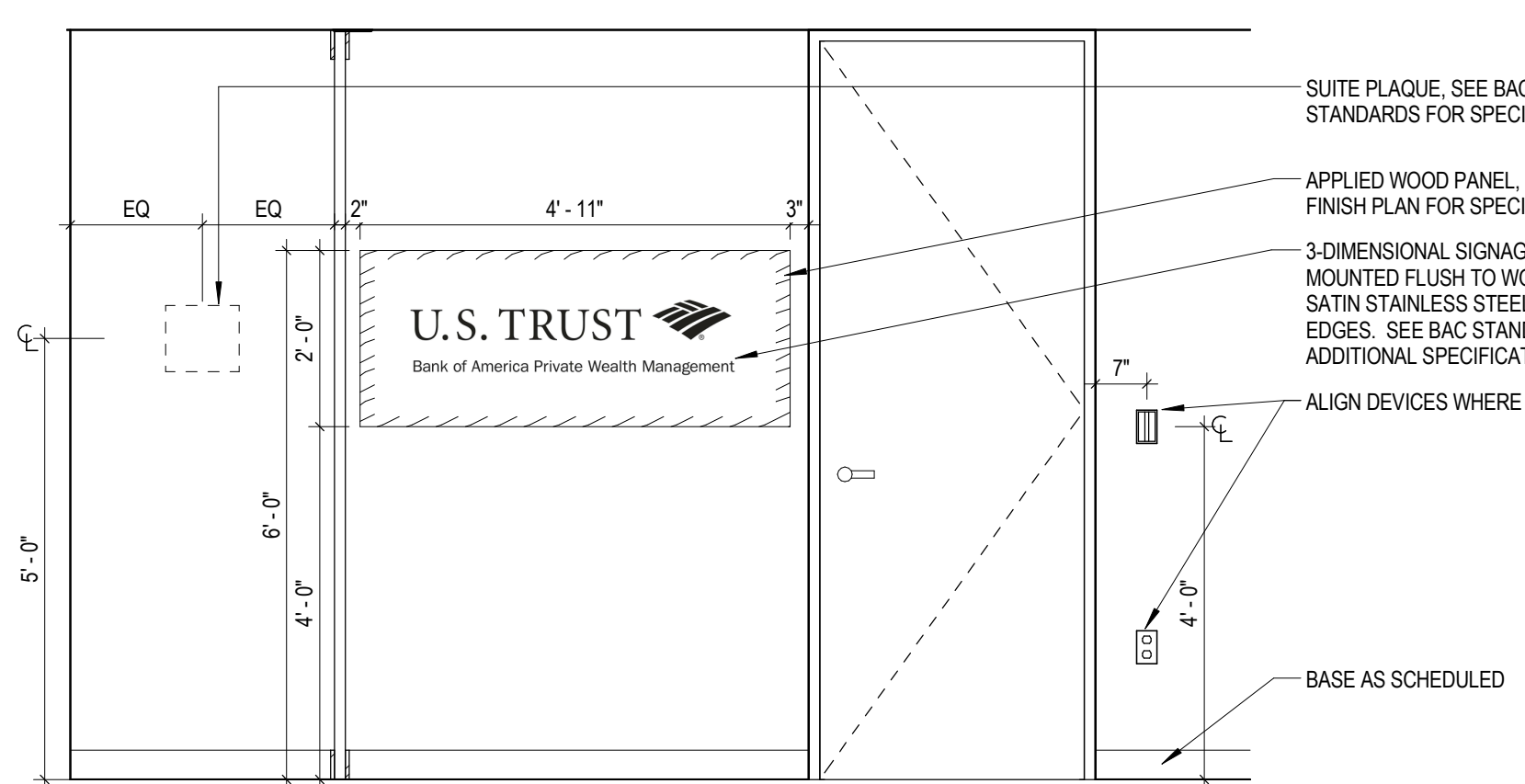

10 9TH FLOOR US TRUST LOGO  
 1/2" = 1'-0"

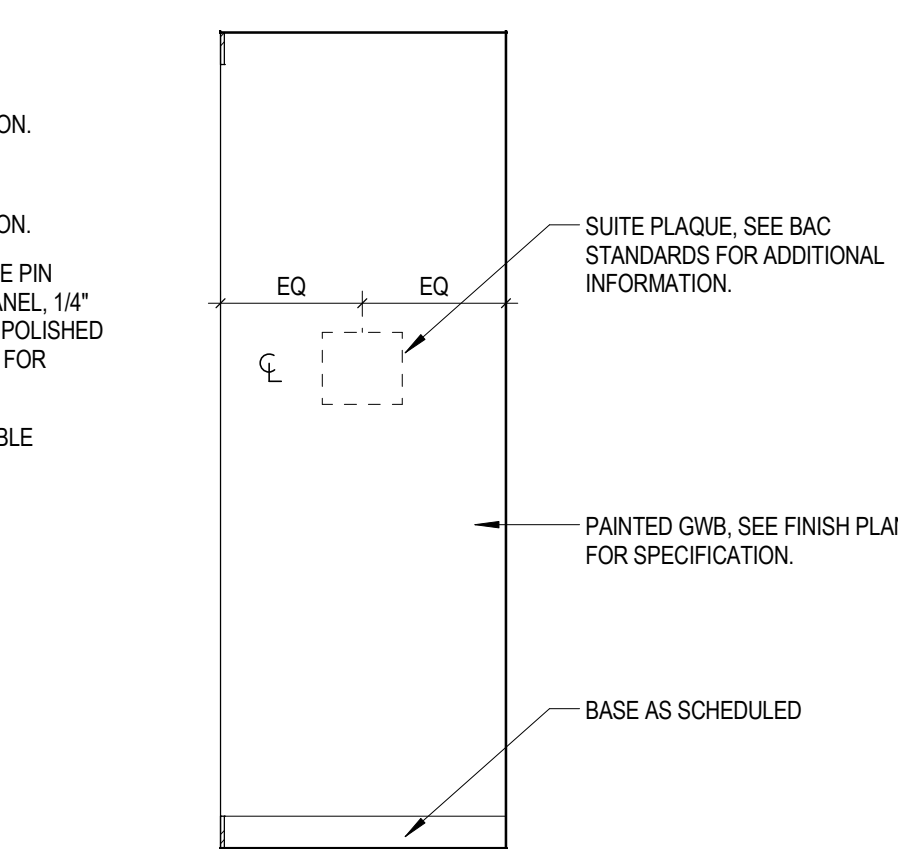

9 GBAM SUITE PLAQUE ELEVATION  
 1/2" = 1'-0"

REVISIONS

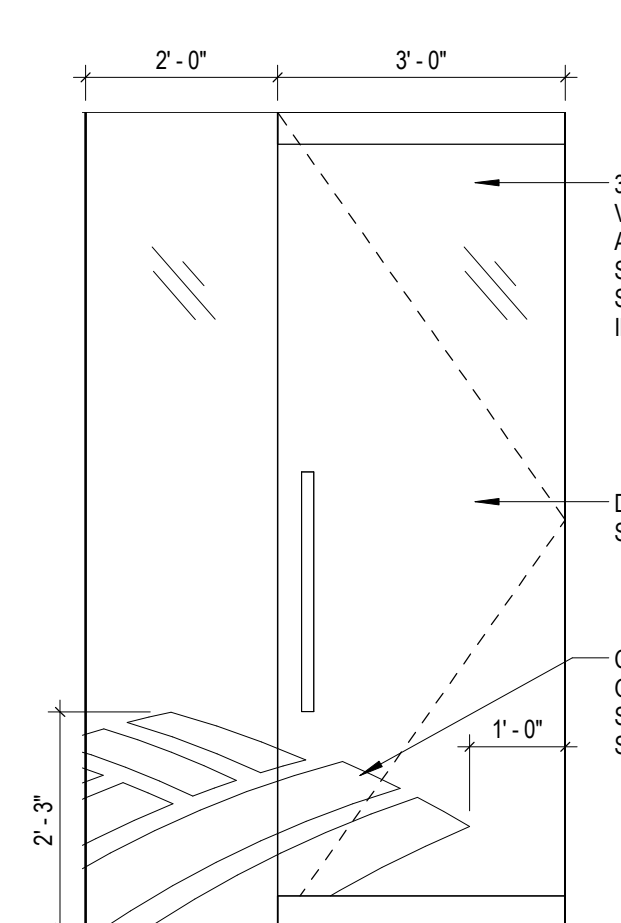

8 US TRUST SECONDARY ENTRANCE  
 1/2" = 1'-0"

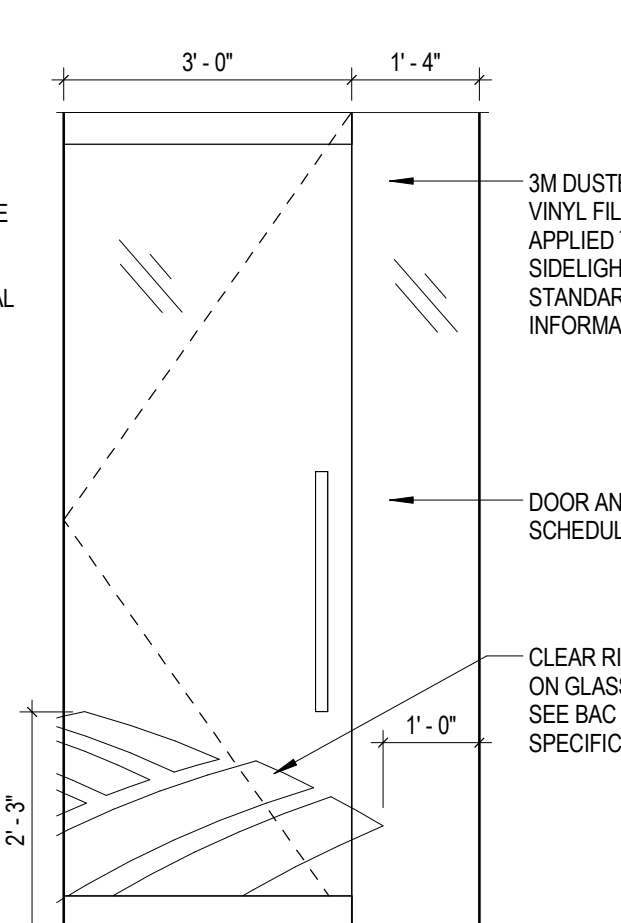

7 GBAM SECONDARY ENTRANCE  
 1/2" = 1'-0"

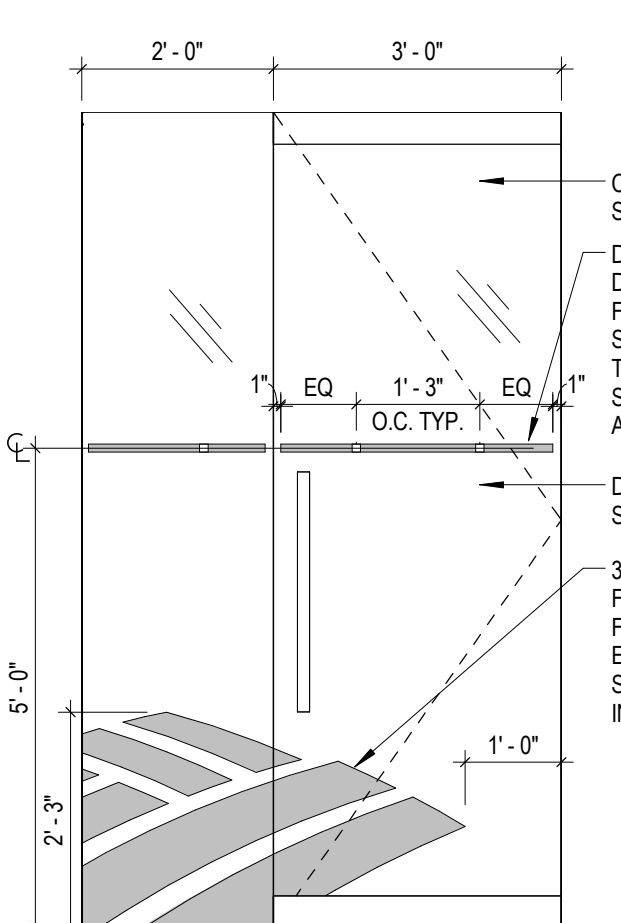

6 SHARED SUITE PRIMARY ENTRANCE  
 1/2" = 1'-0"

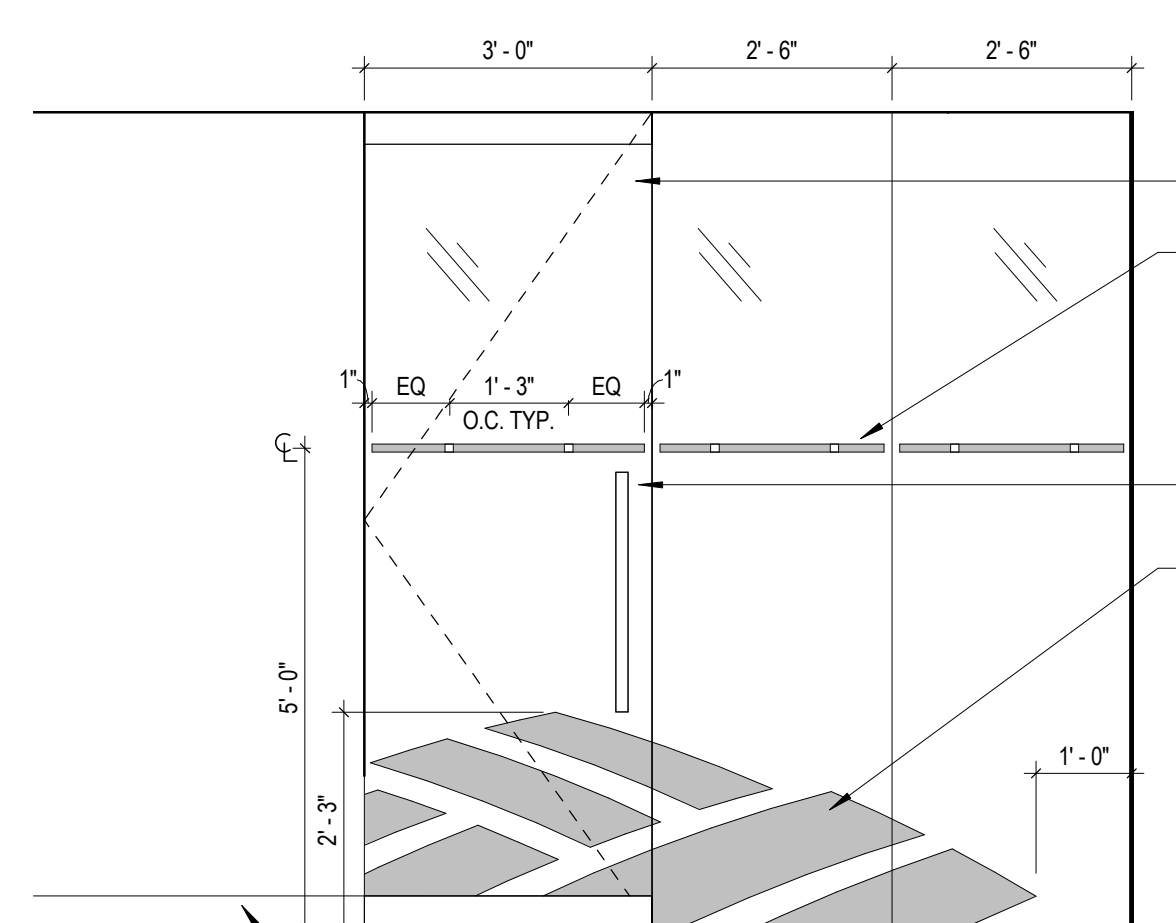

5 US TRUST PRIMARY ENTRANCE  
 1/2" = 1'-0"

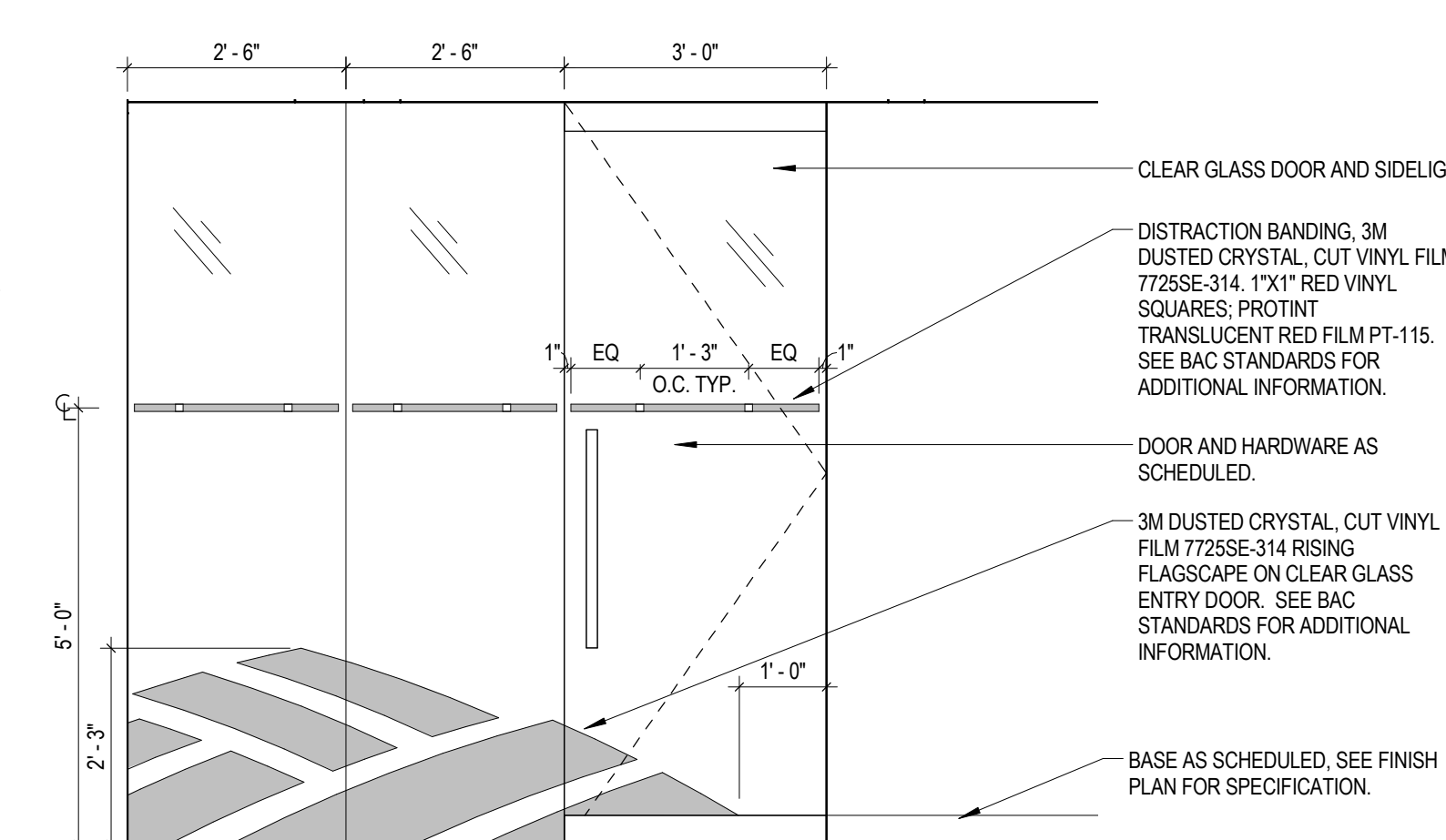

4 GBAM PRIMARY ENTRANCE  
 1/2" = 1'-0"

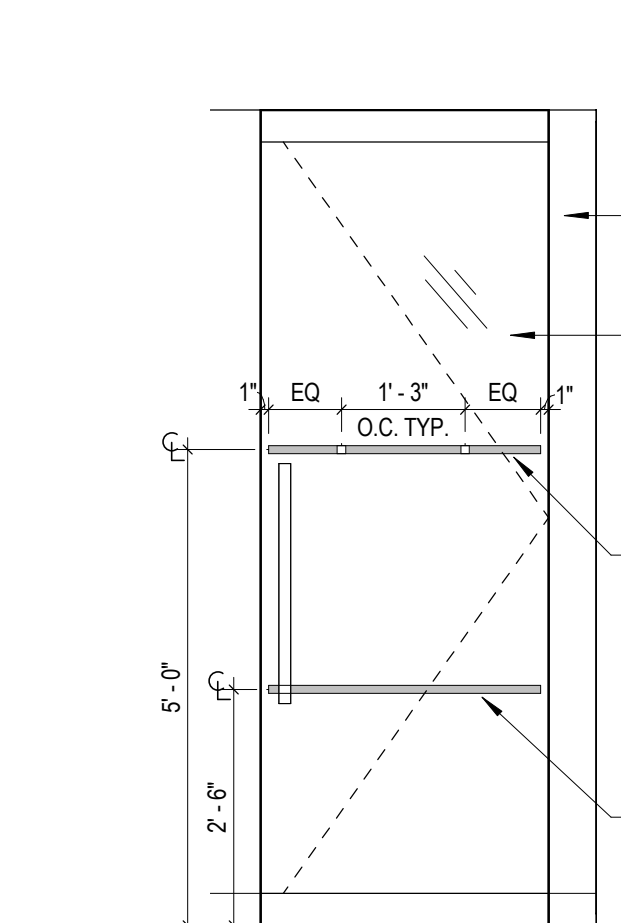

3 SHARED SUITE SECONDARY ENTRANCE  
 1/2" = 1'-0"

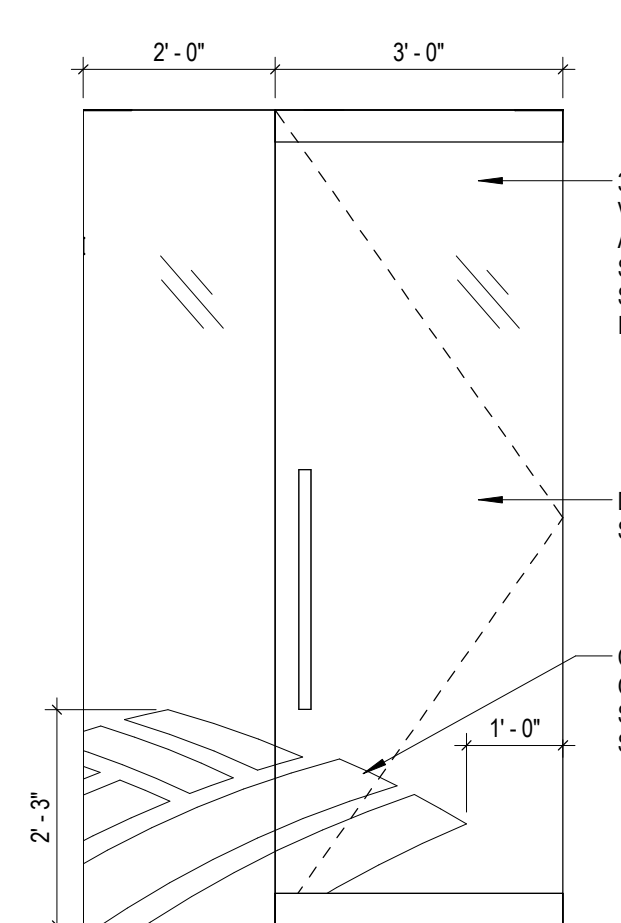

2 9TH FLOOR CORRIDOR ENTRANCE  
 1/2" = 1'-0"

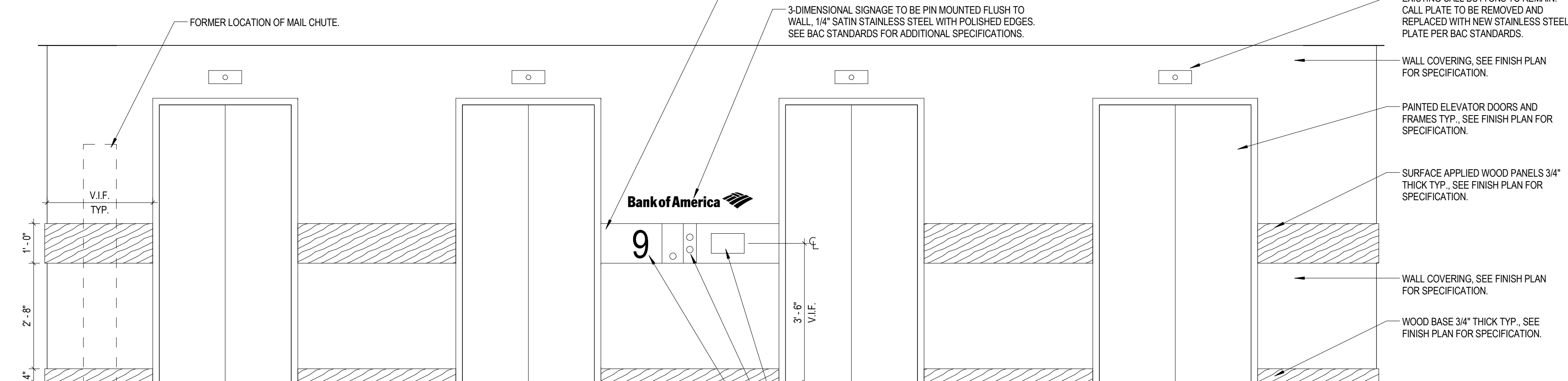

1 9TH FLOOR ELEVATOR LOBBY PRIMARY IDENTIFIER  
 1/2" = 1'-0"

**BANK OF AMERICA - 9TH & 10TH FLOORS**

BANK OF AMERICA  
 1 MONUMENT SQUARE  
 Portland, ME

**TITLE**  
 9TH FLOOR SIGNAGE ELEVATIONS

**DATE** May 11, 2015  
**JOB NO.** 15051.00

**DRAWING NO.** **A7.03**

ISSUED FOR CONSTRUCTION

C:\Revit\2015 Local Files\ME PORTLAND\_1\MONUMENT SQ\_09-10\_FP\_BAC\_CENTRAL\_mskdmlm01.dwg  
 DYER BROWN & ASSOCIATES, INC. ©2015 ALL RIGHTS RESERVED - PLOTTED: 5/11/2015 2:45:57 PM