

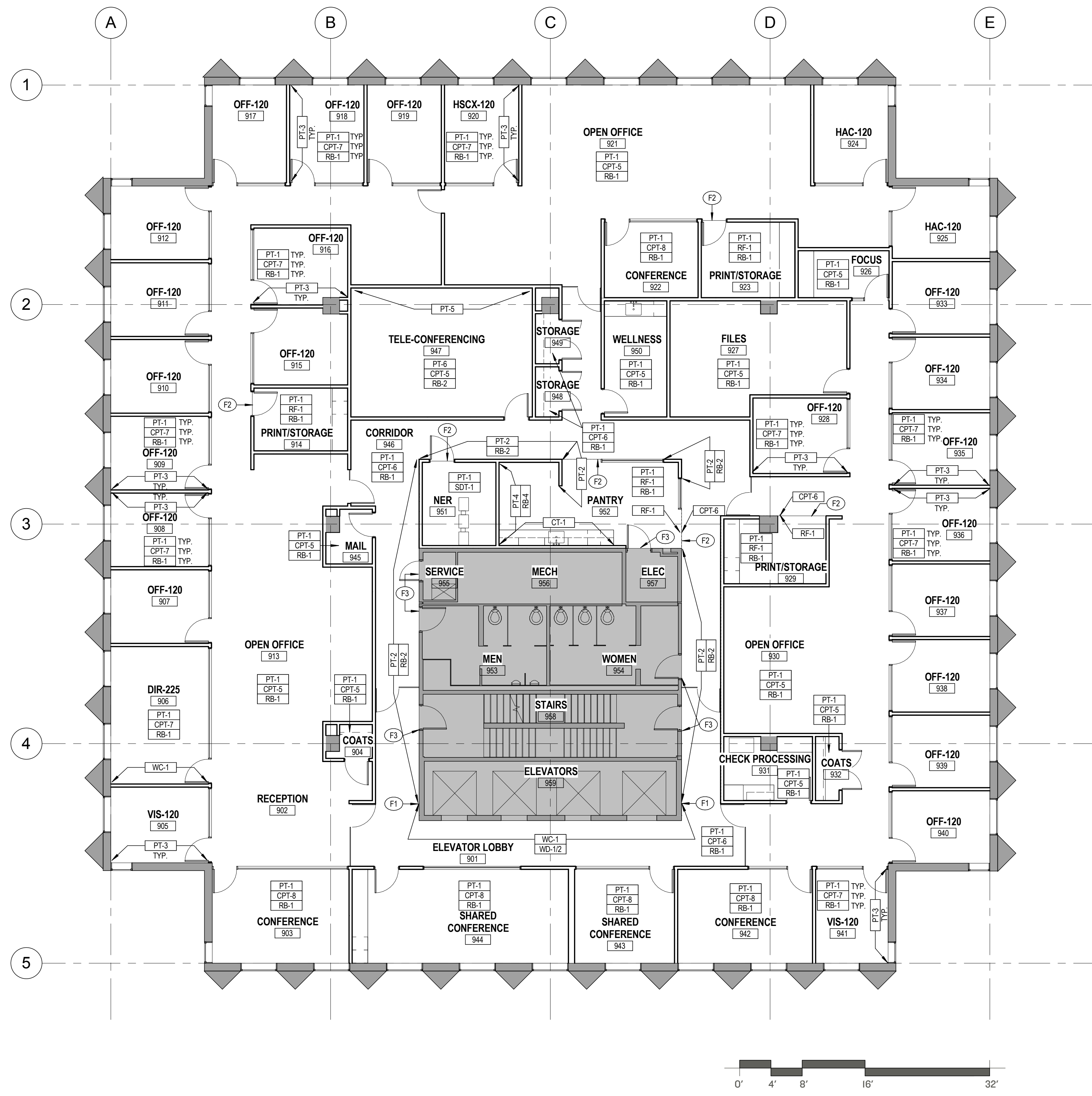

- FINISH PLAN NOTES**
- REFER TO FINISH LEGEND FOR FINISHES. SEE SPECIFICATION SHEETS FOR GENERAL MATERIAL SPECIFICATION REQUIREMENTS AND INSTALLATION INSTRUCTIONS.
 - SUBMIT SAMPLES OF FINISH MATERIALS AS SPECIFIED TO ARCHITECT FOR APPROVAL PRIOR TO INSTALLATION.
 - ALL SURFACE MOUNTED WIREMOLD, PLUGMOLD, CONDUIT AND PIPING SHALL BE PAINTED TO MATCH ADJACENT WALL.
 - REFER TO ELEVATIONS FOR SPECIAL PAINT OR WALLCOVERING DETAILS.
 - ALL SURFACE MOUNTED WIREMOLD, PLUGMOLD, CONDUIT AND PIPING SHALL BE PAINTED TO MATCH ADJACENT WALL.

FINISH PLAN KEYNOTES

NOTE	DESCRIPTION
F1	SEE ELEVATION 214 FOR WALL COVERINGS/PAINT TRANSITION.
F2	PROVIDE JOHNSONITE CTA-XX-C TRANSITION STRIP, COLOR: TBD, AT ALL CARPET TO RESILIENT FLOORING TRANSITIONS.
F3	EXISTING AND NEW CORE DOORS AND FRAMES TO BE PAINTED PT-2 SEMI-GLOSS.



FINISH LEGEND

FINISH ID	SPECIFICATION			REMARKS
	MFR	STYLE	COLOR	
CARPET				
CPT-1	TANDUS - TILE	DISTRICT II	059 COOL WATER	10TH FL FIELD CARPET THROUGHOUT - RANDOM INSTALL
CPT-2	TANDUS - TILE	DISTRICT II	059B COOL WATER	10TH FL ACCENT AT CORE CORRIDORS - RANDOM INSTALL
CPT-3	TANDUS - TILE	METRI	083 ICING	10TH FL PRIVATE OFFICES - MONOLITHIC INSTALL, RUN PATTERN DIRECTION FROM PERIMETER TO OFFICE FRONT
CPT-4	TANDUS - TILE	BOA COLOURSECTION	96348 COOL WATER	10TH FL CONFERENCE RMS./RECEPTION (BROADLOOM)
CPT-5	TANDUS - TILE	DISTRICT II	0790588 BROWN SATIN	9TH FL FIELD CARPET THROUGHOUT - RANDOM INSTALL
CPT-6	TANDUS - TILE	DISTRICT II	058 BROWN SATIN	9TH FL ACCENT AT CORE CORRIDORS - RANDOM INSTALL
CPT-7	TANDUS - TILE	METRI	WARM WEATHER	9TH FL PRIVATE OFFICES - MONOLITHIC INSTALL, RUN PATTERN DIRECTION FROM PERIMETER TO OFFICE FRONT
CPT-8	TANDUS - TILE	BOA COLOURSECTION	BROWN SATIN	9TH FL CONFERENCE RMS. (BROADLOOM)
RESILIENT FLOORING				
RF-1	FORBO	MARMOLEUM PIANO	3632 SEALION	9TH FL PRINT ROOMS, PANTRY
RF-2	FORBO	MARMOLEUM PIANO	3607 GREY DUSK	10TH FL PRINT ROOMS, PANTRY
SDT-1	FORBO	COLOREX SD	SD 150240 ETNA	9TH/10TH FL NER ROOM
RUBBER BASE				
RB-1	ARMSTRONG	COLOR INTEGRATED	#23 MILK	STRAIGHT @ CARPET; COVE @ RESILIENT - FIELD
RB-2	JOHNSONITE	TRADITIONAL	#31 ZEPHYR	STRAIGHT @ CARPET; COVE @ RESILIENT - CORE WALLS
RB-3	JOHNSONITE	TRADITIONAL	#194 ANTIQUE WHITE	STRAIGHT @ CARPET - ACCENT WALLS 9TH FL OFFICES
RB-4	JOHNSONITE	TRADITIONAL	#192 TIDEWATER	COVE @ RESILIENT - ACCENT WALL IN PANTRIES
RB-5	JOHNSONITE	TRADITIONAL	#21 PLATINUM	STRAIGHT @ CARPET - ACCENT WALLS 10TH FL OFFICES
WD-2	WOOD VENEER	KNOLL	V1 AMERICAN WALNUT	TO MATCH ARCHITECT'S SAMPLE
PAINT				
PT-1	BENJAMIN MOORE	EGGSHELL	DECORATOR'S WHITE	FIELD THROUGHOUT
PT-2	SHERWIN WILLIAMS	EGGSHELL FINISH	SW-7038 TONY TAUPE	CORE WALLS
PT-3	BENJAMIN MOORE	EGGSHELL FINISH	OC-1 NATURAL WICKER	ACCENT WALL @ 9TH FL OFFICES
PT-4	SHERWIN WILLIAMS	EGGSHELL FINISH	SW-6501 MATOU BLUE	ACCENT WALL @ PANTRIES
PT-5	BENJAMIN MOORE	EGGSHELL FINISH	AF-155 WEIMARANER	ACCENT @ TELEPRESENCE
PT-6	BENJAMIN MOORE	EGGSHELL FINISH	HC-172 REVERE PEWTER	FIELD @ TELEPRESENCE
PT-7	SHERWIN WILLIAMS	EGGSHELL HARMONY	SW-6246 NORTH STAR	ACCENT @ 10TH FL OFFICES
PT-8	WOLF GORDON	SCUFFMASTER	SM9739 SOLID METAL	ELEVATOR DOORS/FRAMES (PRODUCT ID: GOH 0981340)
WALL COVERING				
WC-1	KNOLL TEXTILES	BOND	WC1577/5 GRANITE	ELEVATOR LOBBIES
WD-1	WOOD VENEER	KNOLL	V1 AMERICAN WALNUT	TO MATCH ARCHITECT'S SAMPLE
WALL TILE				
CT-1	CROSSVILLE	BAC 4 METTA	1'X4' SILK	PANTRY BACKSPLASH; GROUT: LATICRETE 78 STERLING
SOLID SURFACE				
SS-1	CAMBRIA	QUARTZ SURFACING	SNOWDON WHITE	COUNTERTOPS @ PANTRIES AND WELLNESS ROOM
STONE				
ST-1		POLISHED MARBLE	CREMA MARFIL	CUSTOM CREDENZA CONF. RMS. 944 & 1003
PLASTIC LAMINATE				
PL-1	NEVAMAR	ARMORED PROTECTION	S603IT FOSSIL GRAY TEXTURED	9TH FL PANTRY CABINETRY
PL-2	WILSONART	PREMIUM	4830K-07 SATIN STAINLESS	10TH FL PANTRY CABINETRY
PL-3	FORMICA	MATTE	927-58 FOLKSTONE GRAY	PRINT ROOMS, WELLNESS CABINETRY
PL-4	WILSONART	MATTE	1573-60 FROSTY WHITE	PRINT ROOMS COUNTERTOPS
PL-5	WILSONART	PREMIUM AEON	7959K-78 HAPTON WALNUT	10TH FL CASHIER COUNTERTOPS
WINDOW TREATMENT				
WT-1	MECHOSYSTEMS	ECOVEIL	GREY1563	AT CONFERENCE ROOMS ONLY

REVISIONS

BANK OF AMERICA - 9TH & 10TH FLOORS

BANK OF AMERICA
1 MONUMENT SQUARE
Portland, ME

TITLE
9TH FLOOR FINISH PLAN

DATE May 11, 2015
JOB NO. 15051.00

DRAWING NO. **A5.09**

ISSUED FOR CONSTRUCTION

C:\Revit\2015 Local Files\ME PORTLAND_1 MONUMENT SQ_09-10_FP_BAC_CENTRAL_mdklinen.rvt

DYER BROWN & ASSOCIATES, INC. ©2015 ALL RIGHTS RESERVED - PLOTTED: 5/11/2015 2:45:24 PM

1 9th FLOOR FINISH PLAN
1/8" = 1'-0"

