

GENERAL NOTES

- BEFORE BEGINNING WORK AT THE SITE, AND THROUGHOUT THE COURSE OF THE WORK, INSPECT AND VERIFY THE LOCATION AND CONDITION OF EVERY ITEM AFFECTED BY THE WORK UNDER THIS CONTRACT AND REPORT DISCREPANCIES TO ARCHITECT BEFORE BEGINNING WORK RELATED TO THAT BEING INSPECTED.
- THE ARCHITECTURAL DRAWINGS SHOW PRINCIPAL AREAS WHERE WORK MUST BE ACCOMPLISHED UNDER THIS CONTRACT. INCIDENTAL WORK MAY ALSO BE NECESSARY IN AREAS NOT SHOWN ON THE ARCHITECTURAL DRAWINGS DUE TO CHANGES AFFECTING EXISTING MECHANICAL, ELECTRICAL, PLUMBING, OR OTHER SYSTEMS. SUCH INCIDENTAL WORK IS ALSO PART OF THIS CONTRACT. INSPECT THOSE AREAS, ASCERTAIN WORK NEEDED, AND DO THAT WORK IN ACCORDANCE WITH THE CONTRACT REQUIREMENTS, AT NO ADDITIONAL COST.
- DO NOT DRILL OR CUT EXISTING FLOOR JOISTS, BEAMS, COLUMNS, OR OTHER STRUCTURAL MEMBERS UNLESS SPECIFICALLY INDICATED.
- PROTECT EXISTING WORK TO REMAIN FROM DAMAGE.
- REPAIR, PATCH, AND FINISH, OR REFINISH AS APPLICABLE, TO MATCH ADJACENT EXISTING FINISHES, THOSE EXISTING SURFACES DAMAGED OR NEWLY EXPOSED DURING PERFORMANCE OF THE WORK. PATCH OPENINGS IN EXISTING WALLS LEFT BY REMOVAL OF EXISTING ELECTRICAL BOXES. SEE ELECTRICAL DRAWINGS FOR LOCATIONS AND QUANTITIES.
- PATCH EXISTING WALL SURFACES AS NEEDED TO PROVIDE A SMOOTH SURFACE FOR FINISHES.
- EXCEPT IN SPACES WHERE NO WORK UNDER THIS CONTRACT IS REQUIRED, ENCLOSE EXISTING AND NEW CONDUITS, DUCTS, PIPES, AND SIMILAR ITEMS IN FURRING WHERE SUCH ITEMS PASS THROUGH FINISHED SPACES WHETHER OR NOT FURRING IS INDICATED. INSULATE IN UNHEATED SPACES.
- WHERE CONDUITS, WIRES, PIPES, AND SIMILAR ITEMS ARE TO BE INSTALLED IN EXISTING WALLS OR PARTITIONS, NEATLY CHASE THE WALLS OR PARTITIONS, INSTALL THE ITEMS, AND PATCH THE WALLS OR PARTITIONS TO MAKE THE INSTALLATION NOT DISCERNIBLE IN THE FINISHED WORK.
- WHERE "MATCH EXISTING" IS INDICATED, NEW CONSTRUCTION OR FINISHES, AS APPROPRIATE TO THE NOTE, SHALL MATCH THE EXISTING IN EVERY PARTICULAR.
- DIMENSIONS ARE TO FINISH WALL SURFACE AND TO OPENING CENTERLINE UNLESS NOTED OTHERWISE.
- FURNITURE SHOWN ON PLANS IS BY TENANT.

MECHANICAL NOTES

- PROVIDE MODIFICATIONS TO EXISTING HVAC SYSTEM AS NEEDED TO SERVE RENOVATED SPACES.
- LOCATIONS OF HVAC ELEMENTS IN PLAN ARE SUGGESTED. FINAL LOCATIONS, TYPES, AND SIZES OF DIFFUSERS, GRILLES, THERMOSTATS, AND OTHER ELEMENTS TO BE DETERMINED BY HVAC CONTRACTOR.

PLUMBING NOTES

- PROVIDE MODIFICATIONS TO EXISTING SUPPLY AND WASTE SYSTEMS AS NEEDED TO SERVE RENOVATED SPACES: BREAK ROOM KITCHEN SINK AND DISHWASHER.

ELECTRICAL NOTES

- PROVIDE MODIFICATIONS TO EXISTING ELECTRICAL SYSTEM AS NEEDED TO SERVE RENOVATED SPACES WITH LIGHTING AND POWER SYSTEMS.
- PROVIDE JUNCTION BOXES WITH FULL STRING FOR TELEPHONE AND DATA CONNECTIONS. TELEPHONE AND DATA WIRING AND TERMINATIONS TO BE BY TENANT'S VENDOR.
- EXISTING POWER AND DATA OUTLET LOCATIONS MAY REMAIN IN SERVICE IF LOCATION IS APPROPRIATE. REMOVE UNUSED JUNCTION BOXES.
- PROVIDE LIGHTING LAYOUT AS SHOWN. REUSE EXISTING LIGHT FIXTURES, RE-LAMP AND RE-BALLAST EXISTING FIXTURES TO BUILDING STANDARD. PROVIDE NEW FIXTURES TO MATCH EXISTING AS NEEDED. LOCATE NEW FIXTURES IN ENCLOSED ROOMS.

NEW WORK KEYNOTES -- THIS SHEET ONLY

- N01 REINSTALL EXISTING WINDOW BLINDS.
- N02 FRAME IN AND FINISH EXISTING WALL OPENING.
- N03 RELOCATE ELECTRICAL PANEL INTO ELECTRICAL ROOM.

PARTITION TYPES

- P1 3 5/8" STEEL STUD FRAMING 16" O.C.
5/8" GYPSUM BOARD BOTH SIDES
ACOUSTIC INSULATION FULL HEIGHT
PARTITION HEAD AT 9'-0" A.F.F. - BRACE TO STRUCTURE ABOVE
ACOUSTICAL SEALANT AT FLOOR TRACK
- P2 3 5/8" STEEL STUD FRAMING 16" O.C.
5/8" GYPSUM BOARD BOTH SIDES
ACOUSTIC INSULATION FULL HEIGHT
PARTITION HEAD UP TO CEILING GRID - ATTACH TO GRID
ACOUSTICAL SEALANT AT FLOOR TRACK

NOTE: PARTITIONS AND WALLS NOT OTHERWISE NOTED BY PARTITION TYPE OR BY NEW WORK KEYNOTE ARE EXISTING TO REMAIN. PATCH AS NECESSARY AND PAINT.

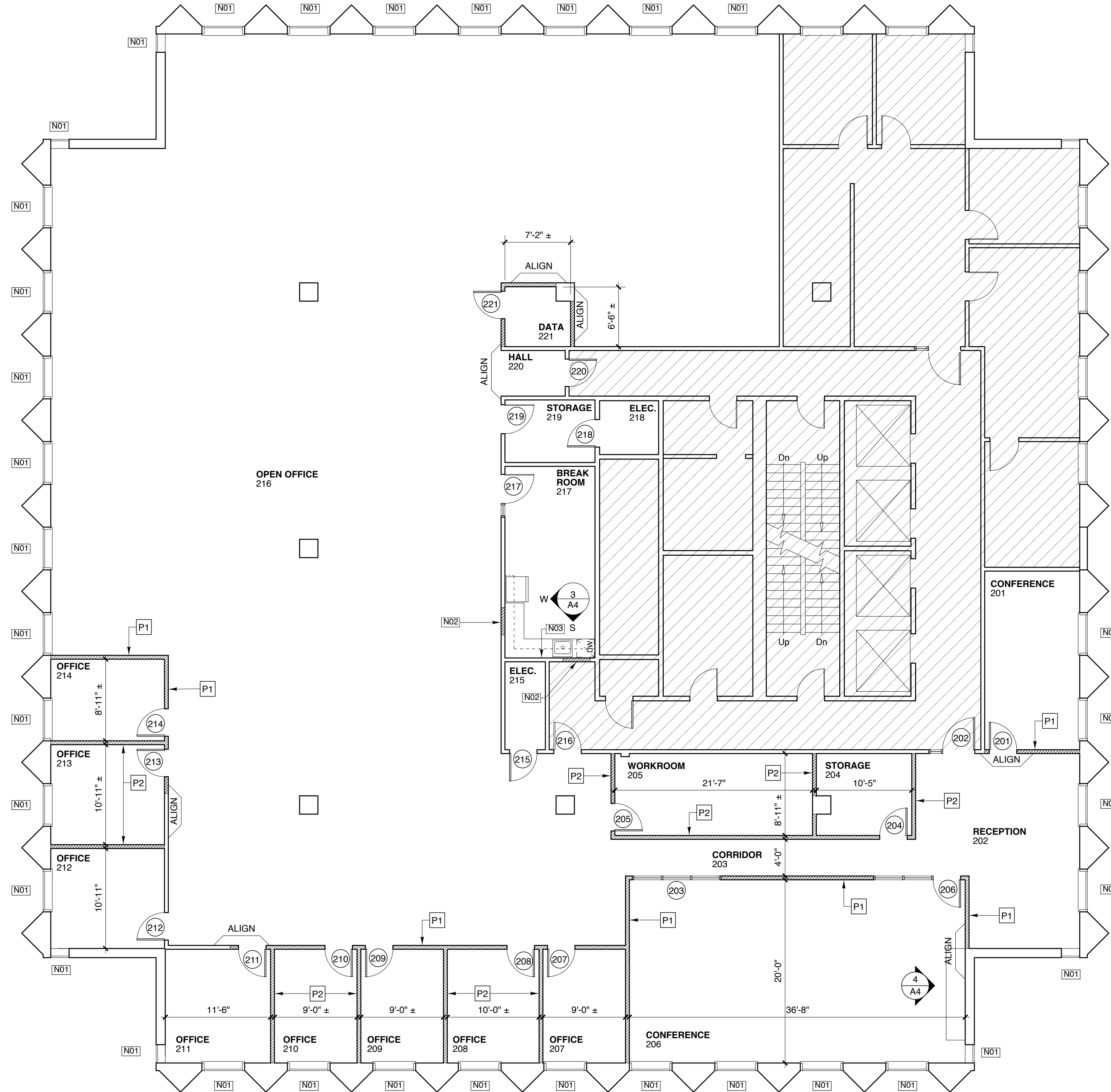

1 FLOOR PLAN
SCALE: 1/8" = 1'-0"
2' 4' 8' 16'

PARTITIONS/WALLS KEY

 EXISTING TO REMAIN
 NEW PARTITION/WALL
 AREA N.I.C.

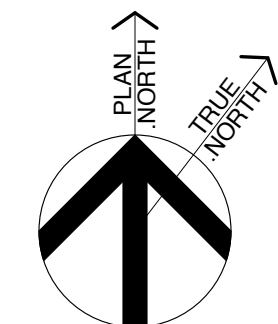

Michael Charek Architects

25 Hartley Street
Portland, Maine 04103
(207) 761-0556



Offices for Professional Disability Associates

Second Floor
One Monument Square
Portland, Maine

Title

FLOOR PLAN

Scale: 1/8" = 1'-0"

Date: 7/10/13

Revisions

Sheet

A1