

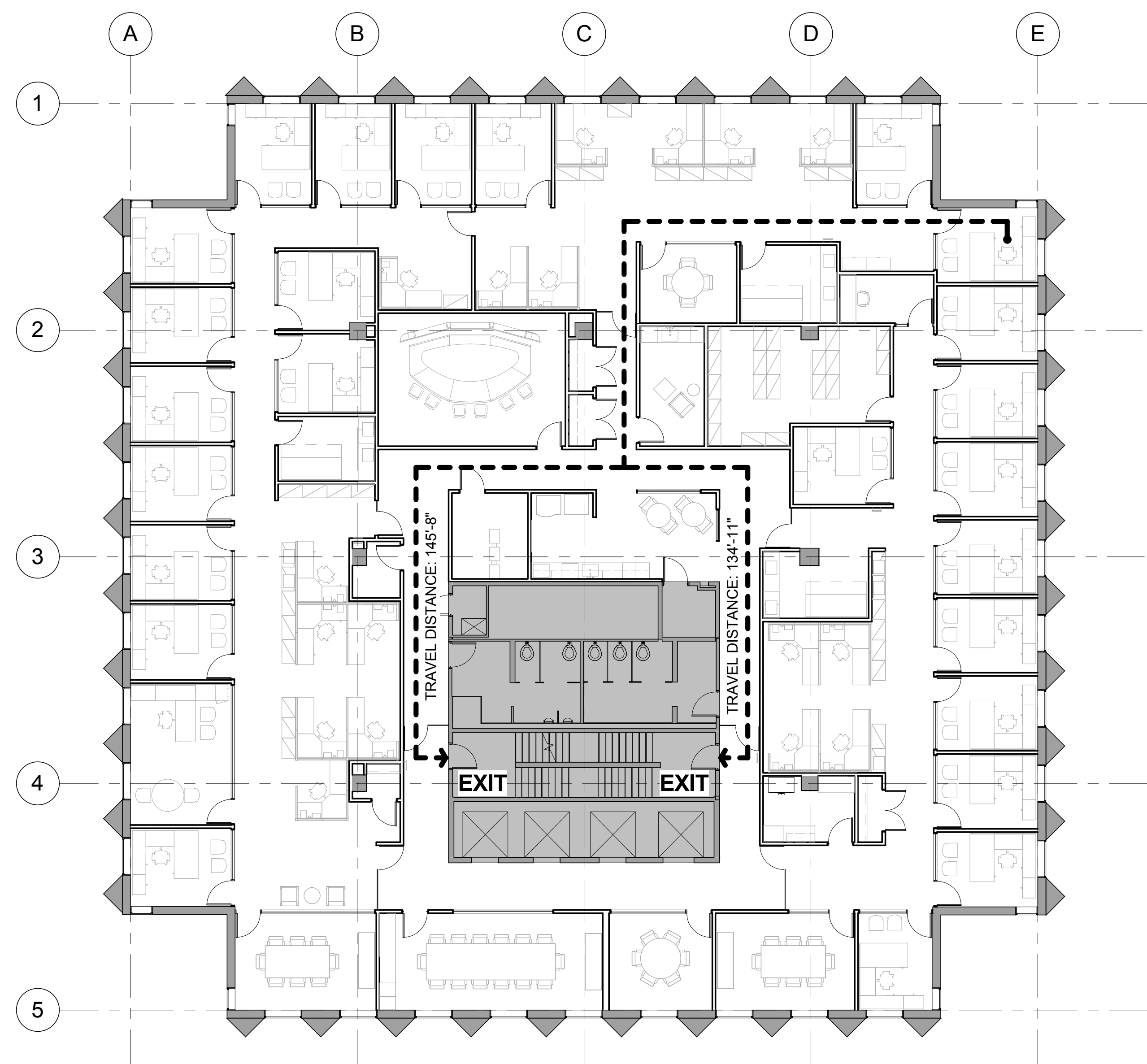

*Brent D. Zeigler*

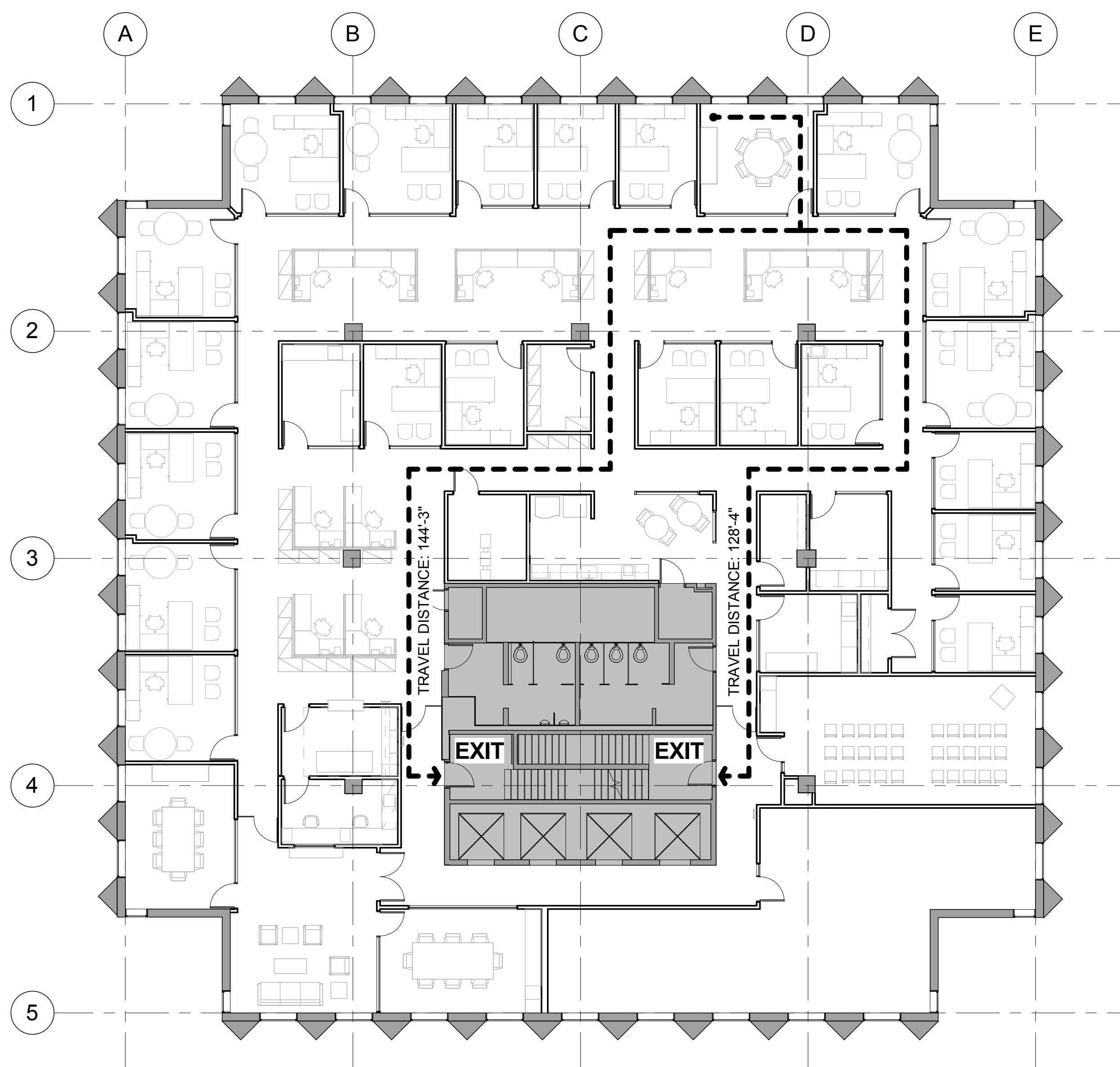

1 9th FLOOR LIFE SAFETY  
3/32" = 1'-0"



2 10th FLOOR LIFE SAFETY  
3/32" = 1'-0"

CODE SUMMARY - 9TH FLOOR		
<b>PROJECT:</b>	BANK OF AMERICA 1 MONUMENT SQUARE PORTLAND, ME 04101	
<b>APPLICABLE CODES:</b>	MAINE UNIFORM BUILDING AND ENERGY CODE 2010 ADA STANDARDS FOR ACCESSIBLE DESIGN	
<b>PROJECT DEFINITION:</b>	TENANT IMPROVEMENT CONSTRUCTION DOCUMENTS	
<b>USE GROUP:</b>	CLASS 'B' - BUSINESS	
<b>CONSTRUCTION CLASSIFICATION:</b>	TYPE: EXISTING - UNCHANGED	
<b>EGRESS OCCUPANT LOAD:</b>	9TH FLOOR TENANT: 12,332 GSF	OFFICE: 12,332 GSF (123 OCCUPANTS)
	TOTAL OCCUPANCY = 123 OCCUPANTS	
<b>EGRESS FROM PROJECT AREA:</b>	<b>REQUIRED</b>	<b>PROVIDED</b>
EXITS FROM FLOOR:	2	2
MAX TRAVEL:	300'	134'-11"
PASSAGE WIDTH:	44" MIN.	44" MIN.
<b>FIRE RESISTANCE RATING FROM CHAP. 7:</b>	<b>REQUIRED</b>	<b>PROVIDED</b>
EXIT ENCLOSURES:	2HR	EXISTING - N/A
SHAFTS:	2HR	EXISTING - N/A
EXIT ACCESS CORRIDORS: 0HR*	EXISTING - N/A	
	* BUILDING IS FULLY SPRINKLERED	
<b>SPRINKLER SYSTEM:</b>	YES <input checked="" type="checkbox"/>	NO <input type="checkbox"/>
<b>FIRE ALARM SYSTEM:</b>	YES <input checked="" type="checkbox"/>	NO <input type="checkbox"/>

CODE SUMMARY - 10TH FLOOR		
<b>PROJECT:</b>	BANK OF AMERICA 1 MONUMENT SQUARE PORTLAND, ME 04101	
<b>APPLICABLE CODES:</b>	MAINE UNIFORM BUILDING AND ENERGY CODE 2010 ADA STANDARDS FOR ACCESSIBLE DESIGN	
<b>PROJECT DEFINITION:</b>	TENANT IMPROVEMENT CONSTRUCTION DOCUMENTS	
<b>USE GROUP:</b>	CLASS 'B' - BUSINESS	
<b>CONSTRUCTION CLASSIFICATION:</b>	TYPE: EXISTING - UNCHANGED	
<b>EGRESS OCCUPANT LOAD:</b>	10TH FLOOR TENANT: 12,332 GSF	OFFICE: 12,332 GSF (123 OCCUPANTS)
	TOTAL OCCUPANCY = 123 OCCUPANTS	
<b>EGRESS FROM PROJECT AREA:</b>	<b>REQUIRED</b>	<b>PROVIDED</b>
EXITS FROM FLOOR:	2	2
MAX TRAVEL:	300'	128'-4"
PASSAGE WIDTH:	44" MIN.	44" MIN.
<b>FIRE RESISTANCE RATING FROM CHAP. 7:</b>	<b>REQUIRED</b>	<b>PROVIDED</b>
EXIT ENCLOSURES:	2HR	EXISTING - N/A
SHAFTS:	2HR	EXISTING - N/A
EXIT ACCESS CORRIDORS: 0HR*	EXISTING - N/A	
	* BUILDING IS FULLY SPRINKLERED	
<b>SPRINKLER SYSTEM:</b>	YES <input checked="" type="checkbox"/>	NO <input type="checkbox"/>
<b>FIRE ALARM SYSTEM:</b>	YES <input checked="" type="checkbox"/>	NO <input type="checkbox"/>

REVISIONS

**BANK OF AMERICA - 9TH & 10TH FLOORS**

BANK OF AMERICA  
1 MONUMENT SQUARE  
Portland, ME

TITLE  
CODE SUMMARY

DATE JOB NO.  
May 11, 2015 15051.00

DRAWING NO. **A0.06**

ISSUED FOR CONSTRUCTION