

DISPLAY THIS CARD ON PRINCIPAL FRONTAGE OF WORK CITY OF PORTLAND

BUILDING INSPECTION

PERMIT

Please Read Application And Notes, If Any, Attached

PERMIT ISSUED
Permit Number: 080538
JUN 30 2008
CITY OF PORTLAND

This is to certify that 386 FORE STREET LLC
has permission to Outside Dining/Three picnic tables, 68 sq ft
AT 386 FORE ST PORTLAND, OR 97204

provided that the person or persons in firm or operation accepting this permit shall comply with all of the provisions of the Statutes of the State and of the Ordinances of the City of Portland regulating the construction, maintenance and use of buildings and structures, and of the application on file in this department.

Apply to Public Works for street line and grade if nature of work requires such information.

Verification of inspection must be obtained and written permission procured before this building or part thereof is occupied or otherwise closed-in. 4
YOUR NOTICE IS REQUIRED

A certificate of occupancy must be procured by owner before this building or part thereof is occupied.

OTHER REQUIRED APPROVALS

Fire Dept. _____
Health Dept. _____
Appeal Board _____
Other _____
Department Name

Carrie Bonke 5/27/08
Director - Building & Inspection Services

PENALTY FOR REMOVING THIS CARD

City of Portland, Maine - Building or Use Permit Application

389 Congress Street, 04101 Tel: (207) 874-8703, Fax: (207) 874-8716

Permit No: 08-0538	Issue Date:	CBL: 032 J001001
-----------------------	-------------	---------------------

Location of Construction: 386 FORE ST	Owner Name: 386 FORE STREET LLC	Owner Address: PO BOX 7225	Phone: 772-6579
Business Name:	Contractor Name:	Contractor Address:	Phone:
Lessee/Buyer's Name	Phone:	Permit Type: Outdoor Seating	Zone: B-3

Past Use: Commercial - Beals Ice Cream - called 12 Moulton St.	Proposed Use: Commercial - Beals Ice Cream Outside Dining/Three picnic tables. 68 square feet	Permit Fee: \$216.00	Cost of Work: \$0.00	CEO District: 1
Proposed Project Description: Outside Dining/Three picnic tables. 68 square feet.		FIRE DEPT: <input type="checkbox"/> Approved <input type="checkbox"/> Denied	INSPECTION: Use Group: A2 Type: outdoor dining Signature: JMB 5/27/08	
		PEDESTRIAN ACTIVITIES DISTRICT (P.A.D.) Action: <input type="checkbox"/> Approved <input type="checkbox"/> Approved w/Conditions <input type="checkbox"/> Denied Signature: Date:		

Permit Taken By: lmd	Date Applied For: 05/20/2008	Zoning Approval
-------------------------	---------------------------------	------------------------

- This permit application does not preclude the Applicant(s) from meeting applicable State and Federal Rules.
- Building permits do not include plumbing, septic or electrical work.
- Building permits are void if work is not started within six (6) months of the date of issuance. False information may invalidate a building permit and stop all work..

Special Zone or Reviews	Zoning Appeal	Historic Preservation
<input type="checkbox"/> Shoreland <input type="checkbox"/> Wetland <input type="checkbox"/> Flood Zone <input type="checkbox"/> Subdivision <input type="checkbox"/> Site Plan Maj <input type="checkbox"/> Minor <input type="checkbox"/> MM <input type="checkbox"/>	<input type="checkbox"/> Variance <input type="checkbox"/> Miscellaneous <input type="checkbox"/> Conditional Use <input type="checkbox"/> Interpretation <input type="checkbox"/> Approved <input type="checkbox"/> Denied	<input type="checkbox"/> Not in District or Landmark <input type="checkbox"/> Does Not Require Review <input type="checkbox"/> Requires Review <input type="checkbox"/> Approved <input type="checkbox"/> Approved w/Conditions <input type="checkbox"/> Denied
Date: <i>5/27/08</i>	Date:	Date:

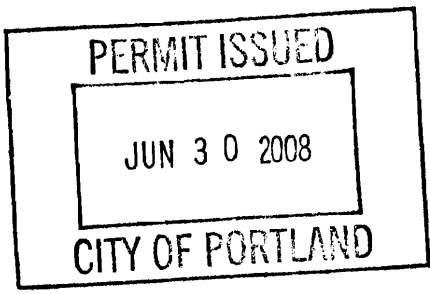

CERTIFICATION

I hereby certify that I am the owner of record of the named property, or that the proposed work is authorized by the owner of record and that I have been authorized by the owner to make this application as his authorized agent and I agree to conform to all applicable laws of this jurisdiction. In addition, if a permit for work described in the application is issued, I certify that the code official's authorized representative shall have the authority to enter all areas covered by such permit at any reasonable hour to enforce the provision of the code(s) applicable to such permit.

SIGNATURE OF APPLICANT	ADDRESS	DATE	PHONE
RESPONSIBLE PERSON IN CHARGE OF WORK, TITLE		DATE	PHONE

COPY-SENT 6/12/08

CITY OF PORTLAND
DEPARTMENT OF PLANNING & URBAN DEVELOPMENT
 389 Congress Street
 Portland, Maine 04101

INVOICE FOR PERMIT FEES

Application No: 8-0538	Applicant: 386 FORE STREET LLC
Project Name: Outside Dining/Three picnic tables	Location: 386 FORE ST
CBL: 032 J001001	Development Type:
Invoice Date: 05/27/2008	

Previous Balance	-	Payment Received	+	Current Fees	-	Current Payment	=	Total Due	Payment Due Date
\$0.00		\$0.00		\$216.00		\$0.00		\$216.00	On Receipt

First Billing

Previous Balance	\$0.00
-------------------------	---------------

Fee Description	Qty	Fee/Deposit Charge
Outside Seating Sidewalk	68	\$136.00
Outside Seating	1	\$80.00
		<u>\$216.00</u>
Total Current Fees:	+	\$216.00
Total Current Payments:	-	\$0.00
Amount Due Now:		\$216.00

Detach and remit with payment

Bill to: 386 FORE STREET LLC
 PO BOX 7225
 PORTLAND, ME 04112

CBL 032 J001001
Application No: 8-0538
Invoice Date: 05/27/2008
Invoice No: 31178
Total Amt Due: \$216.00
Payment Amount:

Make checks payable to the *City of Portland*, ATTN: Inspections, 3rd Floor, 389 Congress Street, Portland, ME 04101.

City of Portland, Maine - Building or Use Permit

389 Congress Street, 04101 Tel: (207) 874-8703, Fax: (207) 874-8716

Permit No: 08-0538	Date Applied For: 05/20/2008	CBL: 032 J001001
------------------------------	--	----------------------------

Location of Construction: 386 FORE ST	Owner Name: 386 FORE STREET LLC	Owner Address: PO BOX 7225	Phone: () 772-6579
Business Name:	Contractor Name:	Contractor Address:	Phone:
Lessee/Buyer's Name	Phone:	Permit Type: Outdoor Seating	

Proposed Use: Commercial - Beals Ice Cream Outside Dining/Three picnic tables. 68 square feet	Proposed Project Description: Outside Dining/Three picnic tables. 68 square feet.
---	---

Dept: Zoning	Status: Approved	Reviewer: Marge Schmuckal	Approval Date: 05/27/2008
Note:	Ok to Issue: <input checked="" type="checkbox"/>		
Dept: Building	Status: Approved with Conditions	Reviewer: Jeanine Bourke	Approval Date: 05/27/2008
Note:	Ok to Issue: <input checked="" type="checkbox"/>		
1) The outside dining permit is approved for the area delineated at the inspection and stated on the permit, and must be kept on site. THIS PERMIT MUST BE RENEWED ANNUALLY 2) This permit approves outside seating only. Any food, alcohol or entertainment in this space requires licensing approvals from the City Clerk. 3) The tables and chairs must not block any means of egress of any building, even during storage.			

Comments: 5/27/2008-mes: gave back to the front staff



Outdoor Dining Permit Application

If you or the property owner owes real estate or personal property taxes or user charges on any property within the City, payment arrangements must be made before permits of any kind are accepted.

Location/Address of Outdoor Seating: <u>12 MOULTON ST 386 Free</u>		Total Square Footage of Proposed Seating Area ¹ <u>30 sq/ft</u>		Square Footage of Lot	
Tax Assessor's Chart, Block & Lot Chart# <u>32</u> Block# <u>5</u> Lot# <u>101</u>		Owner: <u>HH Sawyer</u>		Telephone: <u>772-6579</u>	
Lessee/Buyer's Name (If Applicable) <u>HLN Inc.</u>		Applicant * must be owner or Lessee Name <u>HLN Inc.</u> <u>Jayson Lobo220</u>		Annual Fee: <u>\$80</u>	
Address <u>12 MOULTON ST</u>		City, State & Zip <u>04103</u>		Sq Ft Fee: <u>3068</u> \$ _____ Total Fee: \$ _____	
Current use: <u>Ice Cream Parlor</u>					
Business name: <u>HLN Inc. / DBA Beal's Old Fashioned Ice Cream</u>					
Seating area dimensions: <u>17' x 4'</u>					
How many chairs? <u> </u>		How many tables? <u>3 PICNIC TABLES</u>			
Alcohol to be served outside? circle one : YES <input type="radio"/>		NO <input checked="" type="radio"/>			
Who should we contact for the pre-inspection: <u>Heather Nelson or Jayson Lobo220</u>					
Mailing address: <u>12 MOULTON ST</u>		Phone: <u>8281335</u>			

2
4
8
Pegged at
6850 FT
5m H

Please submit all of the information outlined in the Outdoor Dining Application Checklist. Failure to do so will result in the automatic denial of your permit.

In order to be sure the City fully understands the full scope of the project, the Planning and Development Department may request additional information prior to the issuance of a permit. For further information visit us on-line at www.portlandmaine.gov, stop by the Building Inspections office, room 315 City Hall or call 874-8703.

I hereby certify that I am the Owner of record of the named property, or that the owner of record authorizes the proposed work and that I have been authorized by the owner to make this application as his/her authorized agent. I agree to conform to all applicable laws of this jurisdiction. In addition, if a permit for work described in this application is issued, I certify that the Code Official's authorized representative shall have the authority to enter all areas covered by this permit at any reasonable hour to enforce the provisions of the codes applicable to this permit.

[Signature]
Signature of Applicant

5/20/08
Date

This is not a permit; you may not commence ANY work until the permit is issued.

¹ In no instance shall the total square footage of dining area equal more than 10% of park space, unless the applicant receives a waiver from the Director of Parks and Recreation or his or her designee.

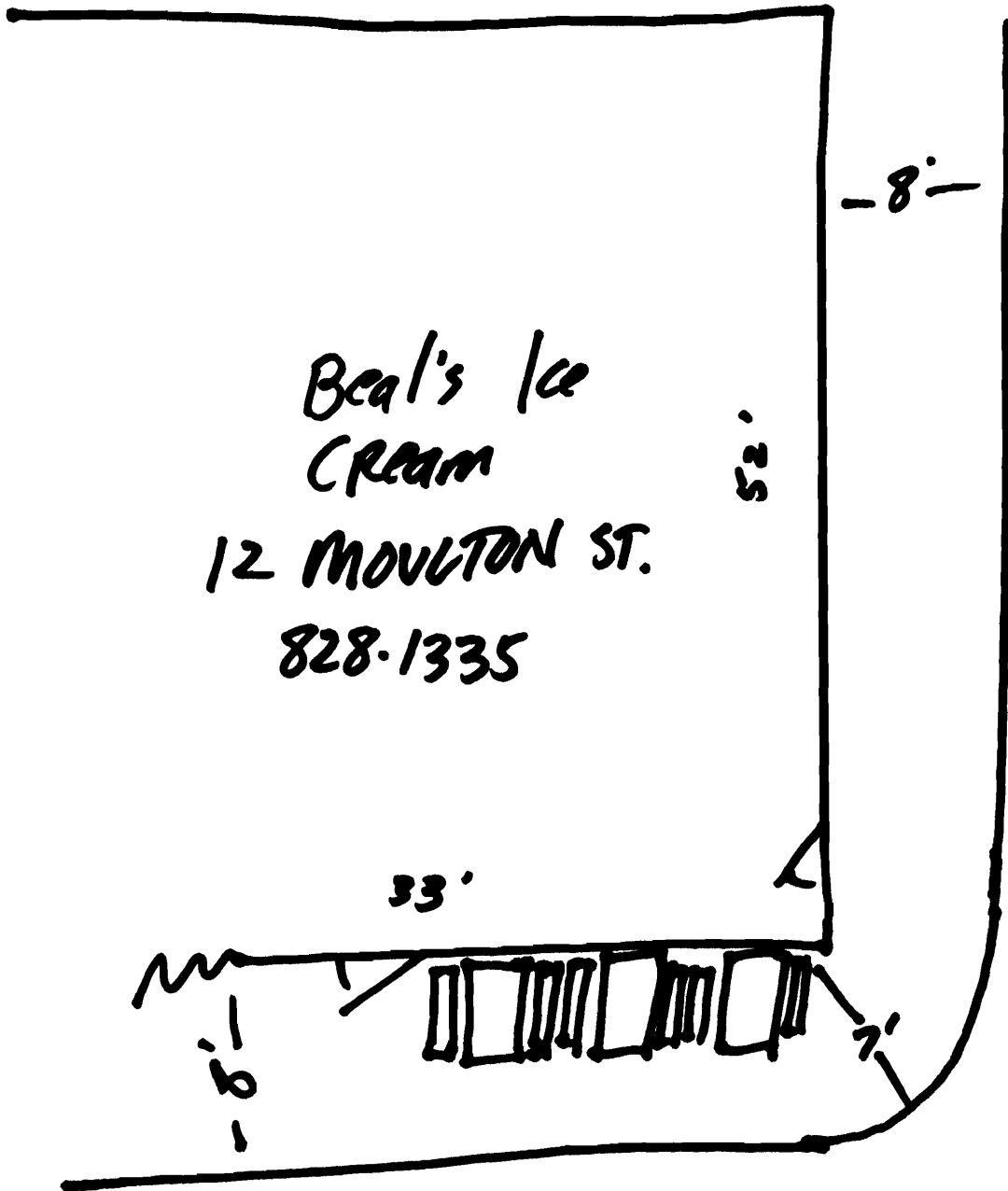

Beal's Ice
Cream
12 MOULTON ST.
828-1335

52'

33'

6'

8'

7'

MOULTON ST

WARF ST.